

RECOMMENDED PANEL
MOUNT OPENING
MAX PANEL THK .080/2.03

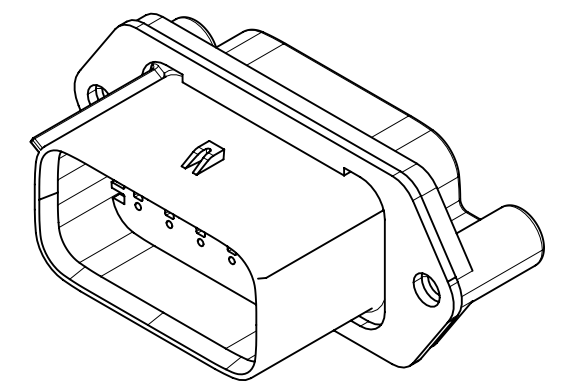

SCALE 1:1

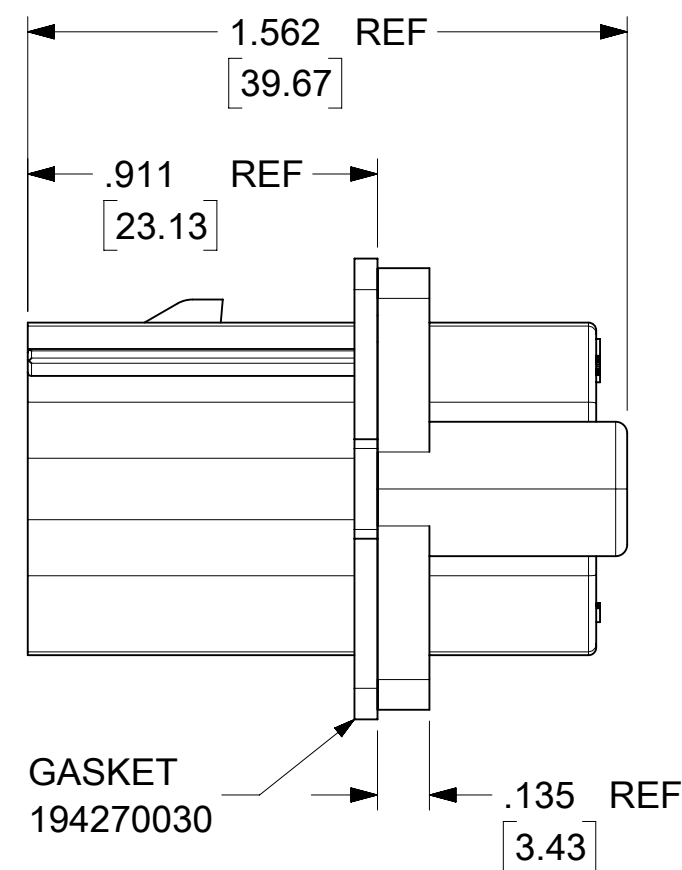
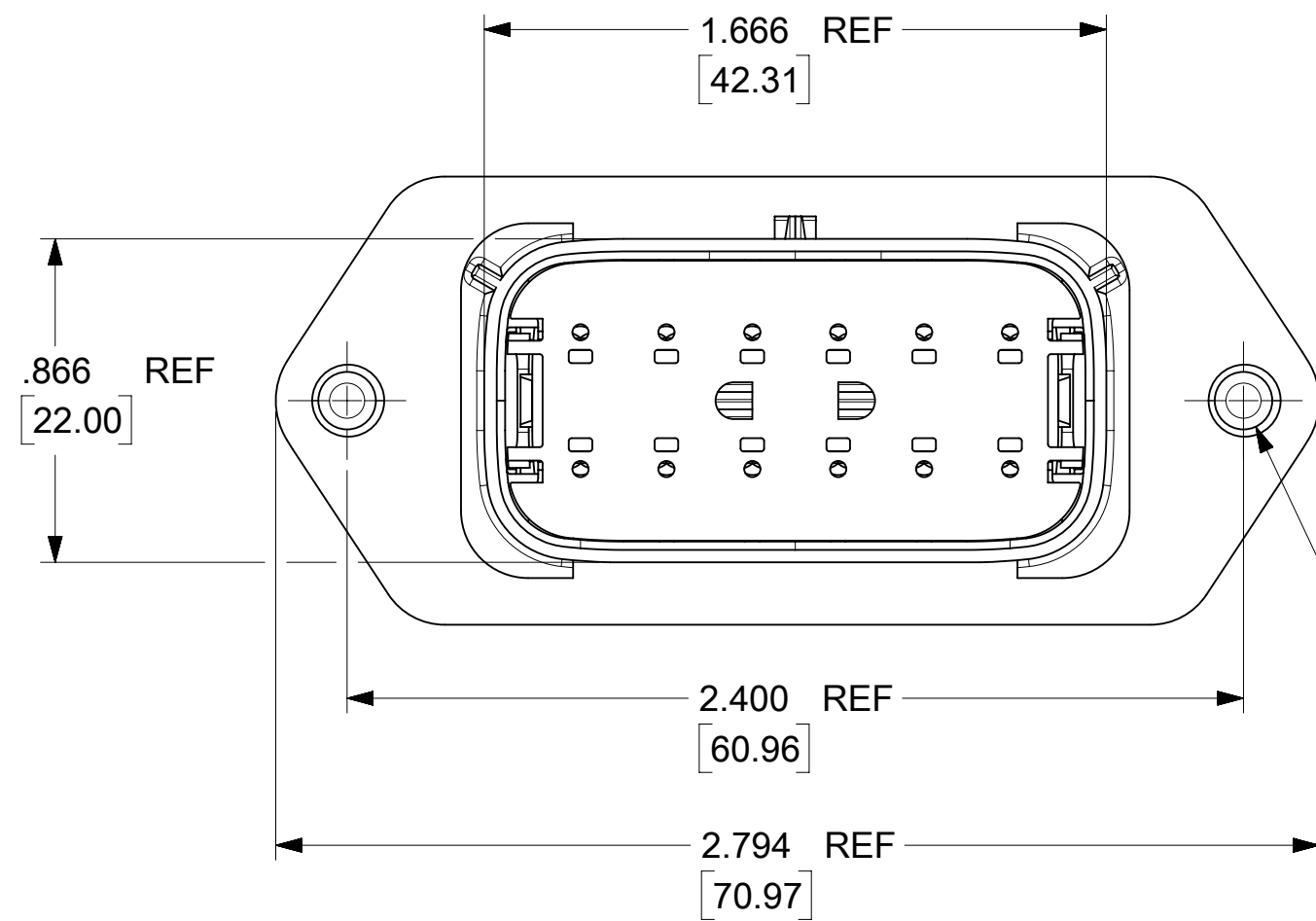

GASKET
194270030

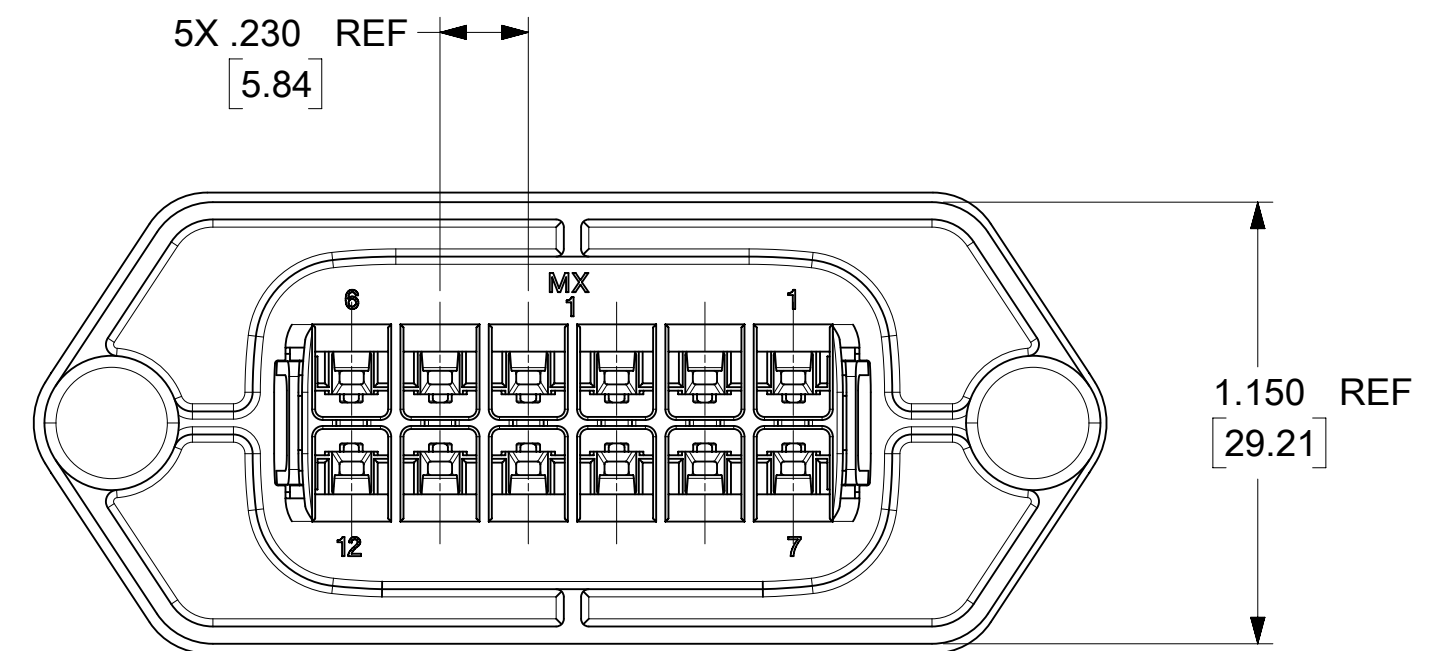

2X Ø .154 X .030 X 45° CHAM
REF [3.91]

- NOTES:
- MATERIALS: [ⓔ]
HOUSING: SYNDIOTACTIC POLYSTYRENE (SPS), GLASS FILLED, UL94 V-0, COLOR: BLACK
GASKET: EPDM RUBBER
 - PRODUCT SPECIFICATION: PS-19417-001.
 - PACKAGING SPECIFICATION: PK-19429-001.
GASKETS, IF REQUIRED FOR THE ASSEMBLIES,
ARE BULK PACKAGED IN A SEPARATE BAG.
 - MATES WITH: 19418 SERIES RECEPTACLE ASSEMBLIES.
 - USE CONNECTOR WITH MALE CRIMP TERMINAL: SERIES 19417.
 - RECOMMENDED MOUNTING HARDWARE: (2)#10 X .62/15.8 LONG
PLASTIC THREAD CUTTING SCREWS. RECOMMENDED TORQUE 15-17 IN-LBS.
SUGGESTED SOURCE: ITW SHAKEPROOF INDUSTRIAL BOSSCREW OR EQUIVALENT.
 - ASSEMBLY IS ROHS COMPLIANT.

194290039	YES
194290015	NO
MATERIAL NUMBER	GASKET

FUNCTIONAL SYMBOLS	THIS DRAWING CONTAINS INFORMATION THAT IS PROPRIETARY TO MOLEX ELECTRONIC TECHNOLOGIES, LLC AND SHOULD NOT BE USED WITHOUT WRITTEN PERMISSION		CURRENT REV DESC: REDRAWN IN NX & HSG MATERIAL UPDATED	
	DIMENSION UNITS	SCALE		
$\frac{F}{A} = 0$	in/[mm]	2:1		
$\frac{F}{C} = 0$	GENERAL TOLERANCES (UNLESS SPECIFIED)			
$\frac{F}{P} = 0$		MM	INCH	
DIVISIONAL SYMBOLS	4 PLACES	±	±	
	3 PLACES	±	± 0.015	
	2 PLACES	± 0.38	±	
	1 PLACE	±	±	
	0 PLACES	±	±	
	ANGULAR TOL	± 1.0°		
	DRAFT WHERE APPLICABLE MUST REMAIN WITHIN DIMENSIONS			
	THIRD ANGLE PROJECTION			
	DRAWING	SERIES		
	C-SIZE	19429		
EC NO: 690910		2021/12/21		molex 12 WAY PLUG PANEL MOUNT ASSEMBLY 22-14 AWG PRODUCT CUSTOMER DRAWING
DRWN: RMV02		2022/01/05		
CHK'D: DMYRICK		2022/01/06		
APPR: JMACNEIL		2022/01/06		DOCUMENT NUMBER
INITIAL REVISION:		03/12/08		DOC TYPE
DRWN: DMYRICK		2010/10/18		DOC PART
APPR: DTITUS				REVISION
MATERIAL NUMBER		CUSTOMER		SHEET NUMBER
SEE CHART		GENERAL MARKET		1 OF 1

DOCUMENT STATUS	P1	RELEASE DATE	2022/01/06 14:54:32
-----------------	----	--------------	---------------------