

WM 3-D MODEL: EM-111111-0400

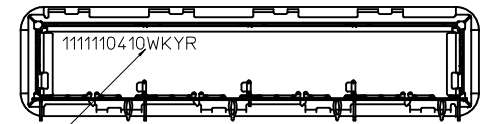
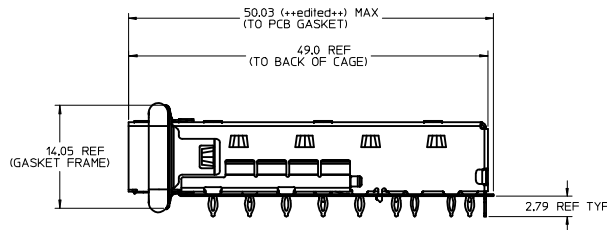
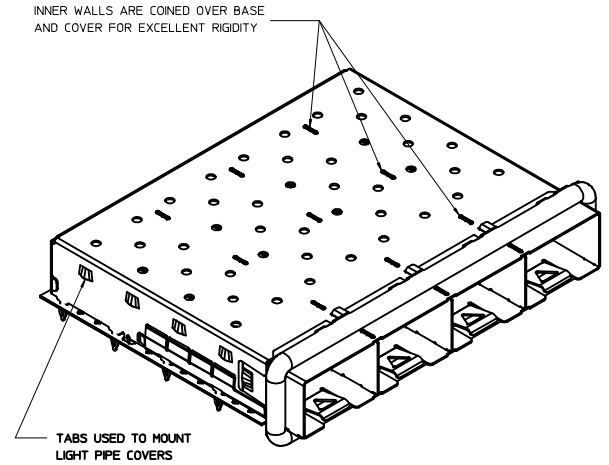
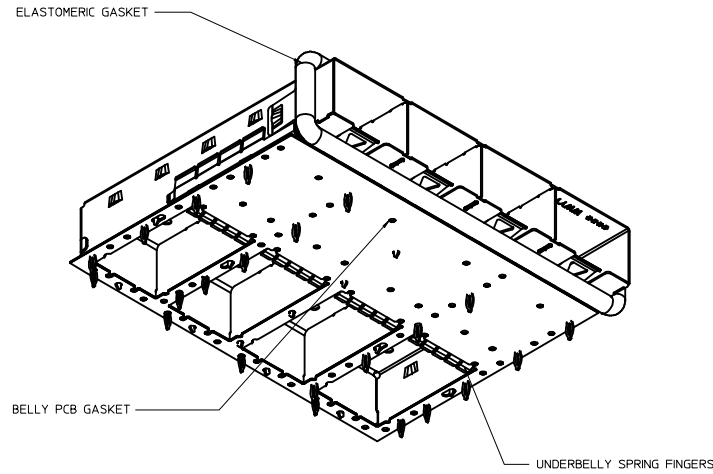
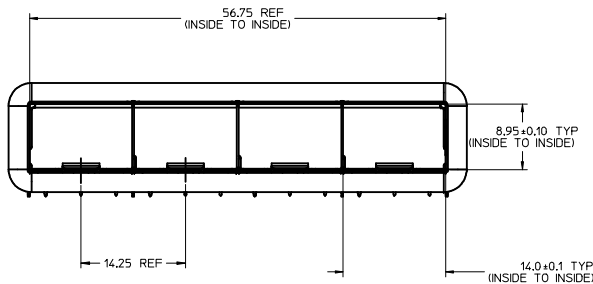
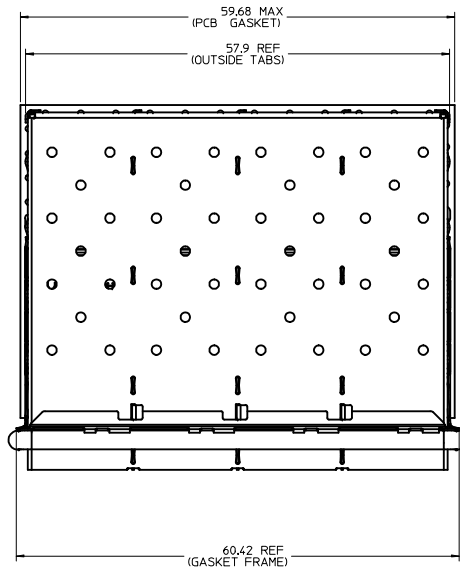

PART NO. AND WEEK/YEAR DATE CODE TO BE PRINTED ON BACK OF CAGE APPROXIMATELY AS SHOWN. SEE TABLE BELOW FOR DATE CODE INFORMATION.

NOTES (UNLESS OTHERWISE SPECIFIED):

- MATERIAL:
  - CAGE: 0.25mm THICK COPPER ALLOY, NICKEL PLATED
  - GASKET FRAME: STAINLESS STEEL
  - ELASTOMERIC GASKET: CONDUCTIVE ELASTOMER
  - BELLY PCB GASKET: COATED POLYIMIDE
- PORTS ARE DESIGNED FOR zSFP+, SFP+, AND SFP TRANSCEIVERS
- OPTIONAL LIGHT PIPE ASSEMBLY AVAILABLE
- LEAD FREE, NO ROHS EXEMPTIONS
- PRESS FIT LEGS:
  - 1.57mm MINIMUM PCB THICKNESS FOR SINGLE SIDED USE
  - 3.00mm MINIMUM PCB THICKNESS FOR BELLY TO BELLY USE

DATE	WEEK/YEAR DATE CODE TABLE
WK	01 THRU 52. EXAMPLE: 01 = FIRST WEEK OF YEAR, 52 = LAST WEEK OF YEAR
YR	11, 12, 13, ETC. EXAMPLE: 2013 = 13

QUALITY SYMBOLS	GENERAL TOLERANCES (UNLESS SPECIFIED)		DIMENSION STYLE		SCALE	DESIGN UNITS	THIRD ANGLE PROJECTION
	mm	INCH	MM ONLY	DATE			
▽=0	4 PLACES ±---	±---	M	DANIELS	3:1	METRIC	ZSFP+ 1X4 GANGED CAGE PRESS FIT ELASTOMER GSKT WITH BELLY PCB GASKETS
▽=0	3 PLACES ±---	±---	C	KJANOTA			
▽=0	2 PLACES ±0.15	±---	M	KJANOTA	1111110410	SD-111111-0410	molex
▽=0	1 PLACE ±0.25	±---	C	KJANOTA			
▽=0	0 PLACE ±	±	M				
DRAFT WHERE APPLICABLE MUST REMAIN WITHIN DIMENSIONS		ANGULAR ± 1°		MATERIAL NO.		DOCUMENT NO.	
				1111110410		SD-111111-0410	
				SIZE		SHEET NO.	
				D		1 OF 5	

HATCHED AREA DENOTES COMPONENTS AND TRACE KEEP-OUT (EXCEPT CHASSIS GROUND)

CROSS HATCHED AREA GOES TO CHASSIS GROUND (NO OSP) 4 PLCS

THIS AREA DENOTES COMPONENT KEEP-OUT (TRACES ALLOWED)

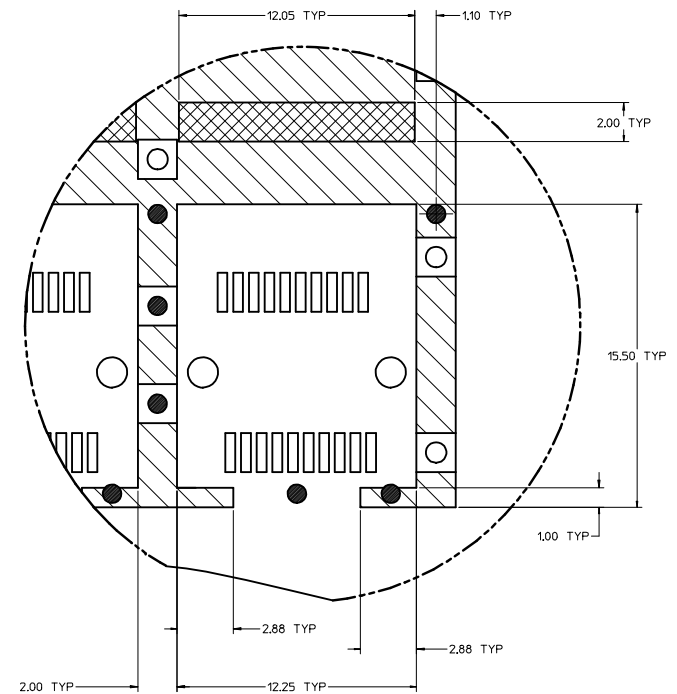
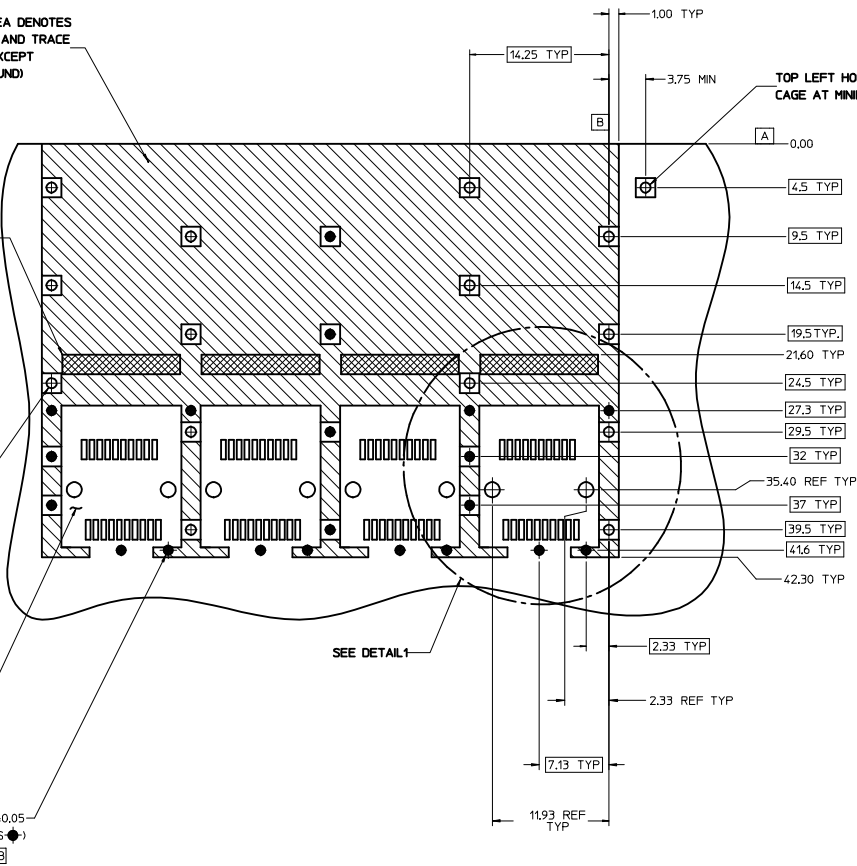

DETAIL1  
SCALE 8:1  
HOST CONNECTOR DETAIL

NOTES (UNLESS OTHERWISE SPECIFIED):

1. PADS AND VIAS CONNECT TO CHASSIS GROUND (RECOMMEND PADS TO BE 2.00mm SQUARE)
2. RECOMMENDED THRU HOLE PLATING INCLUDES HASL, OSP, OR IMMERSION (GOLD, SILVER, OR TIN)
3. CONNECTOR PAD LAYOUT WILL ACCOMMODATE MOLEX CONNECTOR SERIES 170382 OR EQUIVALENT
4. HOLE PATTERN REPEATS FOR EACH PORT. SPACING BETWEEN PORTS IS 14.25mm

<b>SEE REVISION TABLE</b> EEC NO: CPG2016-3726 DRAWN: CHANG04 2016/04/14 CHKD: APPR: RCHEN08 2016/04/29	QUALITY SYMBOLS	GENERAL TOLERANCES (UNLESS SPECIFIED)	DIMENSION STYLE	SCALE	DESIGN UNITS	THIRD ANGLE PROJECTION
	▽=0	mm INCH	MM ONLY	3:1	METRIC	☉
	▽=0	4 PLACES ± --- ± ---	DRAWN BY	DATE	TITLE	
	▽=0	3 PLACES ± --- ± ---	MDANIELS	2011/07/12	ZSFP+ 1X4 GANGED CAGE PRESS FIT, ELASTOMER GSKT WITH BELLY PCB GASKETS	
	2 PLACES ± 0.15 ± ---	CHECKED BY	DATE			
	1 PLACE ± 0.25 ± ---	KJANOTA	2011/07/14			
	0 PLACE ± ±	APPROVED BY	DATE			
		KJANOTA	2011/07/20			
	ANGULAR ± 1 °	MATERIAL NO.	DOCUMENT NO.			
	DRAFT WHERE APPLICABLE MUST REMAIN WITHIN DIMENSIONS	SEE SHEET 1	SD-111111-0410			
		THIS DRAWING CONTAINS INFORMATION THAT IS PROPRIETARY TO MOLEX INCORPORATED AND SHOULD NOT BE USED WITHOUT WRITTEN PERMISSION				

# PCB LAYOUT FOR BELLY TO BELLY MOUNTING

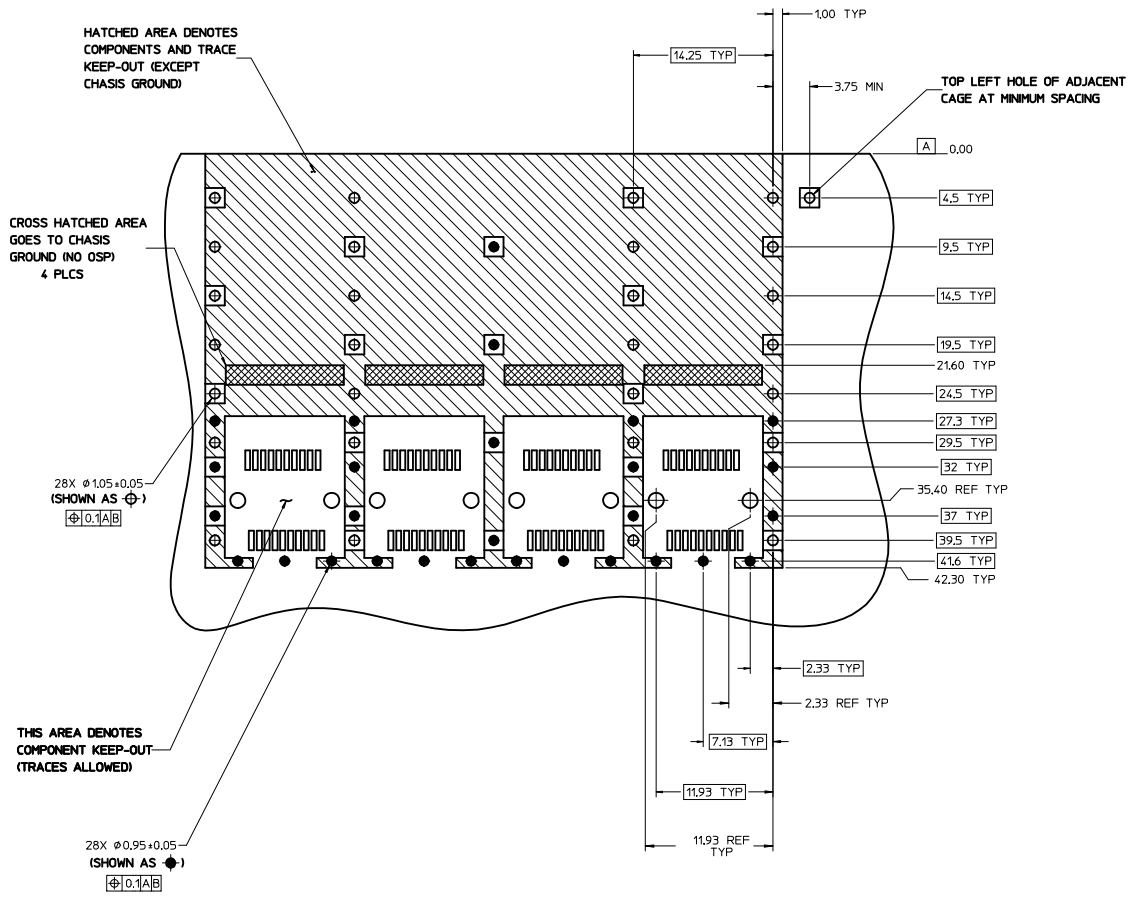

NOTE:  
SEE SHEET 2 FOR  
HOST CONNECTOR DETAIL

NOTES (UNLESS OTHERWISE SPECIFIED):

1. PADS AND VIAS CONNECT TO CHASSIS GROUND (RECOMMEND PADS TO BE 2.00mm SQUARE)
2. RECOMMENDED THRU HOLE PLATING INCLUDES HASL, OSP, OR IMMERSION (GOLD, SILVER, OR TIN)
3. CONNECTOR PAD LAYOUT WILL ACCOMMODATE MOLEX CONNECTOR SERIES 170382 OR EQUIVALENT
4. HOLE PATTERN REPEATS FOR EACH PORT. SPACING BETWEEN PORTS IS 14.25mm

<b>SEE REVISION TABLE</b> IEC NO: CPG2016-3726 DRAWN: HCHANG04 CHKD: CHXD APPR: RCHEN08 DATE: 2016/04/14 DATE: 2016/04/19	<b>QUALITY SYMBOLS</b> ∇=0 ∇=0 ∇=0	<b>GENERAL TOLERANCES (UNLESS SPECIFIED)</b>		<b>DIMENSION STYLE</b> MM ONLY	<b>SCALE</b> 3:1	<b>DESIGN UNITS</b> METRIC	<input checked="" type="checkbox"/> THIRD ANGLE PROJECTION
		4 PLACES ± --- ± --- mm INCH 3 PLACES ± --- ± --- 2 PLACES ± 0.15 ± --- 1 PLACE ± 0.25 ± --- 0 PLACE ± ±	4 PLACES ± --- ± --- 3 PLACES ± --- ± --- 2 PLACES ± 0.15 ± --- 1 PLACE ± 0.25 ± --- 0 PLACE ± ±	DRAWN BY DATE MDANIELS 2011/07/12 CHECKED BY DATE KJANOTA 2011/07/14 APPROVED BY DATE KJANOTA 2011/07/20	MATERIAL NO. <b>SEE SHEET 1</b>	TITLE <b>ZSFP+ 1X4 GANGED CAGE PRESS FIT, ELASTOMER GSKT WITH BELLY PCB GASKETS</b> <b>molex</b>	DOCUMENT NO. <b>SD-111111-0410</b>
DRAFT WHERE APPLICABLE MUST REMAIN WITHIN DIMENSIONS		THIS DRAWING CONTAINS INFORMATION THAT IS PROPRIETARY TO MOLEX INCORPORATED AND SHOULD NOT BE USED WITHOUT WRITTEN PERMISSION					

BEZEL AND BOARD POSITION DIMENSIONS FOR SINGLE SIDED MOUNTING  
(ELASTOMERIC GASKET)

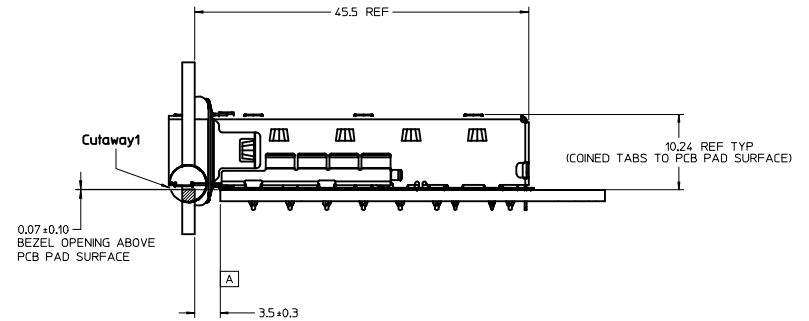
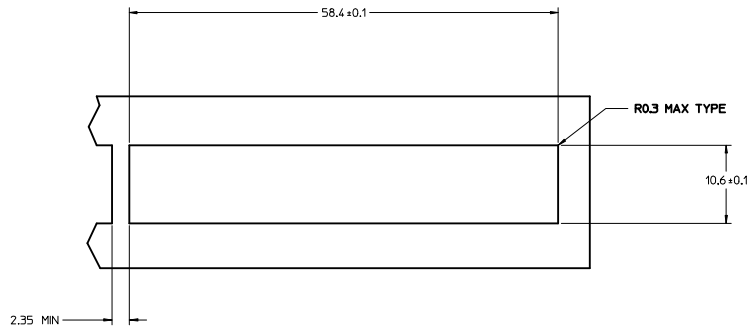

BEZEL AND BOARD POSITION DIMENSIONS FOR BELLY TO BELLY MOUNTING  
(ELASTOMERIC GASKET)

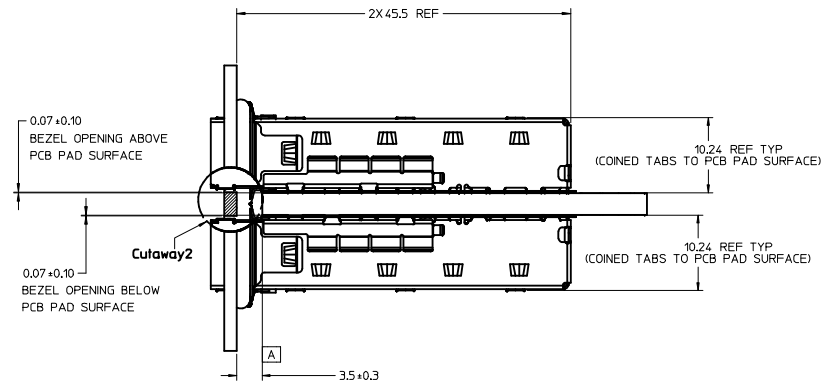
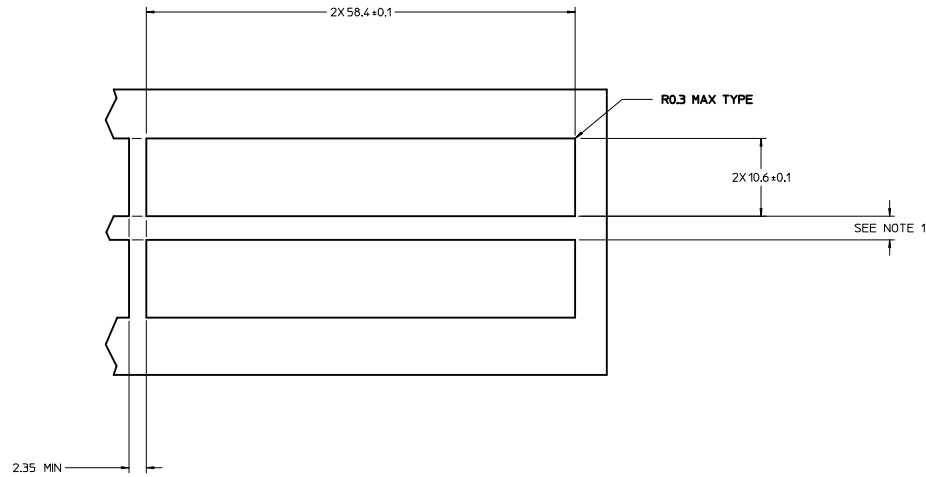

NOTES (UNLESS OTHERWISE SPECIFIED):

1. PCB THICKNESS VARIATION MUST BE CONSIDERED WHEN DETERMINING BEZEL OPENING SIZE AND LOCATION

<b>SEE REVISION TABLE</b> IEC NO: CPG2016-3726 DRAWN: CHANG04 2016/04/14 CHKD: APPR: RCHEN08 2016/04/29	QUALITY SYMBOLS	GENERAL TOLERANCES (UNLESS SPECIFIED)	DIMENSION STYLE	SCALE	DESIGN UNITS	THIRD ANGLE PROJECTION
	▽=0	mm INCH	MM ONLY	3:1	METRIC	☉
	▽=0	4 PLACES ± --- ± ---	DRAWN BY DATE	TITLE		
	▽=0	3 PLACES ± --- ± ---	MDANIELS 2011/07/12	ZSFP+ 1X4 GANGED CAGE PRESS FIT ELASTOMER GSKT WITH BELLY PCB GASKETS		
▽=0	2 PLACES ± 0.15 ± ---	CHECKED BY DATE	MATERIAL NO. DOCUMENT NO.			
▽=0	1 PLACE ± 0.25 ± ---	KJANOTA 2011/07/14	SD-111111-0410			
▽=0	0 PLACE ± ±	APPROVED BY DATE	SHEET NO.			
		KJANOTA 2011/07/20	4 OF 5			
			THIS DRAWING CONTAINS INFORMATION THAT IS PROPRIETARY TO MOLEX INCORPORATED AND SHOULD NOT BE USED WITHOUT WRITTEN PERMISSION			

DATE (YEAR/MONTH/DAY)	REV	DESCRIPTION
2011/07/12	A	INITIAL RELEASE
2012/05/15	B	<p>UPDATED THE TITLE AND CHANGED THE 2 PLACE TOLERANCE FROM ±0.13 TO ±0.15 IN THE TITLE BLOCK.</p> <p>SHEET 1: DELETED SPRING FINGER, ADDED GASKET FRAME AND ELASTOMERIC GASKET, AND RENUMBERED THE NOTES.</p> <p>FROM 49.79 (SHEET TOL) TO 50.03 MAX (TO PCB GASKET) AT G-11, ADDED 49.0 REF (TO BACK OF CAGE) AT F-11, FROM 2.73 (SHEET TOL) TO 2.79 REF AT E-8, FROM 14.1 (SHEET TOL) (ACROSS FRAME) TO 14.05 REF (GASKET FRAME) AT E-13.</p> <p>ADDED TYP TO 14.0 AT D-14 AND 8.95 AT E-15, ADDED 14.25 REF CENTERLINE AT D-18, ADDED REF TO 56.75 AT G-17 AND 60.42 AT G-17, DELETED 57.25 (OUTSIDE FRAME) AT H-18, FROM 57.85 (SHEET TOL) TO 57.9 REF AT L-17, FROM 59.37 (SHEET TOL) TO 59.68 MAX AT M-17.</p> <p>SHEETS 2 AND 3: DELETED INCH DUAL DIMENSIONS FOR THE THRU HOLES AT D-18 AND G-18, CHANGED 14.25 TO BASIC AT L-13, CHANGED THE DIMENSIONS FOR THE CONNECTOR MOUNTING HOLES FROM BASIC TO REF: 35.40 AT G-10, 2.33 AT E-11, AND 11.93 AT D-12, ADDED NOTE 4 FOR THE SPACING.</p> <p>SHEET 4: CHANGED BEZEL OPENING FROM 0.13 BELOW THE PCB TO 0.07 ABOVE THE PCB PADS AT I-9, E-9, AND D-9, FROM 46.29 (EDGE OF PCB GASKET) TO 45.5 REF TO THE BACK OF THE CAGE AT L-6 AND G-6, FROM 10.35 TO 10.24 REF (COINED TABS TO PCB PAD SURFACE) AT J-3, E-3, AND D-3.</p> <p>SHEET 5: ADDED REVISION HISTORY.</p>
2016/02/04	C	SHEET 4: D8: CORRECT TYPO. CHANGED *ABOVE* TO *BELOW*.
2016/04/29	D	SHEET 1: M17: CORRECT TYPO. DELETED (++)EDITED++).

<b>SEE REVISION TABLE</b> IEC NO: CPG2016-3726 D DRWN: CHANG04 2016/04/14 CHKD: APPR: RCHEN08 2016/04/29 REV:	QUALITY SYMBOLS	GENERAL TOLERANCES (UNLESS SPECIFIED)	DIMENSION STYLE	SCALE	DESIGN UNITS	THIRD ANGLE PROJECTION	
	▽=0	mm INCH	MM ONLY	1:1	METRIC		
	▽=0	4 PLACES ± --- ± --- 3 PLACES ± --- ± --- 2 PLACES ± 0.15 ± --- 1 PLACE ± 0.25 ± --- 0 PLACE ± ±	DRAWN BY DATE MDANIELS 2011/07/12	TITLE ZSFP+ 1X4 GANGED CAGE PRESS FIT, ELASTOMER GSKT WITH BELLY PCB GASKETS			
	▽=0	ANGULAR ± 1 ° DRAFT WHERE APPLICABLE MUST REMAIN WITHIN DIMENSIONS	CHECKED BY DATE KJANOTA 2011/07/14	APPROVED BY DATE KJANOTA 2011/07/20			
			MATERIAL NO.	DOCUMENT NO.	SHEET NO.		
			SEE SHEET 1	SD-111111-0410	5 OF 5		
			THIS DRAWING CONTAINS INFORMATION THAT IS PROPRIETARY TO MOLEX INCORPORATED AND SHOULD NOT BE USED WITHOUT WRITTEN PERMISSION				