

DESCRIPTION: HIGH DENSITY FEMALE - VERTICAL DIP SOLDER

DIMENSIONS

| No. OF PINS | A | B | C | D | E | F | G | H |
|-------------|-------|-------|-------|-------|-------|-------|-------|-------|
| 15 | 1.213 | 0.984 | 0.643 | 0.311 | 0.090 | 0.756 | 0.496 | 0.429 |
| | 30.80 | 24.99 | 16.34 | 7.90 | 2.29 | 19.20 | 12.60 | 10.90 |
| 26 | 1.541 | 1.312 | 0.966 | 0.311 | 0.090 | 1.091 | 0.496 | 0.429 |
| | 39.15 | 33.32 | 24.53 | 7.90 | 2.29 | 27.70 | 12.60 | 10.90 |
| 44 | 2.087 | 1.852 | 1.512 | 0.311 | 0.090 | 1.618 | 0.496 | 0.429 |
| | 53.00 | 47.04 | 38.40 | 7.90 | 2.29 | 41.10 | 12.60 | 10.90 |
| 62 | 2.728 | 2.500 | 2.155 | 0.311 | 0.095 | 2.256 | 0.496 | 0.429 |
| | 69.30 | 63.50 | 54.76 | 7.90 | 2.41 | 57.30 | 12.60 | 10.90 |
| 78 | 2.638 | 2.406 | 2.057 | 0.429 | 0.095 | 2.169 | 0.606 | 0.526 |
| | 67.00 | 61.10 | 52.26 | 10.90 | 2.41 | 55.10 | 15.40 | 13.35 |

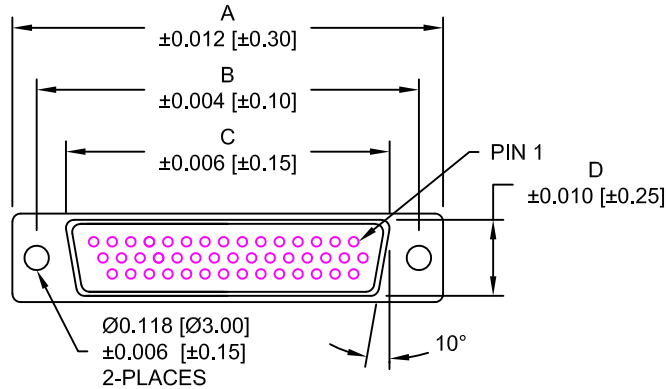

4 ROWS

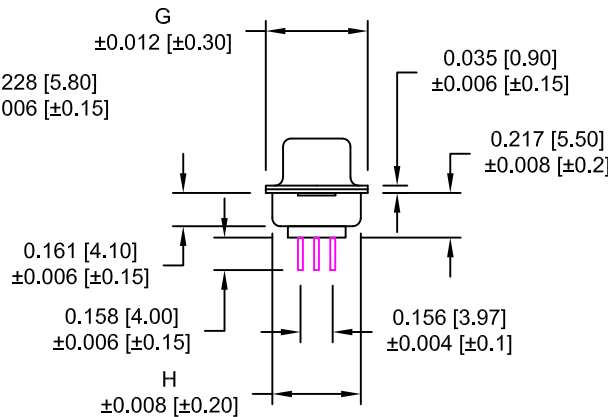
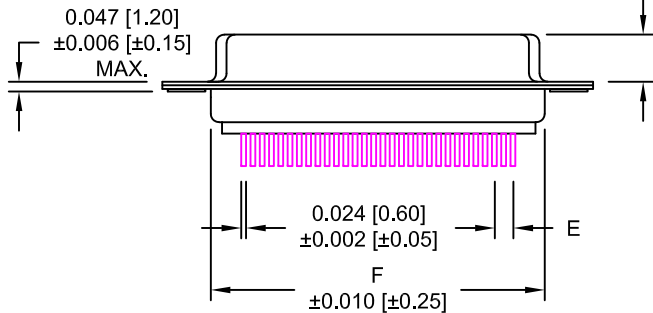

180-YYY-213RYY1

- SERIES
- POSITIONS
 - 015
 - 026
 - 044
 - 062
 - 078
- GENDER
 - 2 = FEMALE
- TERMINATION
 - 1 = VERTICAL DIP SOLDER
- SHELL PLATING
 - 2 = TIN
 - 3 = NICKEL
- RoHS COMPLIANT (260°C)
- HARDWARE OPTIONS
 - 00 = NO HARDWARE
 - 01 = .098" CLINCH NUT (BOARD SIDE)
 - 02 = .236" CLINCH NUT (BOARD SIDE)
 - 03 = .236" CLINCH NUT (MATING SIDE)
 - 05 = .237" 4-40 BOARD LOCK
 - 08 = .224" 4-40 BOARD LOCK
 - 90 = .237" 4-40 BOARD LOCK
 - FOR 0.093" BOARD MAX.
 - 91 = .237" 4-40 SPACER/BOARD LOCK
 - 92 = .237" 4-40 SPACER/BOARD LOCK
 - FOR 0.093" BOARD MAX.
- PLATING OPTIONS
 - 1 = GOLD FLASH
 - A = 30u" GOLD MATING AREA, GOLD FLASH OVERALL

MATERIAL:

- SHELL: STEEL, NICKEL PLATED
- INSULATOR: PBT, UL 94V-O RATED, +30% FIBER-GLASS OR NYLON-66
- CONTACT: BRASS, GOLD PLATED OVER NICKEL

ELECTRICAL:

- CURRENT RATING: 3 AMPS
- CONTACT RESISTANCE: 15 mOhms Max.
- INSULATION RESISTANCE: 1,000 MOhms min.
- VOLTAGE: 500VAC FOR 1 MINUTE
- TEMPERATURE: -50° C TO 100° C

DO NOT SCALE FROM DRAWING



THESE DRAWINGS AND SPECIFICATIONS ARE THE PROPERTY OF NorComp AND SHALL NOT BE REPRODUCED, COPIED OR USED AS THE BASIS FOR THE MANUFACTURE OF SALE OF APPARATUS WITHOUT WRITTEN PERMISSION.

| | |
|----------------------------|--------------------|
| DRAWN: PAM JENKINS | DATE: 09-12-05 |
| CHECKED: | DATE: |
| SCALE: 1 : 1 | SHEET 1 OF 3 |
| DWG NO. 180-YYY-213RYY1 | REV 19 |

RoHS COMPLIANT

NorComp

DESCRIPTION: PCB LAYOUT - VERTICAL - FEMALE

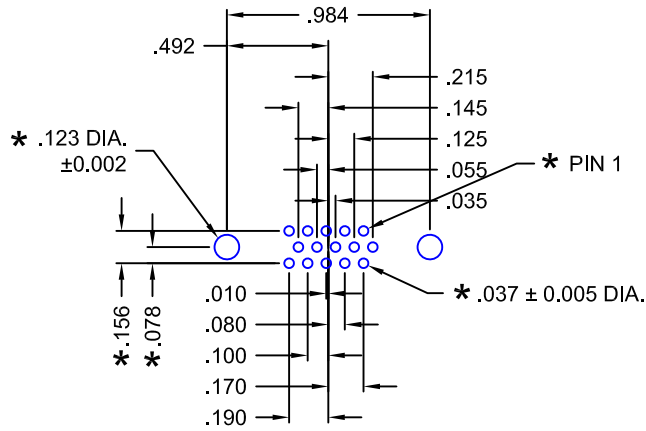

15 POSITION

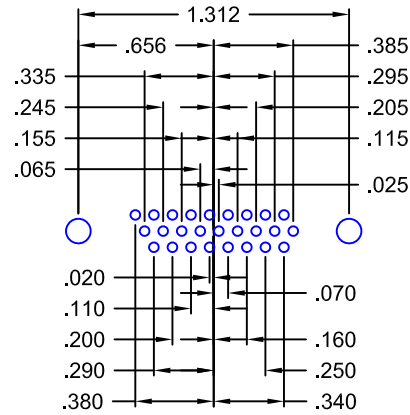

26 POSITION

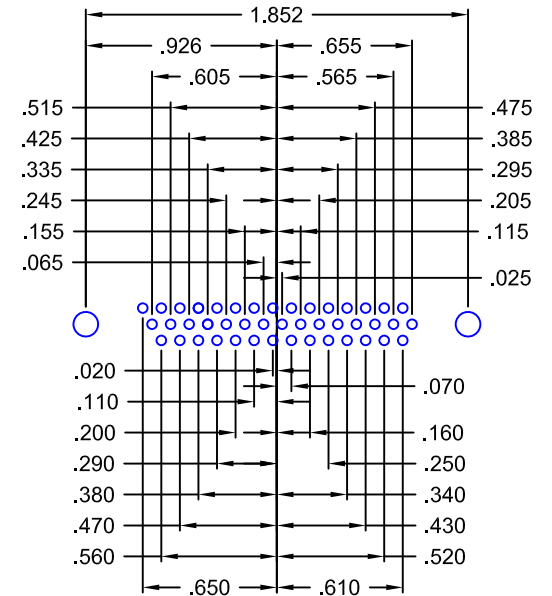

44 POSITION

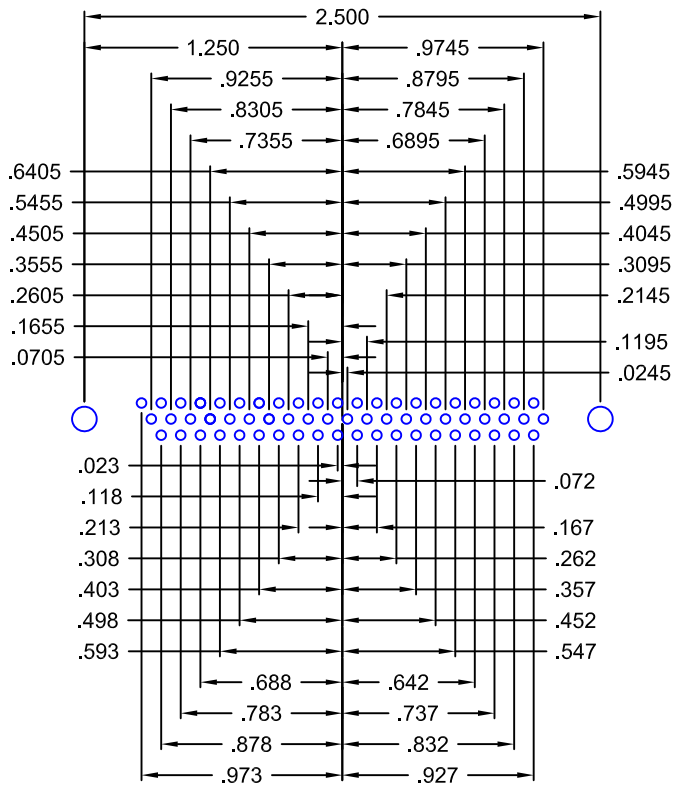

62 POSITION

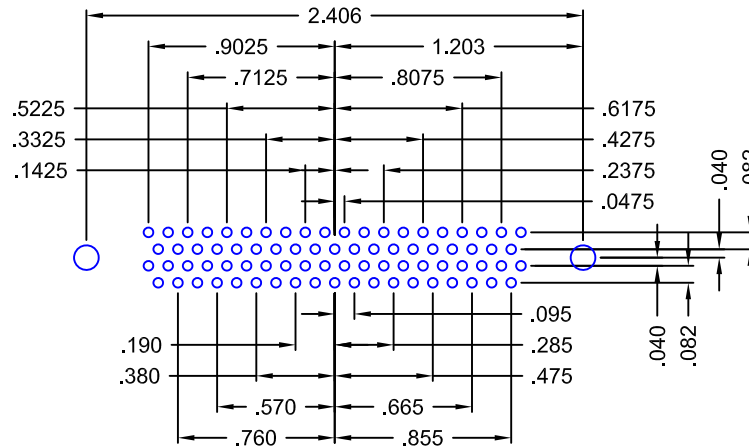

78 POSITION

180 SERIES
HIGH DENSITY
VERTICAL

HOLE PATTERN SHOWN
ARE FOR FEMALE

* TYP. ON ALL SIZES

DO NOT SCALE FROM DRAWING



THESE DRAWINGS AND SPECIFICATIONS ARE THE PROPERTY OF NorComp AND SHALL NOT BE REPRODUCED, COPIED OR USED AS THE BASIS FOR THE MANUFACTURE OF SALE OF APPARATUS WITHOUT WRITTEN PERMISSION.

NorComp

| | | | |
|-------------------------|------------|-------------------|-----------|
| DRAWN: PAM JENKINS | | DATE: 09-12-05 | |
| CHECKED: | | DATE: | |
| SCALE: | SHEET 2 | OF 3 | REV 19 |
| DWG NO. 180-YYY-213RYY1 | | | |

DESCRIPTION: CLINCH NUT HARDWARE

ALL CLINCH-NUTS ARE 4-40 INTERNAL THREADS

TOLERANCE:

ALL DIMENSIONS ARE ±0.010

01X 0.098" (BOARD SIDE) - CN1

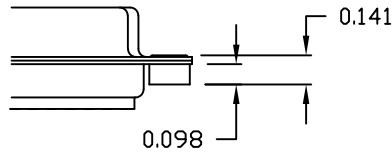

02X 0.236" (BOARD SIDE) - CN2

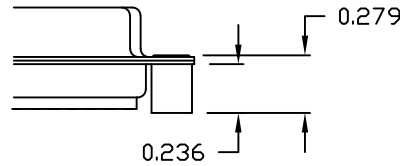

03X..... 0.236" (MATING SIDE) - CN8

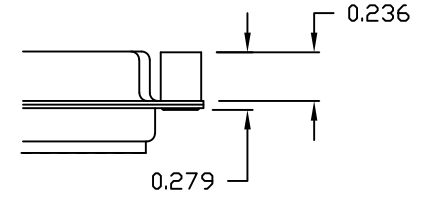

05X 0.237" (BOARD SIDE) - CN10

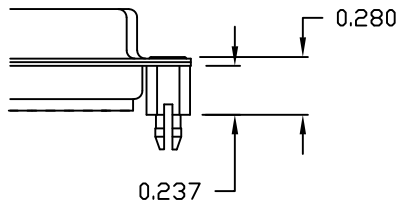

08X 0.228" (BOARD SIDE) - CN3

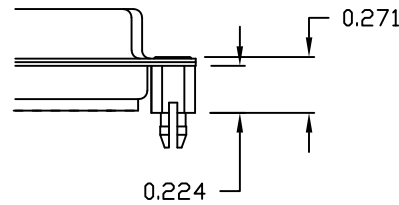

91X 0.237" BOARD SIDE
0.197 MATING SIDE
CN10/SFSO4404

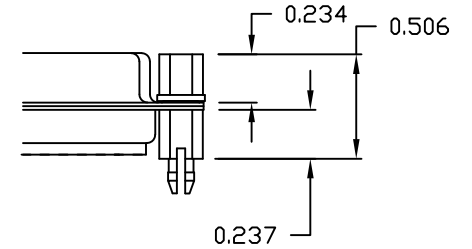

NOTE: 4-40 FEMALE SCREW LOCK IS REMOVABLE

90X 0.237" (BOARD SIDE) - CN10-237-093

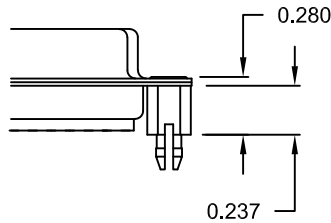

92X 0.237" BOARD SIDE
0.197 MATING SIDE
CN10-237-093/SFSO4404

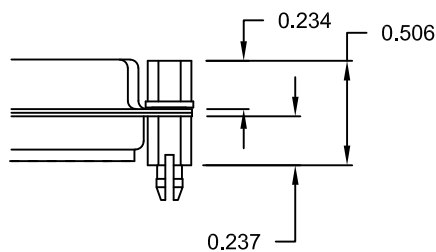

NOTE: 4-40 FEMALE SCREW LOCK IS REMOVABLE

NOTE: 90 & 92 OPTION FOR 0.093" MAX. BOARD THICKNESS

DO NOT SCALE FROM DRAWING

RoHS COMPLIANT



THESE DRAWINGS AND SPECIFICATIONS ARE THE PROPERTY OF NorComp AND SHALL NOT BE REPRODUCED, COPIED OR USED AS THE BASIS FOR THE MANUFACTURE OF SALE OF APPARATUS WITHOUT WRITTEN PERMISSION.

NorComp

| | | | |
|-------------------------|------------|-------------------|-----------|
| DRAWN: WAYNE ROBBINS | | DATE: 11-28-05 | |
| CHECKED: | | DATE: | |
| SCALE: | SHEET 3 | OF 3 | REV 19 |
| DWG NO. 180-YYY-213RYY1 | | | |