

1 2 3 4 5 6 7 8

F

F

E

E

D

D

C

C

B

B

A

A

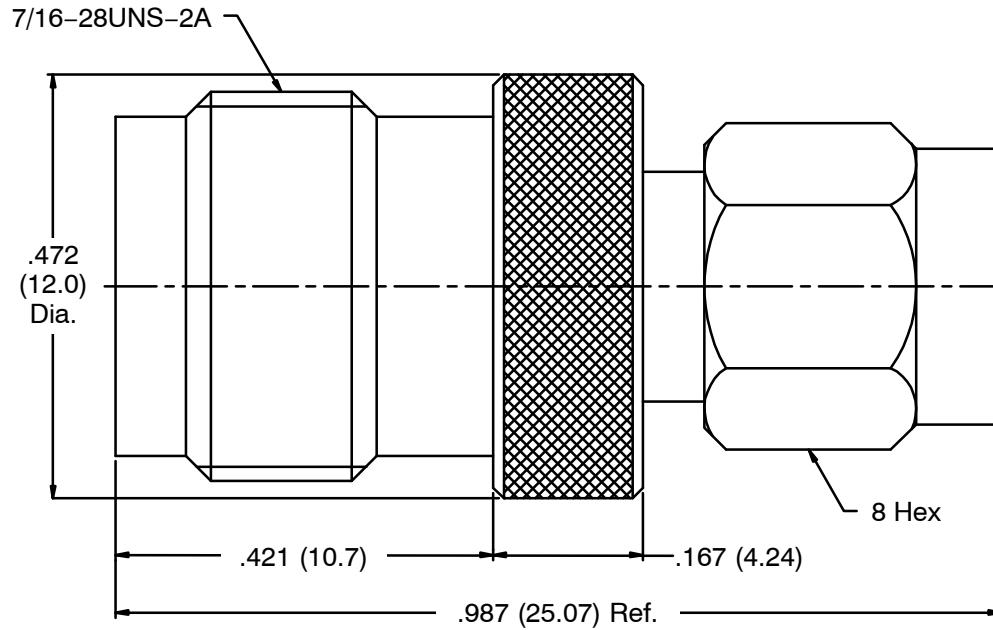

- NOTES: Finish (Plating Thickness in Micro-inches)
1. Brass
 2. Nickel Pl. 100 Min. Thick over Copper Pl. 50 Min. Thick
 3. Phosphor Bronze
 4. Gold Pl. 3 Min Thick over Nickel Pl. 50 Min. Thick over Copper Pl. 50 Min. Thick
 5. Teflon

RoHS Compliant

Dimensions are in Inches				Part No.		<h1>NTE Electronics</h1>	
Unless Otherwise Specified Tolerances				Approved			Title
0.5-6 = ±0.2				Date			SMA Male to TNC Female Adapter
6-30 = ±0.4				11-22-2010			Drawing No.
30-120 = ±0.6				Checked		06-S011	
120-315 = ±1				Date		File No.	
315-1000 = ±1.6				11-22-2010			
1000-2000 = ±2.4				Drawn			
				Date			
				11-22-2010			
No.	Description	Material	Finish	Q'ty	Drawing No.		

1 2 3 4 5 6 7 8