

MOLEX LOGO

CKT NO.

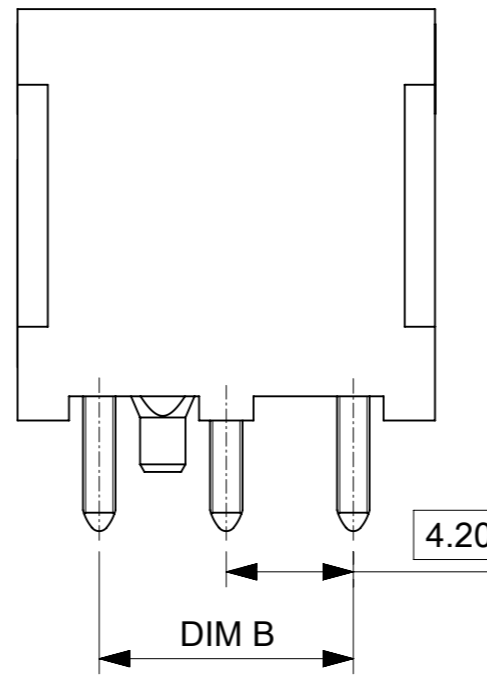
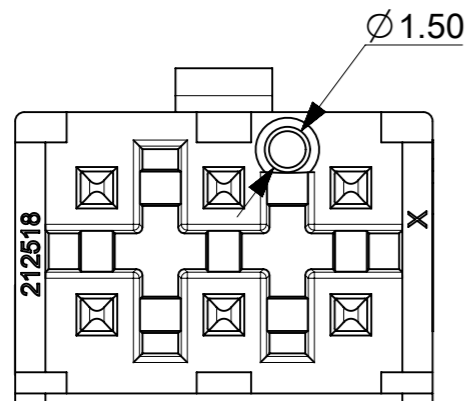
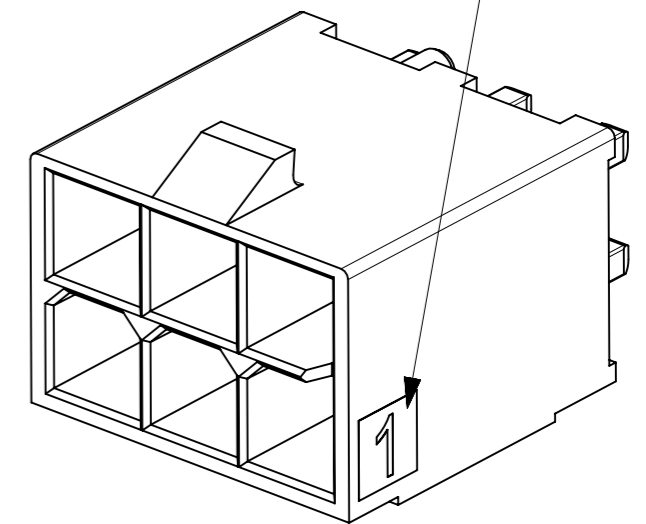

- NOTES:
- MATERIALS:
HOUSING - LCP UL94V-0, COLOR: SEE CHART
TERMINAL - COPPER ALLOY
 - TERMINAL PLATING: TIN OVER NICKEL OVERALL.
 - PRODUCT SPECIFICATION: 2125150000-PS.
 - PACKAGING SPECIFICATION: TRAY PACK PER: 212520001-PK
 - PART MATES WITH MINI-FIT MAX RECEPTACLE SERIES 212514.
 - DISCOLORIZATION IN THE BANDOLIER CARRIER AREA OF THE PIN IS INHERENT TO THE PLATING PROCESS AND IS DUE TO THE MASKING EFFECT OF THE CARRIER. THIS DISCOLORIZATION IS A NON-FUNCTIONAL AREA OF THE PIN AND WILL NOT AFFECT THE PERFORMANCE OF THE HEADER ASSEMBLY.
 - CONNECTORS ARE NOT TO BE MATED OR UNMATED WHILE CIRCUITS ARE LIVE.
 - PARTS ARE NOT DESIGNED FOR CURRENT SHARING.
 - THIS PART CONFORMS TO CLASS "B" REQUIREMENTS OF COSMETIC SPECIFICATION PS-45499-002.
 - TEXT ON PART IS FOR REFERENCE ONLY. TEXT AND TEXT LOCATION MAY VARY DEPENDING ON PART NUMBER AND/OR TOOL.

FUNCTIONAL SYMBOLS	THIS DRAWING CONTAINS INFORMATION THAT IS PROPRIETARY TO MOLEX ELECTRONIC TECHNOLOGIES, LLC AND SHOULD NOT BE USED WITHOUT WRITTEN PERMISSION		CURRENT REV DESC:		molex
	MM	SCALE			
FA = 0	mm	4:1			MINI-FIT MAX DR HDR VERTICAL VERT. HEADER ASSY 2-12 CKT
FE = 0	GENERAL TOLERANCES (UNLESS SPECIFIED)				
FE = 0	ANGULAR TOL ± °				PRODUCT CUSTOMER DRAWING
	4 PLACES	±			
	3 PLACES	±			DOCUMENT NUMBER
	2 PLACES	± 0.25			
	1 PLACE	± 0.5			DOC TYPE
	0 PLACES	±			
DIVISIONAL SYMBOLS	DRAFT WHERE APPLICABLE MUST REMAIN WITHIN DIMENSIONS		THIRD ANGLE PROJECTION	DRAWING	SERIES
				A3-SIZE	212520
			MATERIAL NUMBER	CUSTOMER	SHEET NUMBER
			SEE TABLE	GENERAL MARKET	1 OF 2
			EC NO: 679543	DRWN: ZIXUAQ	2021/09/28
			CHK'D: XQZHANG	APPR: XQZHANG	2021/09/29
			INITIAL REVISION:	DRWN: SCHEN76	2020/04/24
			APPR: YXZHENG	2020/05/13	
			2125200001-SD	PSD	000 B1

TIN PLATING				
CKT SIZE	PART NO.	DIM A	DIM B	DIM C
2	212520-1002	5.40	NA	NA
4	212520-1004	9.60	4.2	2.10
6	212520-1006	13.80	8.40	4.20
8	212520-1008	18.00	12.60	6.30
10	212520-1010	22.20	16.80	8.40
12	212520-1012	26.40	21.00	10.50

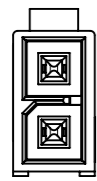

2 CKT

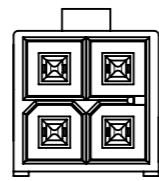

4 CKT

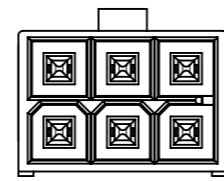

6 CKT

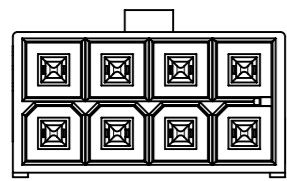

8 CKT

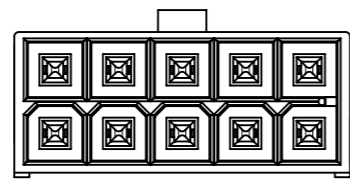

10 CKT

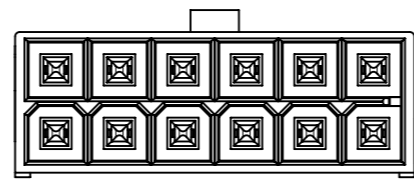

12 CKT

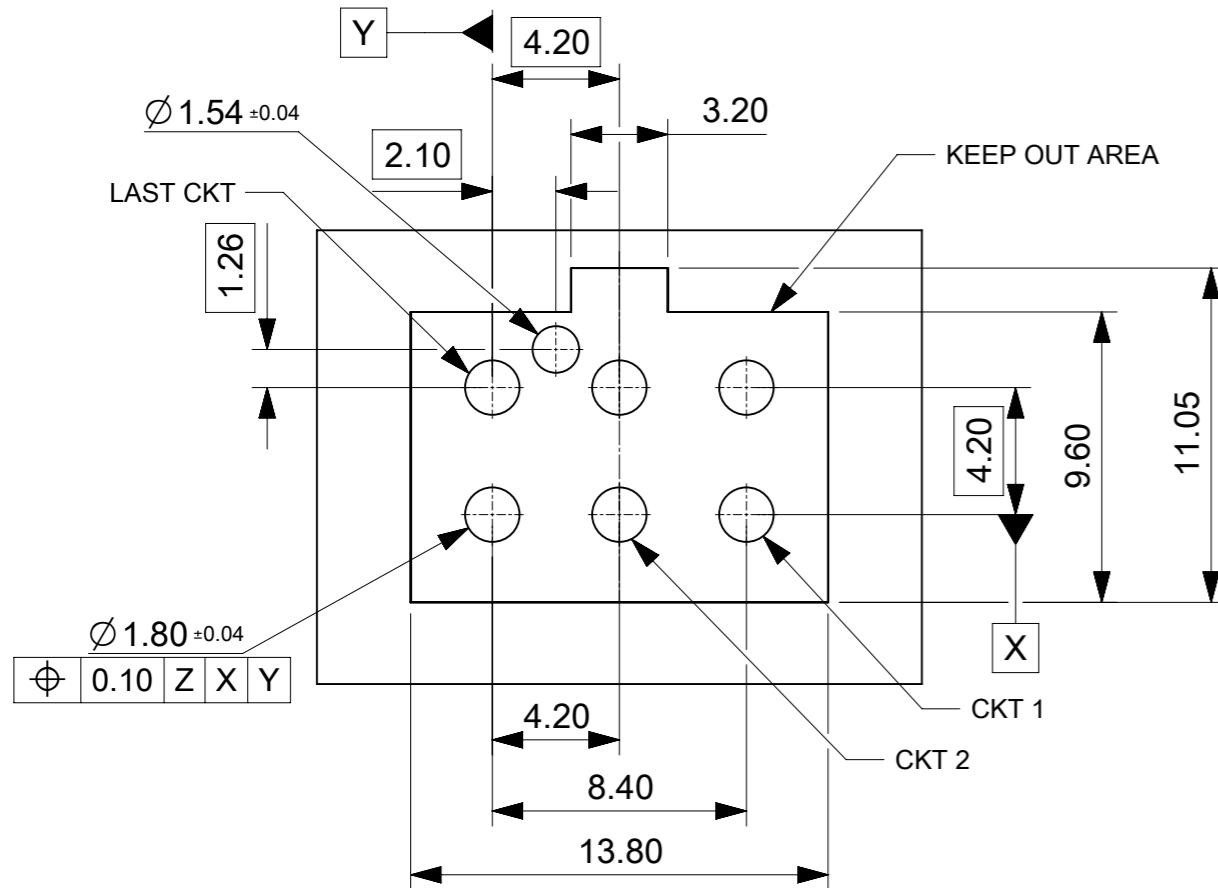

FOR 4 TO 12CKTS

PCB LAYOUT COMPONENT SIDE
RECOMENDED PCB THICKNESS 1.60MM-2.40MM

NOTE: DATUM -Z- IS ON PCB COMPONENT SIDE

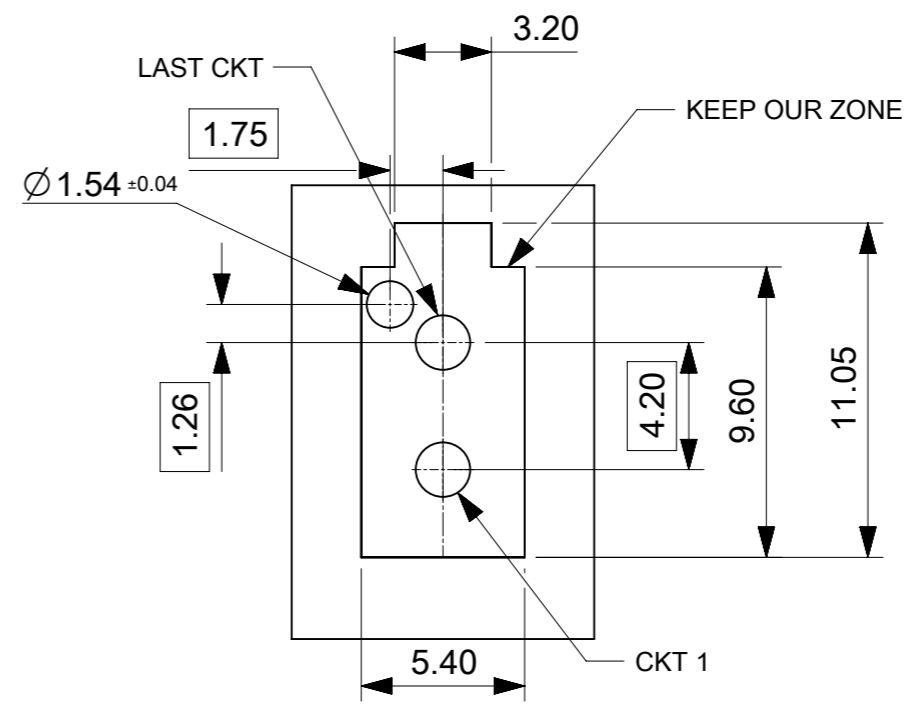

FOR 2CKTS

FUNCTIONAL SYMBOLS	THIS DRAWING CONTAINS INFORMATION THAT IS PROPRIETARY TO MOLEX ELECTRONIC TECHNOLOGIES, LLC AND SHOULD NOT BE USED WITHOUT WRITTEN PERMISSION		CURRENT REV DESC:		molex	
$\nabla_A = 0$ $\nabla_E = 0$ $\nabla_V = 0$	DIMENSION UNITS	SCALE	EC NO: 679543 DRWN: ZIXUAG CHK'D: XQZHANG APPR: XQZHANG			
DIVISIONAL SYMBOLS	mm	4:1	2021/09/28		MINI-FIT MAX DR HDR VERTICAL VERT. HEADER ASSY 2-12 CKT	
	GENERAL TOLERANCES (UNLESS SPECIFIED)		2021/09/29		PRODUCT CUSTOMER DRAWING	
	ANGULAR TOL ± °		2021/09/29		DOCUMENT NUMBER	
	4 PLACES ±		INITIAL REVISION:		DOC TYPE	
	3 PLACES ±		DRWN: SCHEN76		DOC PART	
	2 PLACES ± 0.25		APPR: YXZHENG		REVISION	
	1 PLACE ± 0.5		2020/04/24		2125200001-SD	
	0 PLACES ±		2020/05/13		PSD 000 B1	
DRAFT WHERE APPLICABLE MUST REMAIN WITHIN DIMENSIONS		THIRD ANGLE PROJECTION	DRAWING	SERIES	MATERIAL NUMBER	CUSTOMER
			A3-SIZE	212520	SEE TABLE	GENERAL MARKET
						SHEET NUMBER
						2 OF 2