

SAW Filter 159.01250MHz
Part No: MP07003

Model: TA0942B
Rev No: 1

A. MAXIMUM RATING:

Electronic Sensitive Device (ESD)

1. Input Power Level: 20dBm
2. DC voltage: 5V
3. Operating Temperature: -40°C to +85°C
4. Storage Temperature: -40°C to +85°C

B. ELECTRICAL CHARACTERISTICS:

Item	Unit	Min.	Typ.	Max.
Center Frequency Fc	MHz	-	159.0125	-
Insertion Loss IL min (reference level)	dB	-	1.85	2.8
Bandwidth BW -3dB	MHz	6.025	8.2	-
Absolute Attenuation (reference to IL min dB)				
Fc -50 ~ Fc -30MHz	dB	42	57	-
Fc -30 ~ Fc -15MHz	dB	36	43	-
Fc +30 ~ Fc +50MHz	dB	42	57	-
Source impedance Z _S	Ω	-	50	-
Load impedance Z _L	Ω	-	50	-

Note:

IL min is the minimum of the pass band attenuation. The center frequency Fc is the mean value of the upper and lower frequencies at the 3dB filter attenuation level relative to the IL min.

C. MEASUREMENT CIRCUIT:

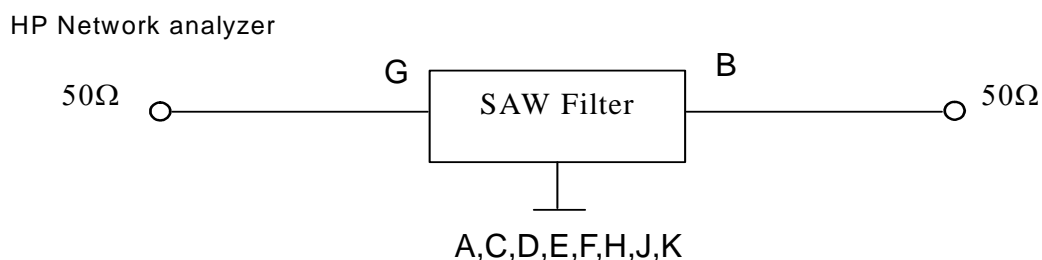

SAW Filter 159.01250MHz
Part No: MP07003

Model: TA0942B
Rev No: 1

D. FREQUENCY CHARACTERISTICS:

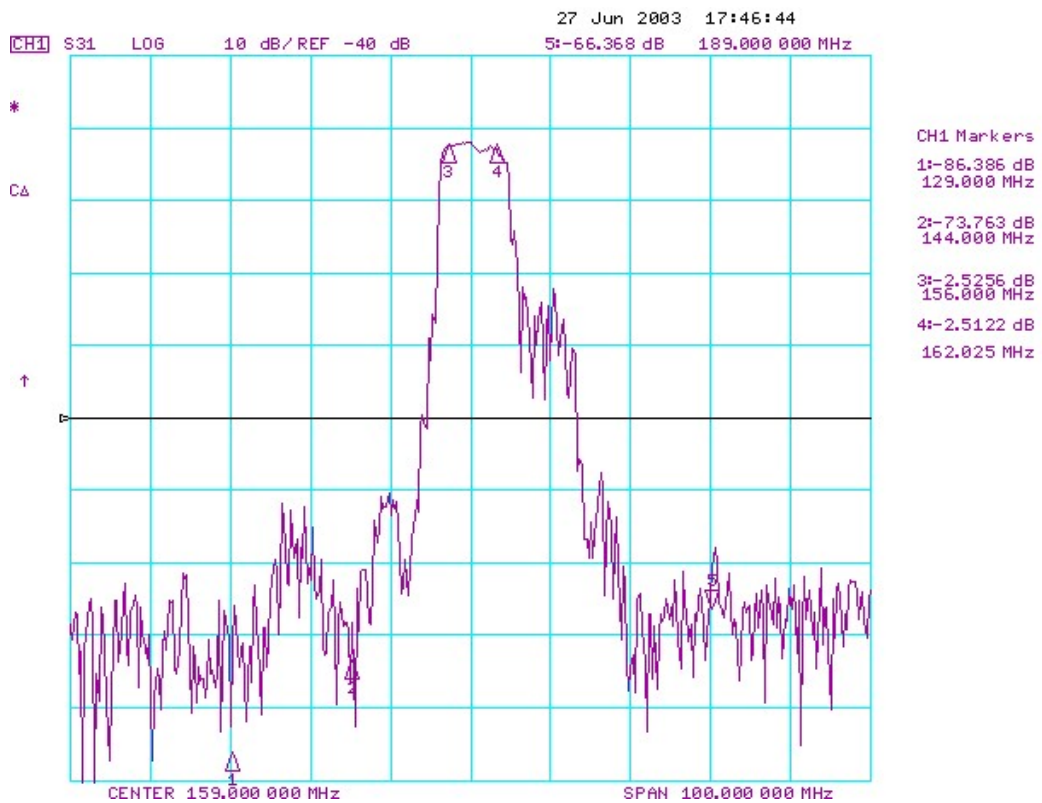
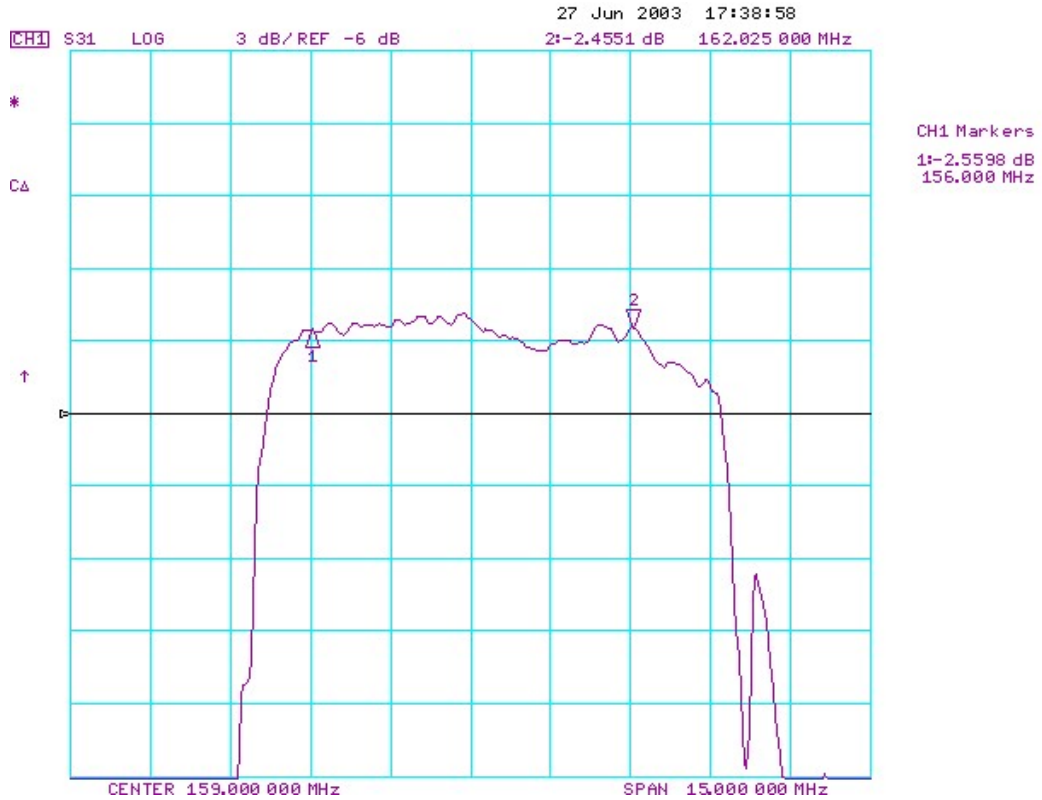

SAW Filter 159.01250MHz
Part No: MP07003

Model: TA0942B
Rev No: 1

E. OUTLINE DRAWING:

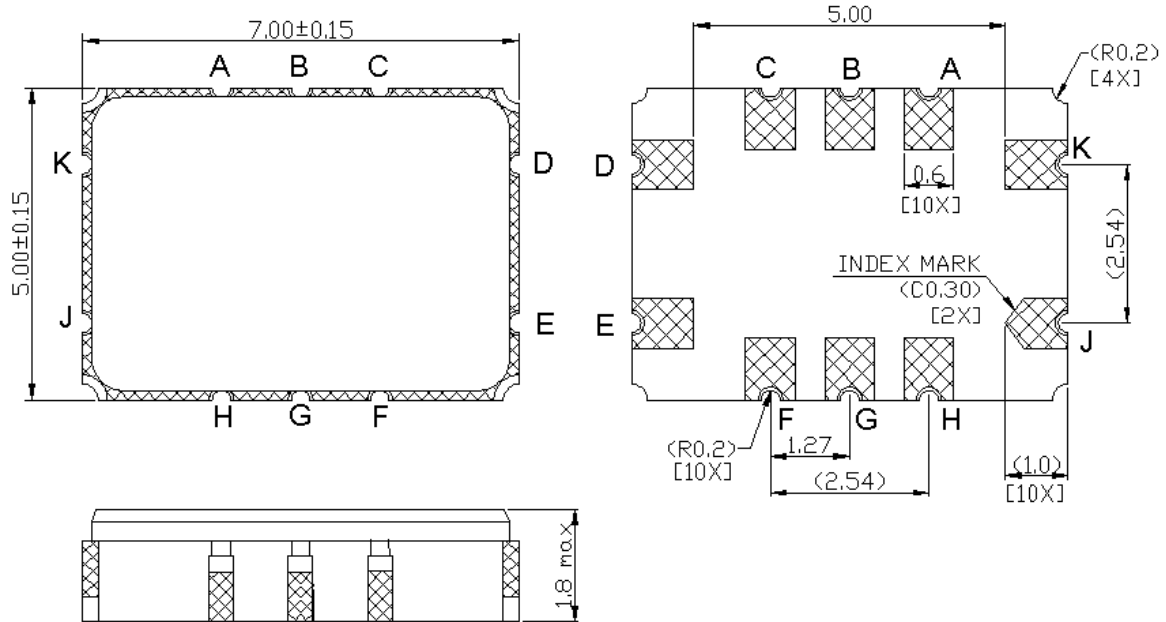

G: Input
B: Output
Unit: mm
A, C, D, E, F, H, J, K: grounded

F. PCB FOOTPRINT:

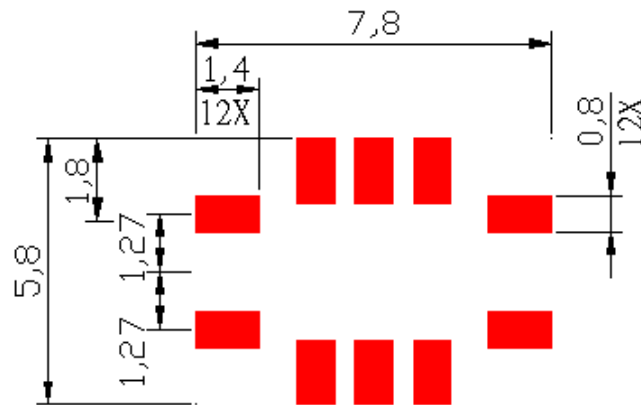

SAW Filter 159.01250MHz
Part No: MP07003

Model: TA0942B
Rev No: 1

G. PACKING:

1. Reel Dimension (Please refer to FR-75D10 for packing quantity)

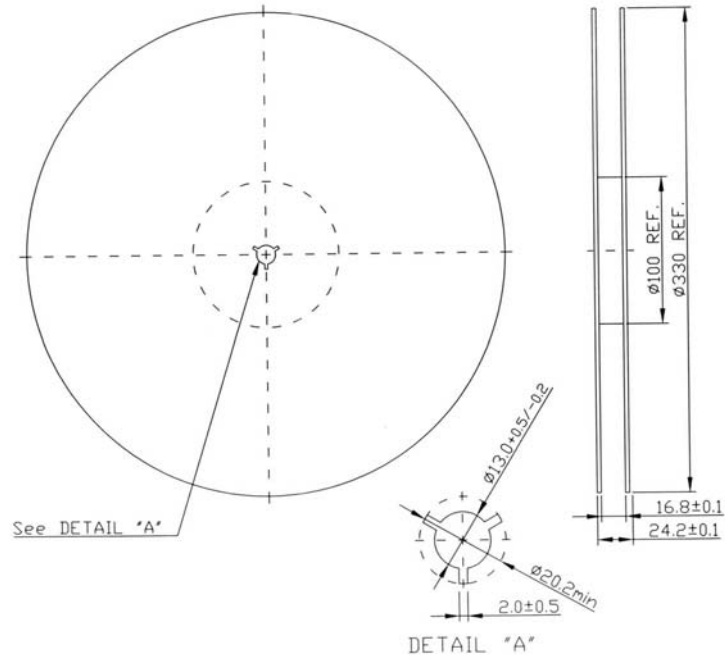

2. Tape Dimension

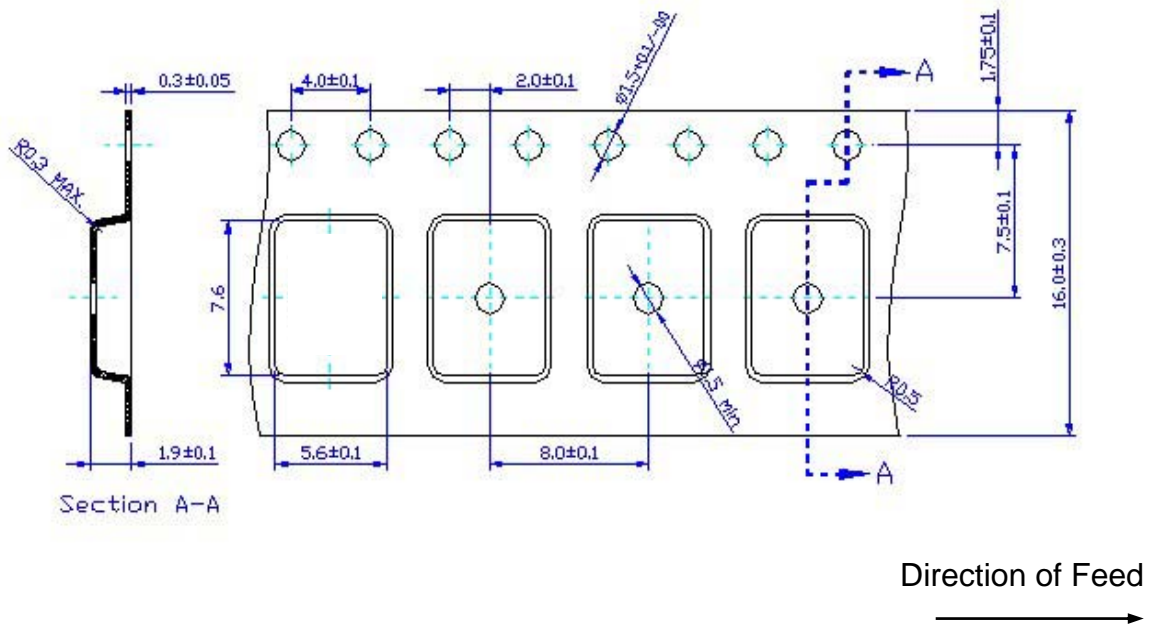

SAW Filter 159.01250MHz
Part No: MP07003

Model: TA0942B
Rev No: 1

H. RECOMMENDED REFLOW PROFILE:

1. Preheating shall be fixed at 150 ~ 180°C for 60 ~ 90 seconds.
2. Ascending time to preheating temperature 150°C shall be 30 seconds min.
3. Heating shall be fixed at 220°C for 50 ~ 80 seconds and at 245 ~ 260°C peak (min. 10 sec).
4. Time: 2 times.

