

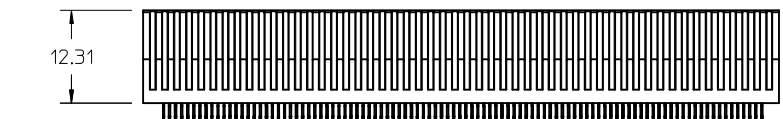

2 BAY EDGE LINE



1 BAY EDGE LINE



LAST CIRCUIT

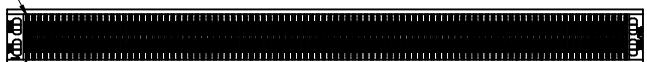

FIRST CIRCUIT

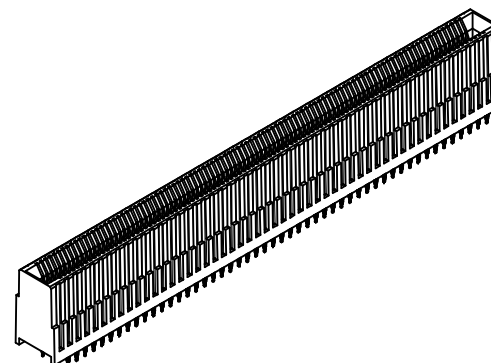
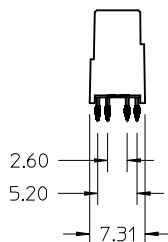

PART NUMBER	VERSION	BAY 1/BAY 2	TOTAL CIRCUITS	DIM A	SALES DRAWING (SEE NOTE 9)
76691-2278	2 BAY	143/132	278	118.63	RSD-76691-2278
76691-1200	1 BAY	200	200	84.20	RSD-76691-1200
76691-2108	2 BAY	86/22	108	50.63	RSD-76691-2108
76691-3108	2 BAY	86/22	108	50.63	RSD-76691-3108
76691-2080	2 BAY	52/28	80	39.43	RSD-76691-111
76691-9046*	1 BAY	46	46	22.60	RSD-76691-109
76691-1046	1 BAY	46	46	22.60	RSD-76691-107

NOTES:

- MATERIAL:  
HOUSING - GLASS FILLED THERMOPLASTIC, 94-VO, BLACK  
TERMINALS - COPPER ALLOY
- FINISH:  
CONTACT AREA: 0.76 MICROMETER MINIMUM HARD GOLD OVER 3.80 MICROMETER NICKEL  
COMPLIANT AREA: 0.76-1.52 MICROMETER TIN OVER 1.27 MICROMETER NICKEL
- REFER TO PS-75594-999 PRODUCT SPECIFICATION FOR ALL ELECTRICAL, MECHANICAL AND ENVIROMENTAL SPECIFICATIONS.
- REFER TO PK-76693-900 FOR ALL PACKAGING SPECIFICATIONS.
- PROCESSING: PRESSFIT TO PC BOARD.
- MATING PC BOARD THICKNESS = 1.60±0.16MM OVER CONTACT PADS.
- THIS PART CONFORMS TO CLASS B REQUIREMENTS OF COSMETIC SPEC PS-45499-002
- FOR EDGE CARD AND MOUNTING PCB LAYOUT DETAIL SEE CORRESPONDING SALES DRAWING.

INITIAL RELEASE EC NO: UCP2015-1097 DRWR:RWHIPPLE 2014/09/15 CHKD:MPOFF 2014/09/15 APPR:SMILLER 2014/09/29	DESCRIPTION REV A	QUALITY SYMBOLS	GENERAL TOLERANCES (UNLESS SPECIFIED)	DIMENSION STYLE MM ONLY	SCALE 2:1	DESIGN UNITS METRIC	THIRD ANGLE PROJECTION
		▽=0	mm INCH	DRAWN BY DATE RWHIPPLE 2014/09/15	TITLE <b>EDGE LINE 12.5GB</b> <b>0.062*PCB 0.8MM PITCH</b>	<b>molex</b>	SHEET NO. 1 OF 1
		▽=0	4 PLACES ± --- ± ---	CHECKED BY DATE MPOFF 2014/09/15			
		▽=0	3 PLACES ± --- ± ---	APPROVED BY DATE SMILLER 2014/09/29			
	2 PLACES ± 0.13 ± ---	MATERIAL NO.					
		1 PLACE ± 0.25 ± ---	ANGULAR ±1/2°	SEE TABLE	DOCUMENT NO.	RSD-76691-100	
		0 PLACE ± --- ± ---	DRAFT WHERE APPLICABLE MUST REMAIN WITHIN DIMENSIONS	SIZE C	THIS DRAWING CONTAINS INFORMATION THAT IS PROPRIETARY TO MOLEX INCORPORATED AND SHOULD NOT BE USED WITHOUT WRITTEN PERMISSION		