

**SAW Filter: 1435.0MHz**  
**Part No: MP05309**

**Model: TA1654A**  
**Rev No: 1**

**A. MAXIMUM RATING:**

Electrostatic Sensitive Device (ESD)

1. Input Power Level: 15dBm
2. DC Voltage: 3V
3. Operating Temperature: -40°C to +85°C
4. Storage Temperature: -40°C to +85°C

**B. ELECTRICAL CHARACTERISTICS:**

1. Terminating source impedance:  $Z_S = 50\Omega$
2. Terminating load impedance:  $Z_L = 50\Omega$

Item	Unit	Min.	Typ.	Max.	Note
Center Frequency Fc	MHz	-	1435	-	-
Max. Insertion Loss (1410 ~ 1460MHz) IL	dB	-	4.2	5.0	-
Passband ripple (1410 ~ 1460MHz)	dB	-	1.7	3.0	-
2dB BW	MHz	50	57	-	-
Group Delay Variation (1410 ~ 1460MHz)	nsec		10	15	
VSWR (1410 ~ 1460MHz)			1.6	2.4	
Source Impedance (single ended)	$\Omega$	-	50	-	-
Load Impedance (single ended)	$\Omega$	-	50	-	-
Attenuation					
D.C ~ 1360MHz	dB	40	46	-	-
1360 ~1385MHz	dB	20	42	-	-
1485 ~ 1565MHz	dB	18	26	-	-
1565 ~ 2900MHz	dB	40	43	-	-
Package size	mm	SMD 3.0x3.0			

**SAW Filter: 1435.0MHz**  
**Part No: MP05309**

**Model: TA1654A**  
**Rev No: 1**

**C. FREQUENCY CHARACTERISTICS:**

1. S21 Response: (span 400MHz)

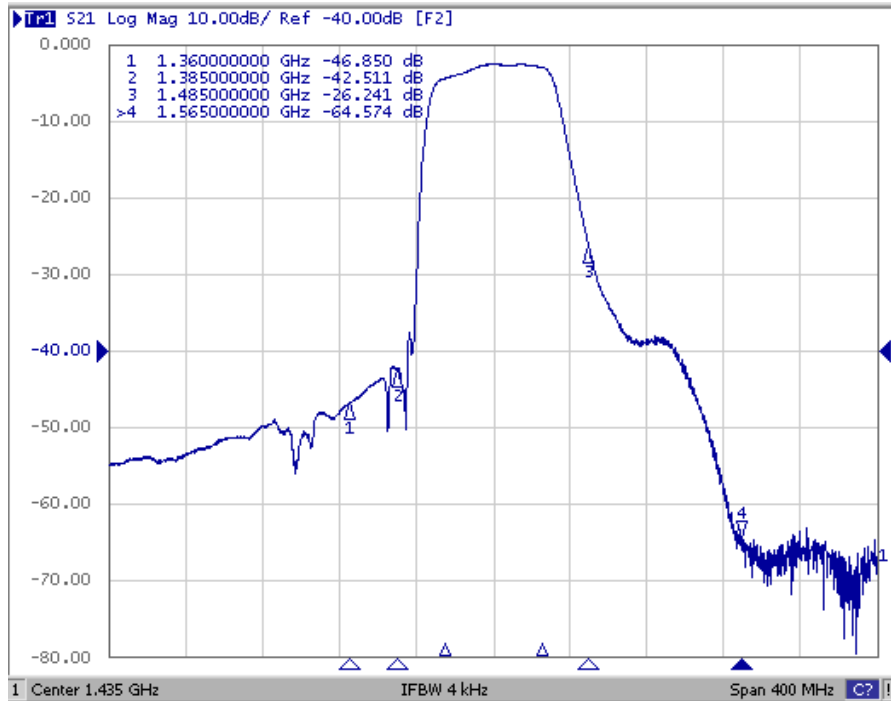

2. Pass band Response: (span 120MHz)

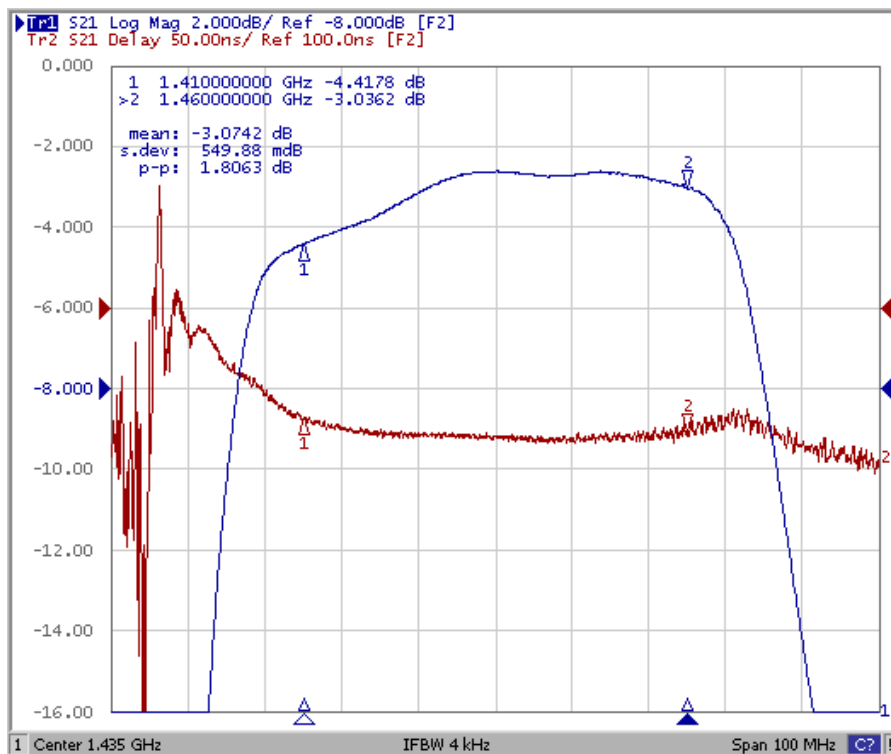

**SAW Filter: 1435.0MHz**  
**Part No: MP05309**

**Model: TA1654A**  
**Rev No: 1**

3. S11 & S22 VSWR Response: (span 100MHz)

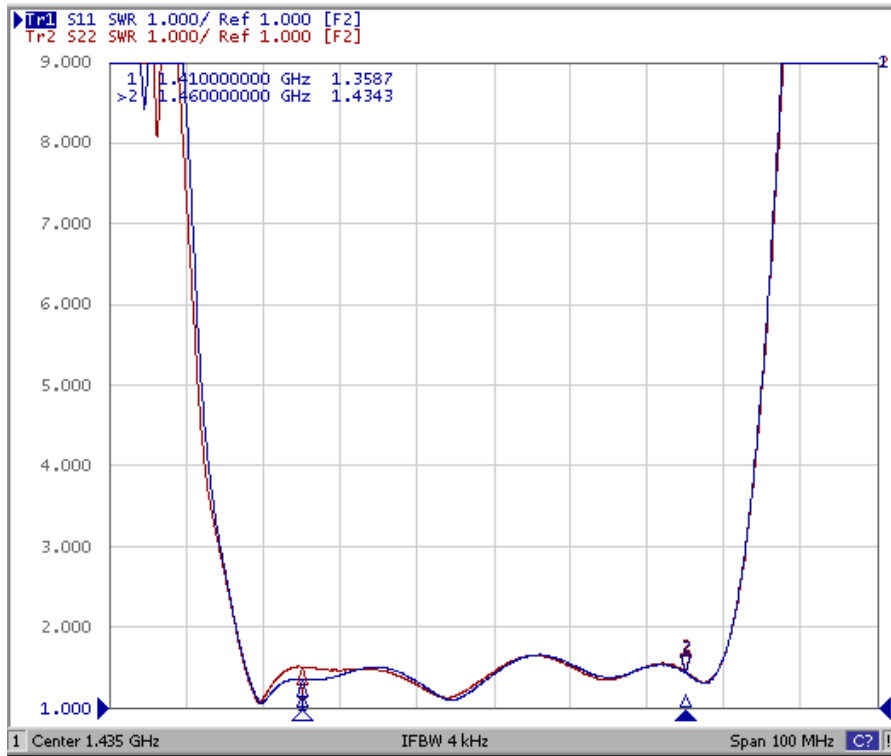

**D. MEASUREMENT CIRCUIT:**

**TESTING ENVIRONMENT**

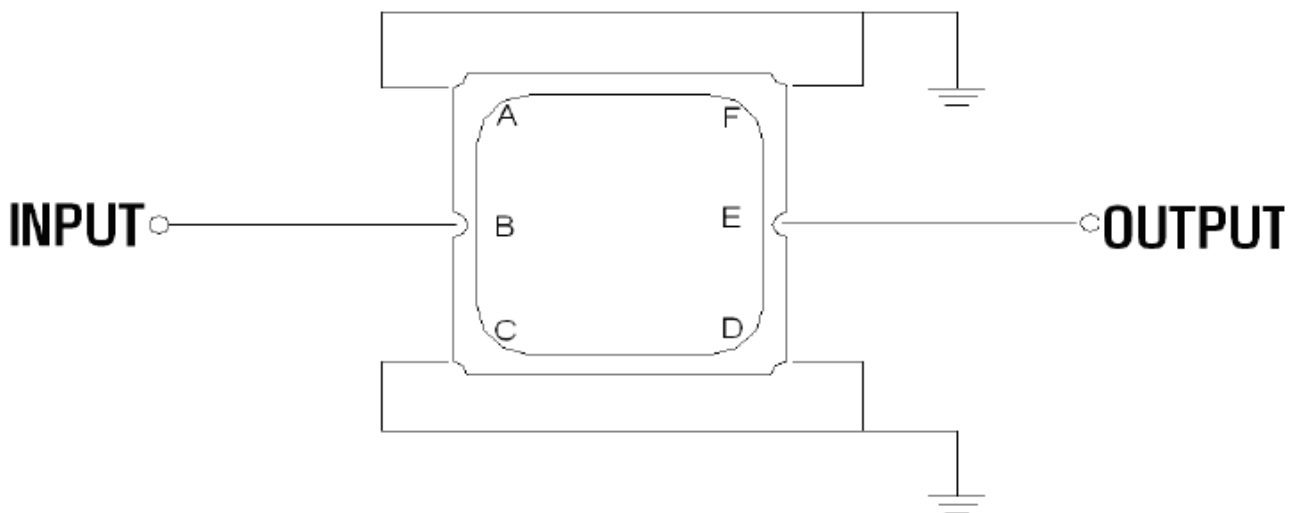

**SAW Filter: 1435.0MHz**  
**Part No: MP05309**

**Model: TA1654A**  
**Rev No: 1**

**E. OUTLINE DRAWING:**

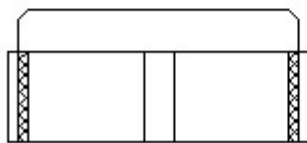
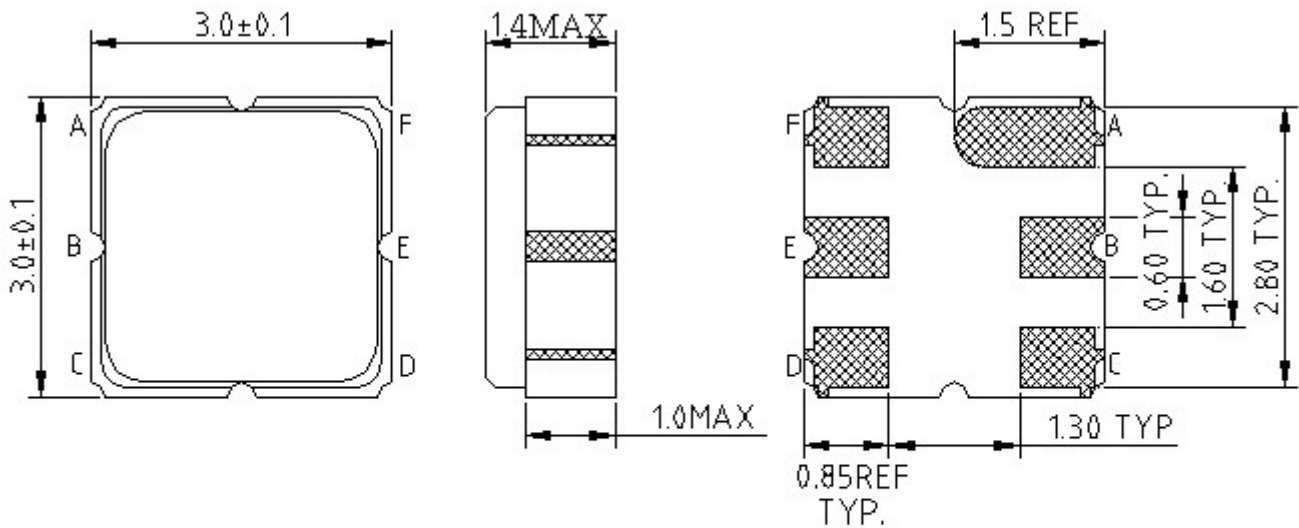

B: Input  
 E: Output  
 A, C, D, F: Ground  
 Unit: mm

**F. PCB FOOTPRINT:**

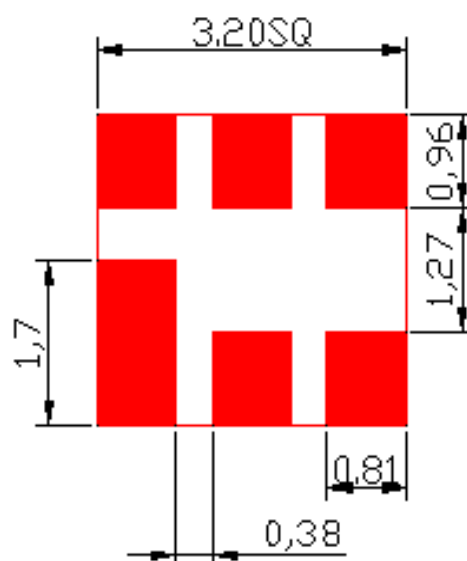

**SAW Filter: 1435.0MHz**  
**Part No: MP05309**

**Model: TA1654A**  
**Rev No: 1**

**G. PACKING:**

1. Reel Dimension

(Please refer to FR-75D10 for packing quantity)

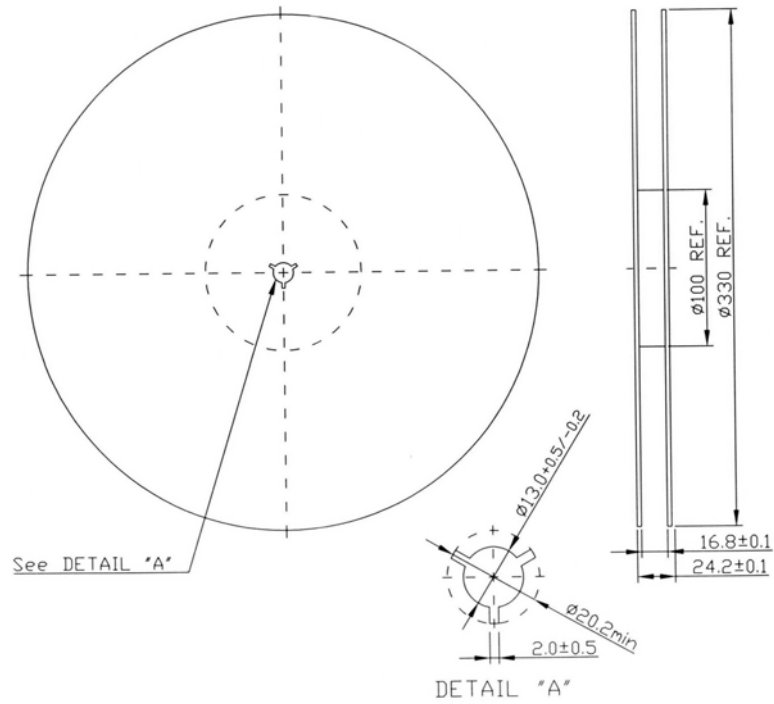

2. Tape Dimension

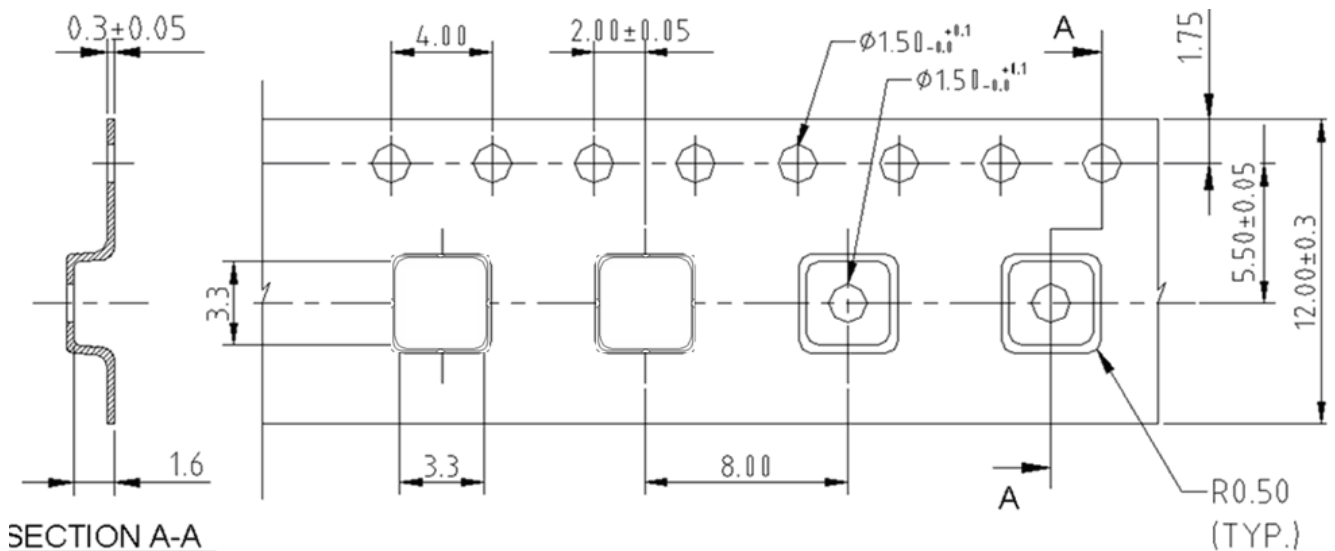

**SAW Filter: 1435.0MHz**  
**Part No: MP05309**

**Model: TA1654A**  
**Rev No: 1**

**H. RECOMMENDED REFLOW PROFILE:**

