

DO NOT SCALE

DIMENSIONS IN MM.

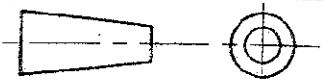

S. C345150.A

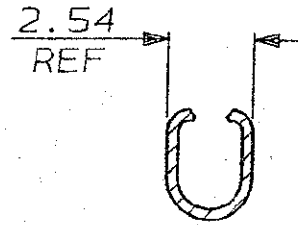
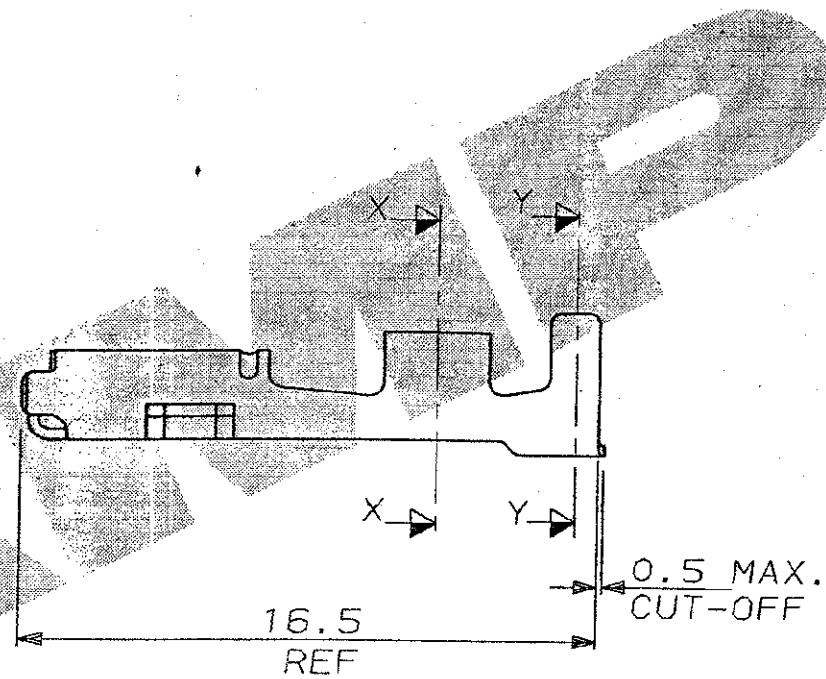

SECTION X-X

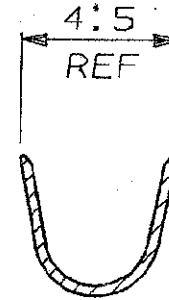

SECTION Y-Y

WIRE RANGE: 0.75 TO 2.00 mm<sup>2</sup>

INSULATION RANGE: 1.65 TO 2.70 mm DIA.

THIN WALLED CABLE TO BE USED

PRODUCT SPEC. 108-3069

APPLICATION SPEC. 114-3040

H/TOOL PN.525317-2 (FOR 0.75-1.0mm<sup>2</sup> WIRES).

H/TOOL PN.525317-4 (FOR 1.5-2.0mm<sup>2</sup> WIRES).

SEALED APPLICATIONS ONLY.

PRE-TINNED BRASS		MADE FROM STRIP PN.345806-1		345150-1	
FINISH		MATERIAL		PART NUMBER	
CUSTOMER DWG FOR REFERENCE ONLY		© COPYRIGHT 1991 BY AMP OF GREAT BRITAIN LTD. ALL INTERNATIONAL RIGHTS RESERVED. ALL PRODUCTS MAY BE COVERED BY BRITISH AND FOREIGN PATENTS AND/OR PATENTS PENDING.		RELEASED FOR PUBLICATION 02 JUL 1991	
		TOLERANCES UNLESS OTHERWISE STATED DEC ± 0.5 ANGLES ± 1°		DR. R.J.S. 2.7.91 CH. M.McG. APP. J.P.	
		NAME LOOSE PIECE .070" RECEPTACLE ECONOSEAL 3 L.C. (SEALED)		AMP of Great Britain Ltd. TERMINAL HOUSE STANMORE MIDDX.	
A E500-0041-01 14.02.91		SCALE LOC SIZE DWG.No.		REV SHEET	
1 PRELIM. ISSUE 2.7.91		5/1 E A3 C345150		A 1/1	
REV APPROVED ECN DATE					