

ITEM NO.	PART NUMBER	DESCRIPTION	QTY.	COMPONENT NOTES
1	50-00525	Connector, dc plug, 5.5x2.5xL18.5 mm, molding style, spring contacts, white insulators	1	
2	30-00405	Wire, 2C TS, 24 AWG, UL2468, 300V, 80C, 3.0 mm, VW-1, PVC, 87A, white	1	
3	24-00006	Overmold, PVC, white	1	

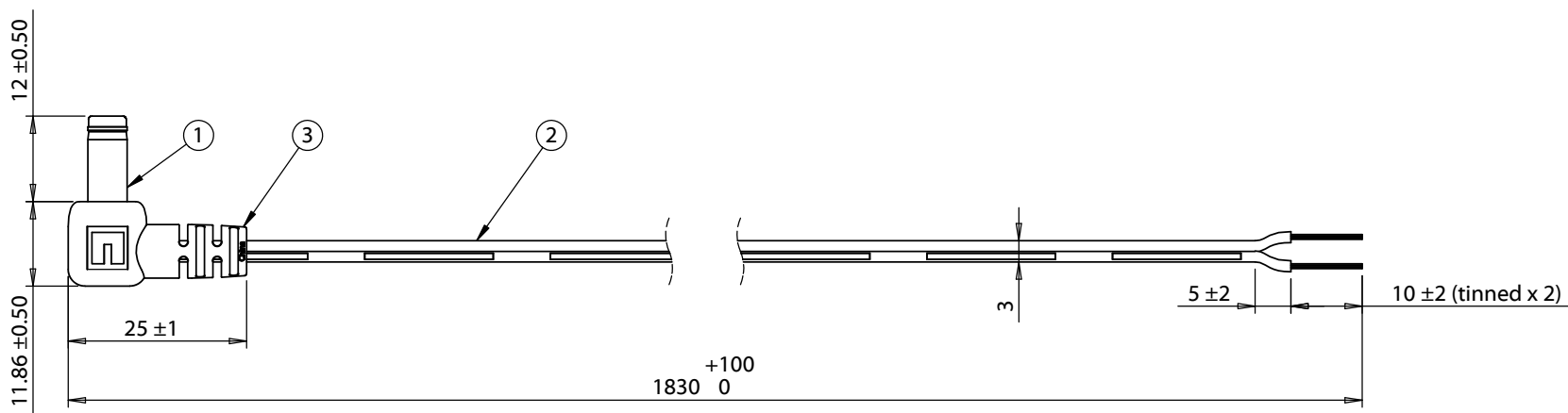
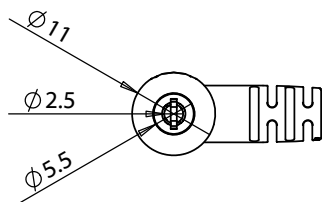

Notes:

Cables individually tied and bundled in groups of 10

Functionally equivalent components may be substituted

4 A, 12 Vdc

Wiring Diagram	
50-00525	wire color
center	white with stripe
sleeve	white

Revision:	Date:	Description:	Prepared:	Notes:	<h1>TENSILITY</h1> tel 1.541.323.3228 800 877.670.7118 fax 1.541.323.4202 web tensility.com
A	12/11/2015	Initial release	GL 2016.06.16 12:20:21 -07'00'		
			Verified:	Function test: no open, no short circuit, no intermittent	Size: Part number: A 10-01240
			LA Digitally signed by LA DN: cn=LA, o=Tensility ou=Engineering, email=la@tensility.com, c=US Date: 2016.06.21 14:56:10 -07'00'		
			Dimensions are in millimeters. Tolerances: X: ± 0.5 mm X.X: ± 0.3 mm X.XX: ± 0.05 mm	Description: Cable, 1830 mm, 5.5x2.5x12 mm 90° 50-00525 dc plug to stripped tinned, 24 AWG, 30-00405 wire, white	Scale: 1:2

