

CODINGS

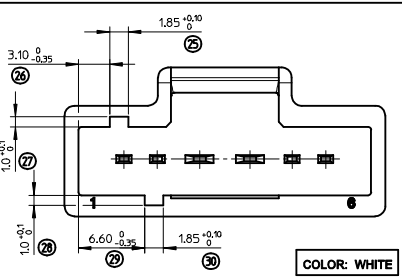

OVERALL DIMENSIONS

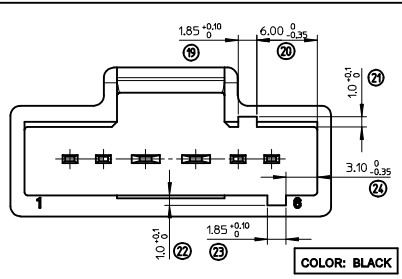
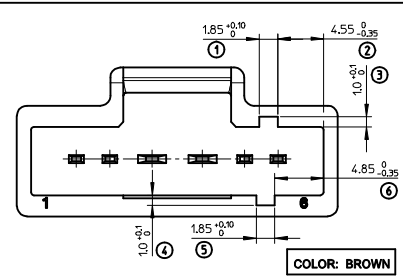
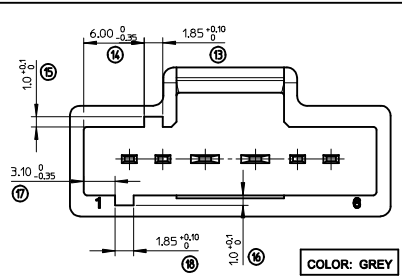
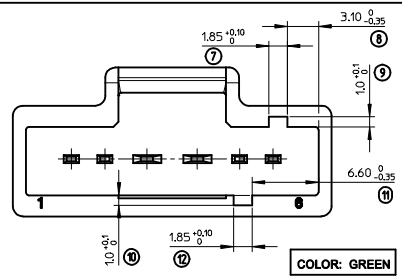
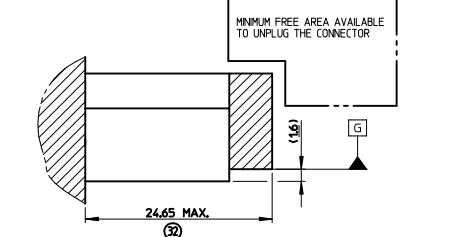
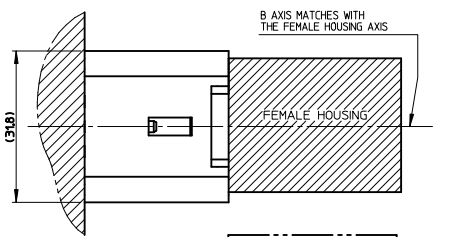
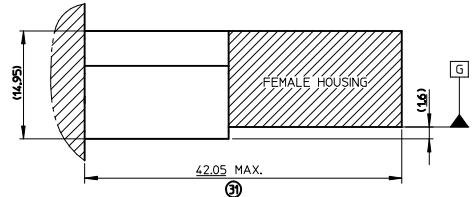

HEADER'S DEFINITION

(GREEN CODING REPRESENTED)

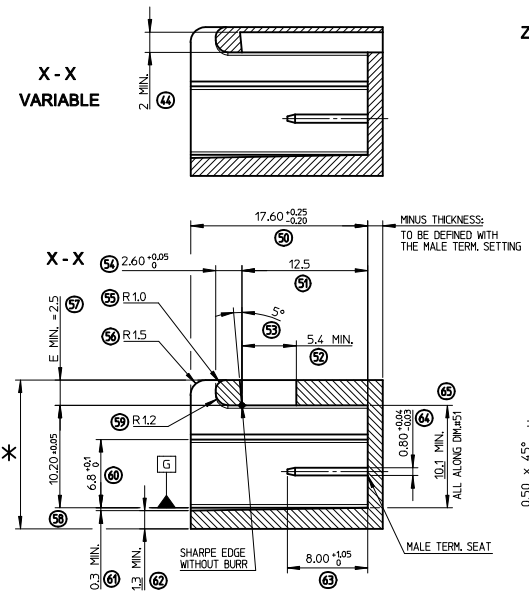

Z - Z

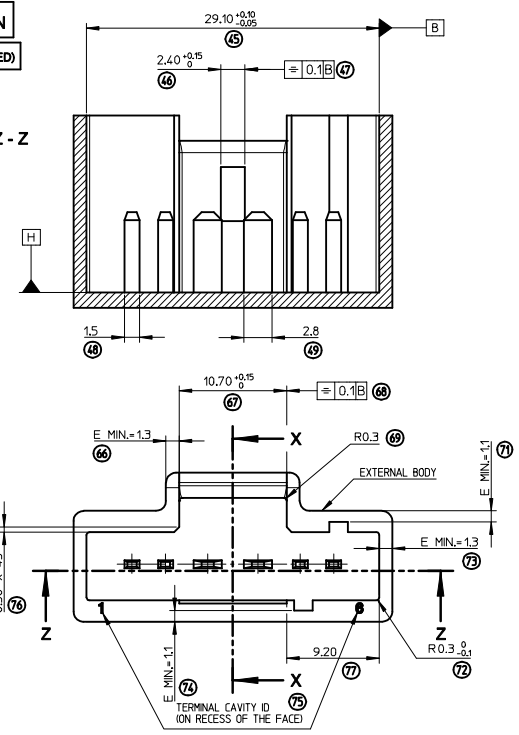

ISO VIEW (GREEN CODING)

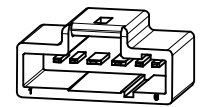

NOTES:

- MALE TERMINALS:**
 - MALE TERMINALS RESISTANCE: 100N MIN IN MALE TERM. AXIS.
 - MATERIAL: COPPER, COPPER ALLOY OR BRASS.
 - FINISHES: TIN PLATED 2µ MIN.
- HEADER:**
 - RADII WITHOUT DIM: R=0.3MM
 - E MIN: MINIMUM MATERIAL THICKNESS RECOMMENDED FOR SPECIFIED MATERIAL
 - MATERIAL: PBT (RECOMMENDED) (70)
 - * WARNING: 0.35MM MAX. ACCEPTED ON "*" DIM. WITH ANOTHER EXTERNAL SHAPE AS DRAWN WHEN PLUGGED.
- MATES WITH:**
 - MOLEX CONNECTORS 98821-106X

MALE TERMINALS SETTING

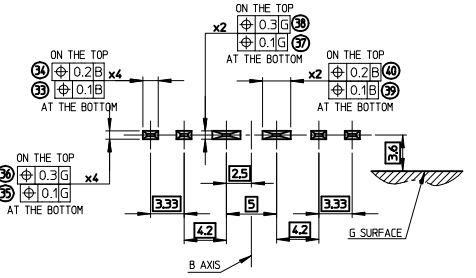

MALE TERMINALS VARIABLE SETTING

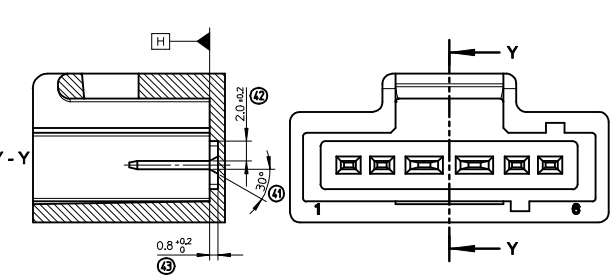

REV.	FIRST	LAST	DELETED	SUPERSEDED
	1	76		

INSPECTION NUMBERS

PRINT 1st RELEASE EC NO: G2012-0184 DRAWING DESIGNS: 2012/04/23 CHK'D: JUDUCLOS 2012/04/24 APPR'D: PLESSIS 2012/05/02	QUALITY SYMBOLS ▽+0 ▽-0 ▽-0	GENERAL TOLERANCES (UNLESS SPECIFIED) 4 PLACES ± --- ± --- 3 PLACES ± --- ± --- 2 PLACES ± 0.1 ± --- 1 PLACE ± 0.1 ± --- 0 PLACE ± --- ± ---	DIMENSION STYLE MM ONLY	SCALE 4:1	DESIGN UNITS METRIC	FIRST ANGLE PROJECTION
		DRAFT WHERE APPLICABLE MUST REMAIN WITHIN DIMENSIONS	MATERIAL NO. N/A	DRAWN BY ASHOOR 1996/12/20	CHECKED BY JUDUCLOS 2007/12/13	APPROVED BY DPLESSIS 2012/05/02

E D1 D C B A /	PRINT REDRAWN AND ASSOCIATED WITH 3D MODELS. FRENCH TEXTS REMOVED. RE-NUMBERED BALLONS. NEW MOLEX TITLE BLOCK (4 RE-PAGED). DRAWING SPEC. N°26 REDRAWN WITH MOLEX ID ISO-98820-002 R12 +0.1 WAS R0.5 +0.10 TO BE RESPECTED ON HEADERS. BROWN CODING ADDED. E-E SECTION: 0.3 MIN. (AND DRAFT) WAS 0.3 0/-0.1 MALE TERMINALS TOLERANCES AND SETTING UPDATED. 29.1 +0.10 -> 29.1 +0.1/-0.05 7 0/-0.1 -> 7 MAX DM: 0.1 MIN. ADDED ALL ALONG DIM. 12.5 3.1 0/-0.1 -> 3.1 0/-0.35 6.6 0/-0.1 -> 6.6 0/-0.35 6.1 0/-0.1 -> 6.1 0/-0.35	DRAWING GENERATED WITH SPEC. N°27 REV. B WITH CODINGS UPDATED AND LIGHTNESS CAVITIES REMOVED.
REV.	MODIFICATIONS	DOCUMENT NO. SD-98820-002



THIS DRAWING CONTAINS INFORMATION THAT IS PROPRIETARY TO MOLEX INCORPORATED AND SHOULD NOT BE USED WITHOUT WRITTEN PERMISSION

MOLEX P/N°: 0988211060
COLOUR: WHITE

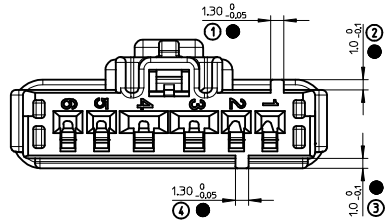

MOLEX P/N°: 0988211061
COLOUR: BLACK

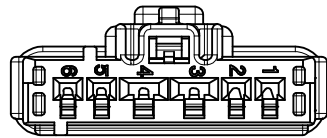

MOLEX P/N°: 0988211065
COLOUR: GREEN

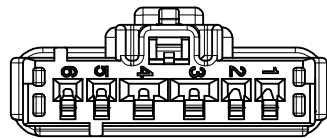

MOLEX P/N°: 0988211068
COLOUR: GREY

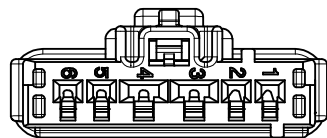

MOLEX P/N°: 0988211069
COLOUR: BROWN

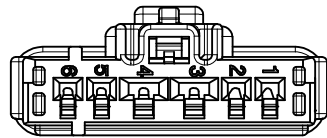

CAVITIES PITCH
5:1

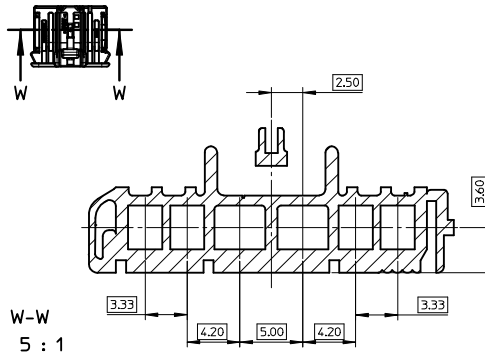

HOLDING IN FIXTURE
DIMENSION PRIOR TO LOCKING
2:1

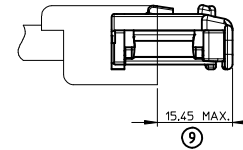

DIMENSION WHEN CONNECTOR MATED
2:1

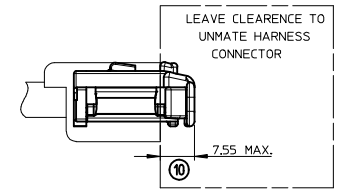

CLEARANCE FOR CONNECTOR MATED AND UNMATED
2:1

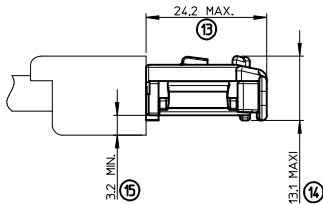
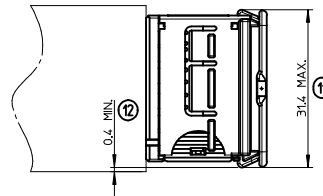

HOLDING IN FIXTURE
2:1

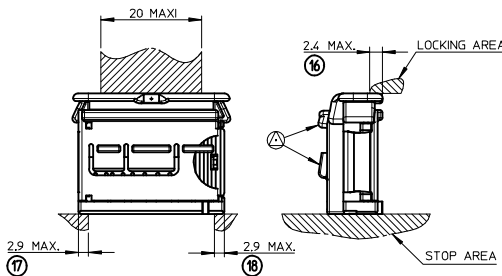

		MOLEX P/N	
SCC RCPT TERM 1.5 MM	RANGE 1	0988971109	
	RANGE 2	0988971119	
	RANGE 3	0988971129	
TERM RCPT 2.8 MM UCC2	RANGE 1		0988981029
	RANGE 2		0988981039
	RANGE 3		0988981049

INDICATION DIMENSIONS S.P.C DENOTES S.P.C DIMENSIONS
 INDICATION DIMENSIONS CRITIQUES DENOTES CRITIQUES DIMENSIONS
 INDICATION DIMENSIONS FONCTIONNELLES DENOTES FUNCTIONNELLES DIMENSIONS
 QUANTITE PAR FEUILLE INDIVIDUELLE
 QUANTITY PER INDIVIDUAL SHEET
 = 0 = 0 = 4

- FEMALE CONNECTOR WILL MATE WITH MALE CONNECTOR P/N 098825106x OR HEADER P/N 098770201X

- THE USING CONDITIONS OF THE HINGE ARE SHOWN IN THE MOLEX SPECIFICATION N°: AS-98821-001.

- HOLDING FORCE ONTO FIXTURE:
20 TO 35 NEWTON WITH PUSH TEST.
10 TO 35 NEWTON WITHOUT PUSH TEST.

- DO NOT LOCK THE FIXTURE WITH THE AREAS IDENTIFIED BY: (16)

- DO NOT DAMAGE THE PART ON THE AREAS IDENTIFIED BY: (17)

- FEMALE TERMINAL USED: SEE CHART BELOW.

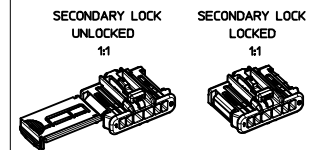

REVISED IEC NO: G2013-030 0000-0103 C DRAWINGS: BRUIERES 2013/04/26 CHYKOLBARRETO 2013/04/26 APPROPRIETES 2013/09/12	QUALITY SYMBOLS DESCRIPTION	GENERAL TOLERANCES (UNLESS SPECIFIED)		DIMENSION STYLE MM ONLY		SCALE 4:1	DESIGN UNITS METRIC	FIRST ANGLE PROJECTION	
		m	INCH	DRAWN BY LPOUCHAUD	DATE 2007/12/05	TITLE UCC RCPT CONN HYBRID UNSEALD 6CKT			
		4 PLACES ± --- ± ---		CHECKED BY YIGEL	DATE 2007/12/12	DOCUMENT NO. SD-98821-002			
		3 PLACES ± --- ± ---		APPROVED BY LSTICKEIR	DATE 2007/12/17	SHEET NO. 1 OF 2			
		ANGULAR ± 1 °		SEE CHART		THIS DRAWING CONTAINS INFORMATION THAT IS PROPRIETARY TO MOLEX INCORPORATED AND SHOULD NOT BE USED WITHOUT WRITTEN PERMISSION			

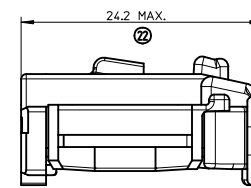
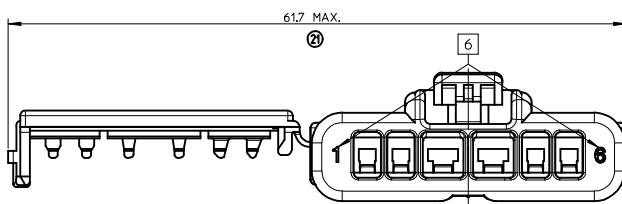
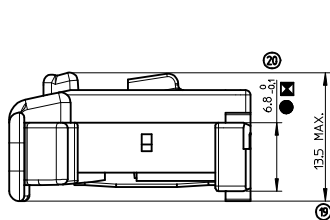

SECONDARY LOCK
UNLOCKED

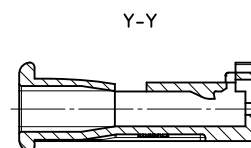
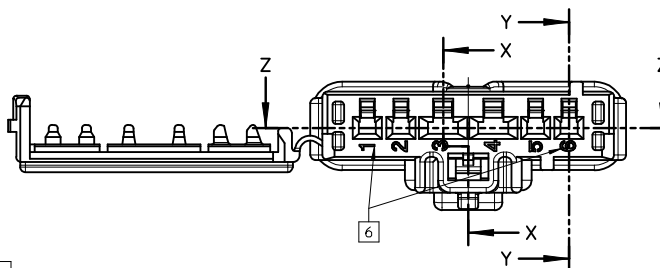
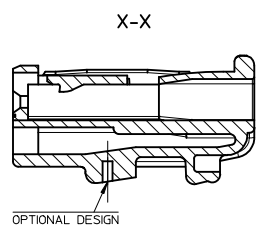
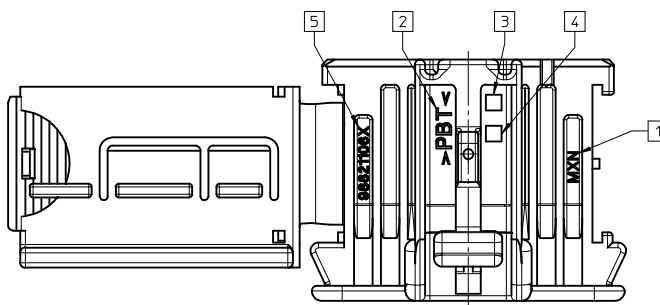

SECONDARY LOCK
LOCKED

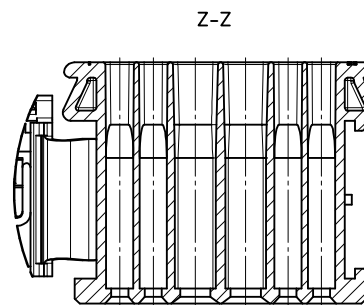
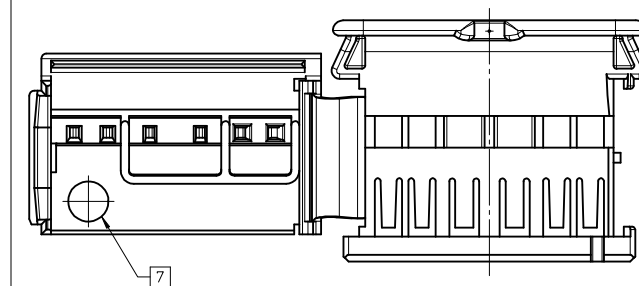
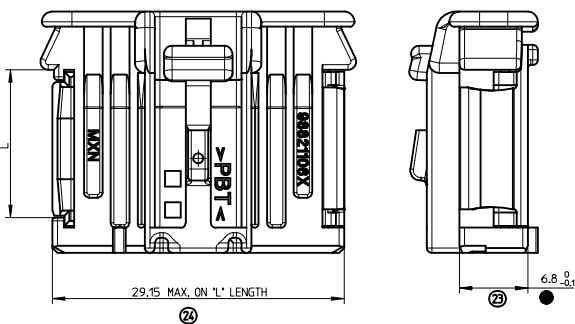

- FEMALE CONTACTS AND CAVITIES LOCATION,
HOLDING IN FIXTURE, OVERALL DIMENSIONS,
KEY ACCORDING SHEET 1/2 OF SAME P/N°.

MARKINGS:

- 1 - SUPPLIER MFG. PLANT ID.
- 2 - MATERIAL
- 3 - MOLD CAVITY ID.
- 4 - SUPPLIER MOLD REV. LEVEL
- 5 - SUPPLIER P/N°
- 6 - TERM. CAVITY N°
- 7 - DATUM: MONTH/YEAR

1 : 1



[X] INDICATION DIMENSIONS S.P.C
 DENOTES S.P.C DIMENSIONS
 [O] INDICATION DIMENSIONS CRITIQUES
 DENOTES CRITIQUES DIMENSIONS
 [●] INDICATION DIMENSIONS FONCTIONNELLES
 DENOTES FUNCTIONNELLES DIMENSIONS
 QUANTITE PAR FEUILLE INDIVIDUELLE
 QUANTITY PER INDIVIDUAL SHEET
 [X] = 1 [O] = 0 [●] = 2

DESCRIPTION	P/N°	COLOUR	MATERIAL	EFFECTIVE WEIGHT
UCC RCPT CONN HYBRID UNSEALED 6CKT	0988211069	BROWN	PBT	3.480 g
	0988211068	GREY		
	0988211065	GREEN		
	0988211060	WHITE		
	0988211061	BLACK		

REVISED
 E.C. NO: G2013-0330
 DRAWING: BRVIERES 2013/04/26
 CHK: BARRETO 2013/04/26
 APPR: PLESSIS 2013/09/12

QUALITY SYMBOLS	GENERAL TOLERANCES (UNLESS SPECIFIED)	
	mm	INCH
4 PLACES	± 0.10	± 0.004
3 PLACES	± 0.15	± 0.006
2 PLACES	± 0.20	± 0.008
1 PLACE	± 0.30	± 0.012
0 PLACE	± 0.40	± 0.016

ANGULAR ± 1°
 DRAFT WHERE APPLICABLE
 MUST REMAIN WITHIN DIMENSIONS

DIMENSION STYLE	
MM ONLY	
DRAWN BY	DATE
LPOUCHAUD	2007/12/05
CHECKED BY	DATE
YIGEL	2007/12/12
APPROVED BY	DATE
LSTICKEIR	2007/12/17
MATERIAL NO.	
SEE CHART	

SCALE	DESIGN UNITS	FIRST ANGLE PROJECTION	TITLE
4:1	METRIC	[Symbol]	UCC RCPT CONN HYBRID UNSEALED 6CKT
DOCUMENT NO.			SHEET NO.
SD-98821-002			2 OF 2
THIS DRAWING CONTAINS INFORMATION THAT IS PROPRIETARY TO MOLEX INCORPORATED AND SHOULD NOT BE USED WITHOUT WRITTEN PERMISSION			