

## FLLE2006AQDB

Aliases (LLE2006AQDB)

KEMET, FLLE2-Q, EMI/RFI Filters, Noise Suppression, 300 VAC, 300 V, 6 A, 51x45x19mm

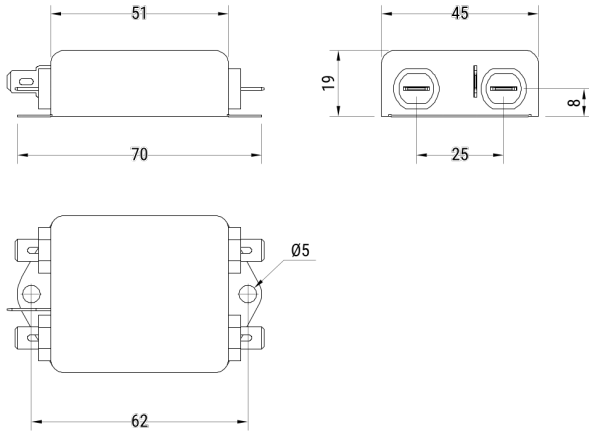

Click [here](#) for the 3D model.

### Dimensions

L	51mm MIN
W	45mm MIN
H	19mm MIN

### Packaging Specifications

Packaging	Bulk
Packaging Quantity	1
Component Weight	95 g

### General Information

Series	FLLE2-Q
Style	Chassis Mount
Description	Single Phase, Chassis Mount Filters
Features	Single Phase
Phase	Single-phase
RoHS	Yes
Qualifications	IEC/EN 60939, UL, CSA
Terminal Type	Faston

### Specifications

Voltage AC	300 VAC
Voltage DC	300 VDC
Rated Frequency	50-60 Hz
Rated Current	6 A
Rated Temperature	40°C
Temperature Range	-25/+100°C
Climate Category	25/100/21
Leakage Current	0.37 mA (MAX)
Test Voltage DC (P/N to E)	2250 VDC
Test Voltage DC (P to N)	1300 VDC