

Number of contacts

6-64

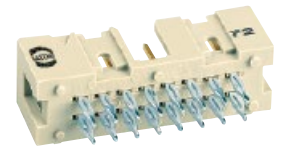

Low-profile male header, straight press-in pins

Identification	No. of contacts	Part number	Drawing	Dimensions in mm
----------------	-----------------	-------------	---------	------------------

Low-profile male header with straight press-in terminations
Length: 5.5 mm

6	09 18 506 □ 329
10	09 18 510 □ 329
14	09 18 514 □ 329
16	09 18 516 □ 329
20	09 18 520 □ 329
26	09 18 526 □ 329
34	09 18 534 □ 329
40	09 18 540 □ 329
50	09 18 550 □ 329
60	09 18 560 □ 329
64	09 18 564 □ 329

No. of contacts	A	B	E
6	15.2	12.78	2.54 x 2 = 5.08
10	20.3	17.86	2.54 x 4 = 10.16
14	25.4	22.94	2.54 x 6 = 15.24
16	27.9	25.48	2.54 x 7 = 17.78
20	33.0	30.56	2.54 x 9 = 22.86
26	40.6	38.18	2.54 x 12 = 30.48
34	50.8	48.34	2.54 x 16 = 40.64
40	58.4	55.96	2.54 x 19 = 48.26
50	71.3	68.66	2.54 x 24 = 60.96
60	84.0	81.36	2.54 x 29 = 73.66
64	89.1	86.44	2.54 x 31 = 78.74

Marking No. 1 contact

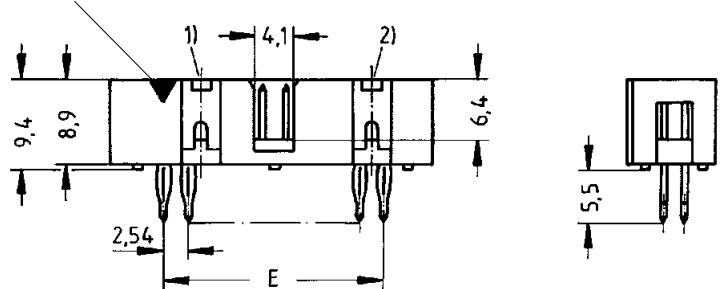

No. 2 contact

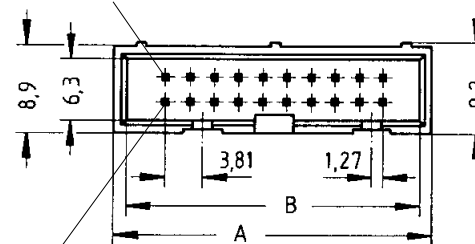

No. 1 contact

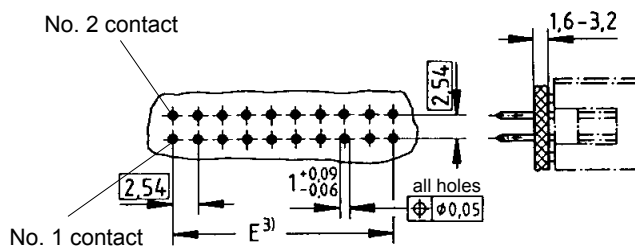

Board drillings

For Performance Level 3 please specify digit 7
For Performance Level 2 please specify digit 6
S4 = 0.76 μm (30 μinch) Au or PdNi equivalent



Not normally kept in stock

- 1) No polarization slot for 6, 10 or 14 way
- 2) No polarization slot for 6 way
- 3) Pitch tolerance: ± 0.1