

Chip Inductor AWHH Series

**Automotive
AEC-Q200**

RoHS Compliant
Halogen Free
REACH Compliant



- RF
Circuit
- Unshield
- Wire
Wound
- Ceramic
- High
Q

Part Numbering

A	WHH	00	161108	10N	H	00	
Grade	Series Name	Control Code	Dimensions Code (mm)	Inductance (nH)	Tolerance		Internal Code
			161108 1.6x1.12x0.82	3N3 3.3 10N 10	H ±3% J ±5%		

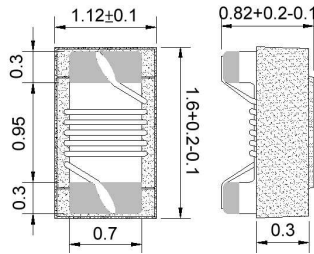
AWHH00161108 Type
■ Dimensions

unit:mm

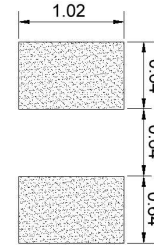
■ Recommended Land Pattern

unit:mm

■ Electrical Characteristics

Part No.	Inductance (nH)	L/Q Test		Q Typ.	SRF (GHz)Typ.	RDC (Ω)Max.	I _{rms} (mA)Max.	Tolerance
		Freq. (MHz)						
AWHH001611083N3□00	3.3	250/250		36	9.6	0.034	1900	5,3
AWHH001611083N6□00	3.6	250/250		28	9.7	0.04	1900	5,3
AWHH001611085N1□00	5.1	250/250		38	8.9	0.042	1700	5,3
AWHH001611085N6□00	5.6	250/250		35	6.6	0.042	1700	5,3
AWHH001611086N0□00	6	250/250		49	6	0.042	1700	5,3
AWHH001611088N2□00	8.2	250/250		40	5.9	0.054	1400	5,3
AWHH001611088N7□00	8.7	250/250		46	5.5	0.054	1400	5,3
AWHH001611089N1□00	9.1	250/250		40	5.1	0.052	1400	5,3
AWHH001611089N5□00	9.5	250/250		42	4.9	0.054	1400	5,3
AWHH0016110810N□00	10	250/250		44	4.3	0.054	1400	5,3
AWHH0016110812N□00	12	250/250		40	4.1	0.088	1100	5,3
AWHH0016110818N□00	18	250/250		45	3.3	0.082	1200	5,3

Note: When ordering, please specify tolerance code. Tolerance: H=±3% / J=±5%

- Operating temperature range - 40°C ~ 125°C(Including self - temperature rise)
- I_{rms} for a 15°C temperature rise from 25°C ambient.
- Measure Equipment:
 L & Q: Agilent E4991A+Agilent HP16197A
 SRF: Agilent E5071C
 RDC: Chroma 16502
 I_{rms}: HP4284A+HP42841A/HP4285A+HP42841A

AWHH00161108 Type

Characteristics Graph

Inductance vs. Frequency Characteristics

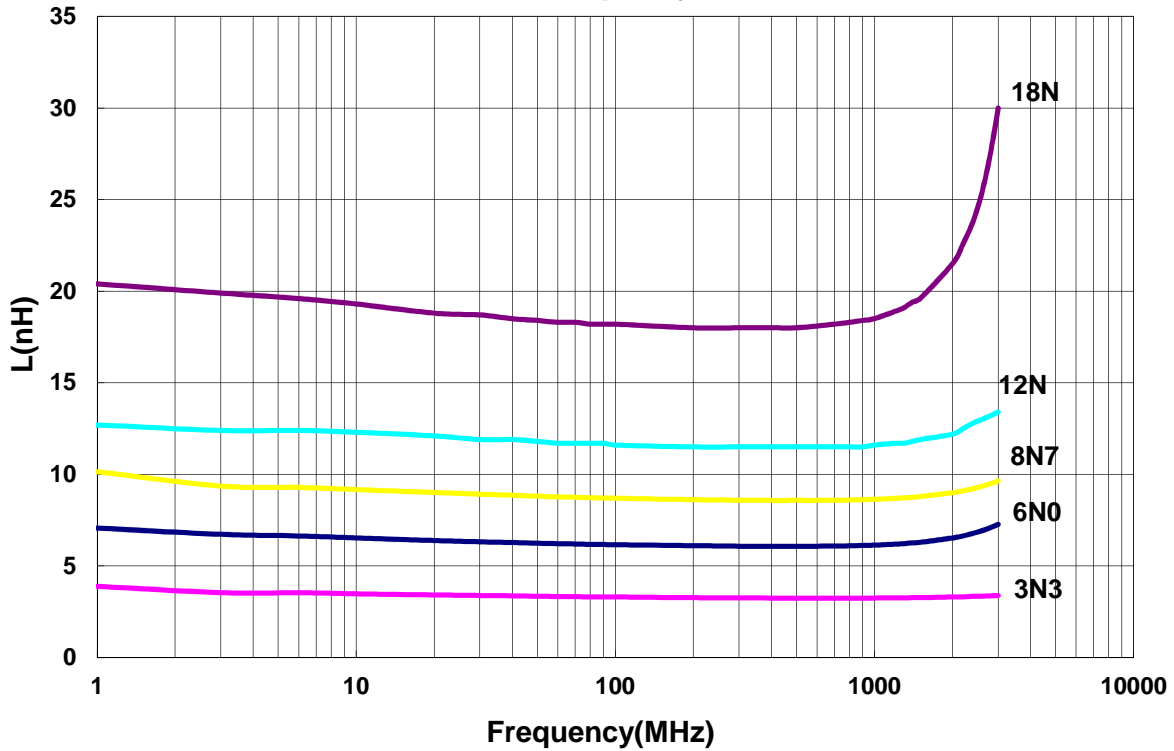

Q vs. Frequency Characteristics

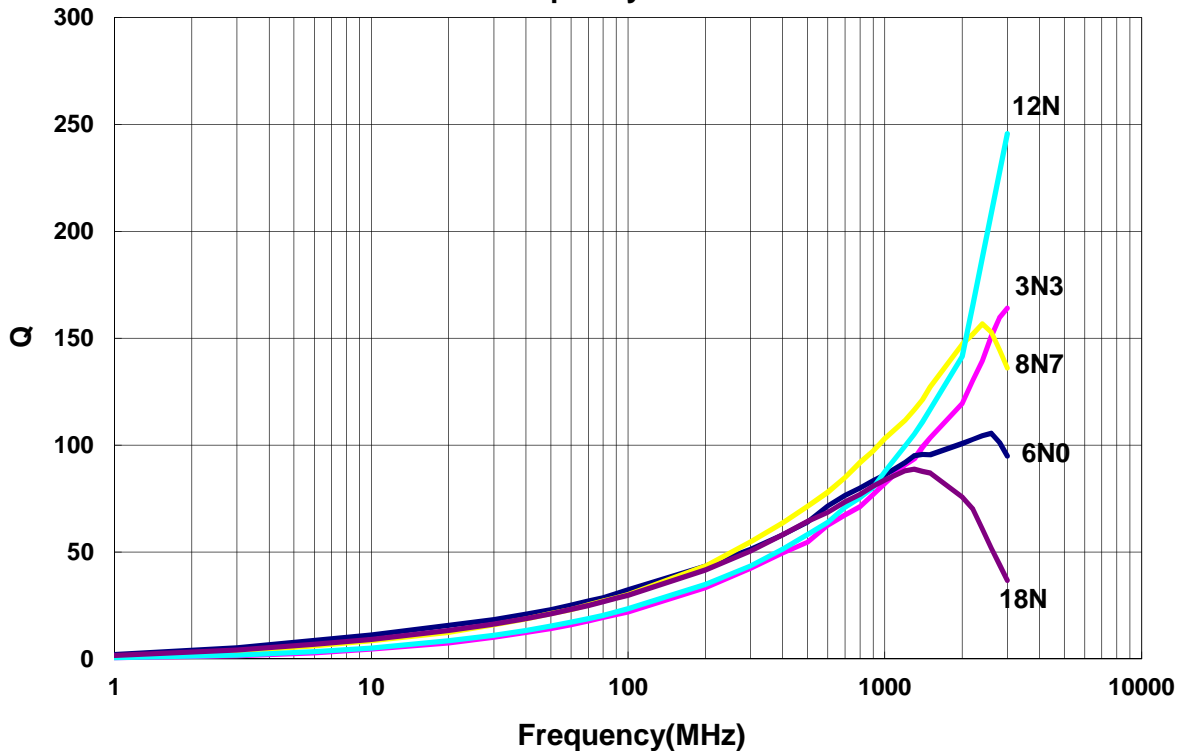

Please be sure to request approval specifications that provide further details of the products. Kindly note that the content of these specifications are subject to change or may be discontinued without prior notice. This product may not be designed/used in medical or high risk applications without Chilisin approval. Please contact our sales department before ordering.

■ Packaging

Tape Dimensions

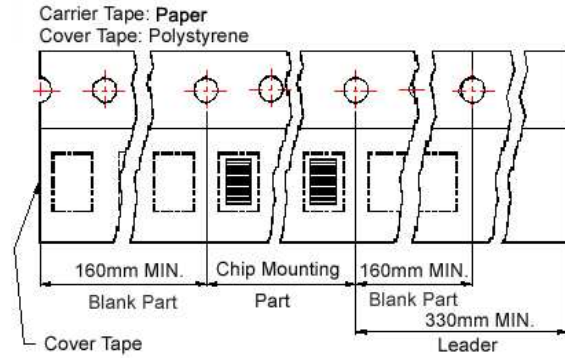
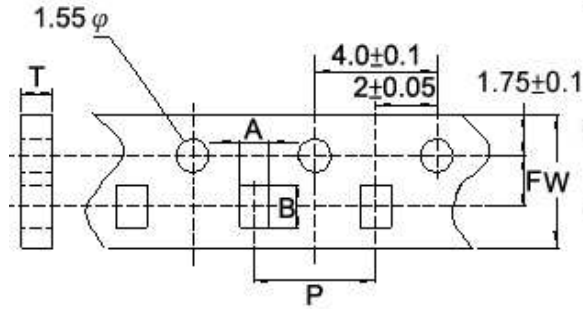

Reel Dimensions

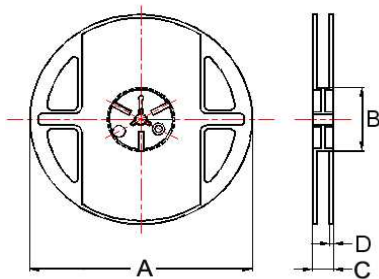

Dimensions in mm

TYPE	Tape Dimensions						Reel Dimensions				Quantity PCS / Reel
	A	B	T	W	P	F	A	B	C	D	
AWHH00161108	1.25	1.90	1.05	8	4	3.5	178	60	12	1.5	4000