

DRAWING NUMBER 243-240-317	ISSUE 14
PART NUMBER SEE TABLE	

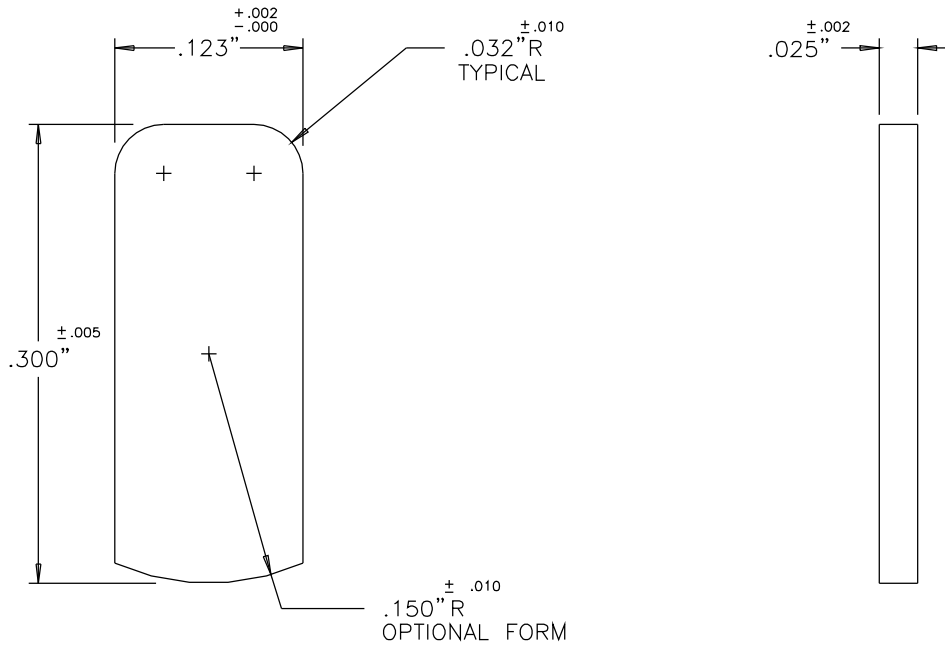

### NOTES

- 1) MATERIAL: NYLON (ZYTEL 101 OR EQUIVALENT)
- 2) PART TO BE STAMPED FROM POLARIZING KEY RAW MATERIAL PART NUMBER 243-241-318

PART NUMBER	COLOUR	REMARKS
243-240-317	NATURAL	AS STAMPED
243-240-318	BLUE	DYED PART

ACAD REFERENCE NO.  
234-240-317

RECOMMENDED DISPOSITION OF STOCK (PRIOR ISSUE PARTS)  
 SCRAP  INSPECT  USE AS IS  
 REWORK  SEE ENGINEERING MEMO  
 ISSUE NUMBER  
 ORIGINAL (1)  
 REDRAWN ON CAD ECN #90-055  
 BDS MAY 22/90 (3)  
 DWG. NO. CHANGE TO PT/NO. F.BRIONES JAN.17/00 (14)

TOLERANCE UNLESS NOTED	
DIMENSION	TOLERANCE
.00	± ----
.000	± .005
.0000	± ----
ANGULAR	± ----

### POLARIZING TAB

DRAWING NOTES:  
 1) DO NOT SCALE DRAWING.  
 2) DIMENSIONS ARE IN INCHES AND INCLUDE THICKNESS OF PLATING.  
 3) ALL SCREW THREADS TO BE CLASS 2 FIT (AM.STD.) UNLESS OTHERWISE SPECIFIED.



DRAWN: R. WEAVER	DATE: MAY 2/73
CHECKED:	DATE:
ENG.APPR:	DATE:
SCALE: 10:1	SHEET 1 OF 1

**EDAC** EDAC INC  
 TORONTO, ONTARIO  
 CANADA  
 YOUR CONNECTION TO QUALITY & SERVICE

THESE DRAWINGS AND SPECIFICATIONS ARE THE PROPERTY OF EDAC INC., AND SHALL NOT BE REPRODUCED, OR COPIED OR USED AS THE BASIS FOR THE MANUFACTURE OR SALE OF APPARATUS WITHOUT WRITTEN PERMISSION.

DRAWING NUMBER 243-240-317	ISSUE 14
-------------------------------	-------------