

Without Screw

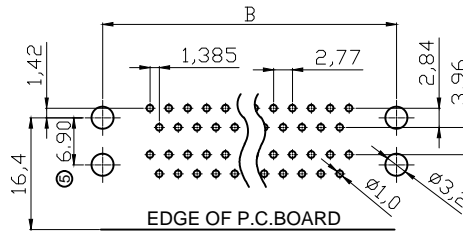
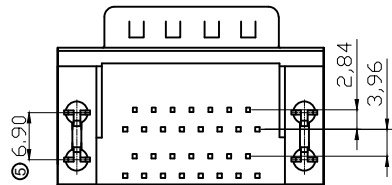
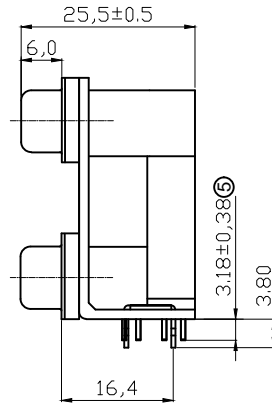
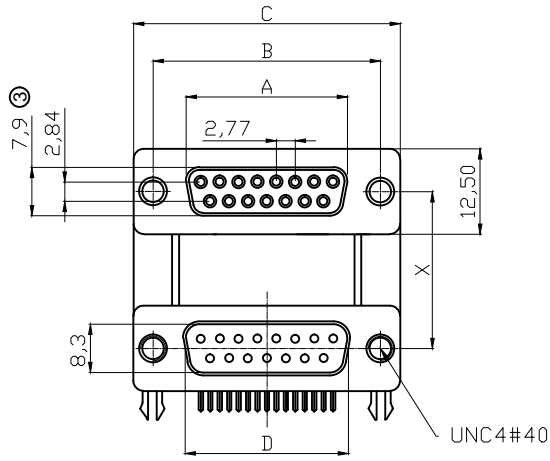

RECOMMENDED P.C.B LAYOUT (TOP VIEW)
TOLERANCES: ±0.10mm

SPECIFICATION
MATERIAL
 Insulator: PBT, rated UL94V-0, black
 Contacts: Copper alloy
 Shell: Steel : 7439-89-6
 Rivet,Boardlock: Copper alloy

CONTACT PLATING
 Contact area: Gold flash
 Solder tails: 100u" Tin over 40u" Nickel
 Shell plating: Tin plated
 Underplate: 50u" Nickel

ELECTRICAL
 Operation voltage: 250 VAC max.
 Current rating: 3 Amps max.
 Contact resistance: 25 mohms max.
 Insulation resistance: 3000 Mohms min @ 500 VDC
 Dielectric withstanding voltage: 1000 VAC / minute
 Operating temperature: -55°C ~ +105°C

① Order Code:

⑥ A-DD xx - x - x - x

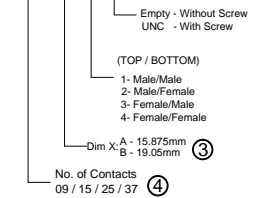

Dimensions

POSITION	A	B	C	D
9	16.30	25.00	30.8	16.92
15	24.60	33.30	39.2	25.25
25	38.30	47.10	53.1	38.96
37	54.80	63.50	69.4	55.42

RoHS compliant

Unit: mm

Scale	Free	⑦	Add version with UNC 4-#40 and adjust distribution	30.01.2019	Xavier		Date	Name	Customer-No.
TOLERANCE		⑥	Add contact style	20.03.2015	Winnie	Drawn	31.08.2012	Winnie	ASSMANN WSW-No. A-DD XX X-X
X.	±0.50	⑤	Correct the 7.90mm into 6.90mm	15.08.2014	Winnie	Approved	20.03.2015	Winnie	
X.X	±0.30	④	Update	24.04.2013	Winnie				
X.XX	±0.20	③	Update	01.04.2013	Winnie				
DIM TOL		②	Update	28.01.2013	Winnie				Drawing-No. ASS 4956 CO
Angle	±5°	Id.	Modification	Date	Name				
									Sheet 1/2



With Screw

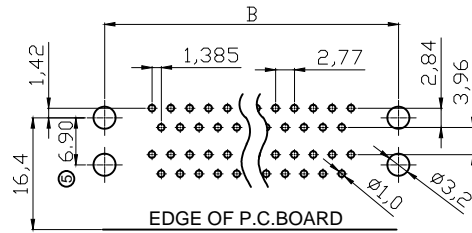
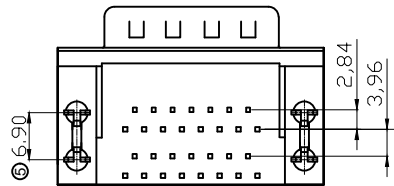
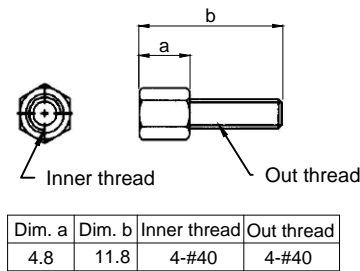
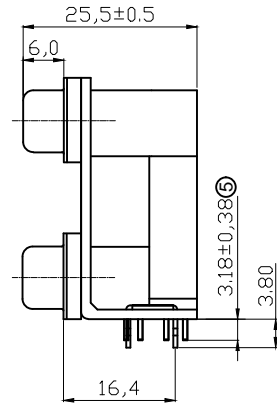
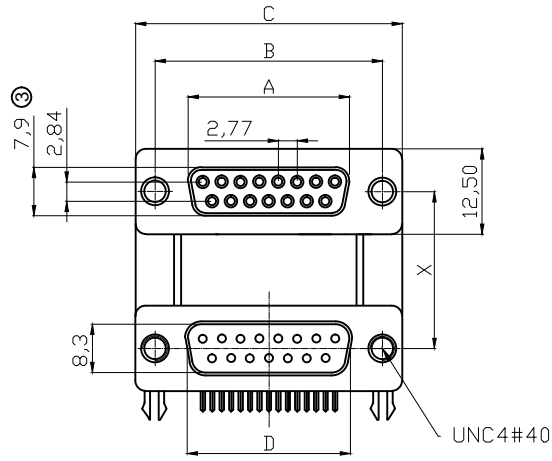

RECOMMENDED P.C.B LAYOUT (TOP VIEW)
TOLERANCES: ±0.10mm

SPECIFICATION
MATERIAL
 Insulator: PBT, rated UL94V-0, black
 Contacts: Copper alloy
 Shell: Steel : 7439-89-6
 Rivet,Boardlock: Copper alloy

CONTACT PLATING
 Contact area: Gold flash
 Solder tails: 100u" Tin over 40u" Nickel
 Shell plating: Tin plated
 Underplate: 50u" Nickel

ELECTRICAL
 Operation voltage: 250 VAC max.
 Current rating: 3 Amps max.
 Contact resistance: 25 mohms max.
 Insulation resistance: 3000 Mohms min @ 500 VDC
 Dielectric withstanding voltage: 1000 VAC / minute
 Operating temperature: -55°C ~ +105°C

① Order Code:

② A-DD xx - x - x - x

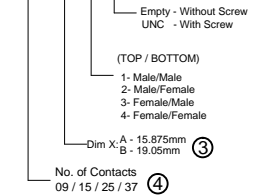

Dimensions

POSITION	A	B	C	D
9	16.30	25.00	30.8	16.92
15	24.60	33.30	39.2	25.25
25	38.30	47.10	53.1	38.96
37	54.80	63.50	69.4	55.42

RoHS compliant

Unit: mm

Scale	Free	⑦	Add version with UNC 4-#40 and adjust distribution	30.01.2019	Xavier	Date	Name	Customer-No.
TOLERANCE		⑥	Add contact style	20.03.2015	Winnie	Drawn	31.08.2012	Winnie
X.	±0.50	⑤	Correct the 7.90mm into 6.90mm	15.08.2014	Winnie	Approved	20.03.2015	Winnie
X.X	±0.30	④	Update	24.04.2013	Winnie			
X.XX	±0.20	③	Update	01.04.2013	Winnie			
DIM TOL		②	Update	28.01.2013	Winnie			
Angle	±5°	Id.	Modification	Date	Name			

ASSMANN WSW-No. ⑦ A-DD XX X-X-UNC	
Drawing-No. ASS 4956 CO	rev07
Replace	Sheet 2/2