

LOOSE PIECE		TAPE MOUNTED		SPECIFICATIONS						
MATERIAL NUMBER	ENGINEERING NUMBER	MATERIAL NUMBER	ENGINEERING NUMBER	STUD SIZE	"S" ±.005 [0.13]	"W" ±.010 [0.25]	"C" MIN.	"L" MAX.	"H"	STOCK ±.001 [0.025] THICKNESS
190580016	B-801-12HD	---	---	12	.515 [13.08]	.750 [19.05]	.611 [15.52]	1.586 [40.28]	---	.050 [1.27]
---	---	---	---	14	.265 [6.73]					
---	---	---	---	38	.390 [9.91]					
---	---	---	---	56	.328 [8.33]					
190580026	B-801-76HD	---	---	76	.453 [11.51]	.375 [9.53]	.303 [7.70]	1.091 [27.71]	.980 [24.89]	.050 [1.27]
190580037	B-828-06HD	---	---	6	.146 [3.71]					
190580041	B-828-08HD	---	---	8	.173 [4.39]					
190580047	B-828-10HD	190580050	B-828-10HDT	10	.198 [5.03]					
190580055	B-830-10HD	---	---	10	.198 [5.03]	.530 [13.46]	.393 [9.98]	1.258 [31.95]	.980 [24.89]	.050 [1.27]
190580063	B-830-14HD	190580068	B-830-14HDT	14	.265 [6.73]					
190580072	B-830-56HD	190580077	B-830-56HDT	56	.328 [8.33]					
---	---	---	---	4	.119 [3.02]					
---	---	---	---	6	.146 [3.71]	.282 [7.16]	.306 [7.77]	1.047 [26.59]	.980 [24.89]	.050 [1.27]
---	---	---	---	8	.173 [4.39]					
---	---	---	---	10	.198 [5.03]					
190580112	B-840-14HD	---	---	14	.265 [6.73]					
190580117	B-840-38HD	190580119	B-840-38HDT	38	.390 [9.91]	.592 [15.04]	.466 [11.84]	1.362 [34.59]	1.172 [29.77]	.050 [1.27]
190580123	B-840-56HD	---	---	56	.328 [8.33]					

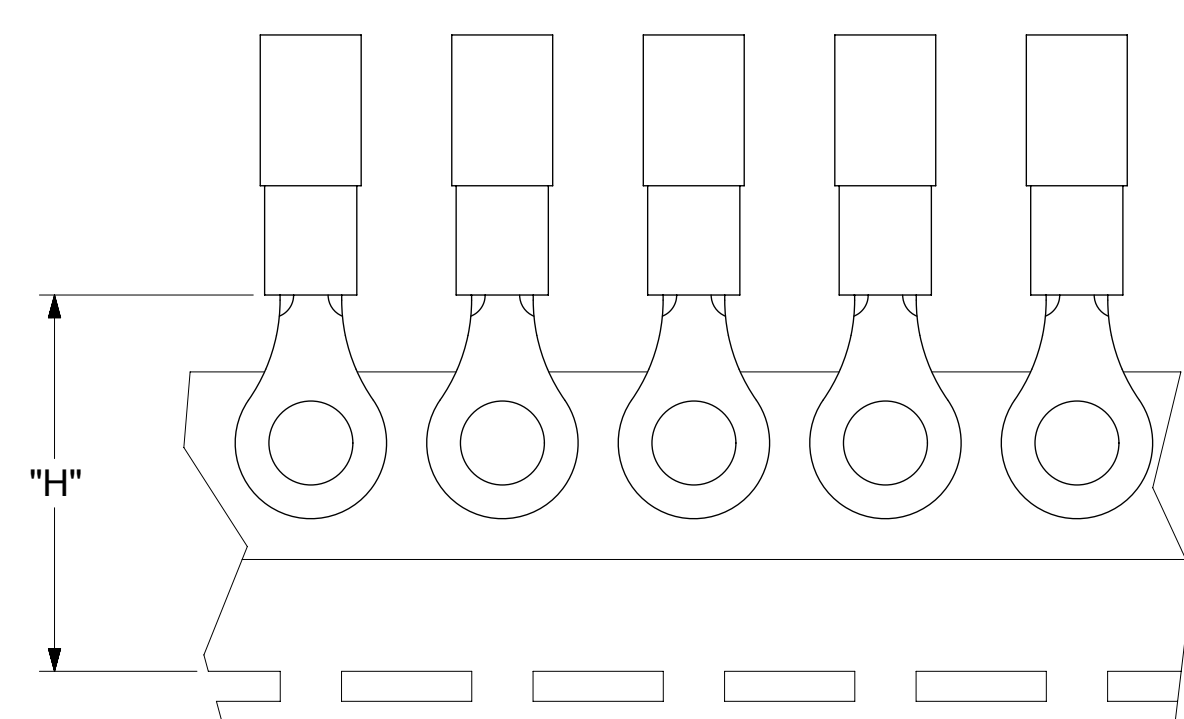
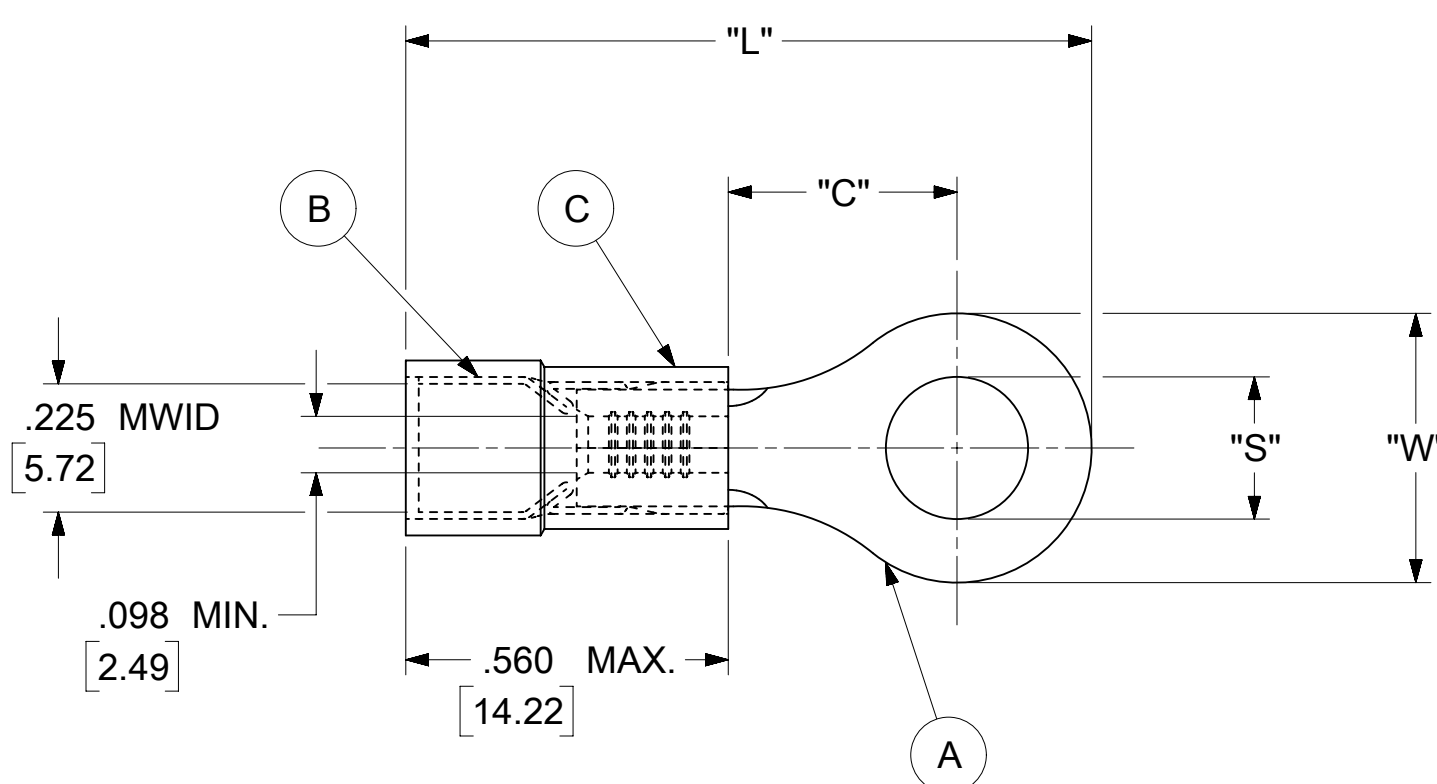

PARTS ON TAPE

- NOTES:
- MATERIAL:
 - (A). RING TONGUE TERMINAL: COPPER PLATING: ELECTRO-TIN (.0003 MIN.)
 - (B). TIN-PLATED BRASS FUNNEL FERRULE
 - (C). INSULATION: NYLON (YELLOW)
 - MWID: MAXIMUM WIRE INSULATION DIAMETER
 - WIRE SIZE: 16 -14 AWG
1.0 -2.5 MM²
 - "UL" LISTING #E32244
"CSA" LISTING #18689
 - ALL DIMENSIONS IN INCHES/[MM].
 - PARTS ARE ROHS COMPLIANT.
 - DIMS. SHOWN ARE FOR REFERENCE ONLY.

SYMBOLS	THIS DRAWING CONTAINS INFORMATION THAT IS PROPRIETARY TO MOLEX ELECTRONIC TECHNOLOGIES, LLC AND SHOULD NOT BE USED WITHOUT WRITTEN PERMISSION										
	DIMENSION UNITS	SCALE		CURRENT REV DESC: MIGRATION TO ECTR/NX							
∇ = 0	INCH/MM	NTS		EC NO: 619818							
∇ = 0	GENERAL TOLERANCES (UNLESS SPECIFIED)			DRWN: ABENJAMINLW 2019/06/18							
∇ = 0		MM	INCH	CHK'D: GROJAS01 2019/06/27						PRODUCT CUSTOMER DRAWING	
S = 0	4 PLACES	±	±	APPR: JMACNEIL 2019/07/10							
∇ = 0	3 PLACES	±	± 0.005	INITIAL REVISION:						DOCUMENT NUMBER 190580016	
∇ = 0	2 PLACES	± 0.13	± 0.01	DRWN: JJ 1984/11/29							
∇ = 0	1 PLACE	± 0.25	±	APPR: JMACNEIL 2019/07/10						DOC PART 000	
∇ = 0	0 PLACES	±	±	ANGULAR TOL ± 0.5 °							
∇ = 0	DRAFT WHERE APPLICABLE MUST REMAIN WITHIN DIMENSIONS			THIRD ANGLE PROJECTION		DRAWING		SERIES		MATERIAL NUMBER	
∇ = 0				C-SIZE		19058		CUSTOMER		SHEET NUMBER	
						GENERAL MARKET			1 OF 1		

NOTES:

- ① MATERIAL: COPPER (STOCK TKN. #050)
- ② PLATING: ELECTRO TIN (.0003 MIN)
- ③ TIN-PLATED BRASS FUNNEL FERRULE
- ④ NYLON INSULATION (COLOR CODED YELLOW)

STUD SIZES: (.005)

02 = .094
04 = .119
06 = .146
08 = .173
10 = .198
14 = .265
56 = .328
38 = .390
76 = .453
12 = .515

"UL" LISTING # E32244
 "CSA" LISTING # 18689

ALL DIMENSIONS = INCHES (MM) (MWID) DENOTES MAXIMUM WIRE INSULATION DIAMETER

WIRE SIZE: 16-14 AWG
 10-25 MM²

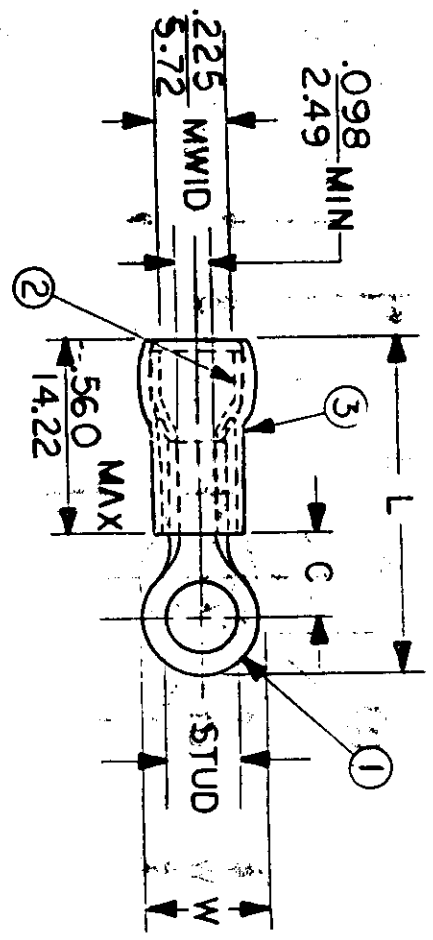

FILE NO: 80HD-801-01

PART NUMBER	"W" T.O.D.	"C" MIN.	"L" MAX.	SCALE: NTS		DATE	TITLE:	DWG. NO.	CUSTOMER DWG.
				DRWN. BY: JJ	CHKD. BY: GZ				
B-801-	.750	.611	1.586	11.84	34.59	11-29-84	RING TONGUE HEAVY DUTY TERMINAL	A	
B-828-	.375	.303	1.091						
B-830-	.530	.393	1.258						
B-836-	.282	.306	1.047						
B-840-	.592	.466	1.362						
DIMENSIONAL TOLERANCES UNLESS OTHERWISE SPECIFIED		REFERENCE		SCALE: NTS		DATE	TITLE:	DWG. NO.	CUSTOMER DWG.
±		±		±		11-29-84	RING TONGUE HEAVY DUTY TERMINAL	A	

