

PART NUMBER CODING

A_B _ _ DHH _ -S1013

**NUMBER OF POSITIONS
(CONTACTS PER ROW)**

PLATING

ALL PLATINGS ARE LEAD FREE AND HAVE .000050" NICKEL UNDERPLATE

CONTACT SURFACE	TERMINATION
B = .000010" GOLD	.000100" PURE TIN, MATTE
C = .000030" GOLD	.000100" PURE TIN, MATTE

MOUNTING STYLE

- D = FLUSH MOUNTING (PAGE 1)
- N = NO MOUNTING EARS
- T = FLUSH MOUNTING, WITH THREADED INSERTS
- R = METAL BOARDLOCKS

REVISIONS				
REV.	ECO. NO	DESCRIPTION	DATE	BY
D	756	UPDATE PART NUMBER TO DHHN, ADD PLATING TABULATION	10/07/05	MNH
E	766	UPDATE PCB LAYOUT	10/13/2005	MNH
F	2136	ADD MOUNTING & POSITION # OPTIONS	4/27/2010	JH

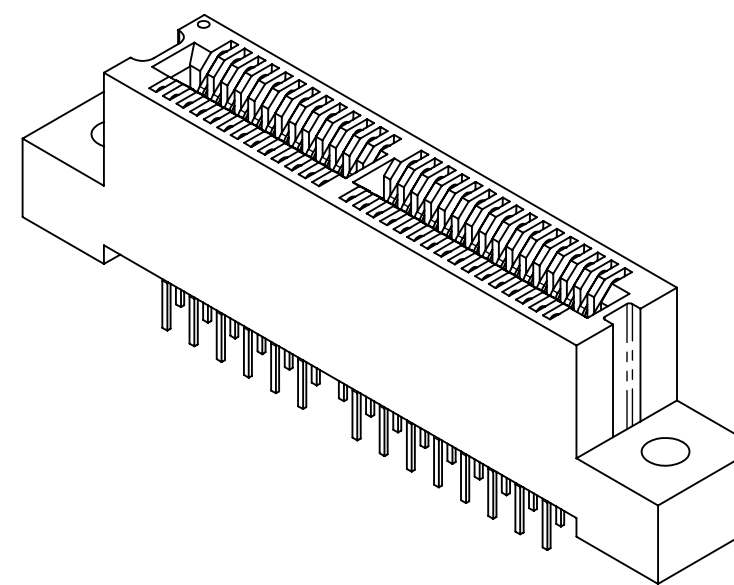
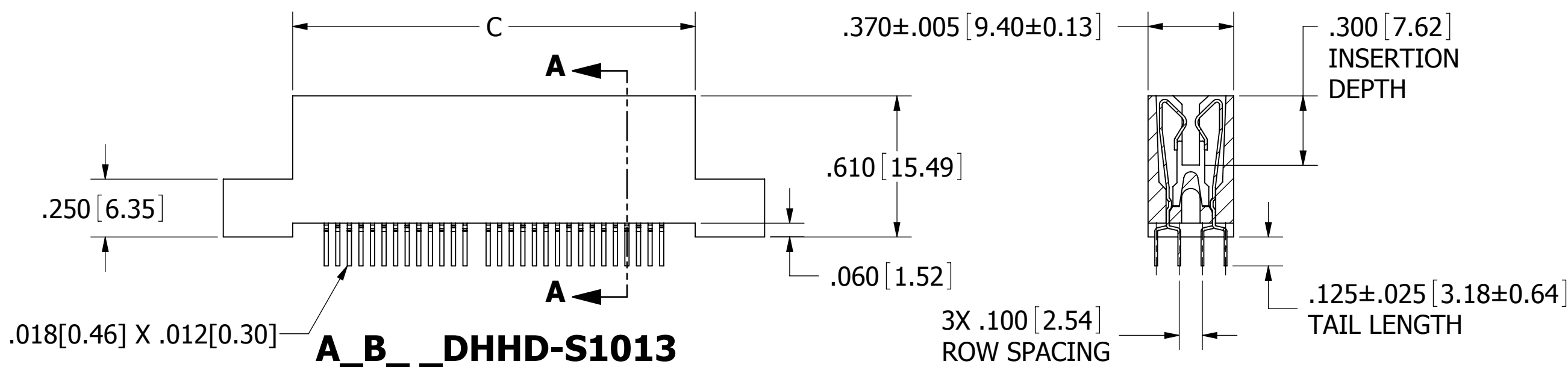
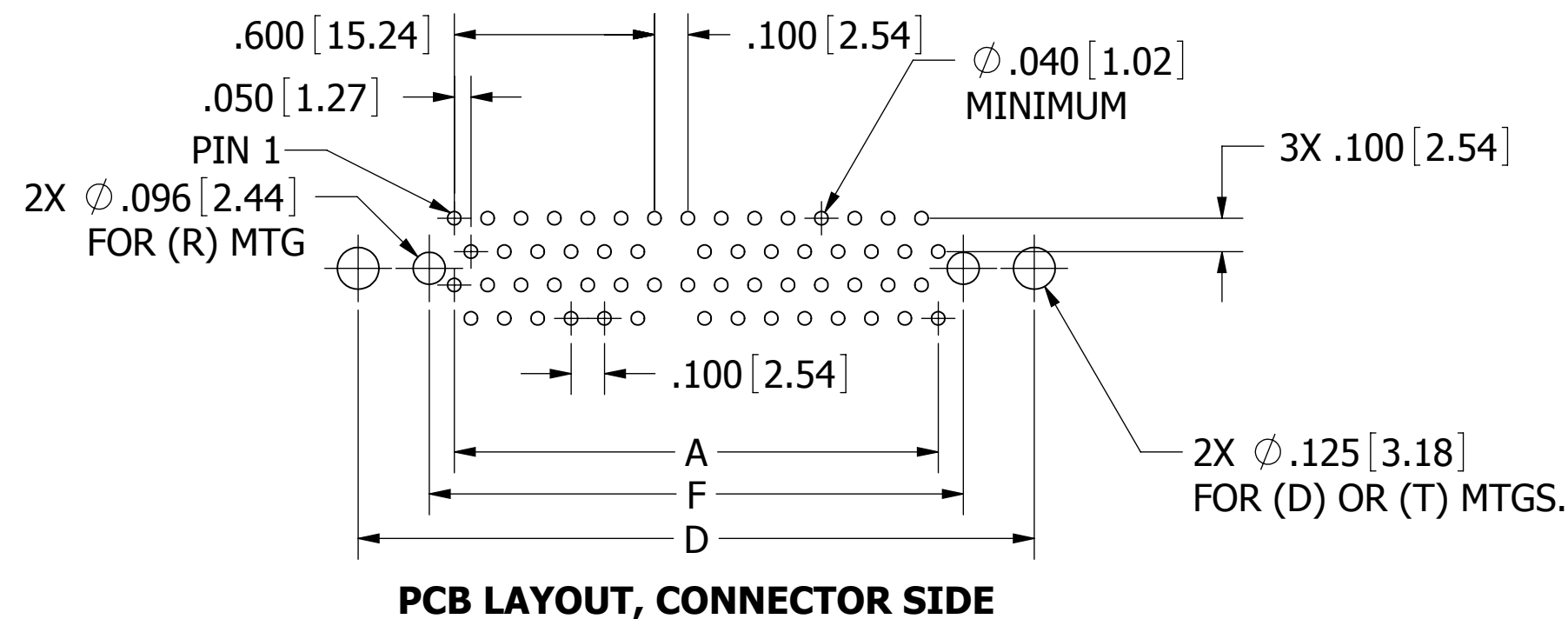
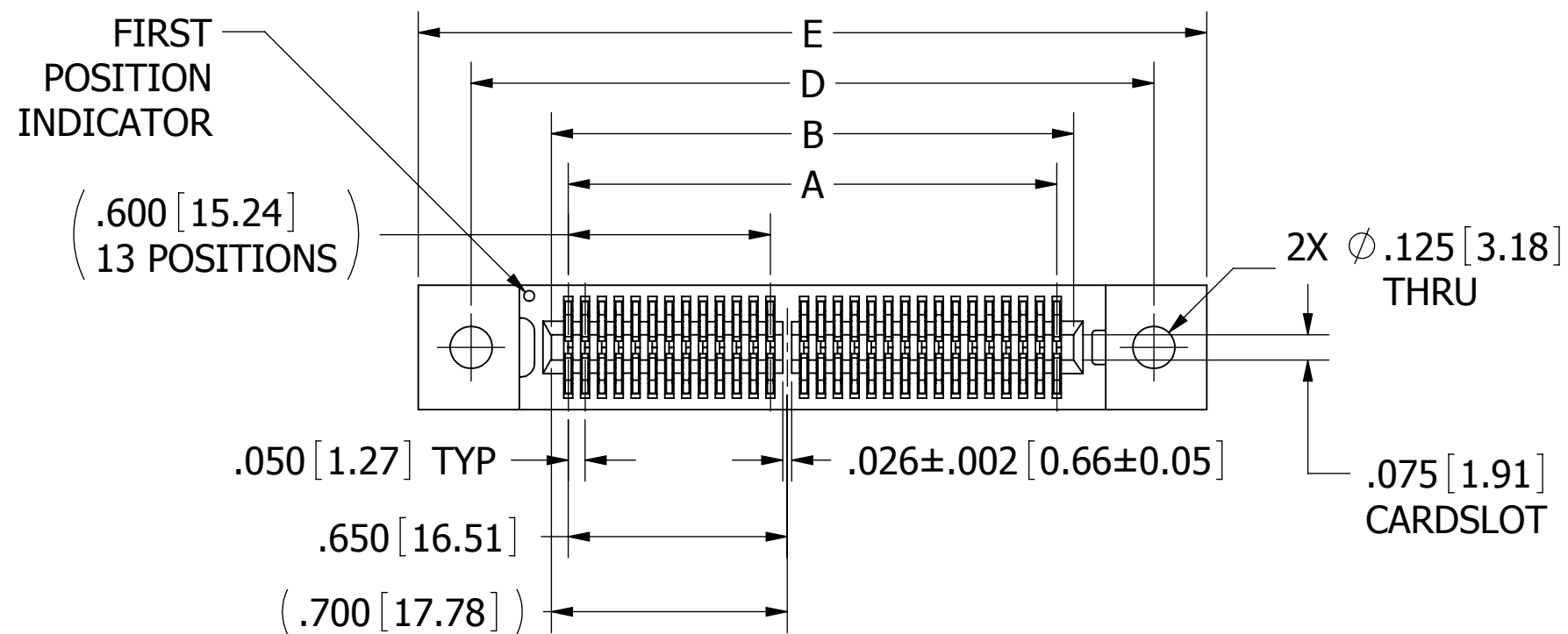

NOTES:

1. INSULATOR MATERIAL: PPS.
2. CONTACT MATERIAL: BERYLLIUM COPPER.
3. PLATING: SEE PART NUMBER CODING.
4. OPERATING TEMPERATURE: -65 °C TO +150 °C .
5. PROCESSING TEMP: 260 °C MAX FOR 120 SECONDS MAX.
6. UL FLAMMABILITY RATING: 94V-0.
7. VOLTAGE RATING: 250 VDC MINIMUM AT SEA LEVEL.
8. CURRENT RATING: 1 AMP PER CONTACT.
9. CONTACT RESISTANCE: 30 MILLIOHMS MAX
10. INSULATION RESISTANCE: 5000 MEGA OHMS.
11. DURABILITY: 500 CYCLES MIN.
12. CONNECTOR IDENTIFICATION: THE PART SHALL BE MARKED WITH A PART NUMBER AND BARCODE.
13. BOARD THICKNESS ACCOMMODATED: .062 ±.008[1.57 ±0.20].
14. BOARD INSERTION FORCE: 16 OZ MAX PER CONTACT PAIR WHEN USING A .062[1.57] TEST BLADE. INTERNAL INSPECTION TO BE PER SULLIN'S WORK INSTRUCTION W17.3-01.
15. BOARD WITHDRAWAL FORCE: 1 OUNCE MINIMUM PER CONTACT PAIR USING .062[1.57] PCB.
16. MODIFICATION:MOLDED KEY IN POSITION 14.

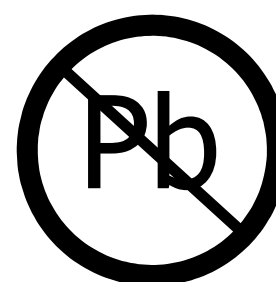

RoHS COMPLIANT

CUSTOMER COPY

UNLESS OTHERWISE SPECIFIED:
DIMENSIONS ARE IN INCHES[MM]
TOLERANCES:
ANGULAR: ± 30'
.XX=± .02 [.508]
.XXX=± .005 [.1270]
.XXXX=± .0005 [.0127]
SURFACE FINISH: 63 Rg
REMOVE ALL BURRS AND SHARP EDGES .010 MAX

INTERPRET DIMENSIONS AND GEOMETRIC TOLERANCING PER: ANSI Y14.5M-1994

DRAWN	DATE	NAME
	4/27/10	HT

THE INFORMATION HEREIN CONTAINS PROPRIETARY INFORMATION OF SULLINS ELECTRONICS AND IS NOT TO BE REPRODUCED, USED OR DISCLOSED TO OTHERS FOR ANY PURPOSE EXCEPT AS SPECIFICALLY AUTHORIZED IN WRITING BY AN OFFICER OF SULLINS ELECTRONICS.

SULLINS CONNECTOR SOLUTIONS		
DESCRIPTION EDGE CARD, .050 CC, HP		
PART NUMBER A_B _ _ DHH _ -S1013		
SIZE C	DWG. NO. C10063	REV F
SCALE: 2:1		SHEET 1 OF 2

PART NUMBER	NO OF POS.	A ±.005[0.13]		B ±.005[0.13]		C ±.015[0.38]		D ±.010[0.25]		E ±.020[0.51]		F ±.010[0.25]	
		IN	MM	IN	MM	IN	MM	IN	MM	IN	MM	IN	MM
A_B25DHH_-S1013	25	1.200	30.48	1.300	33.02	1.490	37.85	1.776	45.11	2.090	53.09	1.350	34.29
A_B30DHH_-S1013	30	1.450	36.83	1.550	39.37	1.740	44.2	2.026	51.46	2.340	59.44	1.600	40.64
A_B50DHH_-S1013*	50	2.450	62.23	2.550	64.77	2.740	69.6	3.026	76.86	3.340	84.84	2.600	66.04
A_B75DHH_-S1013	75	3.700	93.98	3.800	96.52	3.990	101.35	4.276	108.61	4.590	116.59	3.850	97.79

*Consult Factory For Availability

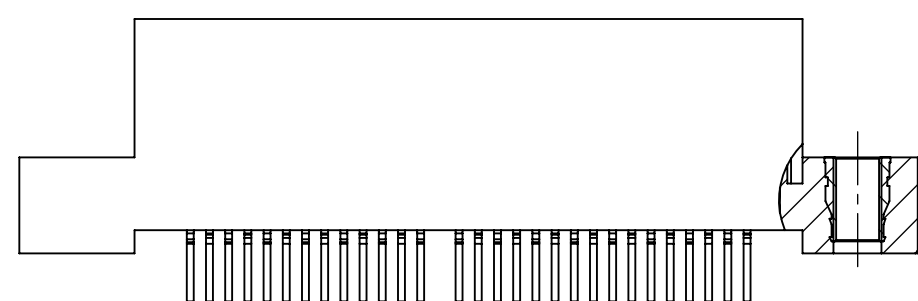
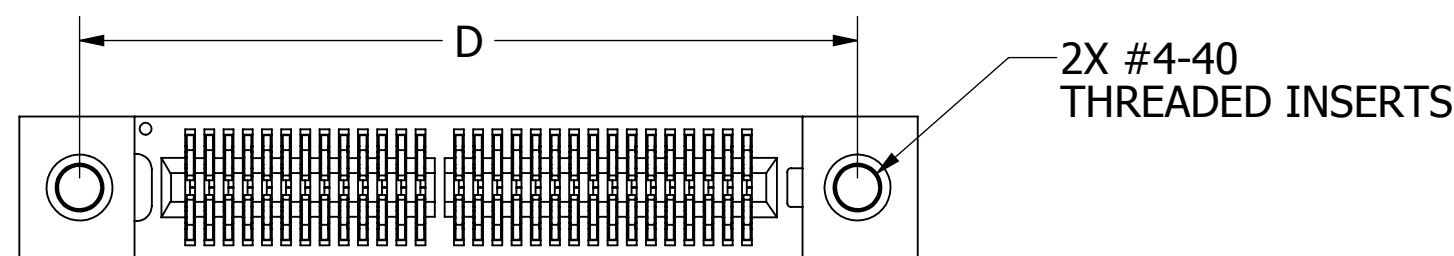

A_B__DHHT-S1013

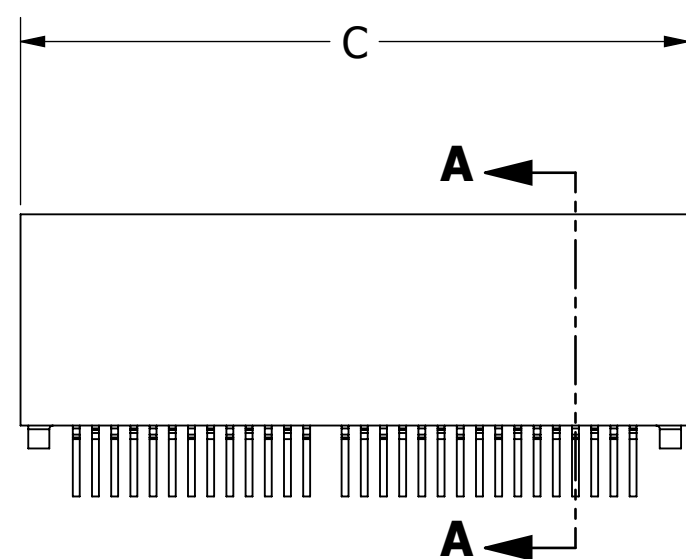

A_B__DHHN-S1013

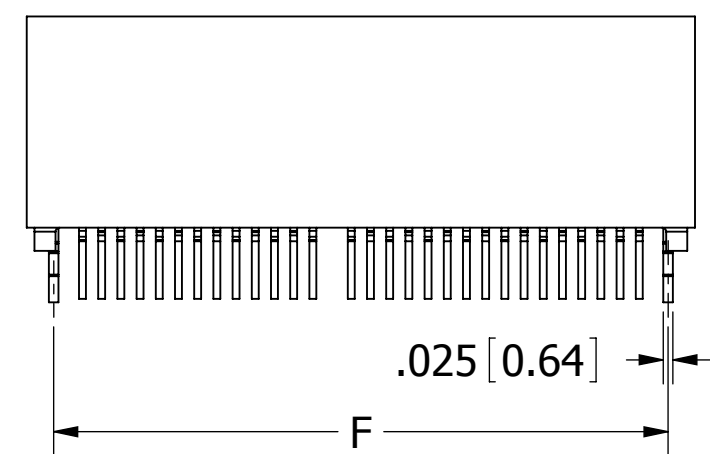

A_B__DHHR-S1013

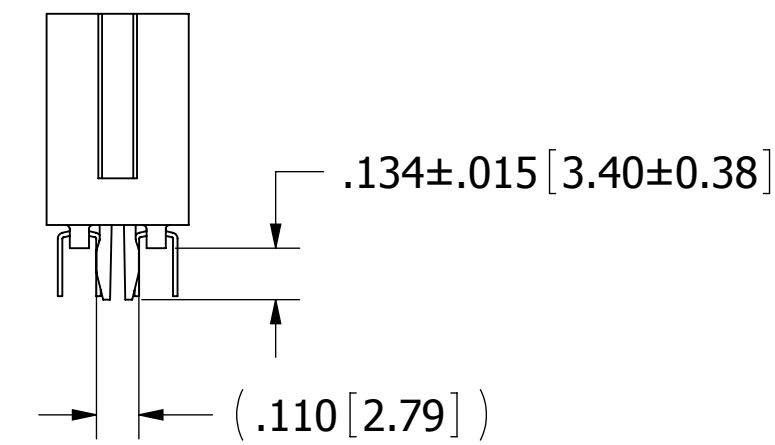

CUSTOMER COPY

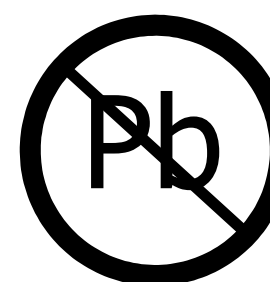

RoHS COMPLIANT

UNLESS OTHERWISE SPECIFIED:
 DIMENSIONS ARE IN INCHES[MM]
 TOLERANCES:
 ANGULAR: ± 30'
 .XX=± .02 [.508]
 .XXX=± .005 [.1270]
 .XXXX=± .0005 [.0127]
 SURFACE FINISH: 63 Rc
 REMOVE ALL BURRS AND SHARP EDGES .010 MAX
 INTERPRET DIMENSIONS AND GEOMETRIC TOLERANCING PER: ANSI Y14.5M-1994

DRAWN	DATE	NAME
HT	4/27/10	HT

THE INFORMATION HEREIN CONTAINS PROPRIETARY INFORMATION OF SULLINS ELECTRONICS AND IS NOT TO BE REPRODUCED, USED OR DISCLOSED TO OTHERS FOR ANY PURPOSE EXCEPT AS SPECIFICALLY AUTHORIZED IN WRITING BY AN OFFICER OF SULLINS ELECTRONICS.

SULLINS CONNECTOR SOLUTIONS	
DESCRIPTION EDGE CARD, .050 CC, HP	
PART NUMBER A_B__DHH_-S1013	
SIZE	DWG. NO.
C	C10063
REV	F

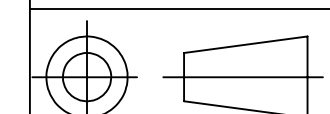

SCALE: 2:1 SHEET 2 OF 2