

NOTES:

1. ONLY THE ITEMS WITH QUANTITIES SPECIFIED ON PARTS LIST ARE USED ON THIS APPLICATOR.

▲ USED IN PLACE OF ITEM 38 WHEN INSULATION CRIMP IS NOT USED.

▲ GUARD MUST BE IN PLACE WHEN OPERATING APPLICATOR IN AMP-O-LECTRIC PRESS.

▲ CUT TO LENGTH AT ASSY.

▲ SEE DWGS FOR COMPONENTS.

▲ QTY IN INCHES.

KEY:

■ RECOMMENDED SPARE PARTS.

▲ LUBRICATE DAILY USING NO 20 MACHINE OIL.

● GREASE LIGHTLY.

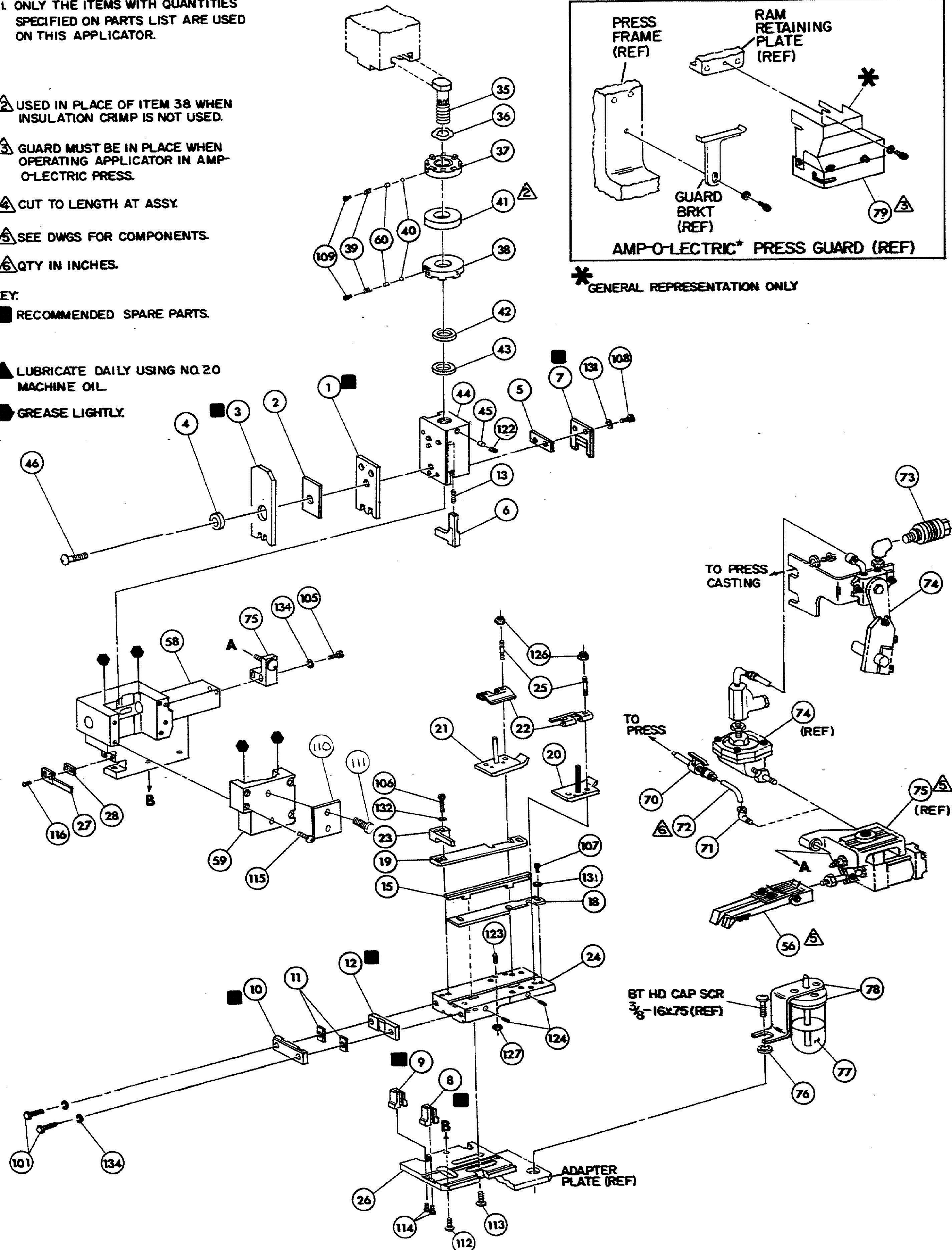

| QTY | PART NO | DESCRIPTION | ITEM NO | QTY | PART NO | DESCRIPTION | ITEM NO | |
|-----|-----------|--|---------|-----|---------|-------------|----------------------|----|
| | | | | 145 | 1 | 458268-1 | CAP, RAM | 59 |
| | | | | 144 | 1 | 458267-1 | HOUSING | 58 |
| | | | | 143 | | | | 57 |
| | | | | 142 | 1 | 460680-3 | FEED FINGER ASSY | 56 |
| | | | | 141 | | | | 55 |
| | | | | 140 | | | | 54 |
| | | | | 139 | | | | 53 |
| | | | | 138 | | | | 52 |
| | | | | 137 | | | | 51 |
| | | | | 136 | | | | 50 |
| | | | | 135 | | | | 49 |
| | 21024-5 | WASHER, LOCK (NO 10) AIR FEED ASSY | | 134 | | | | 48 |
| 4 | 21024-5 | WASHER, LOCK (NO 10) SHEAR PLATES | | 133 | | | | 47 |
| | | | | 132 | 1 | 690636-2 | BOLT, CRIMPER | 46 |
| | 21024-4 | WASHER, LOCK (NO 8) STRIP GUIDE | | 131 | 1 | 690191-1 | PLUG, NYLON | 45 |
| 6 | 21024-4 | WASHER, LOCK (NO 8) SHEAR BLADE | | 130 | 1 | 458266-1 | RAM | 44 |
| | | | | 129 | 1 | 690125-1 | WASHER, LAMINATED | 43 |
| | | | | 128 | 1 | 690124-1 | WASHER, RAM | 42 |
| 4 | 21018-6 | NUT, HEX MACH (8-32) DRAG ADJ SCREW | | 127 | | | SPACER, DISC | 41 |
| 4 | 21022-2 | NUT, HEX SELF-LKG (8-32) DRAG STUD | | 126 | 2 | 23241-6 | BALL, STEEL | 40 |
| 2 | 1-21008-9 | SCR, SKT SET (4-40 x .12) (LOC-WEL) DEP. HOLDER | | 125 | 2 | 690170-1 | SPRING, COMPRESSION | 39 |
| 2 | 3-21006-1 | SCR, SKT SET (6-32 X .38) CTR STR GUIDE | | 124 | 1 | 690142-1 | DISC, INSULATION | 38 |
| 4 | 5-21061-5 | SCR, SKT SET CONE POINT (8-32 X .88) DRAG | | 123 | 1 | 5-690141-6 | DISC, WIRE | 37 |
| 1 | 21009-2 | SCR, SKT SET (1/4-20 X 25) (LOC-WEL) RAM | | 122 | 1 | 22480-5 | WASHER, SPRING | 36 |
| | | | | 121 | 1 | 690212-1 | POST, RAM | 35 |
| | | | | 120 | | | | 34 |
| | | | | 119 | | | | 33 |
| | | | | 118 | | | | 32 |
| | | | | 117 | | | | 31 |
| | | | | 116 | | | | 30 |
| 2 | 2-21002-2 | SCR, BTN HD SKT CAP (8-32 X .50) STRIPPER | | 115 | | | | 29 |
| 4 | 3-21002-1 | SCR, BTN HD SKT CAP (10-32 X 1.00) HSG CAP | | 114 | | | | 28 |
| 2 | 22733-8 | SCR, BTN HD SKT CAP (8-32 X .38) (LOC-WEL) ANVIL | | 113 | 1 | 3-690451-2 | SPACER, STRIPPER | 27 |
| 4 | 3-21002-3 | SCR, BTN HD SKT CAP (1/4-20 X .50) STR GDE PL | | 112 | 1 | 458265-1 | STRIPPER | 26 |
| 3 | 2-22733-8 | SCR, BTN HD SKT CAP (1/4-20 X .75) BASE PL | | 111 | 4 | 458263-1 | PLATE, BASE | 25 |
| 2 | 21017-2 | SCR, DRIVE (#2 X .19) ID PLATE | | 110 | 1 | 22354-7 | DRAG, STUD | 24 |
| 1 | 461264-1 | PLATE, IDENTIFICATION | | 109 | | 458262-1 | PLATE, STRIP GUIDE | 23 |
| 2 | 23030-1 | SCR, SKT HD CAP (6-32 X .25) (LOC-WEL) CP DISC | | 108 | 2 | 461389-1 | PLATE, STRIP HOLD | 22 |
| 2 | 2-21000-6 | SCR, SKT HD CAP (8-32 X .38) SHEAR BLADE | | 107 | 1 | 461389-1 | SPRING, DRAG | 21 |
| 4 | 7-21000-4 | SCR, SKT HD CAP (8-32 X .31) STRIP GUIDE | | 106 | 1 | 458260-1 | DRAG, STOCK (LEFT) | 20 |
| 2 | 3-21000-7 | SCR, SKT HD CAP (10-32 X .75) AIR FEED ASSY | | 105 | 1 | 458259-1 | DRAG, STOCK (RIGHT) | 19 |
| | | | | 104 | 1 | 458258-5 | GUIDE, STRIP (LEFT) | 18 |
| | | | | 103 | | 458257-5 | GUIDE, STRIP (RIGHT) | 17 |
| | | | | 102 | | | | 16 |
| 2 | 3-21000-8 | SCR, HEX HD CAP (10-32 X .88) SHEAR PLATE | | 101 | 1 | 1-458309-0 | GUIDE, CENTER STRIP | 15 |
| 1 | 455750-6 | GUARD ASSY | | 79 | | | | 14 |
| REF | 852931-2 | OIL, LUBRICATING | | 78 | | 23846-1 | SPRING, HOLD DOWN | 13 |
| 1 | 454406-1 | SPACER, LUB BRACKET | | 77 | 1 | 458255-1 | PLATE, REAR SHEAR | 12 |
| 1 | 460277-3 | AIR FEED ASSY | | 76 | | | SPACER, SHEAR PLATE | 11 |
| | 692655-1 | AIR FEED VALVE ASSY | | 75 | 1 | 1-458254-1 | PLATE, FRONT SHEAR | 10 |
| | 24042-2 | VALVE, SHUT OFF | | 74 | 1 | 6-238169-3 | ANVIL, LEFT | 9 |
| 15" | 22620-1 | TUBING, PLASTIC | | 73 | 1 | 6-238169-3 | ANVIL, RIGHT | 8 |
| 1 | 22294-6 | ELBOW, PLASTIC TUBING | | 72 | 1 | 458253-5 | BLADE, SLUG | 7 |
| | | INSERT, COUPLING | | 71 | | | HOLD DOWN, TERMINAL | 6 |
| | | | | 70 | | 1-238075-1 | SPACER, SHEAR BLADE | 5 |
| | | | | 69 | | 238009-1 | SPACER, TUBULAR | 4 |
| | | | | 68 | | 1-458210-7 | CRIMPER, INSULATION | 3 |
| | | | | 67 | | 455888-6 | SPACER, INSULATION | 2 |
| | | | | 66 | 1 | 3-458209-0 | CRIMPER, WIRE | 1 |

| QTY | | PART NO | DESCRIPTION | ITEM NO |
|-----|--|----------|---------------------------|---------|
| 1 | | 694925-4 | REEL BRKT CONVERSION ASSY | |
| 2 | | 690603-1 | SPRING ASSIST | |

| CRIMPING DATA | | | | APPLICATOR WILL APPLY | |
|---------------------------------|--------------|-----------|---------------|-----------------------|------|
| PAD | CRIMP HEIGHT | WIRE SIZE | WIRE RANGE | 42037-1 | |
| LTR | LEFT | RIGHT | LEFT | RIGHT | |
| A | .065 | # 18 | 22-18 | | |
| B | .061 | # 20 | INSUL. RANGE | | |
| C | .059 | # 22 | LEFT .080-110 | | |
| D | NOT USED | | RIGHT | | |
| CRIMP | SIZE | TYPE | CRIMP | SIZE | TYPE |
| WIRE | LEFT | RIGHT | LEFT | RIGHT | FEED |
| | .090 | F | INSUL | .140 | F |
| | | | | | .714 |
| PRESS REF: APPL INST A1 8046 | | | | | |
| REMARKS: AMP-O-LECTRIC AIR FEED | | | | | |

| REMARKS | NO | REV |
|------------------------------|----------------|----------------|
| APPL USED ON MACHINE PART NO | MACH SERIAL NO | DISTRIBUTION |
| CUSTOMER NAME | APPL SERIAL NO | ORIGINAL |
| ADDRESS | PURCHASE ORDER | CUSTOMER COPY |
| CITY | ENG APP | FIELD ENG COPY |

| PIF | LTR | REVISION RECORD | APP DATE | PIF | LTR | REVISION RECORD | APP DATE |
|-----|-----|-----------------|----------|-----|-----|-----------------|----------|
| | | | | | | | |
| | | | | | | | |
| | | | | | | | |

| SET UP PAGE | 10-1 |
|---|------------|
| 455655-1 | 1/4/16 |
| DR 4511 | APP 1/2/91 |
| REL | REL |
| LOC A | D |
| NO 567409-2 | |
| REV 78 | |
| ECR-17-006959 RS 5-17 | |
| ECN A-331091 PJL 9-91 | |
| NAME: MINIATURE QUICK CHANGE APPLICATOR | |
| END FEED, DUAL (RING) | |

THIS INFORMATION IS CONFIDENTIAL AND IS DISCLOSED TO YOU ON CONDITION THAT NO FURTHER DISCLOSURE IS MADE BY YOU TO OTHER THAN AMP PERSONNEL WITHOUT WRITTEN AUTHORIZATION FROM AMP INCORPORATED, HARRISBURG, PA.