

10	9	8	7	6	5	4	3	2	1
MOLEX PN	ENGINEERING NO	LENGTH (mm)							
1300088056	302100B80M100	10M +317mm -0 [32.8' +12.5" -0]							
1300088057	302100B80M200	20M +622mm -0 [65.5' +24.5" -0]							
1300088058	302100B80M050	5M +165mm -0 [16.4' +6.5" - 0]							

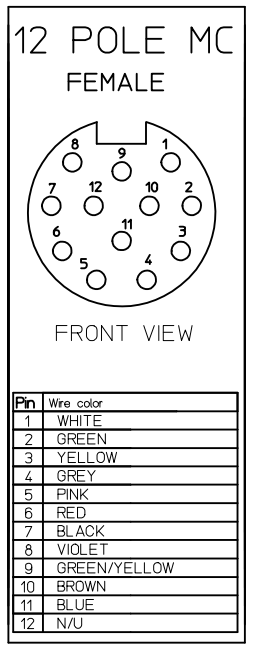
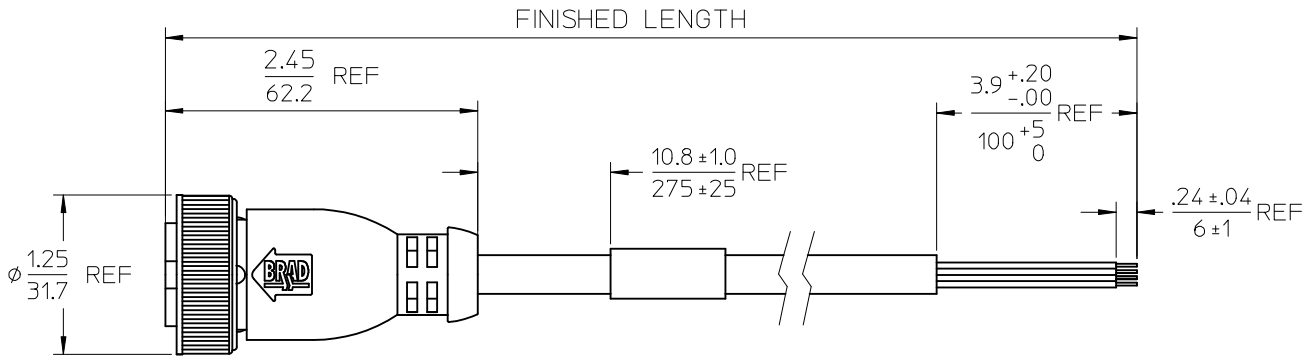
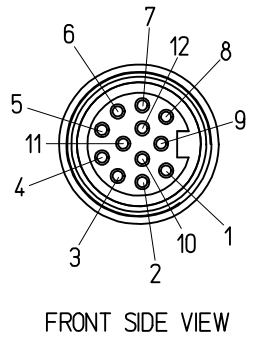

302100B80M100

cable type  
B80= TPU  
BLACK  
3 X 0.75 X 8 X 0.34

cable length  
050--50 Meters  
100--100 Meters

SPECIFICATION DATA:

VOLTAGE RATING:	600V	
AMPERAGE RATING:	5A	
PROTECTION CLASS:	IP 68	
OPERATING TEMPERATURE	-4°C - +105°C (-20°F - 221°F)	
LABEL	MYLAR	BLACK/YELLOW
FRICTION RING - C SIZE	NYLON	NATURAL
COUPLING NUT C-SIZE FEMALE	ZINC ALLOY	BLACK
12P FEMALE INSERT C-SIZE	PVC	YELLOW
OVERMOULD	PVC	YELLOW
FEMALE CONTACT 0.75	COPPER ALLOY	GOLD PLATING
FEMALE CONTACT 0.34/0.5	COPPER ALLOY	GOLD PLATING
CABLE	TPU	BLACK
ITEM QTY.	DESCRIPTION	MATERIAL FINISH

RELEASE EC NO: IPG2015-0971 DRWN: GUSTAFSON 2014/11/20 CHKD: BARDEN 2015/01/16 APPR: BWOODMAN 2014/12/02 DESCRIPTION	QUALITY SYMBOLS	GENERAL TOLERANCES (UNLESS SPECIFIED)	DIMENSION STYLE	SCALE	DESIGN UNITS	THIRD ANGLE PROJECTION																													
	$\nabla=0$ $\sphericalangle=0$	<table border="1"> <thead> <tr> <th></th> <th>mm</th> <th>INCH</th> </tr> </thead> <tbody> <tr> <td>4 PLACES</td> <td>± ---</td> <td>± ---</td> </tr> <tr> <td>3 PLACES</td> <td>± ---</td> <td>± ---</td> </tr> <tr> <td>2 PLACES</td> <td>± 0.05</td> <td>± ---</td> </tr> <tr> <td>1 PLACE</td> <td>± 0.3</td> <td>± ---</td> </tr> <tr> <td>0 PLACE</td> <td>± 0.5</td> <td>± ---</td> </tr> </tbody> </table>		mm	INCH	4 PLACES	± ---	± ---	3 PLACES	± ---	± ---	2 PLACES	± 0.05	± ---	1 PLACE	± 0.3	± ---	0 PLACE	± 0.5	± ---	<table border="1"> <thead> <tr> <th>DRAWN BY</th> <th>DATE</th> <th>TITLE</th> </tr> </thead> <tbody> <tr> <td>FGAIK</td> <td>2014/08/27</td> <td rowspan="2">MC-12P-11W-FE-ST</td> </tr> <tr> <td>BARDEN</td> <td>2014/11/20</td> </tr> <tr> <td>BWOODMAN</td> <td>2014/12/02</td> <td></td> </tr> </tbody> </table>	DRAWN BY	DATE	TITLE	FGAIK	2014/08/27	MC-12P-11W-FE-ST	BARDEN	2014/11/20	BWOODMAN	2014/12/02		IN/MM	METRIC	
		mm	INCH																																
	4 PLACES	± ---	± ---																																
3 PLACES	± ---	± ---																																	
2 PLACES	± 0.05	± ---																																	
1 PLACE	± 0.3	± ---																																	
0 PLACE	± 0.5	± ---																																	
DRAWN BY	DATE	TITLE																																	
FGAIK	2014/08/27	MC-12P-11W-FE-ST																																	
BARDEN	2014/11/20																																		
BWOODMAN	2014/12/02																																		
ANGULAR ± 1 ° DRAFT WHERE APPLICABLE MUST REMAIN WITHIN DIMENSIONS	SEE CHART 1 THIS DRAWING CONTAINS INFORMATION THAT IS PROPRIETARY TO MOLEX INCORPORATED AND SHOULD NOT BE USED WITHOUT WRITTEN PERMISSION	MATERIAL NO. DOCUMENT NO.	SD-130008-027 SHEET NO.	1 OF 1																															

PART No MATRIX

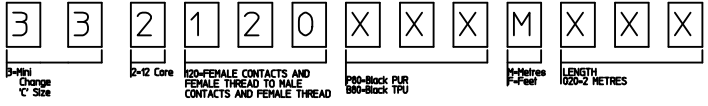

Over	Up to and including	Tolerance
0	305	+19
305	915	+45
915	1830	+56
1830	3660	+89
3660	7320	+165
7320	14640	+317
14640	30500	+610
30500	>	+2% of lenght

CHART 1

MOLEX PN	ENGINEERING NO	L(mm)
1300128009	332120P80M020	2000
1300128010	332120P80M100	10000
1300128011	332120P80M200	20000
1300128022	332120P80M160	16000
1300128027	332120P80M050	5000
1300128033	332120B80M020	2000
1300128034	332120B80M100	10000
1300128035	332120B80M200	20000
1300128036	332120B80M160	16000
1300128037	332120B80M050	5000

CABLE SPECIFICATION:	B80	P80
VOLTAGE RATING:	600V	300V (ONLY FOR ELECTRONIC USE)
TEMPERATURE RANGE (STATIC):	-40°C / +90°C (3000h)	-40°C / +90°C (CEI EN 60811-1-4, ITEM 8.2)
TEMPERATURE RANGE (DINAMIC):	-25°C / +80°C	-15°C / +90°C
UV RESISTANCE:	YES (UL1581/2556-300h)	-
OMOLOGATION:	UL STYLE 21215 + CSA, RATING 80°C 600V	-

WIRING DIAGRAM

- 1) WHITE □ 1
- 2) GREEN □ 2
- 3) YELLOW □ 3
- 4) GREY □ 4
- 5) PINK □ 5
- 6) RED □ 6
- 7) BLACK □ 7
- 8) VIOLET □ 8
- 9) GREEN-YELLOW □ 9
- 10) BROWN □ 10
- 11) BLUE □ 11
- 12) N/U □ 12

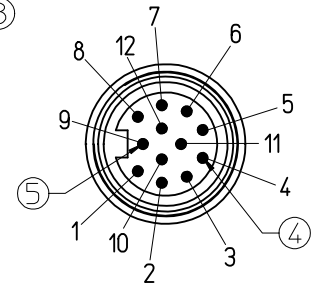
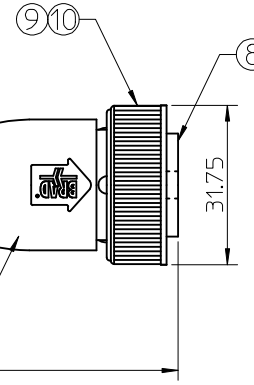
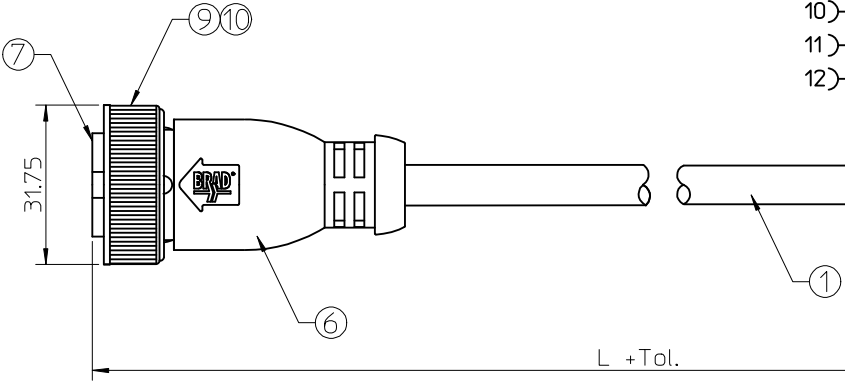
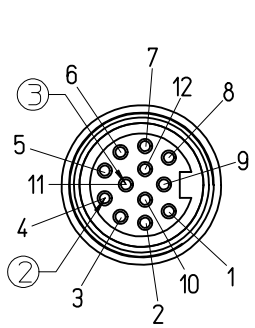

Bill of Materials

ITEM	QTY.	DESCRIPTION	MATERIAL	FINISH
10	2	FRICTION RING - C SIZE	NYLON	-
9	2	COUPLING NUT C-SIZE FEMALE	ZINC ALLOY	BLACK
8	1	12P MALE INSERT C-SIZE	PVC	YELLOW
7	1	12P FEMALE INSERT C-SIZE	PVC	YELLOW
6	-	OVERMOULD	PVC	YELLOW
5	3	MALE CONTACT 18AWG	BRASS	PLATE PER S-243 OR PER S-242
4	9	MALE CONTACT 22AWG	BRASS	PLATE PER S-243 OR PER S-242
3	3	FEMALE CONTACT 0.75	-	-
2	9	FEMALE CONTACT 0.34/0.5	-	-
1	-	CABLE 11W	SEE MATRIX	BLACK

<p>ORIGINAL RELEASE EC NO: IPG2015-0356 DRWN:FGAIK 2014/08/27 CHKD:WSTRASZKIEWI 2014/08/27 APPR:MIWASIECZKO 2014/08/29</p>	<p>QUALITY SYMBOLS</p> <p>▽=0 ∇=0</p>	<p>GENERAL TOLERANCES (UNLESS SPECIFIED)</p> <table border="1"> <thead> <tr> <th></th> <th>mm</th> <th>INCH</th> </tr> </thead> <tbody> <tr><td>4 PLACES</td><td>± ---</td><td>± ---</td></tr> <tr><td>3 PLACES</td><td>± ---</td><td>± ---</td></tr> <tr><td>2 PLACES</td><td>± 0.05</td><td>± ---</td></tr> <tr><td>1 PLACE</td><td>± 0.3</td><td>± ---</td></tr> <tr><td>0 PLACE</td><td>± 0.5</td><td>± ---</td></tr> </tbody> </table>		mm	INCH	4 PLACES	± ---	± ---	3 PLACES	± ---	± ---	2 PLACES	± 0.05	± ---	1 PLACE	± 0.3	± ---	0 PLACE	± 0.5	± ---	<p>DIMENSION STYLE</p> <p>MM ONLY</p>	<p>SCALE</p> <p>---</p>	<p>DESIGN UNITS</p> <p>METRIC</p>	<p>THIRD ANGLE PROJECTION</p>
		mm	INCH																					
	4 PLACES	± ---	± ---																					
	3 PLACES	± ---	± ---																					
2 PLACES	± 0.05	± ---																						
1 PLACE	± 0.3	± ---																						
0 PLACE	± 0.5	± ---																						
<p>ANGULAR ± 1 °</p>	<p>DRAFT WHERE APPLICABLE MUST REMAIN WITHIN DIMENSIONS</p>	<p>DRAWN BY: FGAIK DATE: 2014/08/27</p> <p>CHECKED BY: WSTRASZKIEWI DATE: 2014/08/27</p> <p>APPROVED BY: MIWASIECZKO DATE: 2014/08/29</p>	<p>MC-12P-11W-FE/M -ST/ST-XM-XXX</p>	<p>SIZE</p> <p>A3</p>	<p>SEE CHART 1</p>	<p>DOCUMENT NO. SD-130012-016</p>																		
<p>THIS DRAWING CONTAINS INFORMATION THAT IS PROPRIETARY TO MOLEX INCORPORATED AND SHOULD NOT BE USED WITHOUT WRITTEN PERMISSION</p>	<p>1 OF 1</p>	<p>1 OF 1</p>	<p>1 OF 1</p>	<p>1 OF 1</p>	<p>1 OF 1</p>	<p>1 OF 1</p>																		