

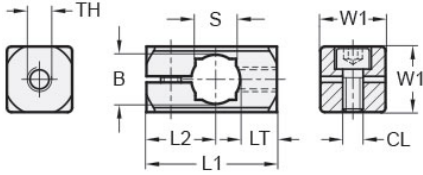

## MT12-CSBC-M6-AN

Ruland Sensor Bracket Clamp Connector, Thru Hole 12mm, Thread M6, L 32mm, Black Anodized Aluminum



### Description

Ruland MT12-CSBC-M6-AN is a sensor bracket clamp connector that attaches to a 12mm round or 10mm square tube and has an M6 center tapped hole, 16mm width and height, and 32mm overall length. It is designed to fit on Ruland tubes and flange bolt bases that begin with MT12. MT12-CSBC-M6-AN is aluminum with a black anodized finish and screws are 304 stainless steel for added corrosion resistance when compared to unplated types. This bracket clamp is used to support brackets for mounting sensors, screens, reflectors, plexiglass machine guards, and other industrial components. The bracket is mounted directly to the clamp by a single M6 screw. An MT10:12-ALK-M5-20 adjustable clamping handle can be used to rapidly reposition MT12-CSBC-M6-AN or the tube it is attached to without the use of tools. MT12-CSBC-M6-AN is manufactured by Otto Ganter, inventoried by Ruland, and RoHS3 compliant.

### Product Specifications

<b>Thru Hole Diameter B</b>	12 mm	<b>Thru Hole Tolerance</b>	+0.11/-0 mm
<b>Square Thru Hole S</b>	10 mm	<b>Thread (TH)</b>	M6
<b>Thread Depth LT</b>	9 mm	<b>Edge To Center L2</b>	17 mm
<b>Width &amp; Height W1</b>	16 mm	<b>Overall Length L1</b>	32 mm
<b>Clamp Screw CL</b>	M5	<b>Weight (lbs)</b>	0.038300
<b>Material Specification</b>	Anodized Aluminum	<b>Manufacturer</b>	JW Winco/ Otto Ganter
<b>UPC</b>	634529230626	<b>Country of Origin</b>	Germany
<b>Tariff Code</b>	7609.00.0000	<b>UNSPC</b>	31162908

**Note 1** Performance ratings are for guidance only. The user must determine suitability for a particular application.

**Prop 65**  **WARNING** This product can expose you to the chemical Nickel (metallic), known to the State of California to cause cancer. For more information go to [www.P65Warnings.ca.gov](http://www.P65Warnings.ca.gov).