

6

5

4

3

2

1

APPROVED: _____
DATE: _____ TITLE: _____

Rev	AWO #	Description	Date	Appr
-		RELEASED	9/17/07	
A		REDRAWN	5/18/11	
B		REVISED DIM.	5/24/12	
C		UPDATED DRAWING	3/4/16	HR/MLY

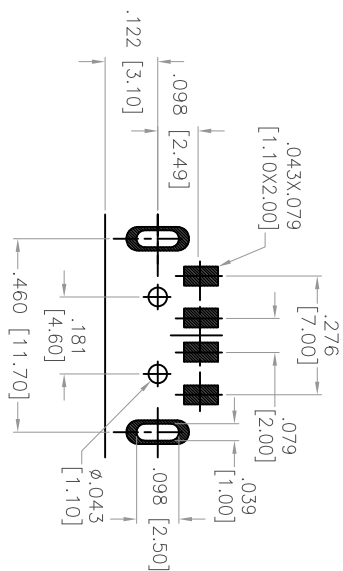
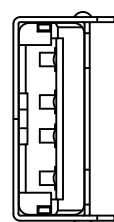

RECOMMENDED PCB LAYOUT

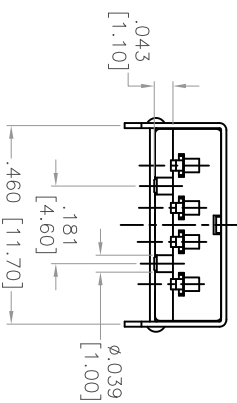
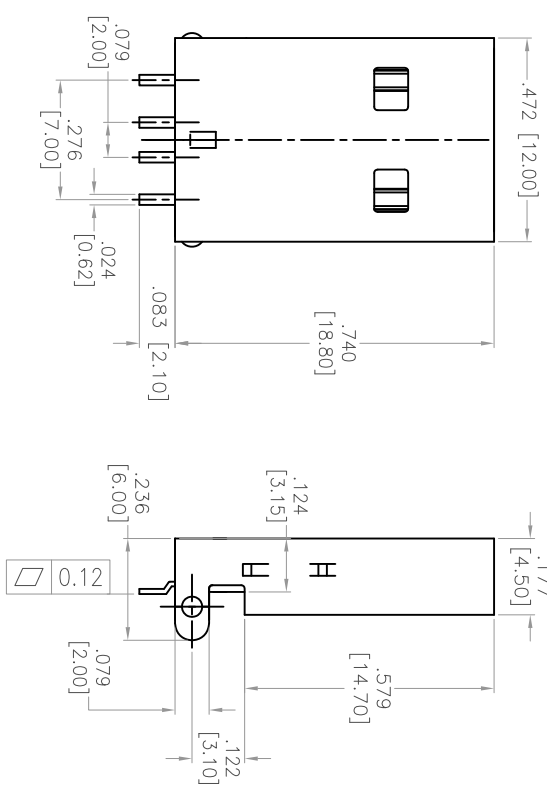

SPECIFICATIONS:

- Material: Insulator: Hi-temp thermoplastic, rated UL 94V-0
- Insulator color: Black
- Contacts: Brass
- Shell: SPCC, Nickel plated
- Plating: Gold Flash over Nickel underplate on contact area, Tin over Copper underplate on SMT tails
- Electrical: Operating voltage: 30 VAC
Current rating: 1.5 Amp
Contact resistance: 30 mohms max.
Insulation resistance: 1,000 Mohms min.
Dielectric withstanding voltage: 500 VAC for 1 minute
- Temperature Rating: Temperature range: -20°C to +60°C
- Environmental: Lead free, RoHS compliant.

ADAM TECH

909 Rahway Avenue, Union, NJ 07083
 Phone: 908-687-5000 Fax: 908-687-5710

TITLE: USB CONNECTOR, A TYPE PLUG, SMT
 SEL GOLD FLASH, BLACK INSULATOR

UNLESS OTHERWISE SPECIFIED ALL DIMENSIONS ARE INCHES [MM] TOLERANCES: EXCEPT AS NOTED		INCHES		HOLE SIZE	
.X	± .10	Ø.X	± .10		
.XX	± .020	Ø.XXX	± .015		
.XXX	± .015	Ø.XXX	± .010		
APPROVALS		DATE			
DRAWN	SS	9/17/07			
CHECKED					
APPROVED					
SIZE	PART NO.	TITLE		REV.	
X	USB-AP-S-RA-SMT	USB CONNECTOR, A TYPE PLUG, SMT SEL GOLD FLASH, BLACK INSULATOR		C	
REF:	S00005C	SCALE:	NTS	SHEET	1 OF 1



6

5

4

3

2

1