



wire connector 2 cables with control wire voltage tap-off 4 units accessory for: 3VA6 150/250

Model	
product brand name	SETRON
product designation	accessories
Product version	circular conductor terminal
Accessories	Wire connector
General technical data	
designation / of the terminal	TA2.3
Connections according IEC	
connectable conductor cross-section	
<ul style="list-style-type: none"> <li>for copper cable / stranded / minimum</li> <li>for copper cable / stranded / maximum</li> <li>for aluminum cable / stranded / minimum</li> <li>for aluminum cable / stranded / maximum</li> </ul>	25 mm <sup>2</sup> 150 mm <sup>2</sup> 25 mm <sup>2</sup> 150 mm <sup>2</sup>
stripped length	26 / 51 mm
tightening torque / when using copper cables	
<ul style="list-style-type: none"> <li>stranded</li> <li>finely stranded</li> </ul>	25 - 150 mm <sup>2</sup> : 31.1 Nm 25 - 150 mm <sup>2</sup> : 31.1 Nm
Connections according UL	
permissible temperature / of connectable conductor / according to UL 486A-486B	75 °C
stripped length	1.0 / 2.0 in
connectable conductor cross-section	
<ul style="list-style-type: none"> <li>for copper cable / stranded / minimum</li> <li>for copper cable / stranded / maximum</li> <li>for copper cable / finely stranded / minimum</li> <li>for copper cable / finely stranded / maximum</li> <li>for aluminum cable / stranded / minimum</li> <li>for aluminum cable / stranded / maximum</li> </ul>	4 AWG 300 kcmil 4 AWG 300 kcmil 4 AWG 300 kcmil
tightening torque / when using copper cables	
<ul style="list-style-type: none"> <li>stranded</li> <li>finely stranded</li> </ul>	4 AWG - 300 kcmil: 275 lb-in 4 AWG - 300 kcmil: 275 lb-in
Further information	

Information- and Downloadcenter (Catalogs, Brochures,...)

<http://www.siemens.com/lowvoltage/catalogs>

Industry Mall (Online ordering system)

<https://mall.industry.siemens.com/mall/en/en/Catalog/product?mlfb=3VA9244-0JC22>

Service&Support (Manuals, Certificates, Characteristics, FAQs,...)

<https://support.industry.siemens.com/cs/ww/en/ps/3VA9244-0JC22>

Image database (product images, 2D dimension drawings, 3D models, device circuit diagrams, ...)

[http://www.automation.siemens.com/bilddb/cax\\_en.aspx?mlfb=3VA9244-0JC22](http://www.automation.siemens.com/bilddb/cax_en.aspx?mlfb=3VA9244-0JC22)

CAX-Online-Generator

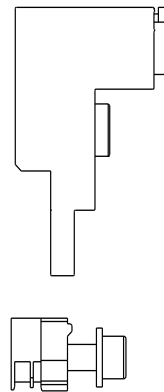
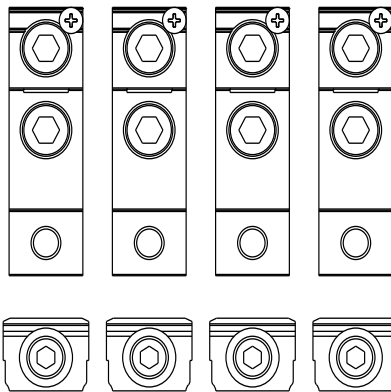
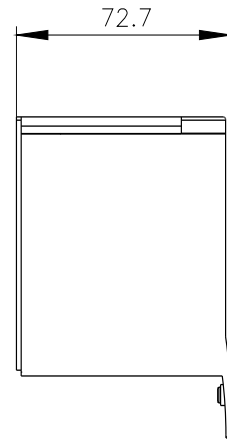
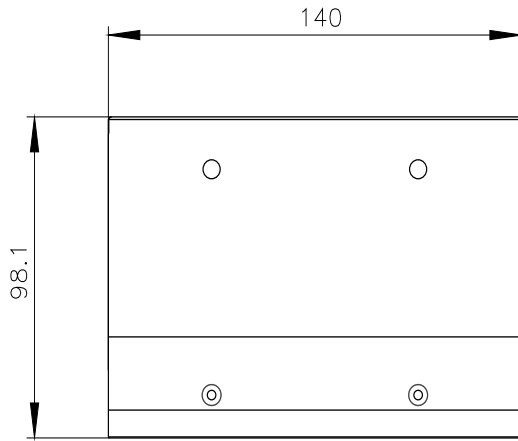

last modified:

7/5/2022

