

P.C.B. LAYOUT

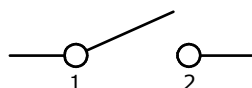

CIRCUIT: SPST

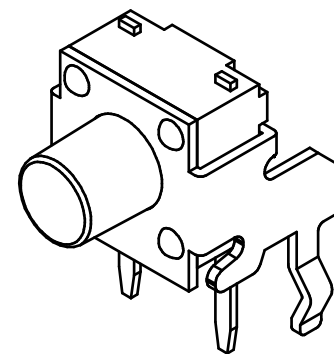

ISOMETRIC

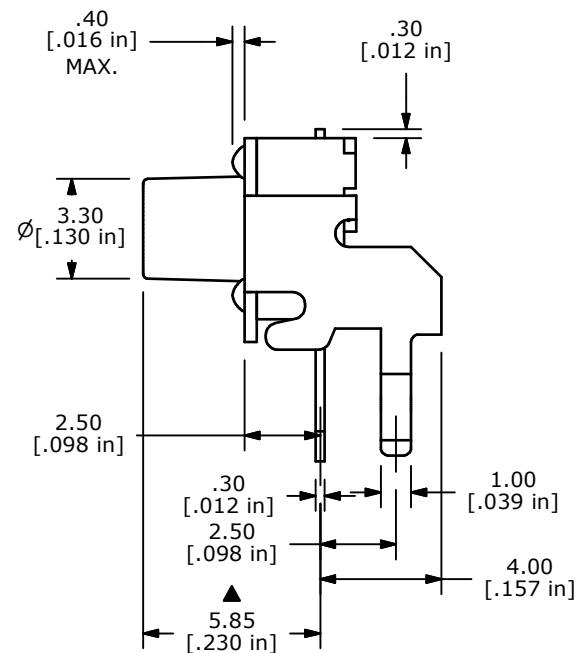
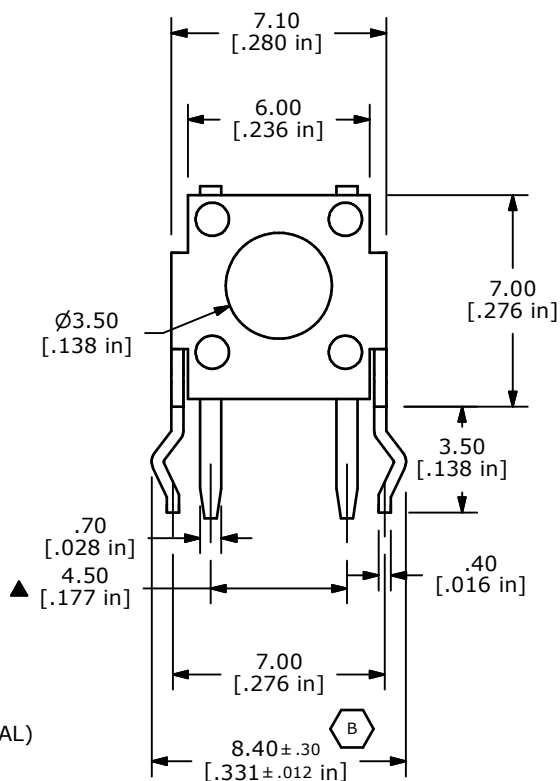

NOTES:

1. ALL DIMENSIONS IN MM
2. GENERAL TOLERANCE: X.X=±0.4
X.XX=±0.25
3. TERM. NOS. FOR REFERENCE ONLY.
4. RATING: 50VDC, 50mA
- ▲ 5. OPERATING FORCE: 100 ± 50 gms
6. TRAVEL: 0.3mm ±0.15
7. CONTACT RESISTANCE: 100 MILLI OHMS MAX. (INITIAL)
- ▲ 8. MECHANICAL/ELECTRICAL LIFE 100,000 CYCLES MIN.
- ▲ 9. SILVER CONTACTS
10. ▲DENOTES CRITICAL PARAMETER



| | | | | |
|-----|--------|---------------------------|----------|-----|
| B | 18742 | LEG TOLERANCE WAS +/- 0.1 | 12/22/09 | BLR |
| A | 14189 | RELEASED FOR PRODUCTION | 7/27/04 | BLR |
| REV | PCR NO | DESCRIPTION | DATE | BY |

| | | | | |
|--------------------|------------|-----|---------|-----|
| TITLE TL1105XF100Q | | | | |
| SCALE | DATE | DR | DWG | REV |
| 4:1 | 12/22/2009 | BLR | P020231 | B |

THE INFORMATION CONTAINED IN THIS DOCUMENT IS PROPRIETARY TO E-SWITCH AND IS NOT TO BE COPIED OR TRANSFERRED