

REVISIONS		DATE	BY	APPD
A7	ECR-19-000431	11APR2019	MSA	KK
AB	ECR-19-005955	12APR2019	AN	AB
A9	AREA FOR PUNCH OR LASER MARKING DEFINED	27APR2021	MAH	SCHO
A10	PCN-22-142062	07JUL2022	FRAN	SCHO

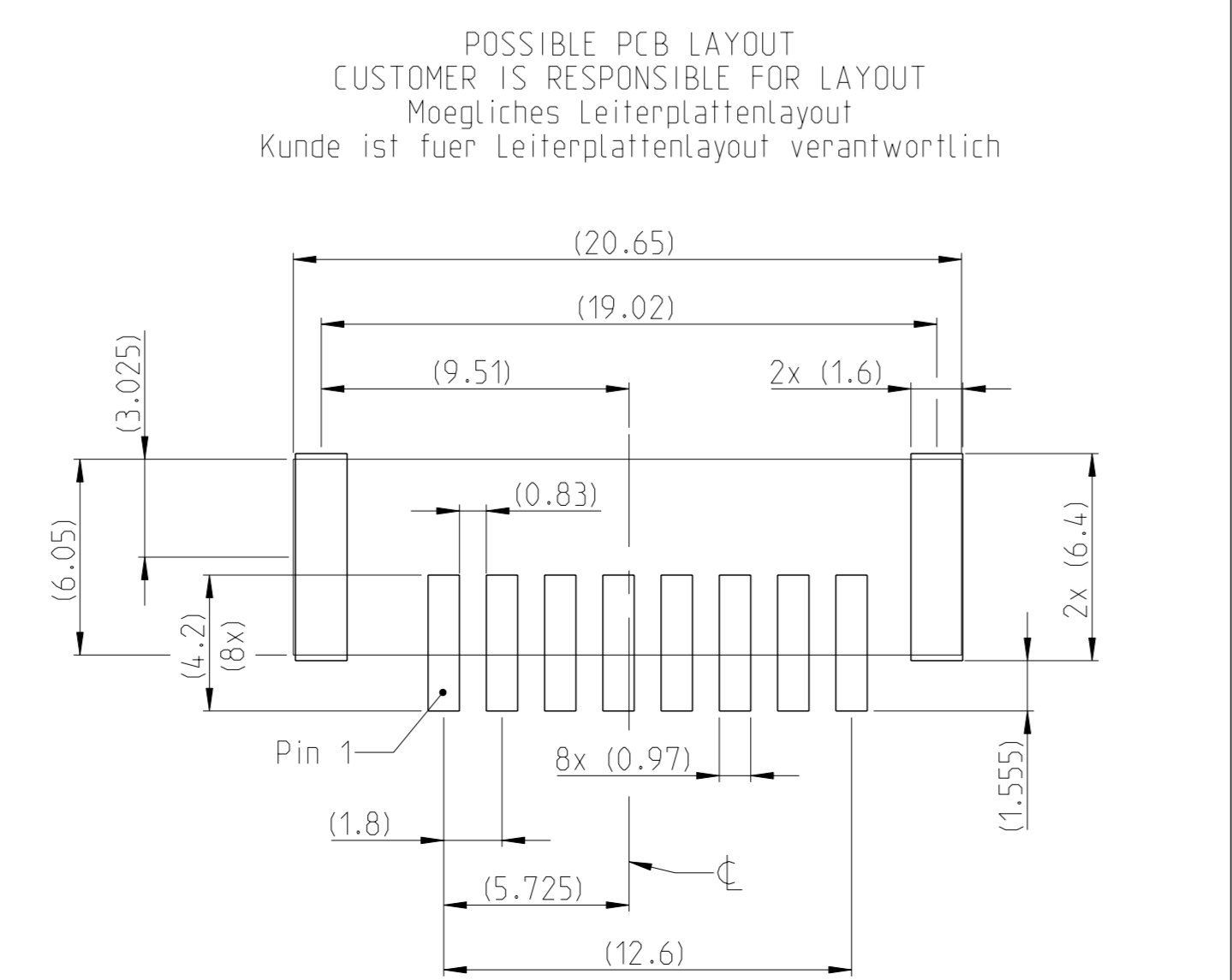

- NOTES  
Bemerkungen
- PRESS OUT FORCE FOR NANOMQS CONTACT >15N WITH FEED RATE 25mm/min  
Kontaktausdruckkraft fuer NanoMQS Kontakt >15N mit Vorschubgeschwindigkeit 25mm/min
  - PRESS OUT FORCE FOR SOLDER BRACKET >60N WITH FEED RATE 25mm/min  
Kontaktausdruckkraft fuer Loetblech >60N mit Vorschubgeschwindigkeit 25mm/min
  - INTERFACES ACC. TO 208-18060, Rev. A1 and 114-94000-17, Rev. B1  
Schnittstellen nach 208-18060, Rev. A1 and 114-94000-17, Rev. B1
  - INTERFACE IS NOT PART OF PPAP; TE CONNECTIVITY IS RESPONSIBLE FOR CONNECTOR SYSTEM  
Schnittstelle ist nicht Bestandteil des PPAP. TE Connectivity ist verantwortlich fuer Stecksystem
  - TOLERANCES ACC. TO DIN EN ISO 8015, DIN EN ISO 14405-1  
GENERAL TOL. ACC. TO DIN 16742 TIGS, EXCEPT ANGLE DIM. (SEE TITLE BLOCK)  
Tolerierung nach DIN EN ISO 8015, DIN EN ISO 14405-1  
Allgemeintoleranzen nach DIN 16742 TIGS, ausser Winkelmasse (siehe Schriftkopf)
  - PACKAGING IN TAPE & REEL ACC. TO V2311396  
Verpackung in Tape & Reel nach V2311396
  - SOLDER BRACKET SURFACE 3-8µm Sn OVER 1.0-2.5µm Ni  
Loetblechoberflaeche 3-8µm Sn ueber 1.0-2.5µm Ni
  - CONTACT SURFACE SOLDER SIDE 3-8µm Sn OVER 1.0-2.5µm Ni, MATING SIDE Sn ACC. 114-94201  
Kontaktloetflaeche Loetseitig 3-8µm Sn ueber 1.0-2.5µm Ni, Steckseite Sn nach 114-94201
  - FOR MISSING DIMENSION SEE CAD-MODEL 2311396, REV. A  
Fehlende Masse sind dem CAD-Model 2311396, Rev. A zu entnehmen
  - AREA FOR GOOD PART MARKING; WITH PUNCH MARK OR LASER MARKING  
Bereich fuer Gutteilmarkierung; Mit Koerperpunkt oder Lasermarkierung
  - ELECTRICAL 100% FINAL INSPECTION FOR CONTINUITY AND SHORT CIRCUIT  
AS WELL AS EXISTENCE OF ALL CONTACTS  
Elektrische 100% Endpruefung auf Durchgang und Kurzschluss,  
sowie das Vorhandensein aller Kontakte
  - REFERENCE POINTS A5.6.7.8 ARE ON OPPOSITE SITE OF A1.2.3.4  
Bezugspunkte zu A5.6.7.8 auf gegenueberliegender Seite von A1.2.3.4
  - SOLDERING PROCESS: LEAD-FREE REFLOW SOLDERING IN REFERENCE TO JEDEC J-STD-020D  
Loelprozess: Bleifreies Loeten in Anlehnung an JEDEC J-STD-020D
  - COLOURED IDENTIFICATION MARK FOR C-SAMPLES  
Farbliche Markierung fuer C-Muster
  - CUT-OUT WITH PLAIN STAMPING EDGES  
Ausschnitt mit blanken Stanzkanten
  - POSITION OF HOUSING PN, REVISION AND MATERIAL MARKING MAY DIFFER FROM SERIES TO PRE-SERIES  
Position der Gehaeuse-PN, Revision und Materialkennzeichnung abweichend von Serie zu Vorserie
  - FURTHER VARIANT SEE FAMILY DRAWING 2331612  
Weitere Varianten siehe Familien Zeichnung 2331612
  - PINS OPTIONAL ALLOWED, BUT AT CPA-CONNECTOR WITHOUT ELECTRIC FUNCTION  
Pins optional zulaessig, aber bei CPA-Stecker ohne elektrische Funktion

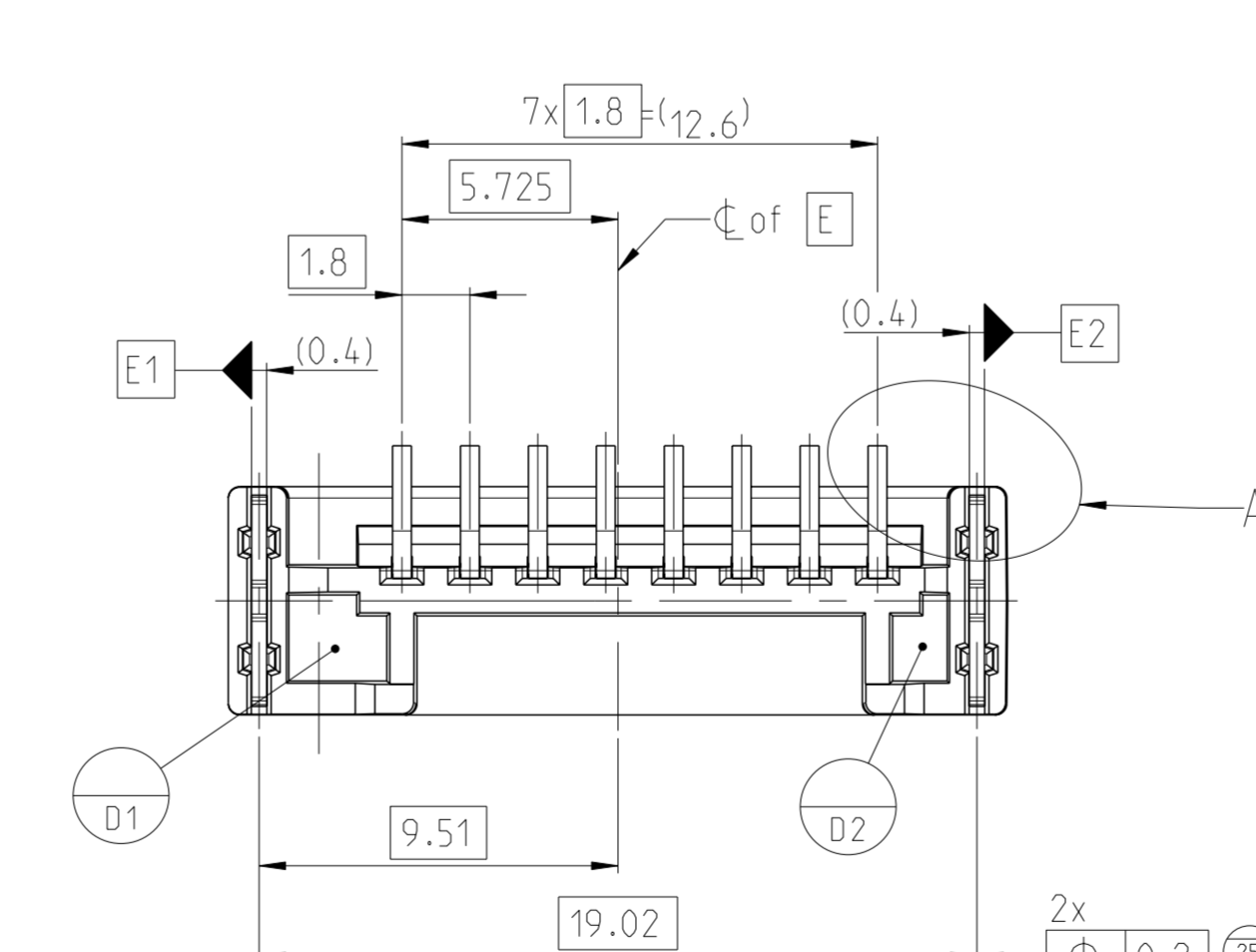
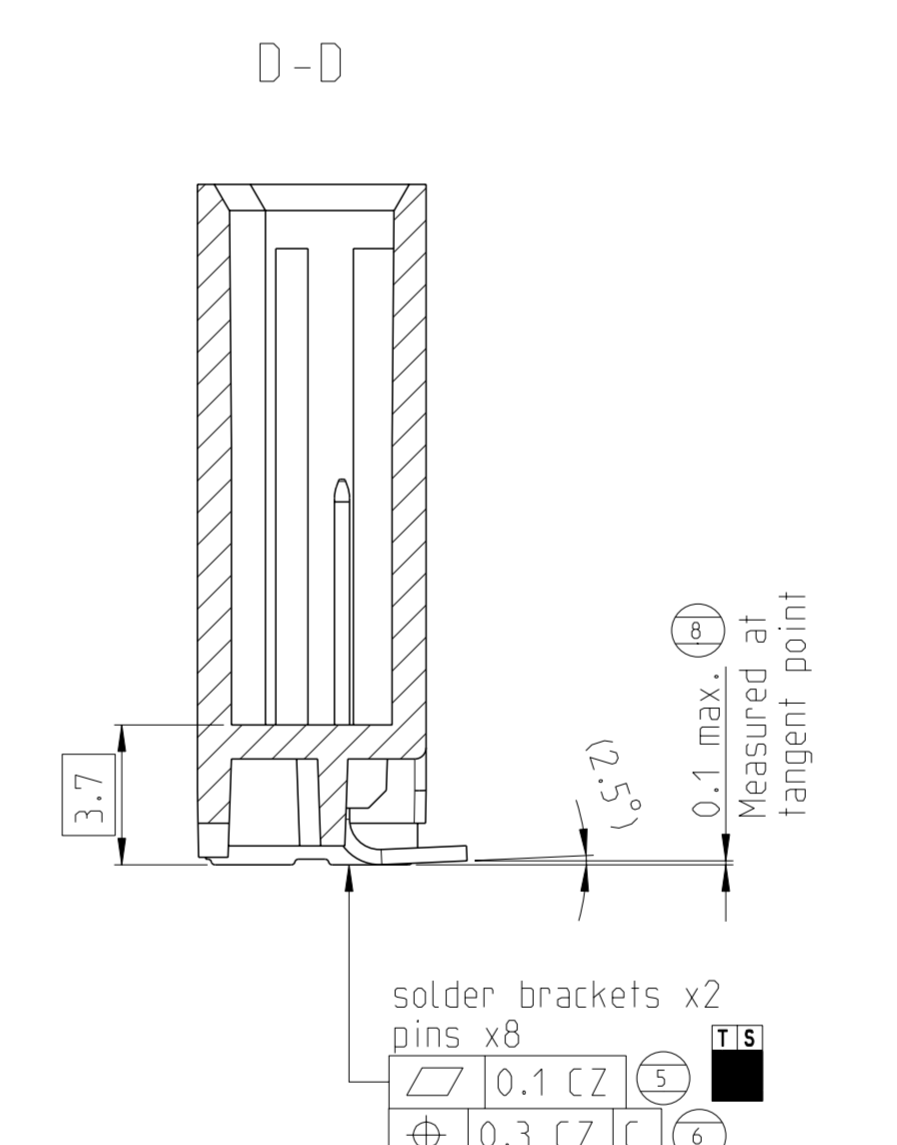
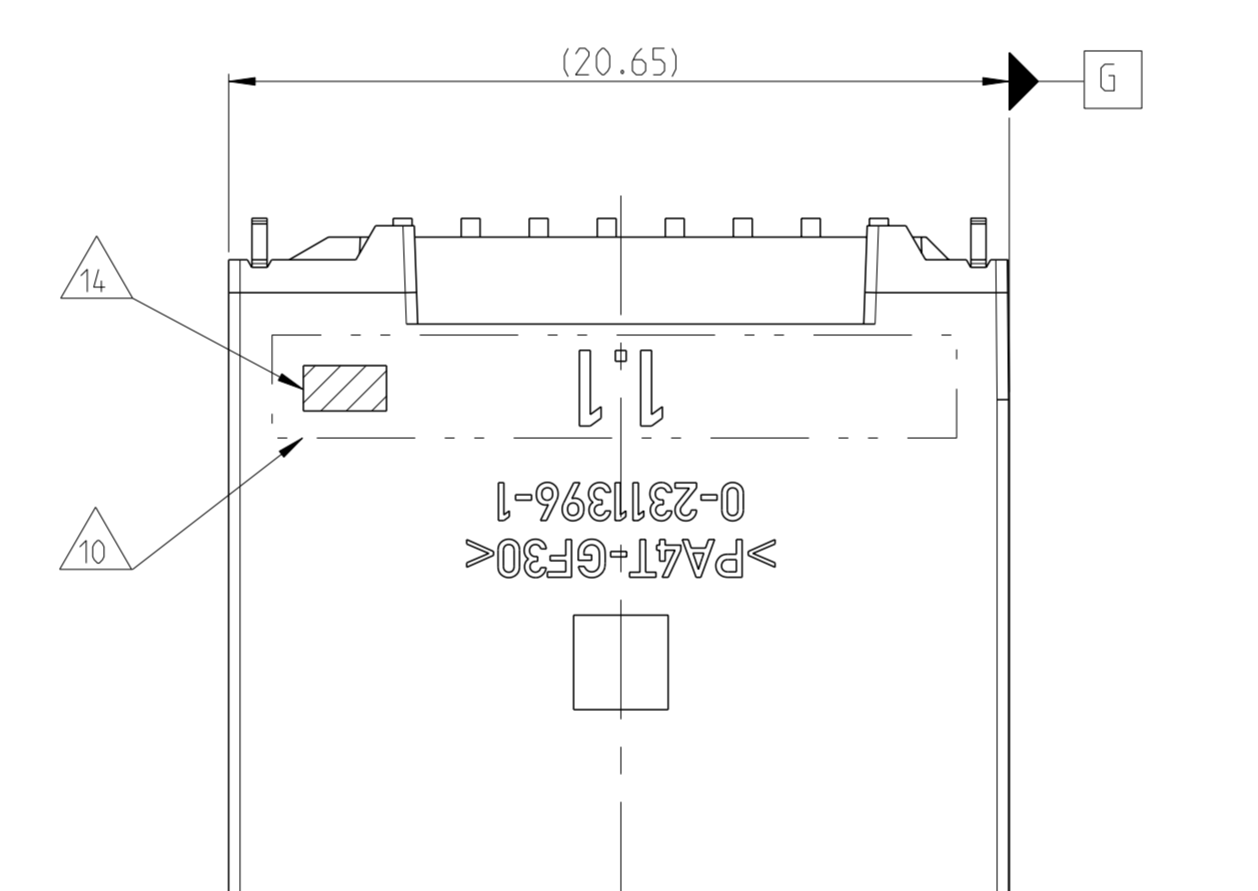
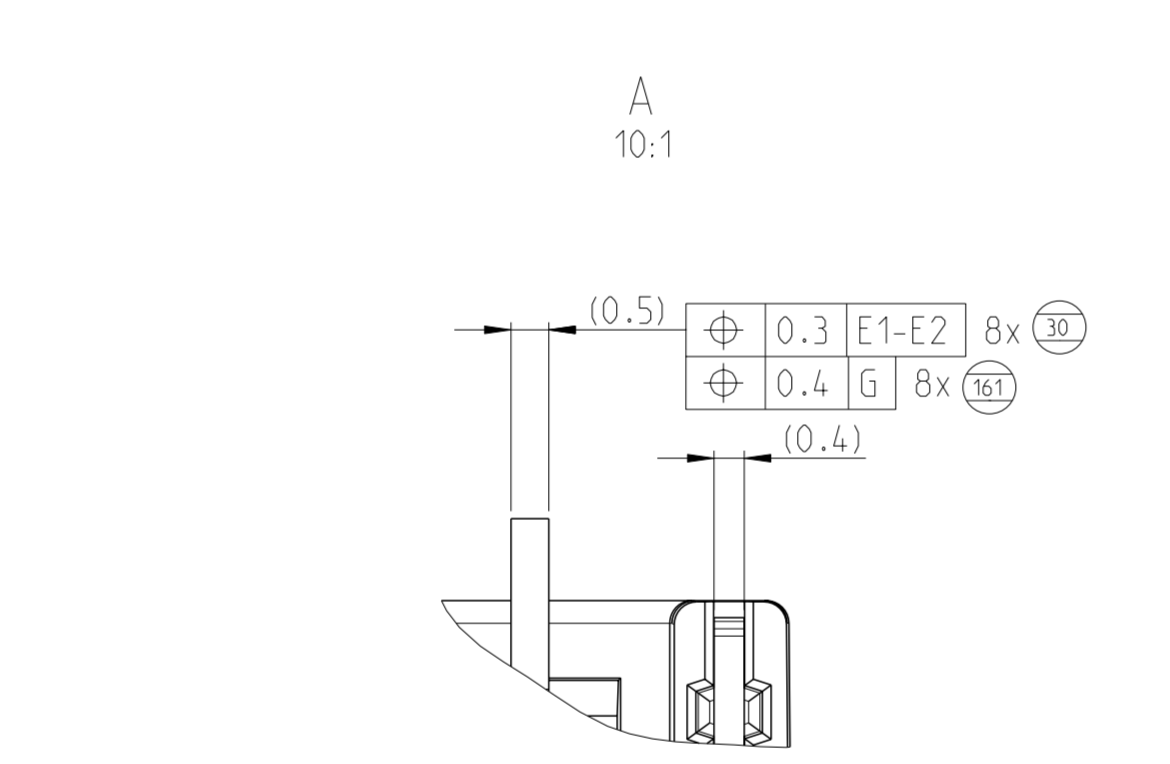
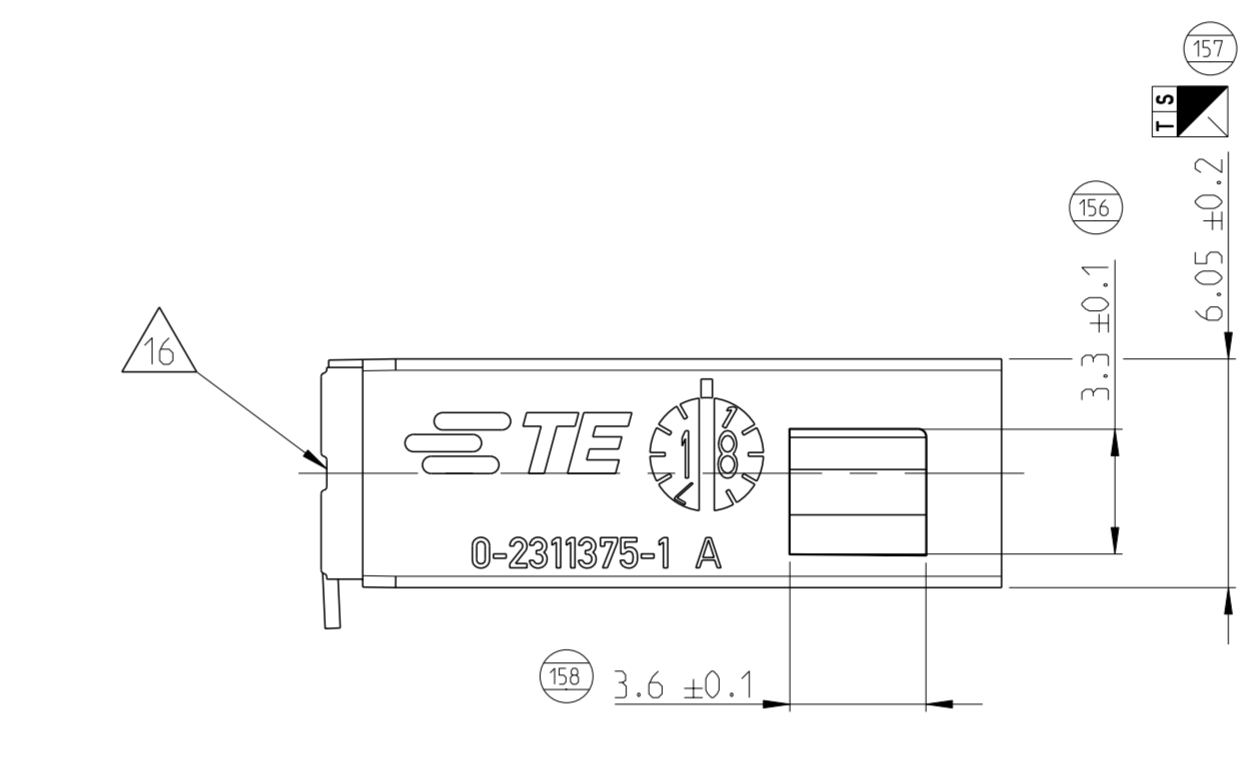
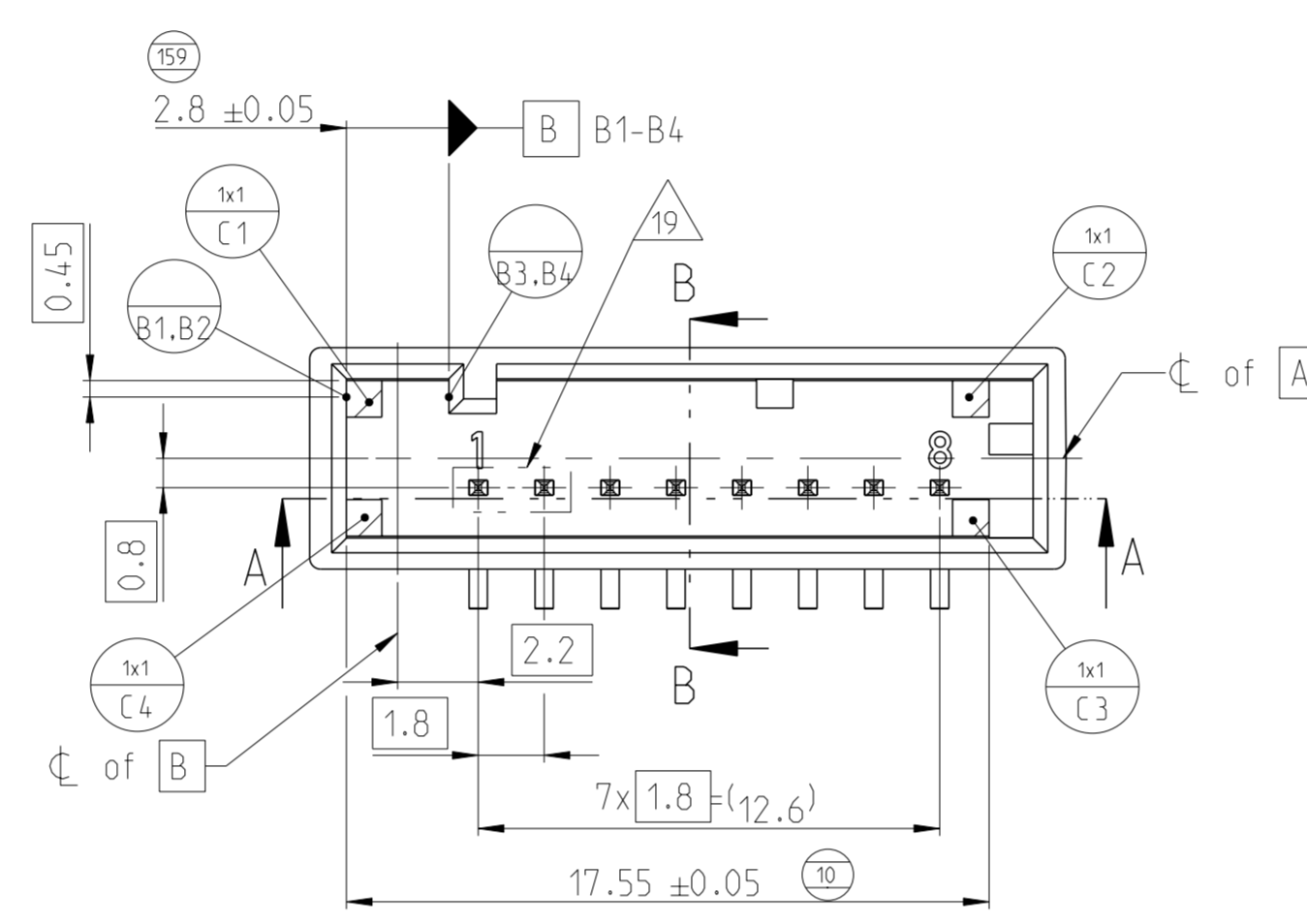
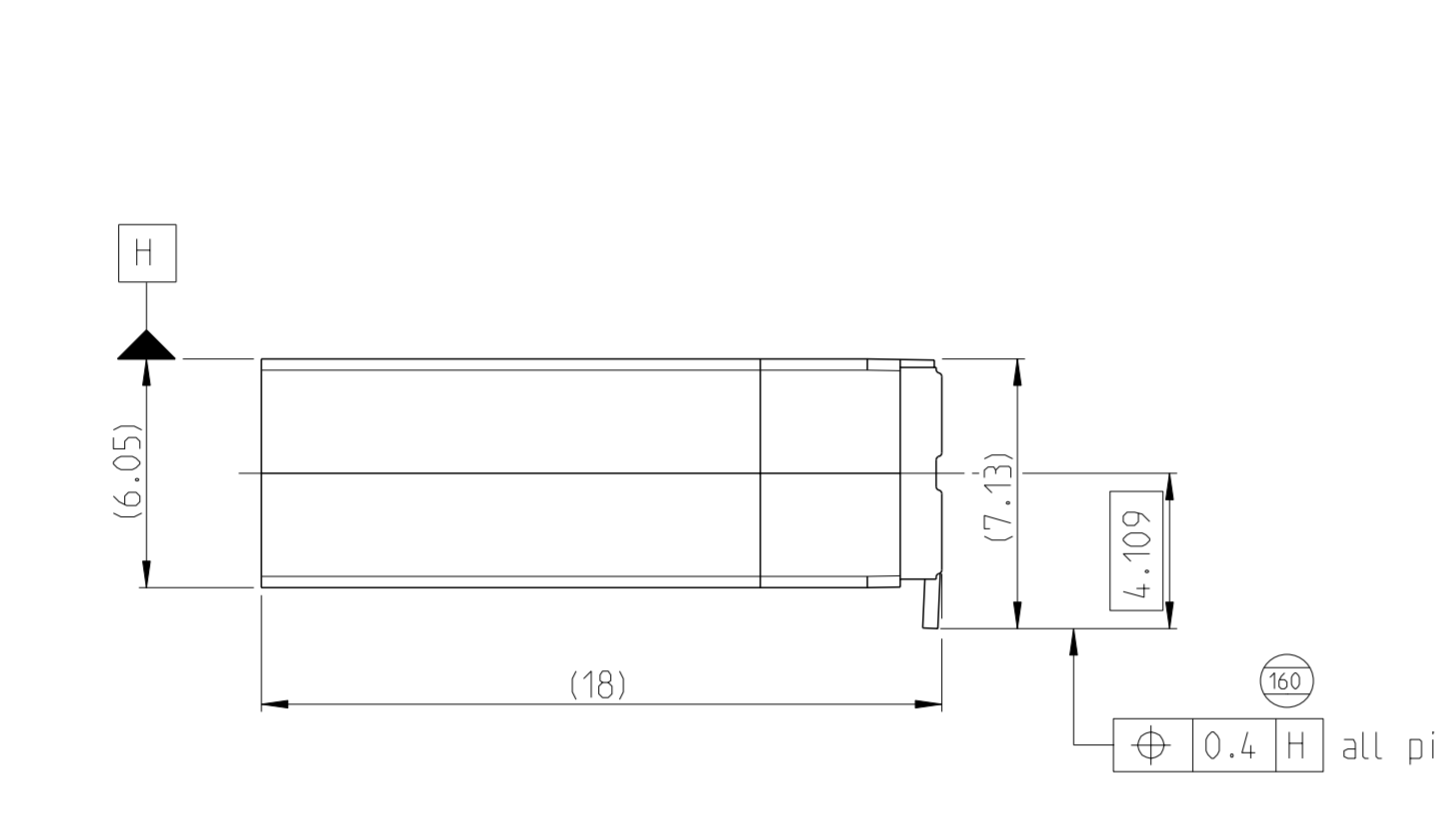
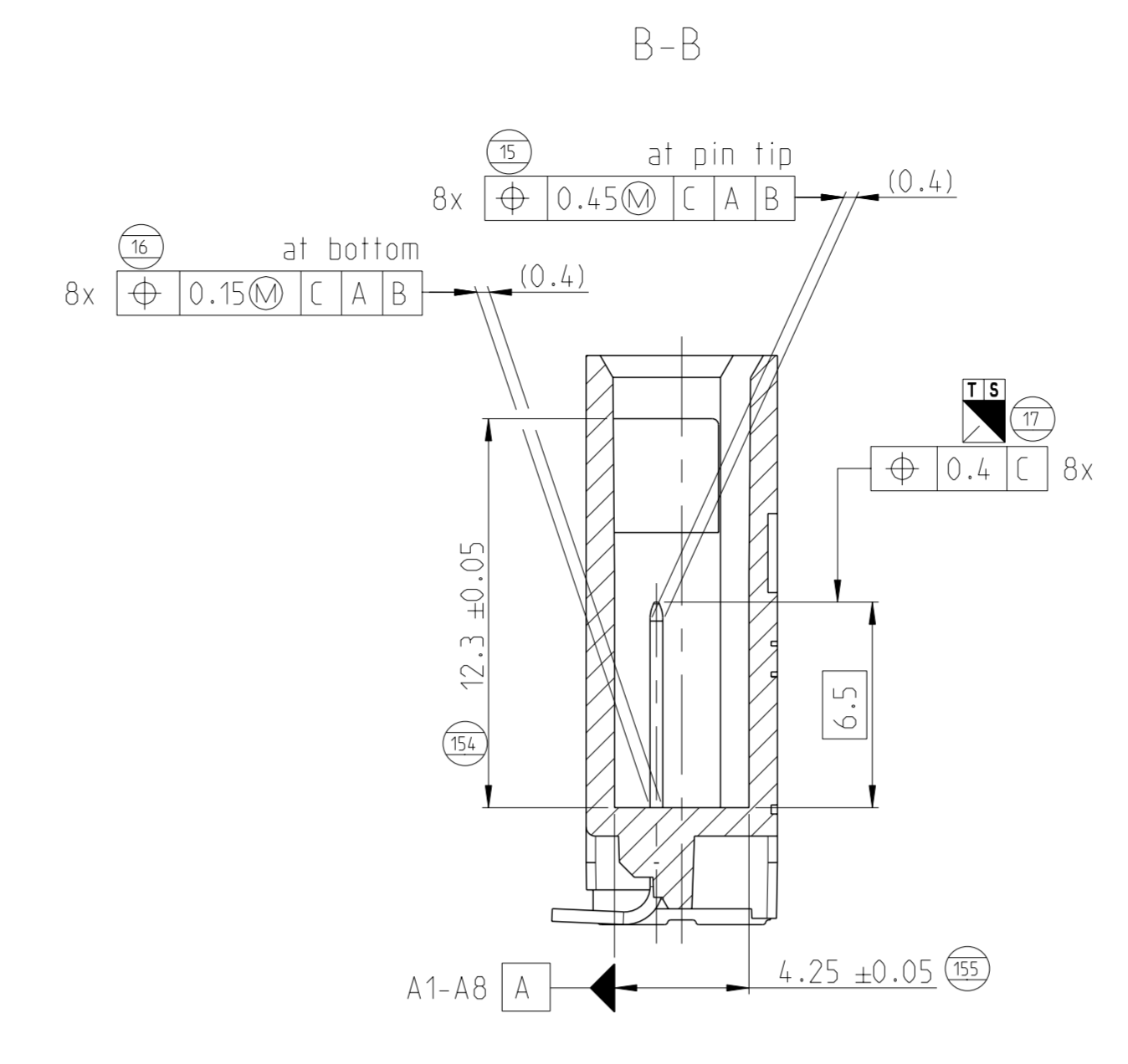
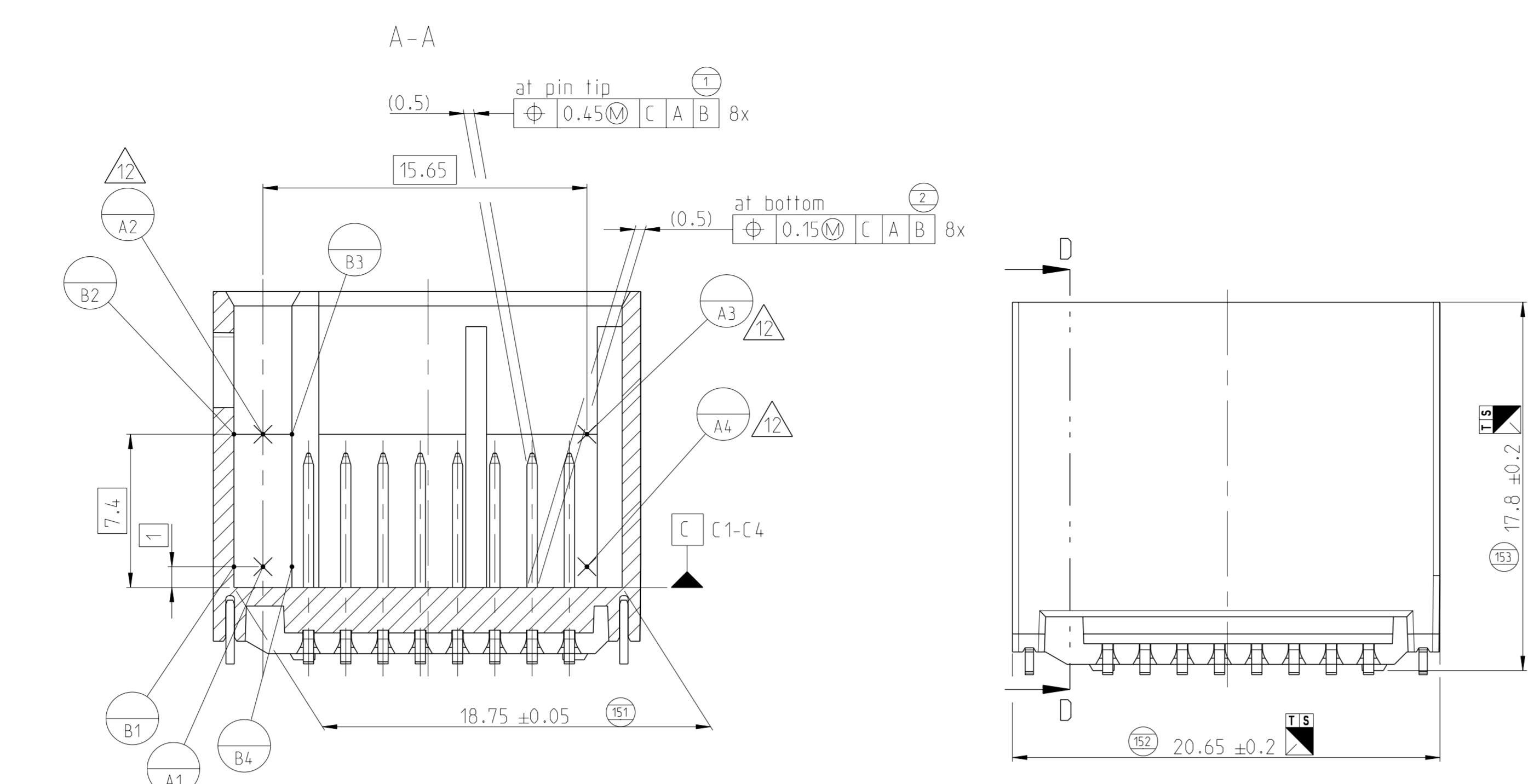
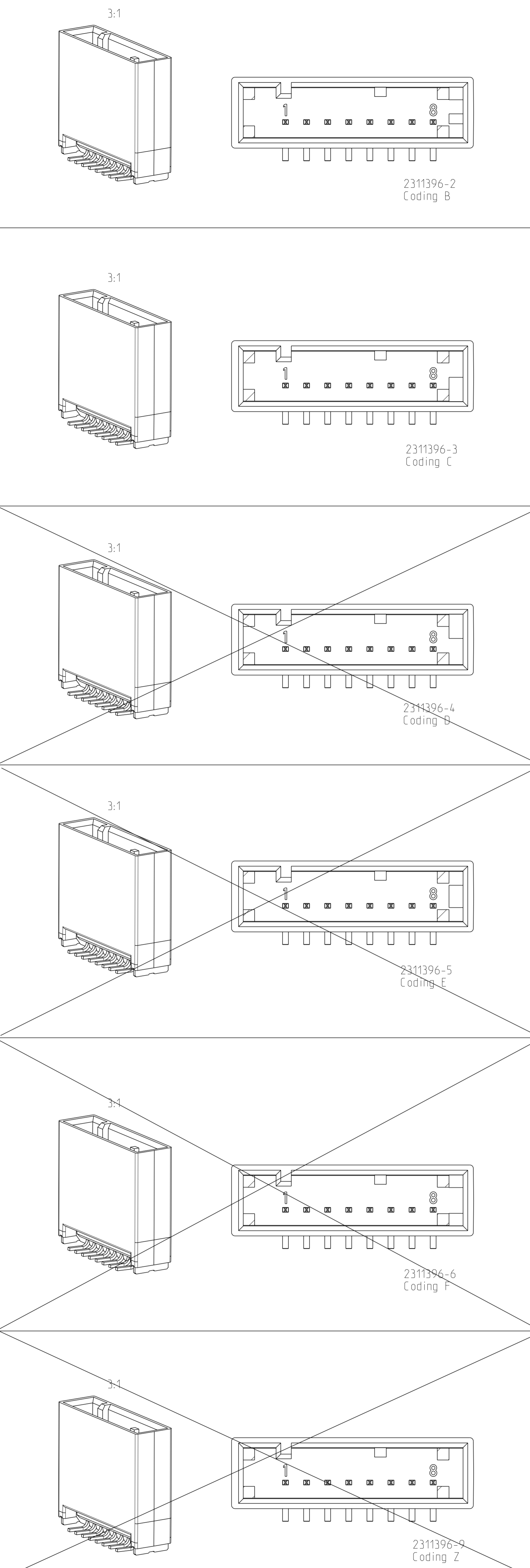
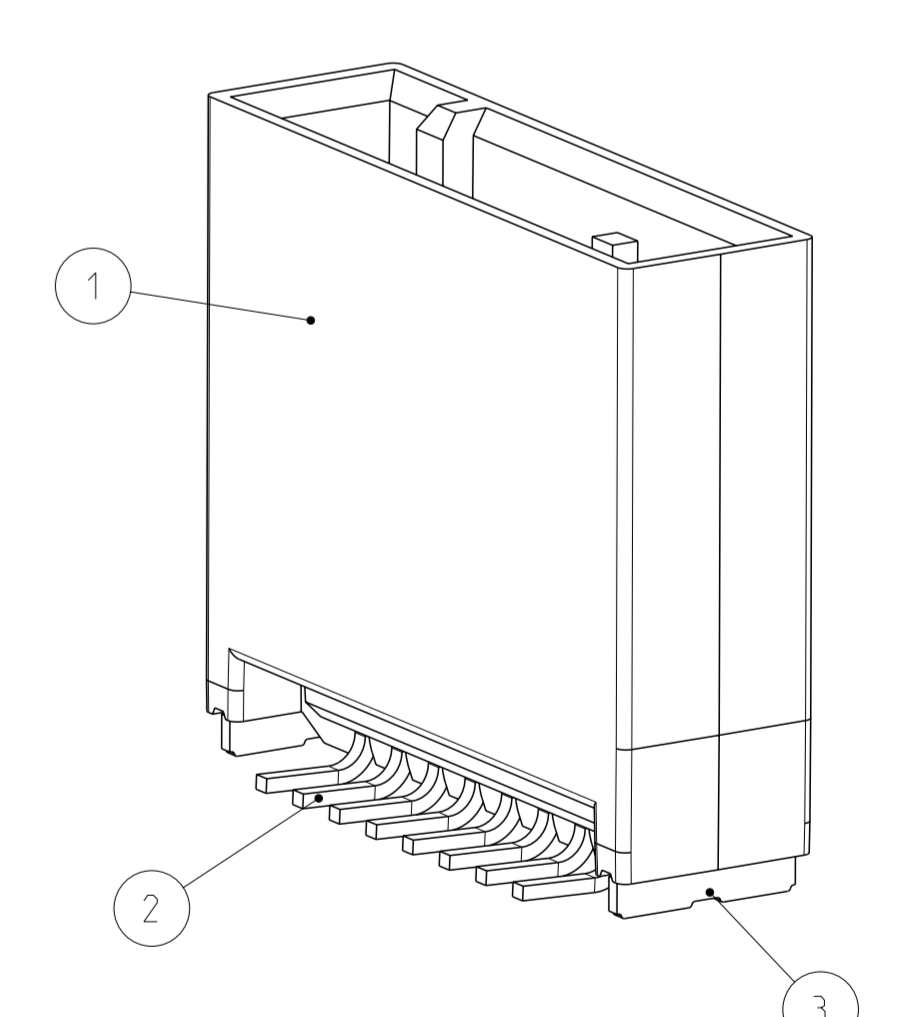

SERIES								PN: 2282267 - suitable Receptacle Housing w/o CPA						
x- -1	x- -2	x- -3	x- -4	n/a	n/a	n/a	x- -9	PN: 2309873 - suitable Receptacle Housing w/ CPA						
2	2	2	2	2	2	2	2	Solder Brackets	-	A	Copper-Alloy	△	-	3
8	8	8	8	8	8	8	8	NanoMQS Pin	-	A	Copper-Alloy	△	-	2
-	-	-	-	-	-	-	1	Bpos Header Assy	Z	A	PA4T-GF30	waterblue	5021	1
-	-	-	-	-	-	-	-	Bpos Header Assy	F	A	PA4T-GF30	brown	1bd	1
-	-	-	-	-	-	-	-	Bpos Header Assy	E	A	PA4T-GF30	green	1bd	1
-	-	-	-	-	-	-	-	Bpos Header Assy	D	A	PA4T-GF30	claret-violet	4004	1
-	-	1	-	-	-	-	-	Bpos Header Assy	C	A	PA4T-GF30	blue	5005	1
-	1	-	-	-	-	-	-	Bpos Header Assy	B	A	PA4T-GF30	nature	-	1
1	-	-	-	-	-	-	-	Bpos Header Assy	A	A	PA4T-GF30	black	9011	1
DESCRIPTION								COD.	REV.	MATERIAL	SURFACE/COLOR	RAL (similar)	POS.	
A	A	A	A	A	A	A	A	Assy. REV.						
0-x-1	0-x-2	0-x-3	0-x-4	0-x-5	0-x-6	0-x-9	TE PARTNUMBER							
1.51	1.51	1.49	1.48	1.49	1.51	1.46	theoretical weight [gr.]							

THIS DRAWING IS A CONTROLLED DOCUMENT.

100% Inspection

cmk >= 1.67

Gauge Inspection

STE

TE Connectivity

8pos NanoMQS 180deg SMD, Assembly

00779 ©=2311396

SCALE 5:1 SHEET 1 of 1

0-2311396-1 AS SHOWN wie gezeichnet