

P/N: 46437-1226

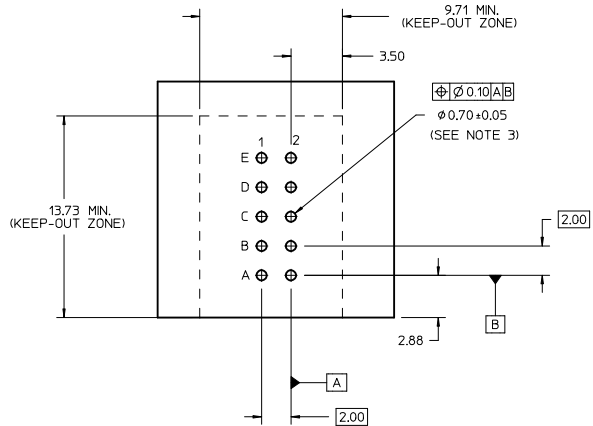
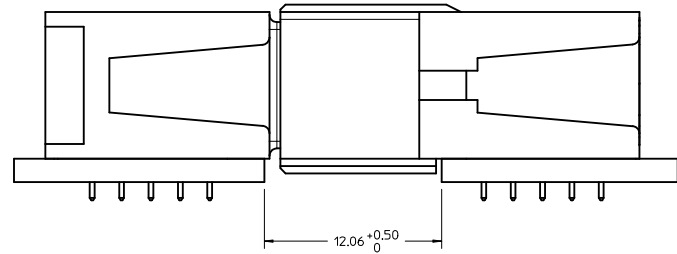
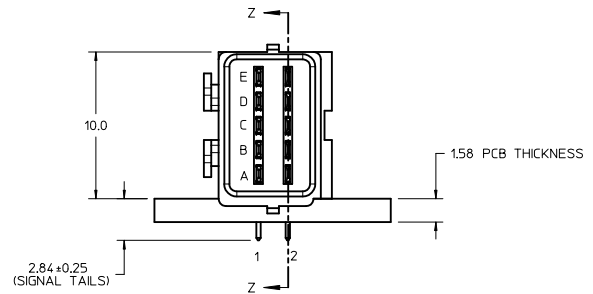

NOTES:

- MATERIAL:
  - HOUSINGS: LCP UL94 V-0, COLOR: BLACK.
  - TERMINALS: COPPER ALLOY.
  - PLATING: 0.00127mm NICKEL OVERALL WITH 0.00254mm SELECTIVE MATTE TIN ON TAILS. AND 0.000762mm SELECTIVE GOLD ON CONTACT AREA.
- ASSEMBLIES TO BE TRAY PACKED, STD. QUANTITY: TBD.
- PC BOARD REQUIRES PLATED THRU HOLES. REFER TO PS-46436-100 FOR DETAILS.
- PRODUCT SPEC: PS-46436-100.
- APPLICATION SPEC: AS-46436-100.
- SEE PRODUCT SPEC. FOR ROHS REQUIREMENTS.
- ASSEMBLY MATES WITH MOLEX RECEPTACLE ASSEMBLY, P/N 46436-1226.

RECOMMENDED PCB LAYOUT AND KEEP-OUT ZONE

INITIAL RELEASE IEC NO. UCF2012-1145 DRAWN BY BPI/SZCZOR 2012/05/14 CHECKED BY CHYD/BPI/SZCZOR 2012/05/31 APPR: APATEL 2012/06/07	QUALITY SYMBOLS ▽=0 ▽=0 ▽=0	GENERAL TOLERANCES (UNLESS SPECIFIED) mm      INCH		DIMENSION STYLE <b>MM ONLY</b>	SCALE <b>6:1</b>	DESIGN UNITS <b>METRIC</b>	THIRD ANGLE PROJECTION
		4 PLACES ±--- ±--- 3 PLACES ±--- ±--- 2 PLACES ±0.13 ±--- 1 PLACE ±0.25 ±--- 0 PLACE ±--- ±---	DRAWN BY DATE BPI/SZCZOR 2012/05/14 CHECKED BY DATE BPI/SZCZOR 2012/05/31 APPROVED BY DATE APATEL 2012/06/07	TITLE <b>R/A PLUG ASSY          10S NO GUIDES          TEN60 POWER FAMILY</b>		MATERIAL NO. <b>46437-1226</b>	DOCUMENT NO. <b>SD-46437-1226</b>

THIS DRAWING CONTAINS INFORMATION THAT IS PROPRIETARY TO MOLEX INCORPORATED AND SHOULD NOT BE USED WITHOUT WRITTEN PERMISSION