

RECOMMENDED PCB LAYOUT
(Top View)

Material and Finish

Insulator: High Temperature Thermoplastic, UL 94V-0 Rated, Color: Black or White

Shell: Brass, Nickel Plated

Contact Material: Phosphor Bronze

Contact Plating Options:

Standard: Gold Flash on Mating End, Tin on Termination End, Nickel Underplate on Entire Contact

30 Option: 30u" Gold on Mating End, Tin on Termination End, Nickel Underplate on Entire Contact

Electrical Specifications

Rated Current: 1.5A

Rated Voltage: 30V RMS

Insulation Resistance: 1000 Megohms Min.

Contact Resistance: 30 milliohms Max.

Dielectric Withstanding Voltage: 500V for 1 Minute

Mechanical Specifications

Insertion Force: 35N Max.

Withdrawal Force: 10N Min.

Durability: 1500 Mate Cycles Min.

Operating Temperature: -55°C to +85°C

Part Number	Insulator Color	Contact Area Plating Finish
KUSBX-SMT4-ASFS1N-BTR	Black	Gold Flash (Standard)
KUSBX-SMT4-ASFS1N-B30TR	Black	30u" Gold (30 Option)
KUSBX-SMT4-ASFS1N-WTR	White	Gold Flash (Standard)
KUSBX-SMT4-ASFS1N-W30TR	White	30u" Gold (30 Option)

Tolerances
X.X ± 0.25
X.XX ± 0.15
Unless Stated Otherwise



REV.	DATE	DESCRIPTION	REV. BY	CHK. BY	DRAWN BY	DATE
A0	02/14/19	New Drawing	C. Kelleher	D. Shehan	.C. Kelleher	02/13/19
A1	04/25/19	Release Drawing DC19-004	G. Serrato	D. Shehan		
A2	01/05/21	ECO #21-001	C. Kelleher	C. Furumasu		

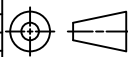

UNITS
mm

KUSBX-SMT4-ASFS1N-xxx

USB Socket, Type-A,

Right Angle, SMT,

