

ASSEMBLY	CKT	PEG	VOID POSITION	PLATING	DIMENSIONS				
					A	B	M	P	F
151011-0201	02	N	-	4	4.00	2.00	3.30	3.00	8.30
151011-0202	02	Y	-	4	4.00	2.00	3.20	2.80	8.00
151011-0600	06	N	3 & 4	4	12.00	10.00	3.20	2.85	8.05

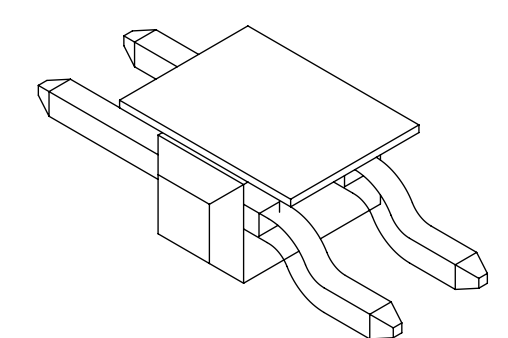

ISO VIEW WITH KAPTON TAPE

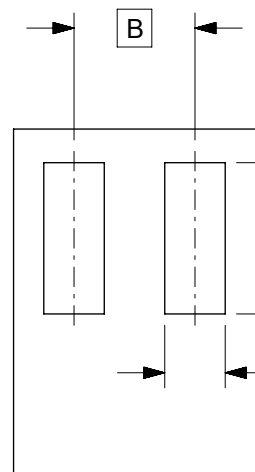
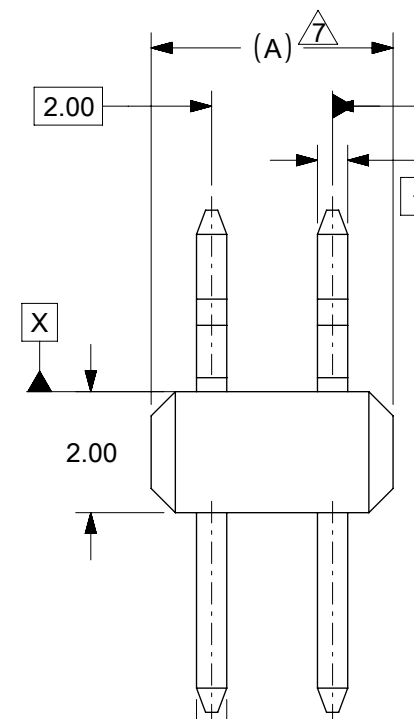

RECOMMENDED PCB LAYOUT

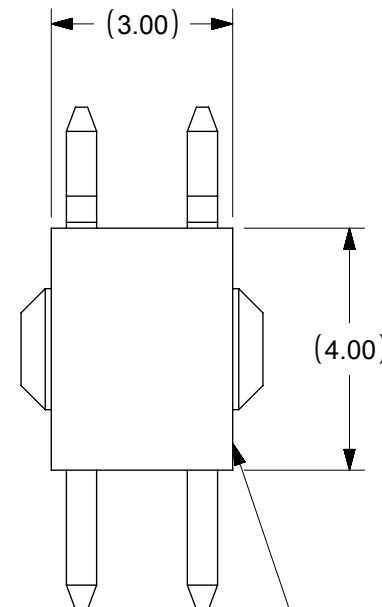

5 KAPTON TAPE PART WITH KAPTON TAPE 2CKT SHOWN FOR ILLUSTRATION ONLY

- NOTES**
- MATERIAL:**
HSG: LCP, GLASS-FILLED, UL94V-0 COLOR: BLACK
PIN: 0.50MM SQ, COPPER ALLOY
 - PLATING TYPE:**
 - GOLD FLASH ON CONTACT AND 2.50µm MIN. TIN ON SOLDER TAIL OVER 1.25µm MIN. NICKEL OVERALL.
 - 0.38µm MIN. GOLD PLATE ON CONTACT AND 2.50µm MIN. TIN ON SOLDER TAIL OVER 1.25µm MIN. NICKEL OVERALL.
 - 0.75µm MIN. GOLD PLATE ON CONTACT AND 2.50µm MIN. TIN ON SOLDER TAIL OVER 1.25µm MIN. NICKEL OVERALL.
 - 2.50µm MIN TIN OVERALL 1.25µm NICKEL OVERALL
 - PRODUCT SPECIFICATION:** PS-87761-100
 - PACKAGING TYPE:** TAPE AND REEL, : PK-87858-300
 - 5 KAPTON TAPE IS CENTERED ALONG THE PART AS SHOWN.
 - RECOMMENDED PCB THICKNESS IS 1.60mm±0.10
 - 7 IRREGULAR CIRCUIT CUTOFF WITHIN BREAKAWAY SECTION IS PERMISSIBLE. CUTTING OR CHIPPING OF THE MAIN BODY IS NOT ACCEPTABLE.
 - 8 COPLANARITY IS TO BE MEASURED BY RESTING THE SOLDER TAIL ON A FLAT SURFACE.
 - THE ABOVE CKT 2 IS FOR ILLUSTRATION PURPOSE ONLY

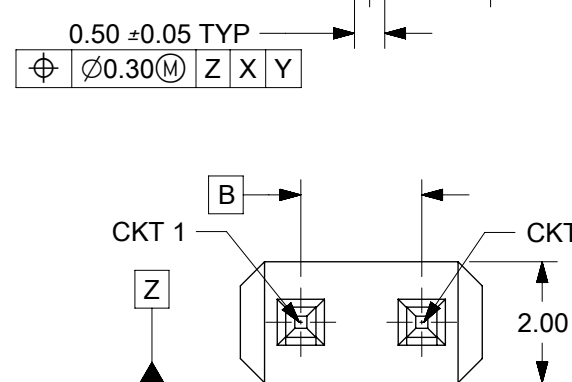

HOUSING WITHOUT PEG

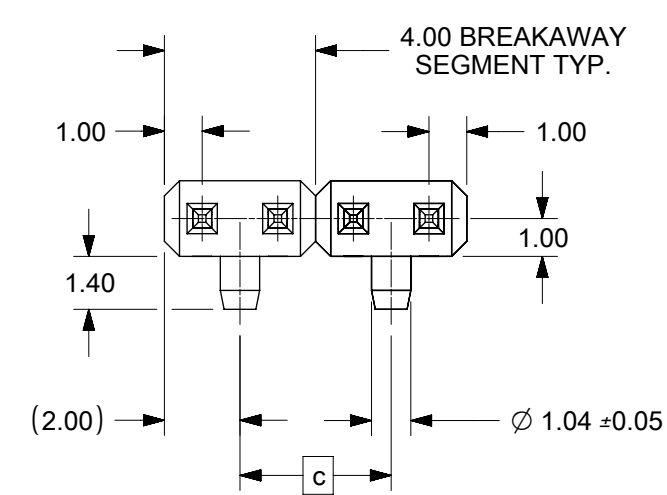
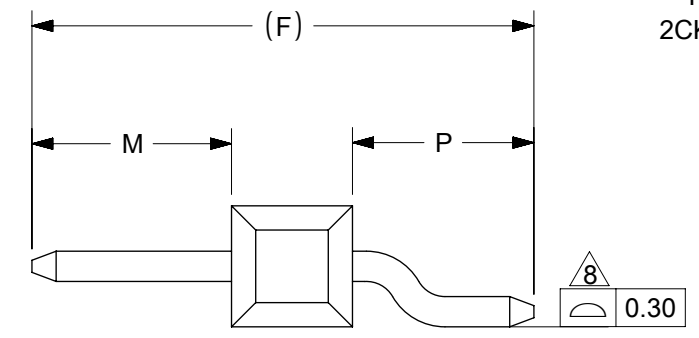

HOUSING WITH PEG

SYMBOLS	THIS DRAWING CONTAINS INFORMATION THAT IS PROPRIETARY TO MOLEX ELECTRONIC TECHNOLOGIES, LLC AND SHOULD NOT BE USED WITHOUT WRITTEN PERMISSION		CURRENT REV DESC: P/N 151011-0202 ADD		molex
	mm	NTS			
▽ = 0	GENERAL TOLERANCES (UNLESS SPECIFIED)				CUSTOM HEADER 2.00MM PITCH SINGLE ROW SINGLE WAFER SMT
▽ = 0	MM	INCH			
▽ = 0	4 PLACES ±		EC NO: 619230		PRODUCT CUSTOMER DRAWING
▽ = 0	3 PLACES ±		DRWN: GJEEVANSURES 2019/06/17		
▽ = 0	2 PLACES ±	0.2	CHK'D: GJEEVANSURES 2019/06/18		DOCUMENT NUMBER SD-151011-0201
▽ = 0	1 PLACE ±		APPR: ISHWARG 2019/06/18		
▽ = 0	0 PLACES ±		INITIAL REVISION:		DOC TYPE PSD
▽ = 0	ANGULAR TOL ±	3.0°	DRWN: ATSEE 2014/09/04		DOC PART 000
▽ = 0	DRAFT WHERE APPLICABLE MUST REMAIN WITHIN DIMENSIONS		APPR: LBLEE 2014/10/03		REVISION C3
▽ = 0	THIRD ANGLE PROJECTION		DRAWING A3-SIZE	SERIES 151011	MATERIAL NUMBER SEE TABLE
▽ = 0			CUSTOMER GENERAL MARKET		SHEET NUMBER 1 OF 2

CKT SIZE	DIMENSION		
	A	B	C
2	4.00	2.00	-
4	8.00	6.00	4.00
6	12.00	10.00	8.00
8	16.00	14.00	12.00
10	20.00	18.00	16.00
12	24.00	22.00	20.00
14	28.00	26.00	24.00
16	32.00	30.00	28.00
18	36.00	34.00	32.00
20	40.00	38.00	36.00

CKT	PCS/ REEL
2	2000

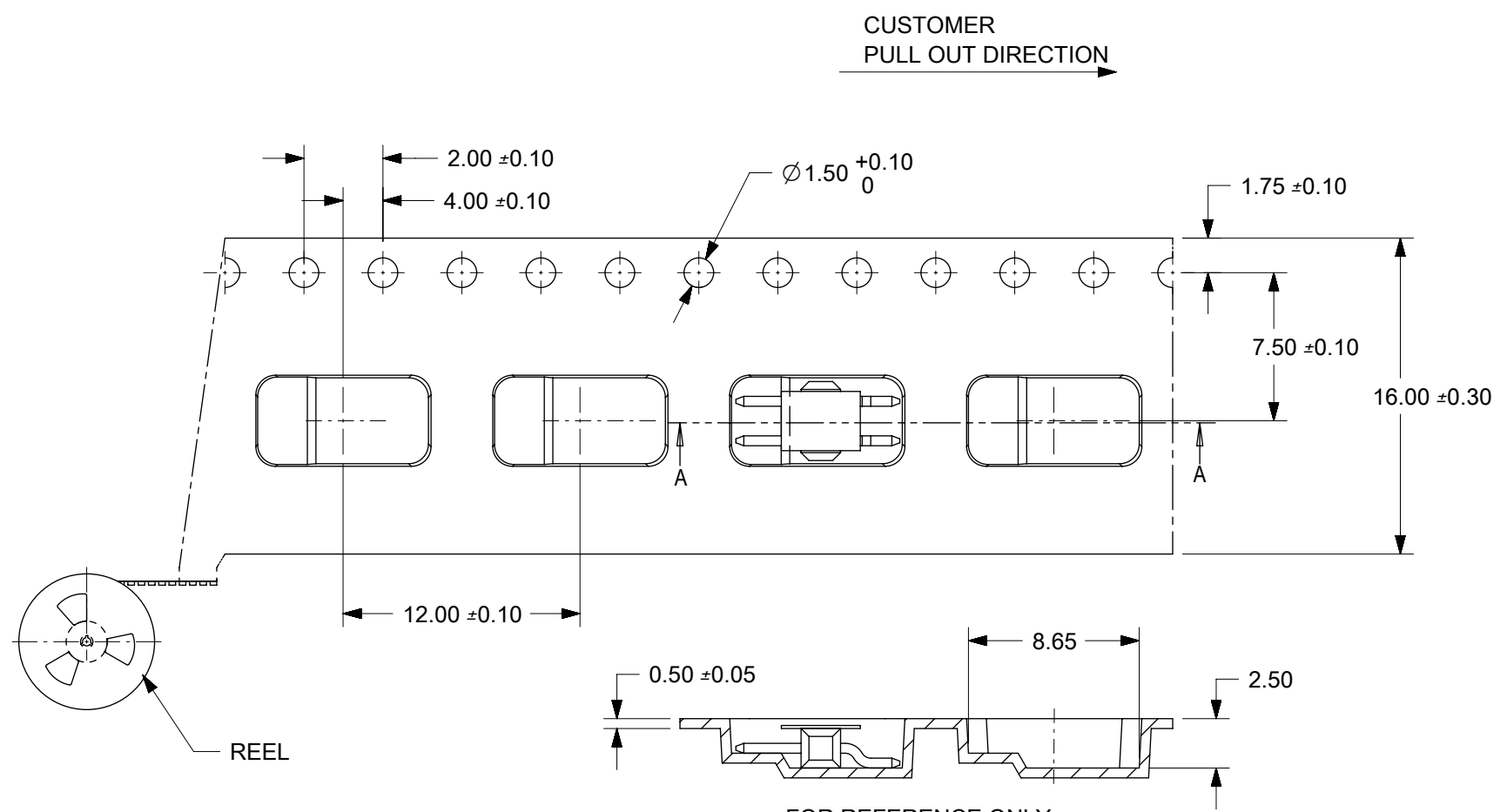

FOR REFERENCE ONLY
ORIENTATION OF
PART IN T&R
SECTION A-A

NOTE:

1. LEADER AND TRAILER TAPE

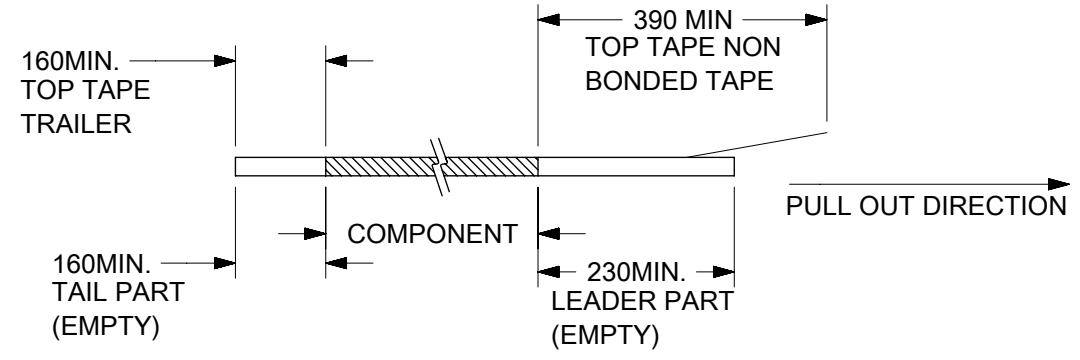

2. PEELING OFF FORCE OF THE TOP TAPE: 20 - 80gf.
(PEELING DIRECTION AS SHOWN IN FOLLOWING FIGURE)

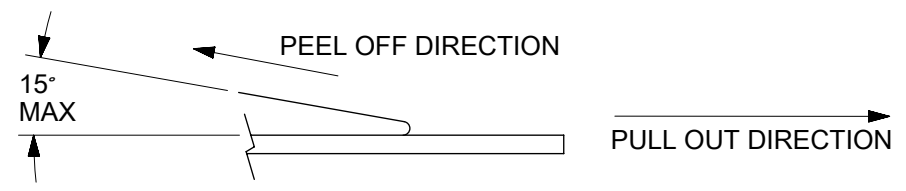

- 3. TAPE AND REEL SPECIFICATION IS AS PER EIA-481.
- 4. THE TAPE IS TREATED FOR ANTI-STATIC.

SYMBOLS	THIS DRAWING CONTAINS INFORMATION THAT IS PROPRIETARY TO MOLEX ELECTRONIC TECHNOLOGIES, LLC AND SHOULD NOT BE USED WITHOUT WRITTEN PERMISSION															
	DIMENSION UNITS		SCALE		CURRENT REV DESC: P/N 151011-0202 ADD						molex					
	mm		NTS													
	GENERAL TOLERANCES (UNLESS SPECIFIED)										CUSTOM HEADER 2.00MM PITCH SINGLE ROW SINGLE WAFER SMT					
		MM		INCH												
▽ = 0	4 PLACES ±				EC NO: 619230						INITIAL REVISION:					
▽ = 0	3 PLACES ±				DRWN: GJEEVANSURES 2019/06/17											
▽ = 0	2 PLACES ±		0.2		CHK'D: GJEEVANSURES 2019/06/18						PRODUCT CUSTOMER DRAWING					
▽ = 0	1 PLACE ±				APPR: ISHWARG 2019/06/18											
□ = 0	0 PLACES ±				DRWN: ATSEE 2014/09/04						DOCUMENT NUMBER SD-151011-0201					
□ = 0	ANGULAR TOL ±		3.0°		APPR: LBLEE 2014/10/03											
■ = 0	DRAFT WHERE APPLICABLE MUST REMAIN WITHIN DIMENSIONS				THIRD ANGLE PROJECTION		DRAWING		SERIES		MATERIAL NUMBER		CUSTOMER		SHEET NUMBER	
▽ = 0					A3-SIZE		151011		SEE TABLE		GENERAL MARKET		2 OF 2			

DOCUMENT STATUS	P1	RELEASE DATE	2019/06/18	18:31:37
-----------------	----	--------------	------------	----------