

SIDE VIEW

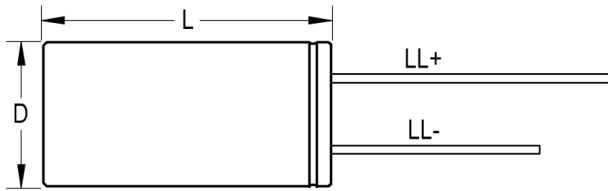

TERMINAL END VIEW

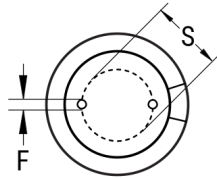

Click [here](#) for the 3D model.

### Dimensions

|             |               |
|-------------|---------------|
| D           | 10mm +/-0.5mm |
| L           | 15mm +2mm     |
| S           | 5mm +/-0.5mm  |
| LL Negative | 15mm MIN      |
| LL Positive | 20mm MIN      |
| F           | 0.6mm NOM     |

### Packaging Specifications

|                    |           |
|--------------------|-----------|
| Packaging          | Bulk, Bag |
| Packaging Quantity | 3000      |

### General Information

|             |                                            |
|-------------|--------------------------------------------|
| Series      | ESH                                        |
| Dielectric  | Aluminum Electrolytic                      |
| Description | High CV Single Ended Aluminum Electrolytic |
| Features    | High CV                                    |
| RoHS        | Yes                                        |
| Lead        | Wire Leads                                 |
| AEC-Q200    | No                                         |

### Specifications

|                         |                          |
|-------------------------|--------------------------|
| Capacitance             | 4.7 uF                   |
| Capacitance Tolerance   | 20%                      |
| Voltage DC              | 350 VDC, 400 VDC (Surge) |
| Temperature Range       | -25/+105°C               |
| Rated Temperature       | 105°C                    |
| Life                    | 2000 Hrs                 |
| Dissipation Factor      | 20%                      |
| Ripple Current          | 55 mAmps (120Hz 105C)    |
| Leakage Current         | 59.35 uA (2min 20°C)     |
| Impedance Ratio at -25C | 4                        |