

NOTES:

1. ALL PARTS TO BE BULK PACKED
2. CONTACTS ARE INSTALLED INTO CONNECTOR.

ASS'Y P/N	NO. OF CONTACT	CABLE O.D.
18282-2PG-311	2 POS.	.09-.14 [2.3-3.5mm]
18282-2PG-315		.15-.17 [3.8-4.3mm]
18282-2PG-318		.18-.20 [4.6-5.1mm]
18282-3PG-311	3 POS.	.09-.14 [2.3-3.5mm]
18282-3PG-315		.15-.17 [3.8-4.3mm]
18282-3PG-318		.18-.20 [4.6-5.1mm]

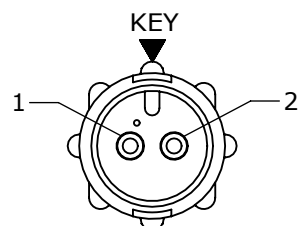

**FACE VIEW**  
18282-2PG-3XX

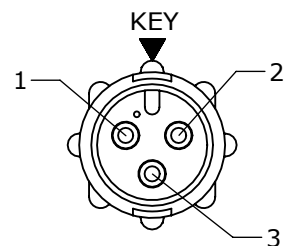

**FACE VIEW**  
18282-3PG-3XX

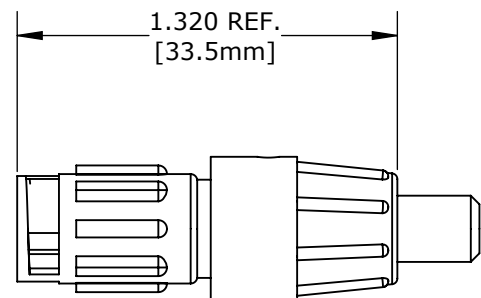
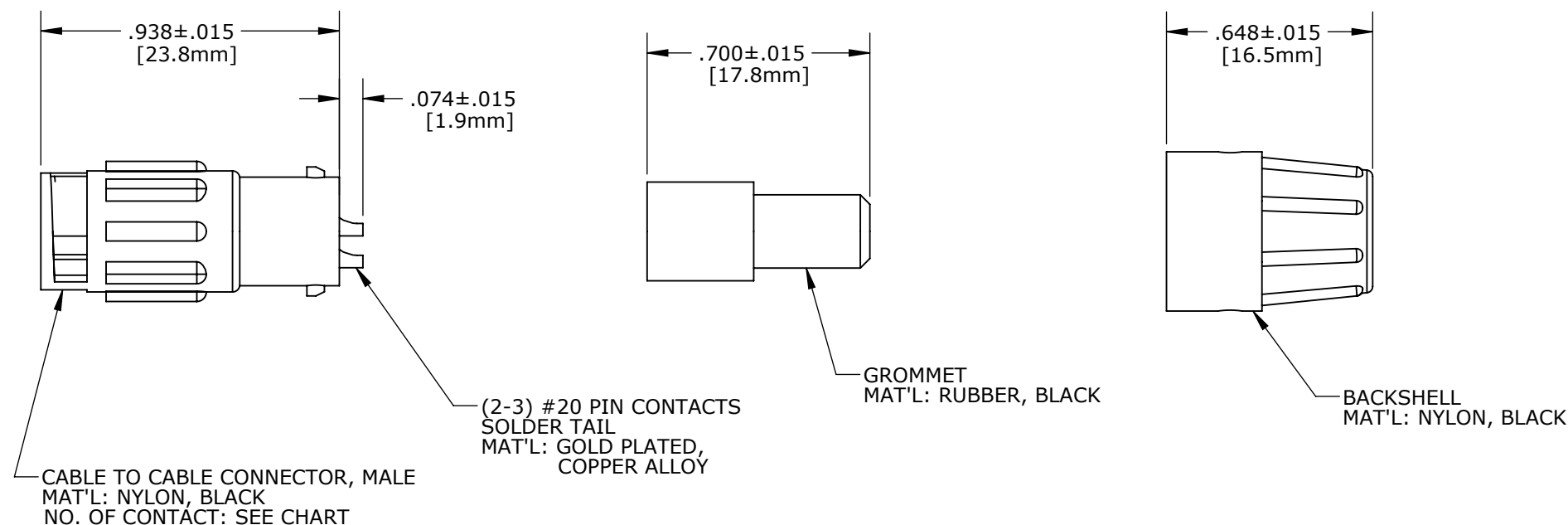

**SHOWN ASSEMBLED KIT**  
FOR CUSTOMER REFERENCE ONLY

DIMENSIONS IN BRACKET [ ] ARE METRIC.

**CUSTOMER APPROVAL**

THIS DOCUMENT CONTAINS CONFIDENTIAL INFORMATION PROPRIETARY TO CONXALL CORPORATION. ANY REPRODUCTION, DISCLOSURE, OR USE OF THIS DOCUMENT /INFORMATION IS EXPRESSLY PROHIBITED UNLESS AUTHORIZED IN WRITING BY CONXALL CORPORATION.

APPROVED BY: \_\_\_\_\_  
DATE: \_\_\_\_\_

**RoHS COMPLIANT**

A	AN	11-08-11	DRAWING CREATED PER DOR 11-E149SL
REV.	INIT.	DATE	DESCRIPTION
	AN	11-07-11	ALL INFORMATION ILLUSTRATED IS THE PROPERTY OF CONXALL CORPORATION. UNAUTHORIZED DUPLICATION OR DISTRIBUTION OF THIS DOCUMENT IS PROHIBITED.
APPROVED BY:			 601 E. WILDWOOD VILLA PARK, IL 60181
TITLE:			
SCALE	SIZE	SHEET	CABLE TO CABLE CONN. ASS'Y (2-3) #20 PIN CONTACTS, SOLDER MINI-CON-X CUSTOMER: STANDARD PRODUCT
NTS	B	1 OF 1	
FILE:	DIRECTORY:	PART NUMBER:	REV
18282-XPG-3XX	SLW	18282-XPG-3XX	A