

THIS DRAWING IS UNPUBLISHED.

RELEASED FOR PUBLICATION

ALL RIGHTS RESERVED.

REVISIONS

| P | LTR | DESCRIPTION | DATE | DWN | APVD |
|----|-----|---------------------------|-----------|-----|------|
| F1 | | REVISED PER ECO-11-020548 | 06FEB12 | KH | DR |
| F2 | | REVISED PER ECO-17-014338 | 26MAR2018 | RS | DR |

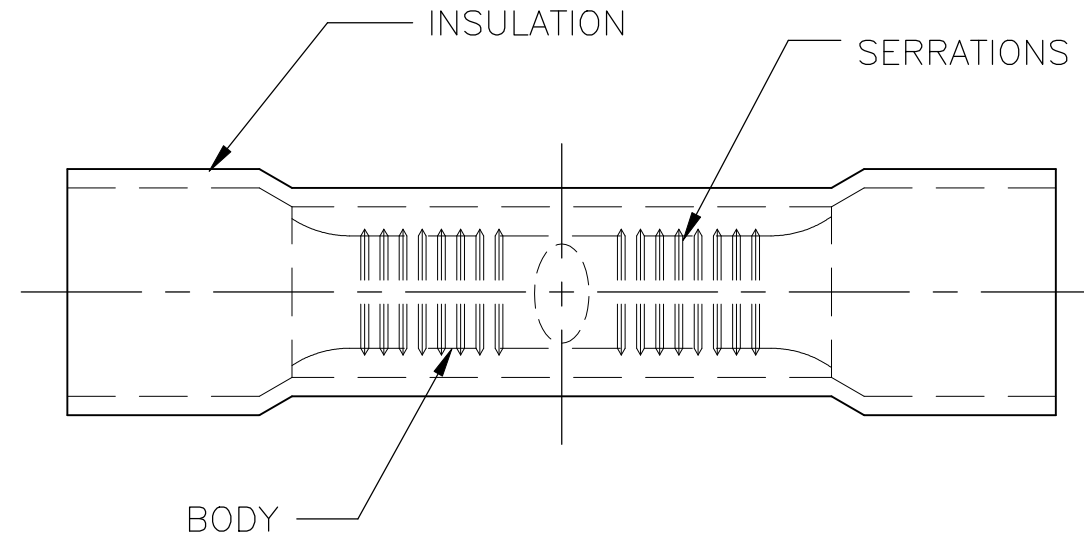

| | |
|--------------------------------|--------------------------------|
| E13288 Listed | LR7189 Certified |
| 16-14 AWG SOLID OR STRANDED | 16-14 AWG SOLID OR STRANDED |

1 FOR 5.461[.215] MAX WIRE INSULATION DIA

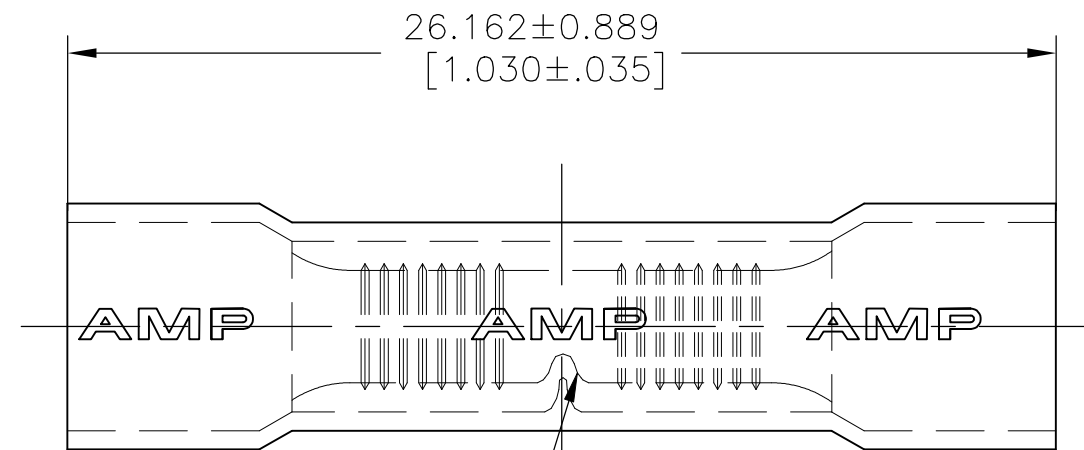

| | | | |
|------|---------------|--|-----------|
| 2000 | TAPE AND REEL | INSULATION: PVC COLOR: BLUE BODY: COPPER PER ASTM B152, ANNEALED TIN PLATE PER ASTM B545 | 2-35244-1 |
| 1000 | LOOSE PIECE | | 35244 |
| QTY | PACKAGE TYPE | MATERIAL & FINISH | PART NO |

AMP INCORPORATED
CUSTOMER SERVICE SYSTEMS

THIS DRAWING IS A CONTROLLED DOCUMENT.

DWN KIRAN HOLAL 06FEB12

CHK ROHDE DANIEL 06FEB12

APVD ROHDE DANIEL 06FEB12



FOR ADDITIONAL PRODUCT INFORMATION OR COPIES OF DRAWINGS AND TECHNICAL DOCUMENTS
PRODUCT INFORMATION CENTER
1-800-522-6752

FOR APPLICATION TOOLING ASSISTANCE CENTER
TOOLING INFORMATION
1-800-722-1111

FOR ORDER ENTRY
1-800-526-5142

MAX RECOMMENDED OPERATING TEMPERATURE:
105°C [221°F] MAX

VOLTAGE RATING:
600V MAX
[1000V SIGN'S OR FIXTURES]

WIRE CROSS SECTIONAL AREA RANGE,
1.04-2.62mm²[4,050-5,180] CIR MILS

DIMENSIONS:
mm [INCHES]

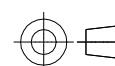

TOLERANCES UNLESS OTHERWISE SPECIFIED:

| | |
|--------|---------------|
| 0 PLC | ± - |
| 1 PLC | ± - |
| 2 PLC | ± - |
| 3 PLC | ± 0.127[.005] |
| 4 PLC | ± - |
| ANGLES | ± - |
| FINISH | - |

MATERIAL
-

PRODUCT SPEC

UL 486 A-B

APPLICATION SPEC

114-2161

WEIGHT

CUSTOMER DRAWING

NAME

WIRE SPLICE

PLASTI-GRIP,BUTT

WIRE SIZE 16-14 AWG

SIZE A3 CAGE CODE 00779 DRAWING NO C-35244 RESTRICTED TO -

SCALE 5:1 SHEET 1 OF 1 REV F2