

RECOMMENDED PCB LAY-OUT AND KEEP-OUT ZONE

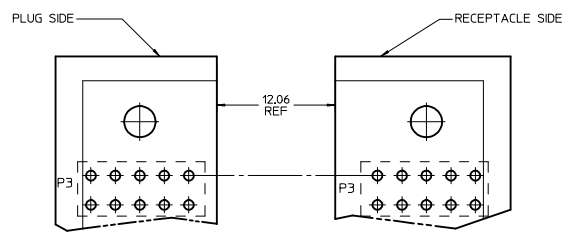
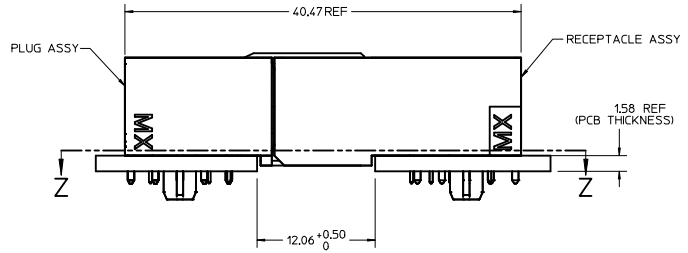
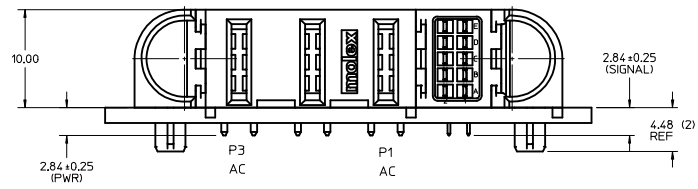

VIEW Z-Z (POWER CKTS ARE ALIGNED)

NOTES:

- MATERIAL:
 - HOUSINGS: LCP UL94 V-0, COLOR: BLACK
 - TERMINALS: COPPER ALLOY
 - PLATING: 0.00127 NICKEL OVERALL WITH 0.00254 SELECTIVE TIN ON COMPLIANT PINS AND 0.000762 SELECTIVE GOLD ON CONTACT AREA
- PACKAGING ASSEMBLIES TO BE TRAY PACKED PER PACKAGING SPEC PK-46562-XXX
- PRODUCT SPEC PS-46436-100
- APPLICATION SPEC: AS-46436-100
- PCB REQUIRES SOLDER THRU HOLES, REFER TO PS-46436-100 FOR DETAILS
- PRODUCT TO MEET RoHS REQUIREMENTS
- ASSEMBLY MATES WITH PLUG ASSEMBLY, P/N 46437-1281

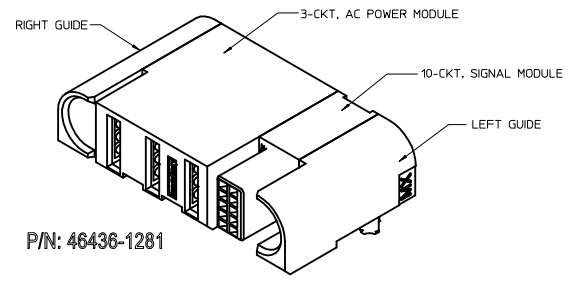

P/N: 46436-1281

RELEASED IEC NO: LCP2012-0275 DRAWN BY: TMPATIL CHECKED BY: CHYKOBPISZCZOR APPR: APATEL DATE: 2011/08/03 DATE: 2012/08/12 DATE: 2012/08/30	QUALITY SYMBOLS	GENERAL TOLERANCES (UNLESS SPECIFIED)	DIMENSION STYLE	SCALE	DESIGN UNITS	THIRD ANGLE PROJECTION
	▽=0	mm INCH	MM ONLY	4:1	METRIC	☉
	▽=0	4 PLACES ±--- ±---	DRAWN BY: TMPATIL	DATE: 2011/08/03	TITLE: RA RECEPTACLE ASSY	
	▽=0	3 PLACES ±--- ±---	CHECKED BY: BPI SZCZOR	DATE: 2012/08/22	10S-3AC	
	2 PLACES ±0.25 ±---	1 PLACE ±0.25 ±---	APPROVED BY: APATEL	DATE: 2012/08/30	TEN60 POWER FAMILY	
	ANGULAR ±1/2°		MATERIAL NO: 46436-1281	DOCUMENT NO: SD-46436-1281	MOLEX INCORPORATED	
		DRAFT WHERE APPLICABLE MUST REMAIN WITHIN DIMENSIONS	SIZE: D	THIS DRAWING CONTAINS INFORMATION THAT IS PROPRIETARY TO MOLEX INCORPORATED AND SHOULD NOT BE USED WITHOUT WRITTEN PERMISSION		

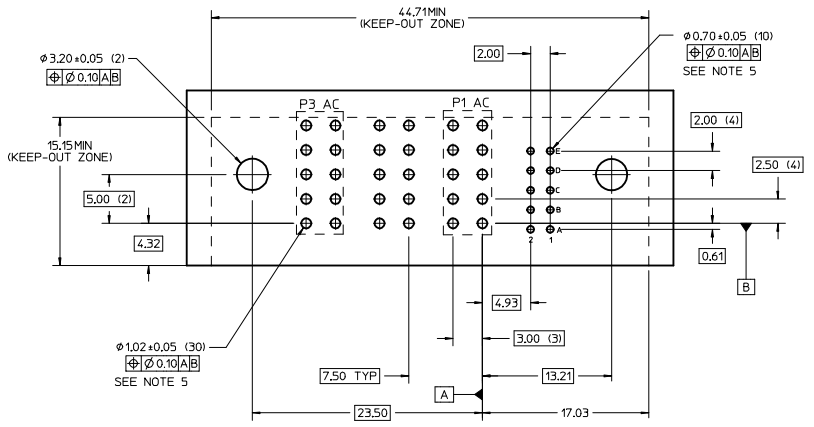
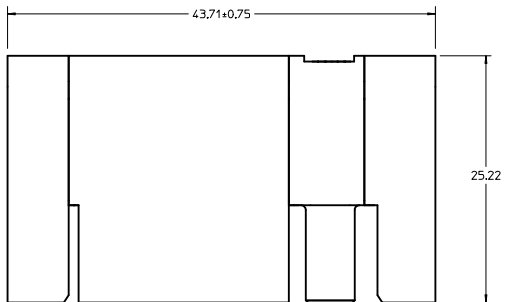

RECOMMENDED PCB LAY-OUT AND KEEP-OUT ZONE

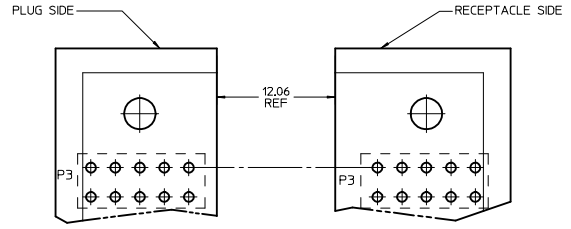
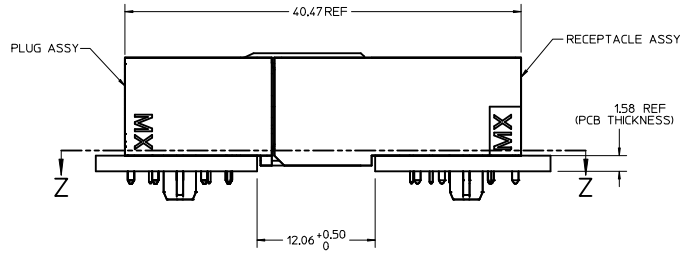
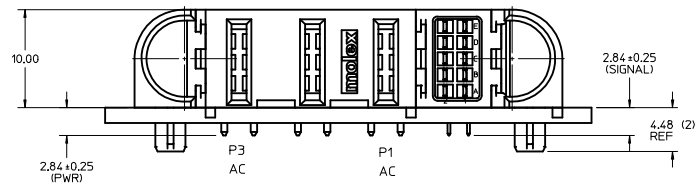

VIEW Z-Z
(POWER CKTS ARE ALIGNED)

NOTES:

- MATERIAL:
 - HOUSINGS: LCP UL94 V-0, COLOR: BLACK
 - TERMINALS: COPPER ALLOY
 - PLATING: 0.00127 NICKEL OVERALL WITH 0.00254 SELECTIVE TIN ON COMPLIANT PINS AND 0.000762 SELECTIVE GOLD ON CONTACT AREA
- PACKAGING ASSEMBLIES TO BE TRAY PACKED PER PACKAGING SPEC PK-46562-XXX
- PRODUCT SPEC PS-46436-100
- APPLICATION SPEC: AS-46436-100
- PCB REQUIRES SOLDER THRU HOLES, REFER TO PS-46436-100 FOR DETAILS
- PRODUCT TO MEET RoHS REQUIREMENTS
- ASSEMBLY MATES WITH PLUG ASSEMBLY, P/N 46437-1281

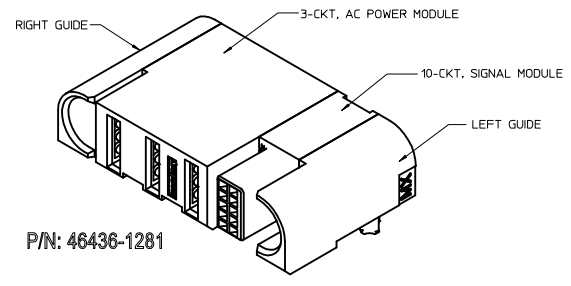

P/N: 46436-1281

RELEASED IEC NO: LCP2012-0275 DRAWN BY: TMPATIL CHECKED BY: CHYKOBPISZCZOR APPR: APATEL DATE: 2012/08/30	QUALITY SYMBOLS	GENERAL TOLERANCES (UNLESS SPECIFIED)	DIMENSION STYLE	SCALE	DESIGN UNITS	THIRD ANGLE PROJECTION
	▽=0	mm INCH	MM ONLY	4:1	METRIC	☉
	▽=0	4 PLACES ±--- ±---	DRAWN BY DATE	TITLE		
	▽=0	3 PLACES ±--- ±---	DATE	RA RECEPTACLE ASSY		
	2 PLACES ±0.25 ±---	APPROVED BY DATE	10S-3AC			
	1 PLACE ±0.25 ±---	DATE	TEN60 POWER FAMILY			
	ANGULAR ±1/2°		MOLEX INCORPORATED			
	DRAFT WHERE APPLICABLE MUST REMAIN WITHIN DIMENSIONS	MATERIAL NO.	DOCUMENT NO.		SHEET NO.	
		46436-1281	SD-46436-1281		1 OF 1	
		THIS DRAWING CONTAINS INFORMATION THAT IS PROPRIETARY TO MOLEX INCORPORATED AND SHOULD NOT BE USED WITHOUT WRITTEN PERMISSION				

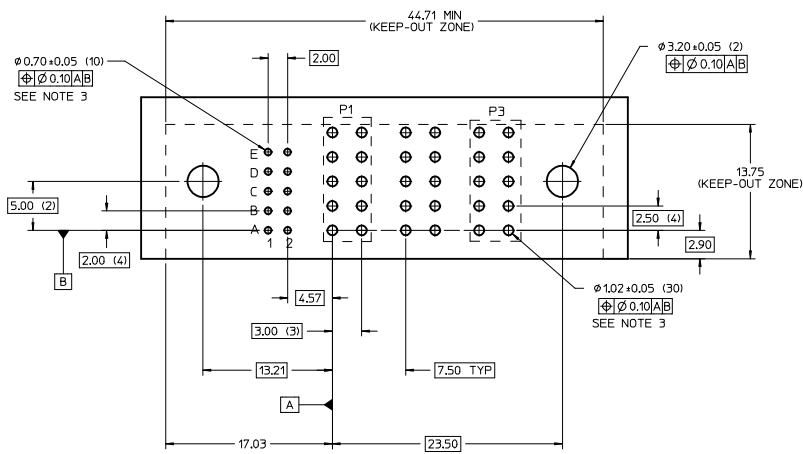
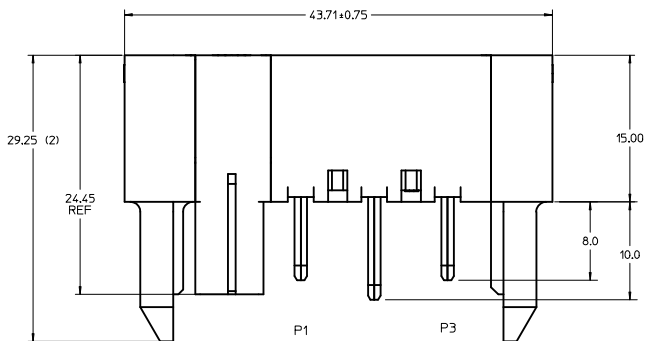

RECOMMENDED PCB LAYOUT AND KEEP-OUT ZONE

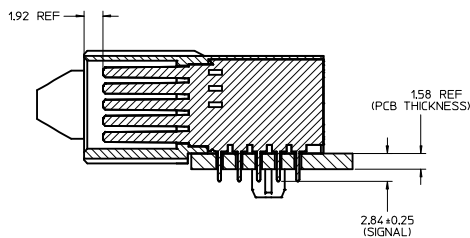
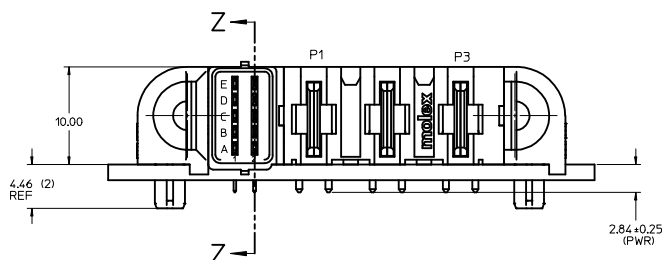

SECTION Z-Z

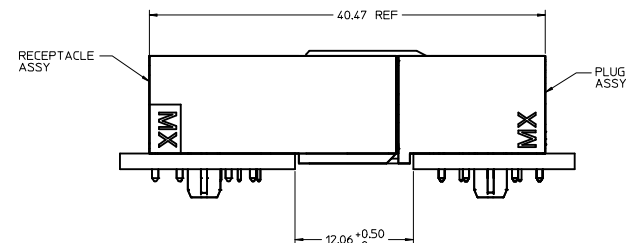

MATING PROFILE

NOTES:

- MATERIAL:
-HOUSINGS: LCP UL-94, V-0, COLOR: BLACK
-TERMINALS: COPPER ALLOY
-PLATING: 0.00127 NICKEL OVERALL WITH 0.00254 SELECTIVE TIN ON SOLDER TAILS AND 0.000762 SELECTIVE GOLD ON CONTACT AREA.
- PACKAGING: ASSEMBLIES TO BE TRAY PACKED, QTY TBD.
- PC BOARD REQUIRES SOLDER THRU HOLES. REFER TO PS-46436-100 FOR DETAILS
- PRODUCT SPEC: PS-46436-100
- APPLICATION SPEC: AS-46436-100
- SEE PRODUCT SPEC FOR MEET ROHS REQUIREMENTS
- ASSEMBLY MATES WITH MOLEX RECEPTACLE ASSEMBLY P/N: 46562-1281 AND 46436-1281

P/N: 46437-1281

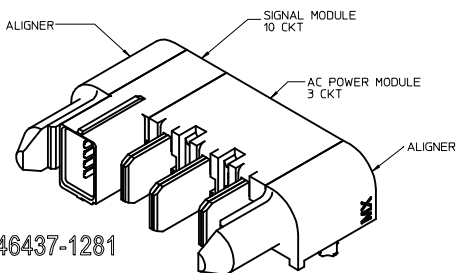

RELEASED IEC NO: UICP2012-0275 DRAWN BY: SZCZOR 2012/04/11 CHECKED BY: SZCZOR 2012/08/22 APPR: APATEL 2012/08/30	QUALITY SYMBOLS	GENERAL TOLERANCES (UNLESS SPECIFIED)	DIMENSION STYLE	SCALE	DESIGN UNITS	THIRD ANGLE PROJECTION
	▽=0	mm INCH	MM ONLY	4:1	METRIC	☉
	▽=0	4 PLACES ± --- ± ---	DRAWN BY: TMPATIL DATE: 2011/08/03	TITLE	R/A PLUG ASSY	
	▽=0	3 PLACES ± 0.25 ± ---	CHECKED BY: BPI SZCZOR DATE: 2012/08/22	G-10S-3AC-G		TEN60 POWER FAMILY
▽=0	2 PLACES ± 0.25 ± ---	APPROVED BY: APATEL DATE: 2012/08/30	MATERIAL NO.	DOCUMENT NO.	molex SD-46437-1281	
	0 PLACE ± ±	ANGULAR ±1/2°	46437-1281	SD-46437-1281	SHEET NO. 1 OF 1	
		DRAFT WHERE APPLICABLE MUST REMAIN WITHIN DIMENSIONS	THIS DRAWING CONTAINS INFORMATION THAT IS PROPRIETARY TO MOLEX INCORPORATED AND SHOULD NOT BE USED WITHOUT WRITTEN PERMISSION			

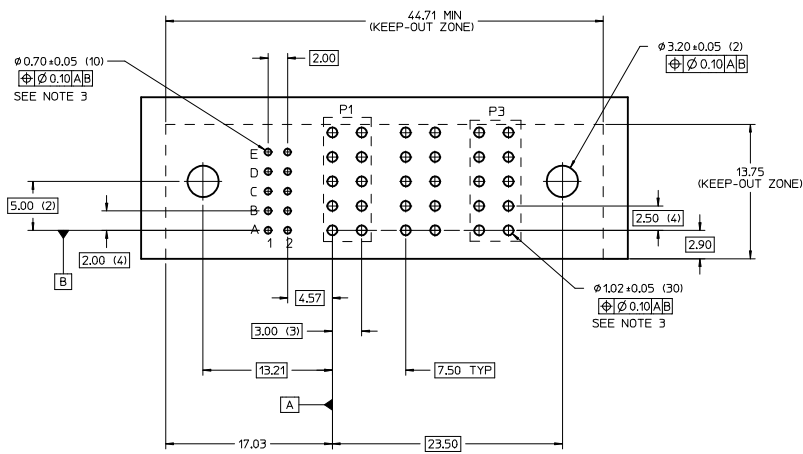
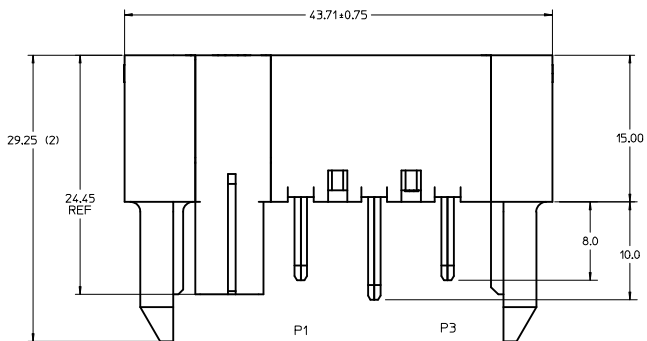

RECOMMENDED PCB LAYOUT AND KEEP-OUT ZONE

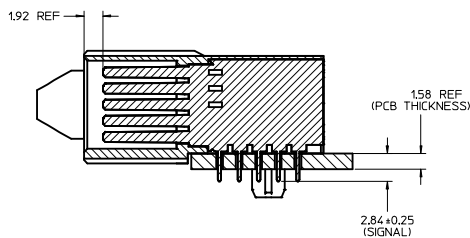
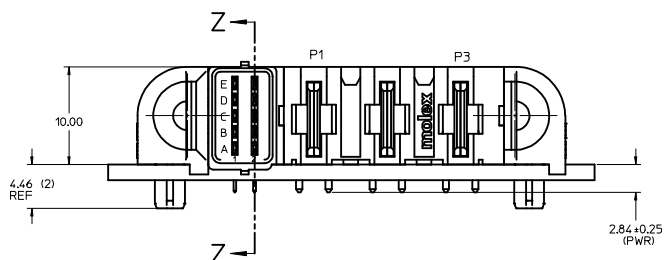

SECTION Z-Z

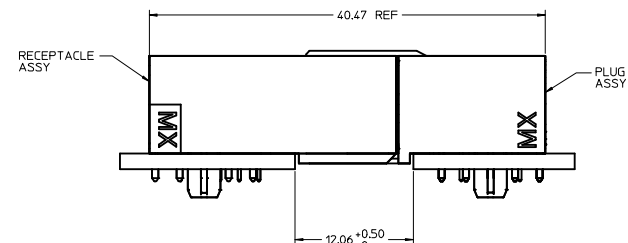

MATING PROFILE

NOTES:

- MATERIAL:
-HOUSINGS: LCP UL-94, V-0, COLOR: BLACK
-TERMINALS: COPPER ALLOY
-PLATING: 0.00127 NICKEL OVERALL WITH 0.00254 SELECTIVE TIN ON SOLDER TAILS AND 0.000762 SELECTIVE GOLD ON CONTACT AREA.
- PACKAGING: ASSEMBLIES TO BE TRAY PACKED, QTY TBD.
- PC BOARD REQUIRES SOLDER THRU HOLES. REFER TO PS-46436-100 FOR DETAILS
- PRODUCT SPEC: PS-46436-100
- APPLICATION SPEC: AS-46436-100
- SEE PRODUCT SPEC FOR MEET ROHS REQUIREMENTS
- ASSEMBLY MATES WITH MOLEX RECEPTACLE ASSEMBLY P/N: 46562-1281 AND 46436-1281

P/N: 46437-1281

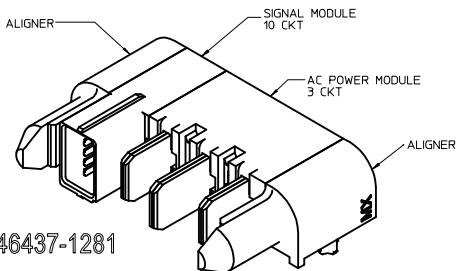

RELEASED IEC NO: UICP2012-0275 DRAWN BY: SZCZOR 2012/04/11 CHECKED BY: SZCZOR 2012/08/22 APPR: APATEL 2012/08/30	QUALITY SYMBOLS	GENERAL TOLERANCES (UNLESS SPECIFIED)	DIMENSION STYLE	SCALE	DESIGN UNITS	THIRD ANGLE PROJECTION
	▽=0	mm INCH	MM ONLY	4:1	METRIC	☉
	▽=0	4 PLACES ± --- ± ---	DRAWN BY: TMPATIL DATE: 2011/08/03	TITLE	R/A PLUG ASSY G-10S-3AC-G TEN60 POWER FAMILY	
	▽=0	3 PLACES ± 0.25 ± ---	CHECKED BY: BPI SZCZOR DATE: 2012/08/22	DOCUMENT NO. SD-46437-1281		SHEET NO. 1 OF 1
▽=0	2 PLACES ± 0.25 ± ---	APPROVED BY: APATEL DATE: 2012/08/30	MATERIAL NO. 46437-1281		INCORPORATED AND SHOULD NOT BE USED WITHOUT WRITTEN PERMISSION	
		0 PLACE ± ±	DRAFT WHERE APPLICABLE MUST REMAIN WITHIN DIMENSIONS			