

1

2

3

4

5

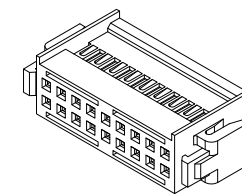
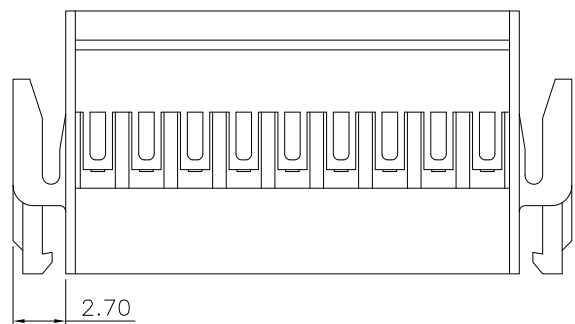

Specifications:

Current Rating: 3.0A AC,DC

Voltage Rating: 250V AC,DC

Contact Resistance: 20m ohm.Max

Insulation Resistance: 1000M ohm.Min

Withstanding Voltage: 1000V AC/Minute

Operating Temperature Range: -25°C ~ +85°C

Material:

Insulator: Nylon 66 (UL94V-0)

Insulator Color: White

Mates with 53325 Terminal

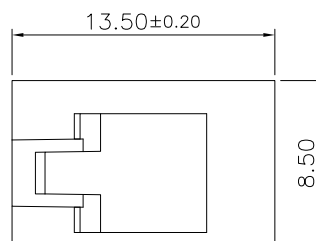
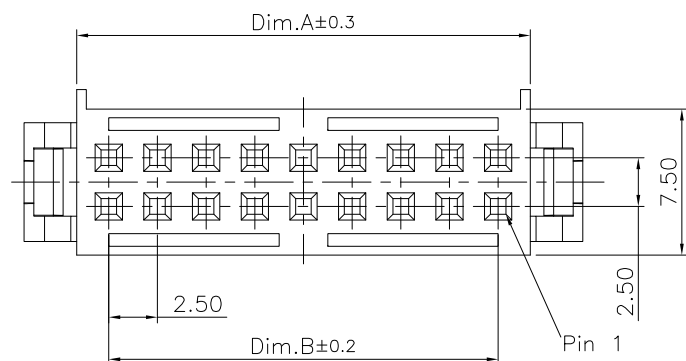

Dimension Information:

Circuits	Dim.A	Dim.B
8	10.80	7.50
10	13.30	10.00
12	15.80	12.50
14	18.30	15.00
16	20.80	17.50
18	23.30	20.00
20	25.80	22.50

RoHS Compliant

DRAWN:

GENERAL TOLERANCE:

.X=±0.20

.XX=±0.15

CnC Tech

Industrial Cable and Connector Technology

CHECKED:

UNIT: MM

DESCRIPTION: WIRE-TO BOARD HOUSING, 2.5mm,
SIDE LOCK

SIZE

APPROVAL:

SCALE: 1:1

SHEET: 1 / 2

PART NO:

53025-XX

A4

REV

DATE

FILE

BY

PROJECTION:

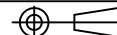

A

B

C

D