

SECTION Z-Z
CONDUCTOR CRIMP AREA
SCALE 10:1

SECTION Y-Y
INSULATOR CRIMP AREA
SCALE 10:1

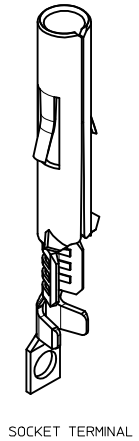
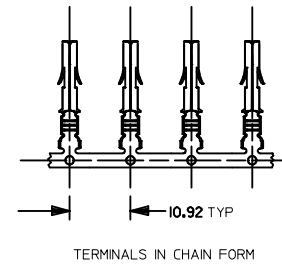
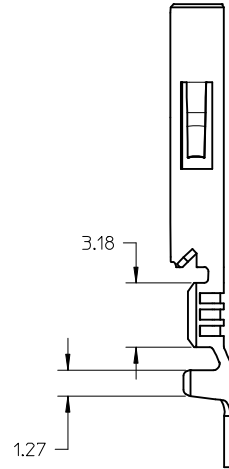
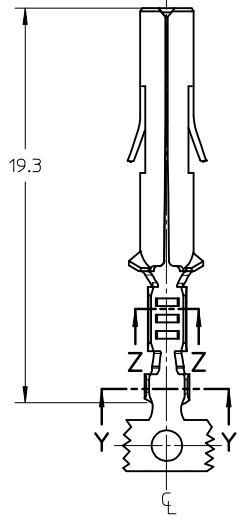

- NOTES:
- SOCKET TERMINALS FOR USE WITH 2.13 DIA SERIES HOUSINGS:
PLUG(42021-**)
CAP (42022-**)
 - SOCKET TERMINALS MATE WITH 42023 PIN TERMINALS 2.13 DIA SERIES
 - TERMINALS FINISHED IN CHAIN FORM
 - MATERIAL: 0.30 THICK STRIP:
A= BRASS, #C26000 PER SMES-124-E7
B= PHOSPHOR BRONZE, #C51000 PER SMES-124-E7
 - FINISH:
HOT TIN DIP 20 m.l/0.51 microns MIN PER SDES-88-P901
 - WIRE RANGE: 22-24AWG COVERS UL 1007 & UL1569
 - PRODUCT SPECIFICATION: PS-42022-0001

PART NO	FINISH	MATERIAL	WIRE SIZE	INSULATION DIA RANGE
42024-1019	ES-88-P901	C26000	22-24 AWG	1.2-1.8 MM
42024-1020	ES-88-P901	C51000	22-24 AWG	1.2-1.8 MM

NOTES UPDATED EC NO: 12014-0044 DRWN:SS06 CHKD: APPR: ISHWARG 2013/11/08 2013/12/02	QUALITY SYMBOLS	GENERAL TOLERANCES (UNLESS SPECIFIED)	DIMENSION STYLE	SCALE	DESIGN UNITS	THIRD ANGLE PROJECTION
	$F_A=0$ $F_G=0$ $F_P=0$	mm INCH 4 PLACES ± --- ± --- 3 PLACES ± --- ± --- 2 PLACES ± 0.25 ± --- 1 PLACE ± 0.38 ± --- 0 PLACE ± --- ± ---	MM ONLY	4:1	METRIC	TITLE MLX TERMINAL SOCKET, 22-24AWG, 2.13 DIA SERIES
		ANGULAR ± 1 ° DRAFT WHERE APPLICABLE MUST REMAIN WITHIN DIMENSIONS	DRAWN BY: SS06 DATE: 2013/10/29 CHECKED BY: DATE: APPROVED BY: ISHWARG DATE: 2013/11/06 MATERIAL NO. SEE TABLE DOCUMENT NO. SD-42024-002	molex SD-42024-002		SHEET NO. 1 OF 1
			SIZE A3 THIS DRAWING CONTAINS INFORMATION THAT IS PROPRIETARY TO MOLEX INCORPORATED AND SHOULD NOT BE USED WITHOUT WRITTEN PERMISSION			

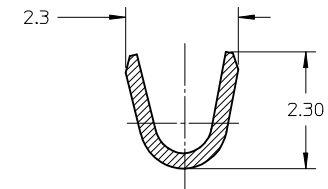
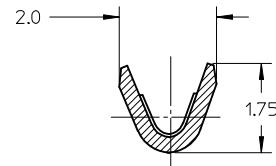
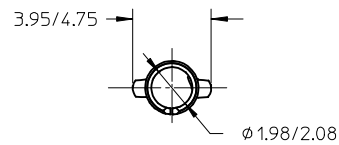

SECTION Z-Z
CONDUCTOR CRIMP AREA
SCALE 10:1

SECTION Y-Y
INSULATOR CRIMP AREA
SCALE 10:1

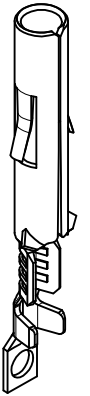
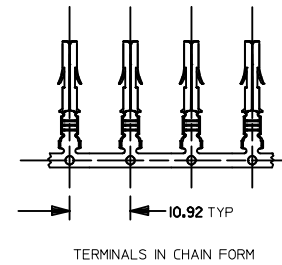
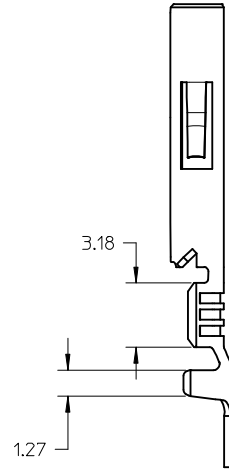
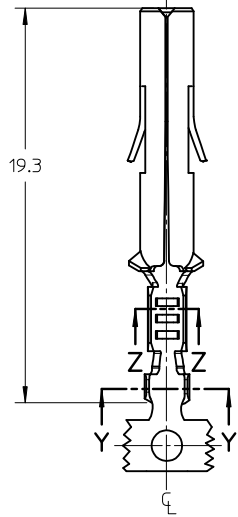

SOCKET TERMINAL

NOTES:

- SOCKET TERMINALS FOR USE WITH 2.13 DIA SERIES HOUSINGS:
PLUG(42021-**)
CAP (42022-**)
- SOCKET TERMINALS MATE WITH 42023 PIN TERMINALS 2.13 DIA SERIES
- TERMINALS FINISHED IN CHAIN FORM
- MATERIAL: 0.30 THICK STRIP:
A= BRASS, #C26000 PER SMES-124-E7
B= PHOSPHOR BRONZE, #C51000 PER SMES-124-E7
- FINISH:
HOT TIN DIP 20 m.l/0.51 microns MIN PER SDES-88-P901
- WIRE RANGE: 22-24AWG COVERS UL 1007 & UL1569
- PRODUCT SPECIFICATION: PS-42022-0001

PART NO	FINISH	MATERIAL	WIRE SIZE	INSULATION DIA RANGE
42024-1019	ES-88-P901	C26000	22-24 AWG	1.2-1.8 MM
42024-1020	ES-88-P901	C51000	22-24 AWG	1.2-1.8 MM

NOTES UPDATED EC NO: 12014-0044 DRWN:SS06 CHKD: APPR: ISHWARG 2	2013/11/08 2013/12/02	DESCRIPTION REV	QUALITY SYMBOLS	GENERAL TOLERANCES (UNLESS SPECIFIED)	DIMENSION STYLE	SCALE	DESIGN UNITS	THIRD ANGLE PROJECTION	
			$F_A=0$ $F_G=0$ $F_P=0$	mm INCH 4 PLACES ± --- ± --- 3 PLACES ± --- ± --- 2 PLACES ± 0.25 ± --- 1 PLACE ± 0.38 ± --- 0 PLACE ± --- ± ---	MM ONLY	4:1	METRIC	DRAWN BY: SS06 DATE: 2013/10/29 CHECKED BY: DATE:	TITLE MLX TERMINAL SOCKET, 22-24AWG, 2.13 DIA SERIES
			ANGULAR ± 1 ° DRAFT WHERE APPLICABLE MUST REMAIN WITHIN DIMENSIONS	APPROVED BY: ISHWARG DATE: 2013/11/06 MATERIAL NO. SEE TABLE	DOCUMENT NO. SD-42024-002				
						SIZE: A3 THIS DRAWING CONTAINS INFORMATION THAT IS PROPRIETARY TO MOLEX INCORPORATED AND SHOULD NOT BE USED WITHOUT WRITTEN PERMISSION	molex		SHEET NO. 1 OF 1