

Pin NO.	A	B	C	D	E
2x30	23.20	26.40	27.60	28.30	28.10
2x40	31.20	34.40	35.60	36.30	36.10
2x50	39.20	42.40	43.60	44.30	44.10

REV.	LOCAS.	DESCRIPTION	DATE	DRAWN
A	NEW	INTERIM INITIAL RELEASE.	2021.11.19	廖昌紅
B	△	1.Update the PCB Layout pitch 2.Update the drawing according to the actual plastic	2022.08.01	廖昌紅

Specifications  
 Current Rating:0.5Amp  
 Insulation Resistance:500MΩMin.  
 Dielectric Withstanding Voltage:250VAC  
 Contact Resistance:100mΩMax.  
 Operating Temperature:-40°C to +105°C  
 Materials  
 Contact Material:Phosphor Bronze  
 Insulator Material:High Temperature Thermoplastic, UL 94V-0 LCP or the equivalent material  
 ☆All materials must meet GREENCONN hazardous substances control standards.  
 "★": Critical Characteristics.  
 indicates product characteristics, functionalities, and manufacturing processes regarding to customer's specifications  
 "☆": Safety Features  
 indicates product characteristics, functionalities, and manufacturing processes complying to legal regulations stated by local government

Recommended P.C.Board Layout  
 (Tolerance:±0.05)

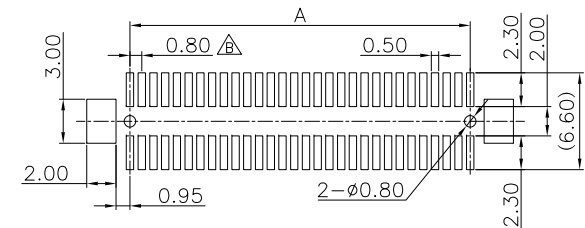

## Ordering Information

C GBC203 - XX XX B 001 C 1 N X

No. Of Pins Per Row: 30,40,50  
 Standard Plating: 02=Gold Flash, Selective Plating: 09=3u"AU/Gold Flash  
 Color: 1=Black  
 Standard Packing: H=Acetate tape +Tape&Reel



3RD.ANG PROJ.	GENERAL TOLERANCE				
	X.*±5.0°	X.±0.30			
	.X.*±3.0°	.X±0.25			
	.XX.*±2.0°	.XX±0.15			
REV. B	UNIT. mm	SCALE. 3:1	PAGE. 1/1	.XXX.*±1.0°	.XXX±0.10

DESIGNED: 廖昌紅	DATE: 2022.08.01
CHECKED: 黃超	DATE: 2022.08.01
APPROVED: 邱國廷	DATE: 2022.08.01

DWG. NO. CGBC203-CB001
PART NO. CGBC203-XXXXB001C1NX

TITLE.  
 0.80mm PITCH BTB FLOATING CONNECTOR