

LOOSE PIECE		TAPE MOUNTED		SPECIFICATIONS					
MATERIAL NUMBER	ENGINEERING NUMBER	MATERIAL NUMBER	ENGINEERING NUMBER	STUD SIZE	"S" ±.005 [0.13]	"W" ±.010 [0.25]	"C" MIN.	"L" MAX.	"H"
191980044	C-841-06	---	---	6	.146 [3.71]	.375 [9.53]	.301 [7.65]	1.118 [28.40]	.980 [24.89]
191980047	C-841-08	191980048	C-841-08T	8	.173 [4.39]				
191980050	C-841-10	191980051	C-841-10T	10	.198 [5.03]				

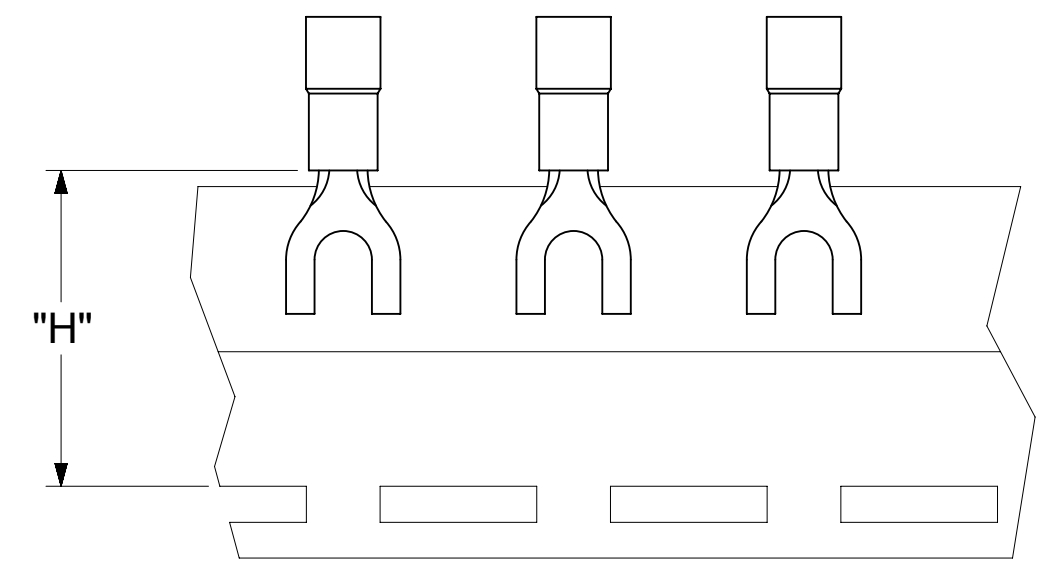
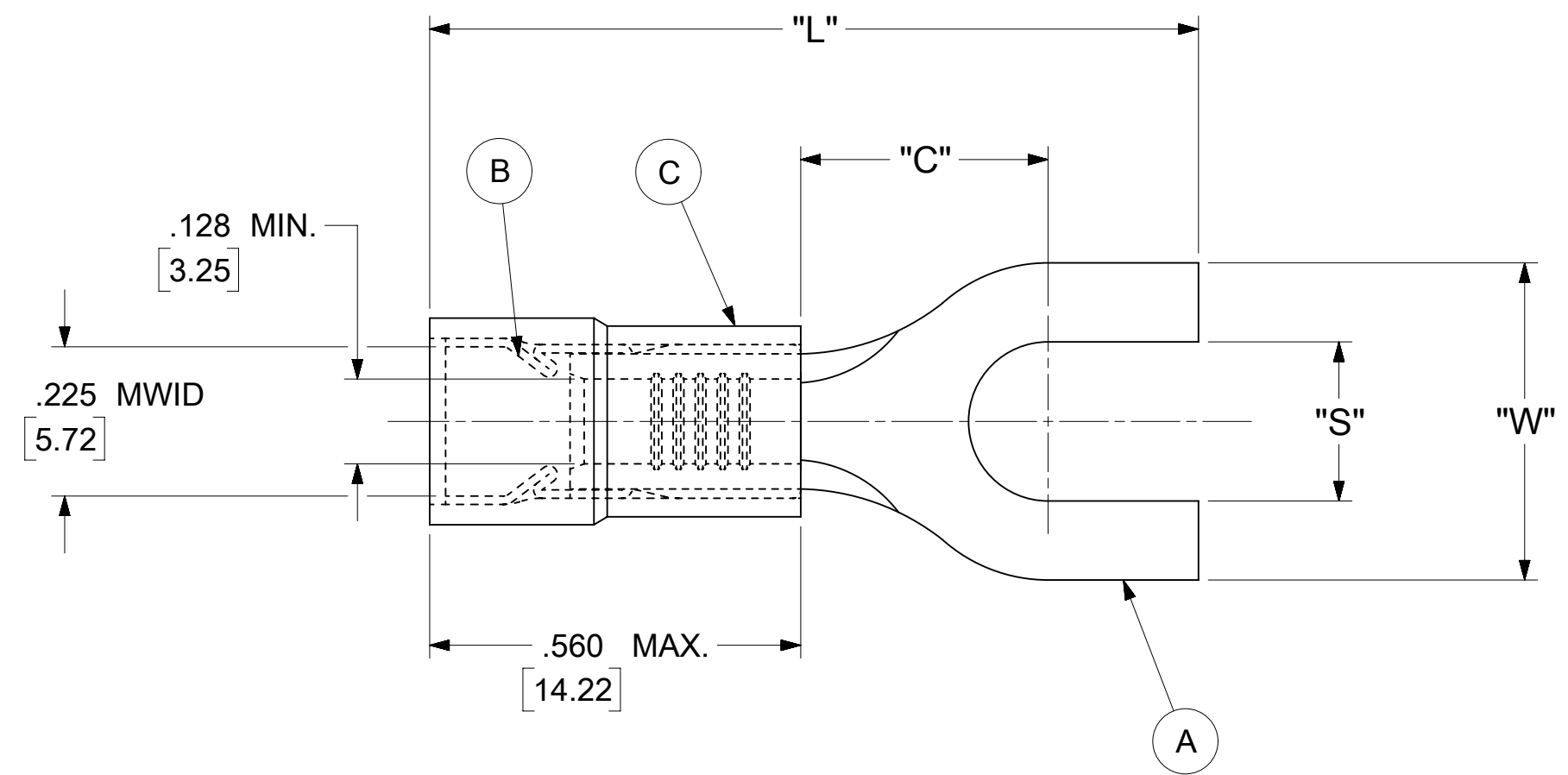

- NOTES:
- MATERIAL:
    - (A). TERMINAL: COPPER (STOCK THICKNESS .040±.001 [1.02] )  
PLATING: ELECTRO-TIN (.0003 MIN.)
    - (B). TIN-PLATED BRASS FUNNEL FERRULE
    - (C). INSULATION: NYLON (COLOR CODED YELLOW)
  - MWID: MAXIMUM WIRE INSULATION DIAMETER
  - WIRE SIZE: 12 - 10 AWG  
4.0 - 6.0 MM<sup>2</sup>
  - "UL" LISTING #E32244  
"CSA" LISTING #18689
  - ALL DIMENSIONS IN INCHES/[MM].
  - PARTS ARE ROHS COMPLIANT.
  - DIMS. SHOWN ARE FOR REFERENCE ONLY.

<b>SYMBOLS</b> DIMENSION UNITS: INCH/MM SCALE: NTS GENERAL TOLERANCES (UNLESS SPECIFIED): 4 PLACES ± --- ± --- 3 PLACES ± --- ± .005 2 PLACES ± 0.13 ± .01 1 PLACE ± 0.25 ± --- 0 PLACES ± --- ± --- ANGULAR TOL ± 0.5 ° DRAFT WHERE APPLICABLE MUST REMAIN WITHIN DIMENSIONS THIRD ANGLE PROJECTION DRAWING SERIES: C-SIZE 19198	THIS DRAWING CONTAINS INFORMATION THAT IS PROPRIETARY TO MOLEX ELECTRONIC TECHNOLOGIES, LLC AND SHOULD NOT BE USED WITHOUT WRITTEN PERMISSION		CURRENT REV DESC: MIGRATION TO ECTR/NX				
	EC NO: 621540 DRWN: ABENJAMINLW 2019/07/25 CHK'D: GROJAS01 2019/07/29 APPR: JMACNEIL 2019/08/05		PRODUCT CUSTOMER DRAWING				
	INITIAL REVISION: DRWN: JJ 1984/11/12 APPR: JMACNEIL 2019/08/05		DOCUMENT NUMBER: 191980044	DOC TYPE: PSD		DOC PART: 000	REVISION: A
	MATERIAL NUMBER: SEE TABLE	CUSTOMER: GENERAL MARKET	SHEET NUMBER: 1 OF 1				

**NOTES:**

- ① MAT'L: COPPER (STOCK TKN.  $\frac{.040}{1.02}$ )
  - PLATING: ELECTRO TIN (.0003 MIN)
  - ② TIN-PLATED BRASS FUNNEL FERRULE
  - ③ NYLON INSULATION (COLOR CODED YELLOW)
- STUD SIZES: ( $\pm .005$ )
- 02 = .094  
 04 = .119  
 06 = .146  
 08 = .173  
 10 = .198  
 14 = .265  
 56 = .328  
 38 = .390
- "UL" LISTING #E32244  
 "CSA" LISTING #18689
- WIRE SIZE: 12 - 10 AWG  
 4.0 - 6.0 MM<sup>2</sup>

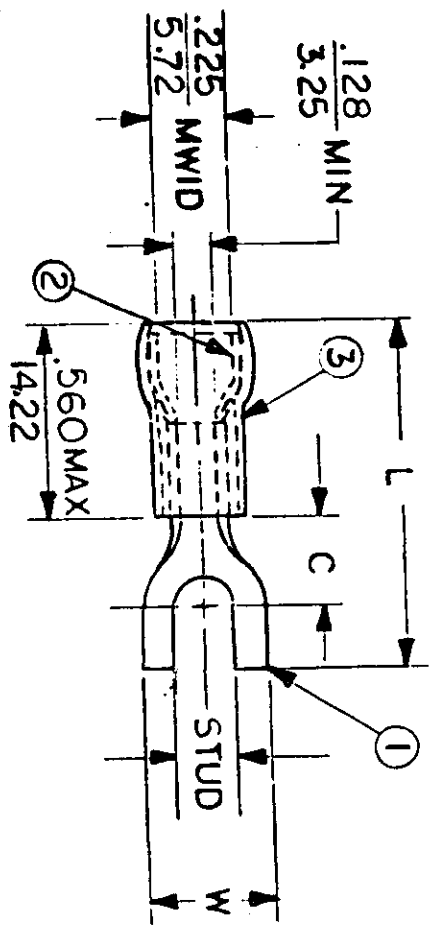

ALL DIMENSIONS =  $\frac{\text{INCHES}}{\text{MM}}$  (MWID) = DENOTES MAXIMUM WIRE INSULATION DIAMETER

PART NUMBER	"W" ±.010	"C" MIN.	"L" MAX.	AVAILABLE STUD SIZES	REFERENCE		TITLE:	
					SCALE:	DATE	SPADE TONGUE TERMINAL AVIKRIMP 800-SERIES	
C-841-	$\frac{.375}{9.53}$	$\frac{.301}{7.65}$	$\frac{1.118}{28.40}$	06,08,10	NTS	11.12.84	INCORPORATED	
C-868-	$\frac{.533}{13.54}$	$\frac{.393}{9.98}$	$\frac{1.271}{32.28}$	10, 14, 56	NTS	11.26.84	INCORPORATED	
DIMENSIONAL TOLERANCES UNLESS OTHERWISE SPECIFIED					SCALE:	DATE:	TITLE:	
FRAC. DEC. ANG.					NTS	11.12.84	SPADE TONGUE TERMINAL AVIKRIMP 800-SERIES	
± ± ±					CHKD. BY: GZ	11.26.84	INCORPORATED	
					APPRD. BY:		INCORPORATED	

