

PWN10V/ 17V



Weight: 10V 22.3 g
17V 33.0 g

Outline UNIT:mm

●PWN10V

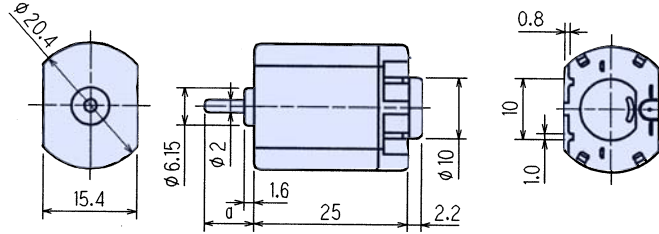

●PWN10VEE (端子タイプ/Terminal type)

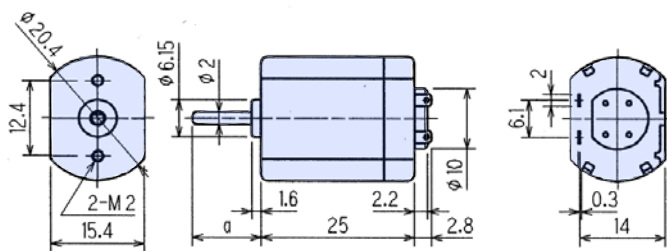

●PWN17V

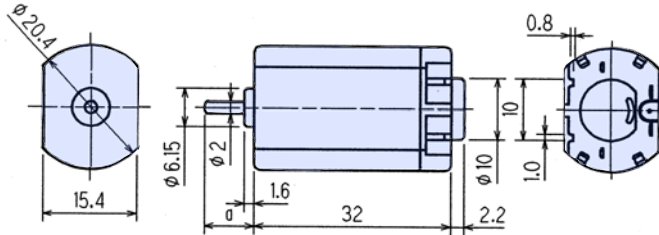

Specifications

Model	Operating Voltage (V)	Rated Voltage (V)	No Load Speed (min^{-1})	No Load Current (mA)	Rated Load		Rated Load Speed (min^{-1})	Rated Load Current (mA)	Starting Torque		Starting Current (mA)	Shaft Length (mm)
					($\text{gf}\cdot\text{cm}$)	($\text{mN}\cdot\text{m}$)			($\text{gf}\cdot\text{cm}$)	($\text{mN}\cdot\text{m}$)		
PWN10VEA12BA	5 to 16	13.5	10792	42	20.4	2.0	8760	221	108.2	10.6	994	a=11.35
PWN10VEE24AA	10.8 to 26.4	24.0	13242	35	20.0	1.96	11139	159	125.9	12.3	815	a=11.3
PWN17VEA12FA	5 to 16	13.5	8669	43	25.5	2.5	6965	225	129.8	12.7	969	a=8.1

Characteristics

