

THIS DOCUMENT IS THE PROPERTY OF
KEYSTONE ELECTRONICS CORP. AND
SHALL NOT BE REPRODUCED, DISTRIBUTED
OR USED AS A BASIS FOR MANUFACTURE
WITHOUT PRIOR WRITTEN PERMISSION
FROM KEYSTONE ELECTRONICS CORP.

ACTUAL SIZE

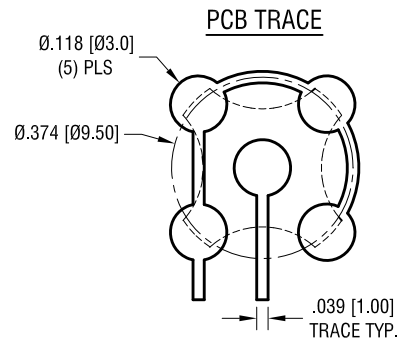

KEYPAD DOMES ARE DESIGNED
TO BE PLACED ON PCB, NOT SOLDERED

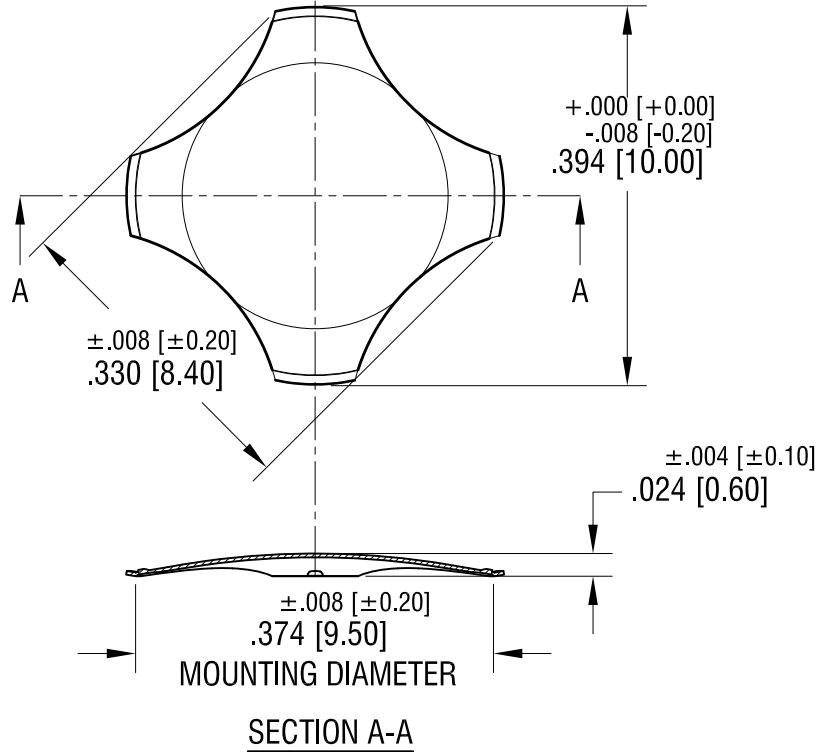

NOTE:

1. VOLTAGE/CURRENT MAXIMUM: 12mA@ 24 Volts DC
2. OPERATING TEMPERATURE: -40°F [-40°C] TO 220°F [105°C]
3. STORAGE TEMPERATURE: -65°F [-55°C] TO 250°F [125°C]
4. TRIP FORCE: 400g

KEYSTONE ELECTRONICS CORP.

www.keyelco.com • NEW HYDE PARK NY 11040 • Tel (516)328-7500

| | | | |
|----------------------------|-----------------|----------------------------------|---------|
| PART NAME | | COMPACT 4 LEG DOME | |
| MATERIAL | | .004 [0.10] TH'K STAINLESS STEEL | |
| FINISH | | DRN BY | DATE |
| NICKEL PLATE | | NT | 3.30.17 |
| | | APP'D | SCALE |
| | | RH | 5X |
| TOLERANCES | INCH [MM] | CODE | DWG NO. |
| DECIMAL | ± .005 [± 0.13] | C | 5156 |
| ANGULAR | ± 1° | | |
| UNLESS OTHERWISE SPECIFIED | | | |

12.29.21 SUPPLIED IN BULK WAS SUPPLIED
IN TUBE
CHANGE AS PER ECN 21-188

A

| DATE | DESCRIPTION | REV. |
|------|-------------|------|
|------|-------------|------|