

4

3

2

1

THIS DRAWING IS UNPUBLISHED.

RELEASED FOR PUBLICATION

,-

© COPYRIGHT - By -

ALL RIGHTS RESERVED.

REVISIONS

P	LTR	DESCRIPTION	DATE	DWN	APVD
A		REVISED PER ECR-18-001192	05FEB2018	BDA	KR

1 CONTINUOUS STRIP ON REELS  
AT 5.08±0.08 [.200±.003] CENTERS.

2 SLOT ACCEPTS A SINGLE OR DOUBLE  
WIRE OF SAME SIZE AND TYPE.  
COPPER MAGNET WIRE:  
DIA 0.23-0.32mm [#31-#28] AWG  
ALUMINUM MAGNET WIRE:  
DIA 0.29-0.36mm [#29-#27] AWG

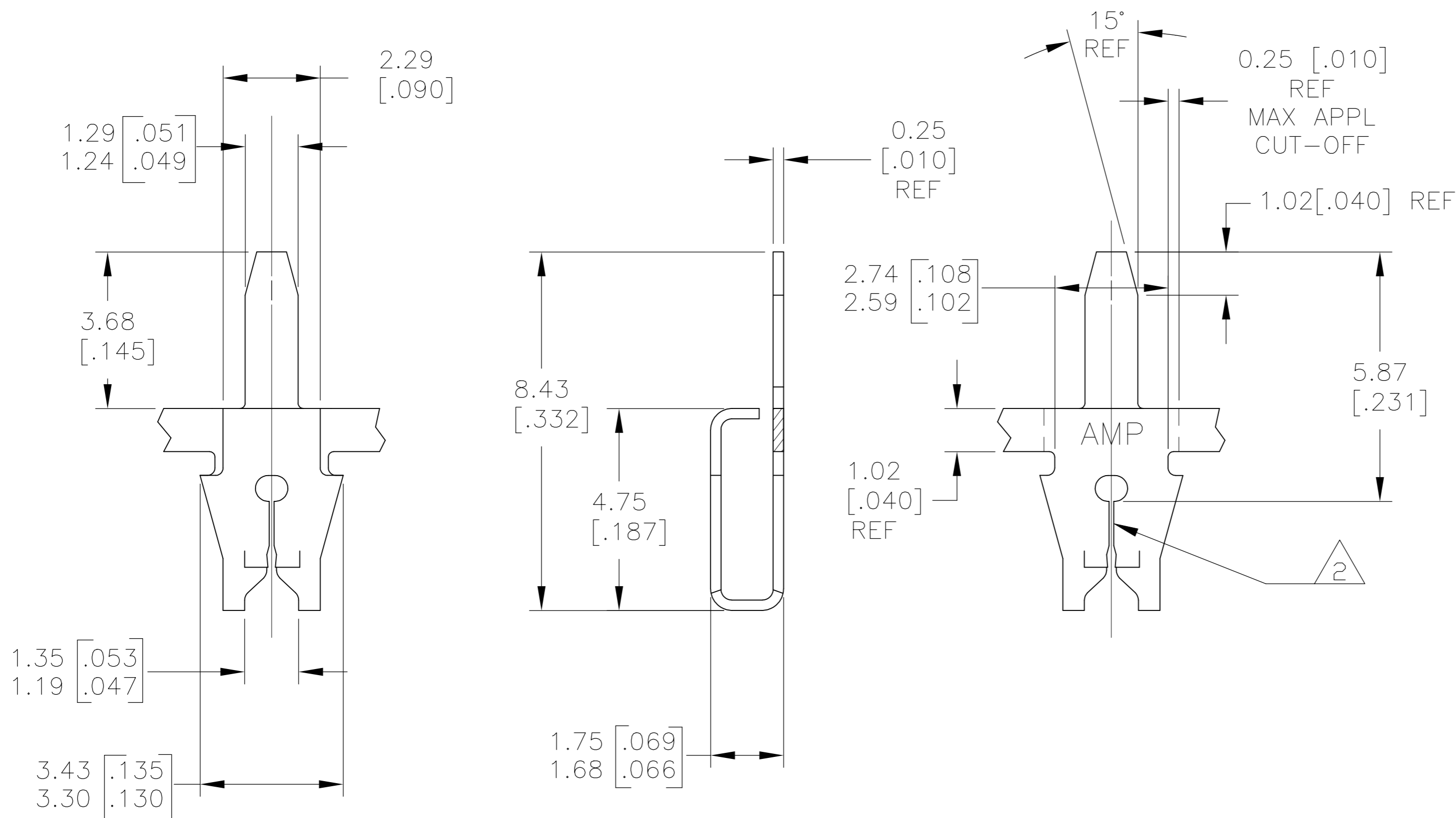

2238062-1

PART NO.

THIS DRAWING IS A CONTROLLED DOCUMENT.		DWN B WAYNE 25FEB2015														
DIMENSIONS: MM [ INCHES ]		CHK KURT RANDOLPH 25FEB15														
TOLERANCES UNLESS OTHERWISE SPECIFIED:		APVD KURT RANDOLPH 25FEB15	NAME TERMINAL, POSTED, 187 SERIES, MAG-MATE													
<table border="0"> <tr><td>0 PLC</td><td>± -</td></tr> <tr><td>1 PLC</td><td>± -</td></tr> <tr><td>2 PLC</td><td>± 0.25 [.010]</td></tr> <tr><td>3 PLC</td><td>± -</td></tr> <tr><td>4 PLC</td><td>± -</td></tr> <tr><td>ANGLES</td><td>± -</td></tr> </table>		0 PLC	± -	1 PLC	± -	2 PLC	± 0.25 [.010]	3 PLC	± -	4 PLC	± -	ANGLES	± -	PRODUCT SPEC 108-2012	SIZE A3	
0 PLC	± -															
1 PLC	± -															
2 PLC	± 0.25 [.010]															
3 PLC	± -															
4 PLC	± -															
ANGLES	± -															
MATERIAL BRASS		APPLICATION SPEC 114-2069	CAGE CODE 00779	DRAWING NO C=2238062												
FINISH TIN		WEIGHT	RESTRICTED TO -													
CUSTOMER DRAWING			SCALE 8:1	SHEET 1 OF 1												
			REV A													