



CABLE 320 RF: RF CABLE ASSEMBLY, I-PEX MHF I LK PLUG + SMA STRAIGHT BULKHEAD JACK + MULTIPLE CABLE OPTIONS - 3GHz

SPECIFICATIONS:

1. I-PEX MHF I LK PLUG, P/N:
 - Ø1.37MM CABLE: 20670-001R-37 + 3376-000
 - Ø1.13MM CABLE: 20670-001R-13 + 3376-000
 - RG178 CABLE: 20670-001R-18 + 3376-000
2. COAXIAL CABLE, SEE P/N OPTION FOR DETAIL.
3. SMA STRAIGHT BULKHEAD JACK, GOLD. P/N: RFCT-SMA010-F78.

USAGE PRECAUTIONS: CABLES USING 'MICRO' COAX ARE DELICATE:

- (i) HANDLE WITH CARE.
- (ii) DO NOT TWIST; APPLY EXCESSIVE FORCES OR SHARP BENDS TO THE CABLE. DO NOT FORCEFULLY DEFORM WIRES.
- (iii) CONSULT CONNECTOR MANUFACTURER'S DATASHEETS FOR DETAILED NOTES ON HANDLING INSTRUCTIONS.

NOTES:

1. THE ORIENTATION OF CONNECTORS ON DRAWING IS FOR REFERENCE ONLY, IF THE ORDER IS LEFT BLANK THE CONNECTOR WILL NOT HAVE FIXED ORIENTATION.
2. FIXED ORIENTATION IS SUGGESTED FOR CABLE LENGTH 25MM TO 100MM. PLEASE SPECIFY THE FIXED ORIENTATIONS FROM THE ORDER CODE (F1, F2, ETC)
3. CONTACT GRAD CONN IF THE ORIENTATION YOU REQUIRE IS NOT SHOWN.
4. WORKING FREQUENCY RANGE: DC-3GHz.
5. OPERATING TEMPERATURE: -40°C TO +85°C.
6. IMPEDANCE: 50 OHM.

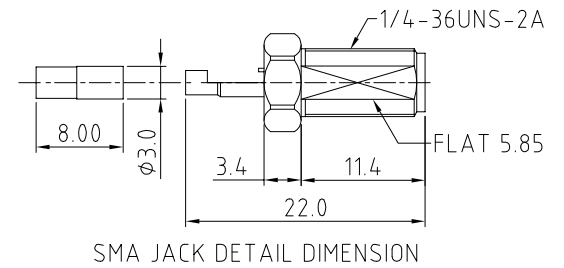
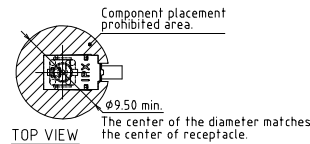
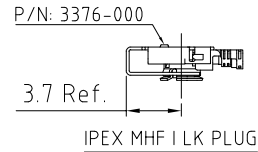
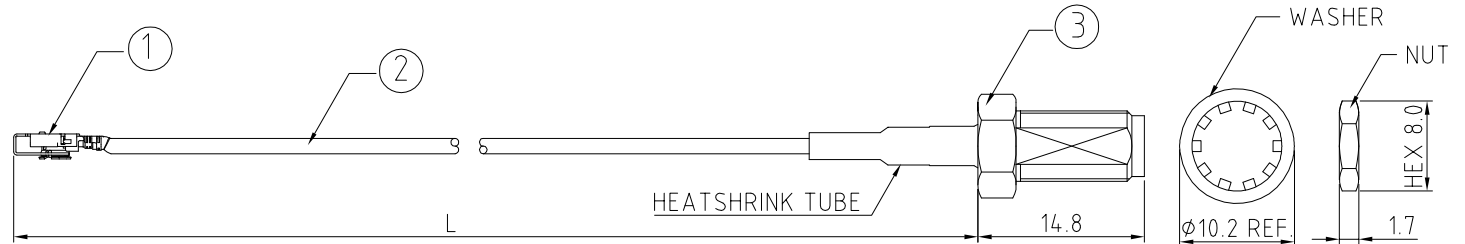

HOW TO ORDER
CABLE 320 RF - X X X - X X - X - X

"L" LENGTH IN MM
eg: 100MM = 100
(MIN. = 025, MAX. = 400)
STANDARD = 100, 150, 200)
Tolerance: <50mm : ±2mm.
51-200mm: ±5mm.
201-400mm: ±7mm.

CABLE SIZE OPTIONS:
1 = Ø1.37MM CABLE, COLOR: BLACK
2 = Ø1.13MM CABLE, COLOR: GRAY (NON-STANDARD)
3 = RG178 CABLE, COLOR: BROWN (NON-STANDARD)

WASHER AND NUT OPTIONS:
BLANK = SEPERATELY PACKED (STANDARD)
A = ASSEMBLED WITH CONNECTOR

ORIENTATION OPTIONS:
BLANK = DOES NOT HAVE A FIXED ORIENTATION
F1 = MHF CONNECTION DOWN (L=25-200MM)
F2 = MHF CONNECTION UP (L=25-200MM)
(SEE NOTES 1, 2, 3 AND DIAGRAMS FOR MORE INFORMATION)

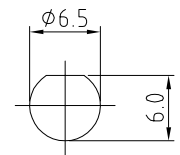
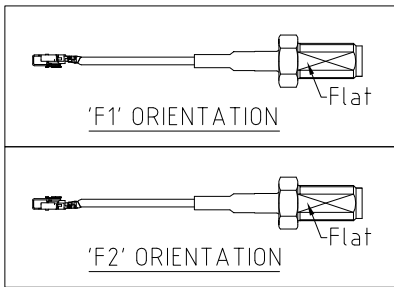

REV. DATE & DRN
10 27/07/18 - NYW RELEASE
11 20/07/20 - NYW ADD NOTES 5 & 6.
12 27/07/20 - NYW AMEND OPERATING TEMP.
13 29/09/20 - NYW ADD 16 PROHIBITED AREA.
14 03/12/20 - NYW UPDATE IPEX P/N.
15 21/12/20 - NYW ADD 13MM CABLE OPTION.
16 27/01/22 - NYW ADD RG178 CABLE OPTION.

Scale: NTS	THIRD ANGLE	Unstated X .XX .XXX ANGLES	Tolerances: N/A N/A N/A	Material SEE NOTE
Drawn: NYW				
App'd: XXX	Title CABLE ASSEMBLY	NOT TO SCALE		
Date: 27 JAN. '22	Revision:1.6	Unit: mm		

THIS DRAWING IS CONFIDENTIAL AND MUST NOT BE COPIED OR DISCLOSED WITHOUT WRITTEN CONSENT

Type: Cable 320 RF
CABLE 320 RF
Drawing Number:
Sheet 1 of 1
Drawing C E and O E