

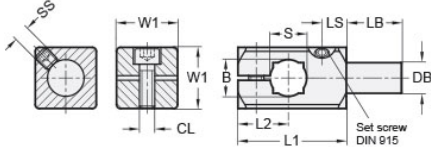

MT12/12-CC90S-AN

Ruland T-Connector Mini-Clamp With Stud, Thru Hole 12mm, Stud Diameter 12mm, Stud Length 19mm, Black Anodized Aluminum



Description

Ruland MT12/12-CC90S-AN is a 90 degree connector with stud with a thru hole for 12mm round or 10mm square tube, 12mm stud diameter, 19mm stud length, and 35.5mm body length. It is designed to fit on Ruland tubes and flange bolt bases that begin with MT12. MT12/12-CC90S-AN is aluminum with a black anodized finish and screws are 304 stainless steel for added corrosion resistance when compared to unplated types. This 90 degree connector clamp with stud is commonly used to support tubes for mounting sensors, screens, reflectors, plexiglass machine guards, and other industrial components. The thru hole allows designers flexibility to reposition the clamp or tube as needed. The stud allows for a more compact installation than other connectors which require the use of a second tube that is significantly longer than the stud. MT10:12-ALK-M5-20 adjustable clamping lever can be used in place of standard clamp hardware for rapid repositioning of the tube or connector without the need for tools. MT12/12-CC90S-AN is manufactured by Otto Ganter, inventoried by Ruland, and RoHS3 compliant.

Product Specifications

Thru Hole Diameter B	12 mm	Thru Hole Tolerance	+0.11/-0 mm
Bolt Length LB	19 mm	Bolt Diameter DB	12 mm
Square Thru Hole S	10 mm	Body Length L1	35.5 mm
Edge To Center L2	16.5 mm	Screw To Edge LS	8 mm
Hole Depth T	12 mm	Width & Height W1	20 mm
Clamp Screw CL	M5	Set Screw SS	M5
Weight (lbs)	0.125700	Material Specification	Anodized Aluminum
Manufacturer	JW Winco/ Otto Ganter	UPC	634529231869
Country of Origin	Germany	Tariff Code	7609.00.0000
UNSPC	31162908		

Note 1 Performance ratings are for guidance only. The user must determine suitability for a particular application.

Prop 65  **WARNING** This product can expose you to the chemical Nickel (metallic), known to the State of California to cause cancer. For more information go to www.P65Warnings.ca.gov.