

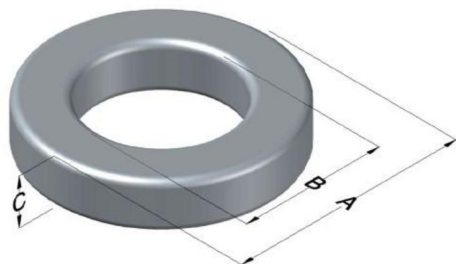

**0076848A7**

110 Delta Drive  
 Pittsburgh, PA 15238  
 NAFTA Sales: (1)800-245-3984  
 HK Sales : (852)3102-9337  
 magnetics@spang.com  
 www.mag-inc.com



Kool M $\mu$ Hf Permeability ( $\mu$ )	$A_L$ (nH/T <sup>2</sup> )	Core Marking			Coating Color
		Lot Number	Part Number	Inductance Grade	
60	32 $\pm$ 8%	XXXXXX	76848A7	N/A	Black

Dimensions						Packaging
Uncoated			Coated Limits			
	(mm)	(in)	(mm)	(in)		Cardboard cut-outs Box Qty = 1600 Pcs
OD (A)	20.32	0.800	21.08	0.830	max	
ID (B)	12.70	0.500	12.07	0.475	min	
HT (C)	6.35	0.250	7.11	0.280	max	

Electrical Characteristics			Physical Characteristics						
Watt Loss @ 100kHz, 100mT (max, mW/cm <sup>3</sup> )	DC Bias min (Oersteds)		Voltage Breakdown wire-to-wire min (V <sub>AC</sub> )	Break Strength (min, kg)	Window Area, W <sub>A</sub> (mm <sup>2</sup> )	Cross Section, A <sub>e</sub> (mm <sup>2</sup> )	Path Length, L <sub>e</sub> (mm)	Volume V <sub>e</sub> (mm <sup>3</sup> )	Weight (g)
	80%	50%							
450	45.0	100	>2000	28.5	114	22.1	50.9	1120	7.2

Winding Information					Temperature Rating		
Winding Length per Turn				Wound Coil Dimensions (mm)		Curie Temp (°C):	500 °C
Winding Factor	(mm)	Winding Factor	(mm)	40% Winding Factor	OD	Coating Temp: (Continuous, up to; °C)	200 °C
0%	23.2	40%	29.3	Completely Full Window	HT	Notes:	
20%	26.3	45%	30.3		Max OD		
25%	27.0	50%	31.2	Max HT	17.4		
30%	27.8	60%	32.9	Surface Area (mm <sup>2</sup> )			
35%	28.6	70%	35.1	Unwound Core:	1200		
				40% Wound:	1900		

