

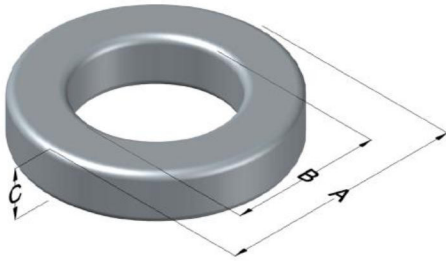

0058726A2

110 Delta Drive
 Pittsburgh, PA 15238
 NAFTA Sales: (1)800-245-3984
 HK Sales : (852)3102-9337
 magnetics@spang.com
 www.mag-inc.com



High Flux Permeability (μ)	A_L (nH/T ²)	Core Marking			Coating Color
		Lot Number	Part Number	Inductance Grade	
60	175 ± 8%	XXXXXX	58726A2	N/A	Khaki

Dimensions	Uncoated		Coated Limits			Packaging
	(mm)	(in)	(mm)	(in)		
OD (A)	50.55	1.990	51.51	2.020	max	Cardboard cut-outs Box Qty= 70 pcs
ID (B)	24.77	0.975	24.00	0.945	min	
HT (C)	20.83	0.820	21.59	0.850	max	

Electrical Characteristics			Physical Characteristics						
Watt Loss @ 100 kHz, 100mT max(mW/cm ³)	DC Bias min (oersteds)		Voltage Breakdown wire to wire min (V _{AC})	Break Strength min (kg)	Window Area W _A (mm ²)	Cross Section A _e (mm ²)	Path Length L _e (mm)	Volume V _e (mm ³)	Weight (g)
	80%	50%							
900	90.0	170	3000	95.0	452	262	113.5	29,700	230

Winding Information					Temperature Rating			
Winding Length Per Turn				Wound Coil Dimensions (mm)		Curie Temp: 460°C		
Winding Factor	(mm)	Winding Factor	(mm)			Coating Temp (Continuous up to): 200°C		
				40% Winding Factor		Notes:		
0%	70.7	40%	82.8	OD	55.0			
				HT	29.0			
20%	76.9	45%	84.8	Max OD	68.0			
25%	78.3	50%	86.6	Max HT	41.0			
				Surface Area (mm ²)				
				Unwound Core	8,300			
35%				81.5	70%	94.4	40% Winding Factor	11,500

Typical DC Bias Performance

