

**BATTERYGUY**

**Lithium**

# Cell Type CR8·LHC Specifications

FLUSH-2

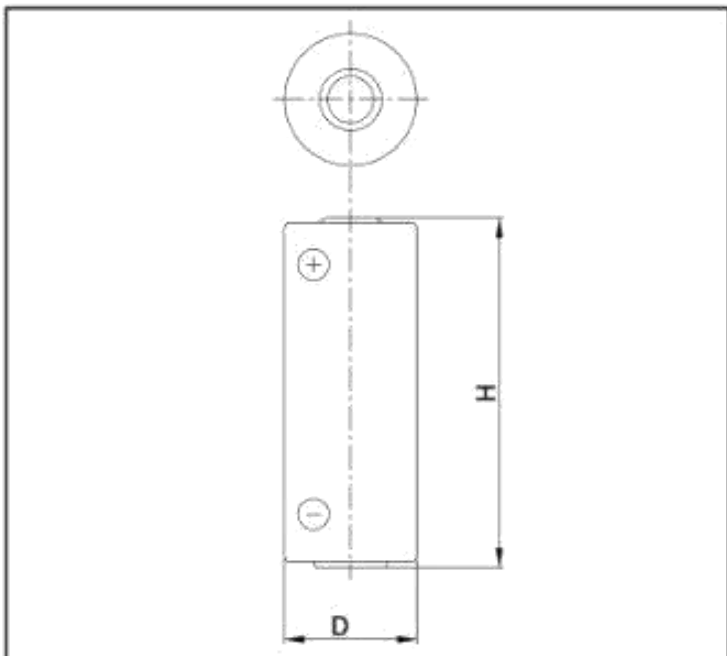

Nominal Voltage (V)		3
Nominal Capacity (mAh) *1		3000
Standard Discharge Current (mA)		0.1
Operating Temperature Range (°C) *2		-40 ~ +85
Max. Dimensions (mm)	Diameter (D)	17.0
	Height (H)	45.0
Weight (g)		23

\*1 Nominal capacity is determined at an end voltage of 2.0V when the battery is allowed to discharge at a standard current level at +23°C.

\*2 Consult FDK when using batteries at temperatures exceeding the -20°C to +60°C range.

## Typical Characteristics (Estimated Curve)

Temperature Characteristics of CR8·LHC

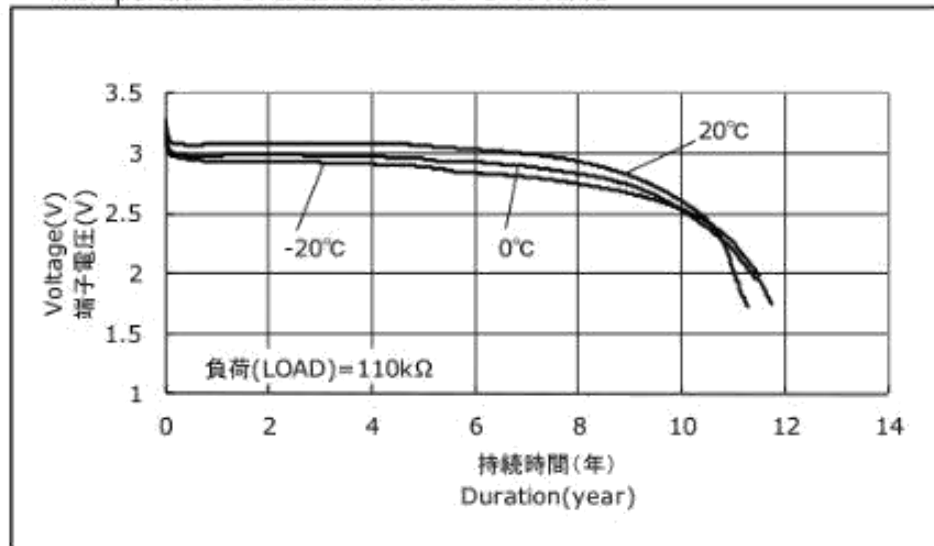

Temperature Characteristics of CR8·LHC

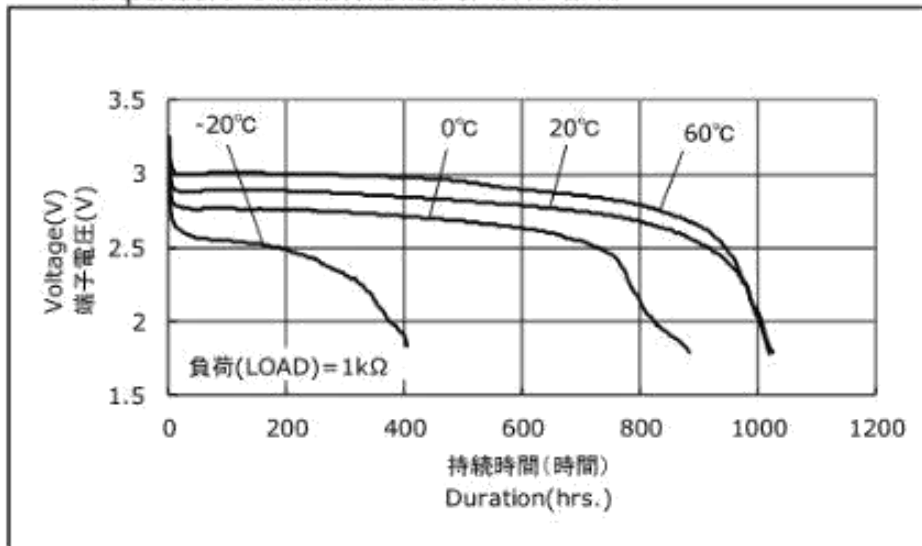

Pulse discharge Characteristics of CR8·LHC

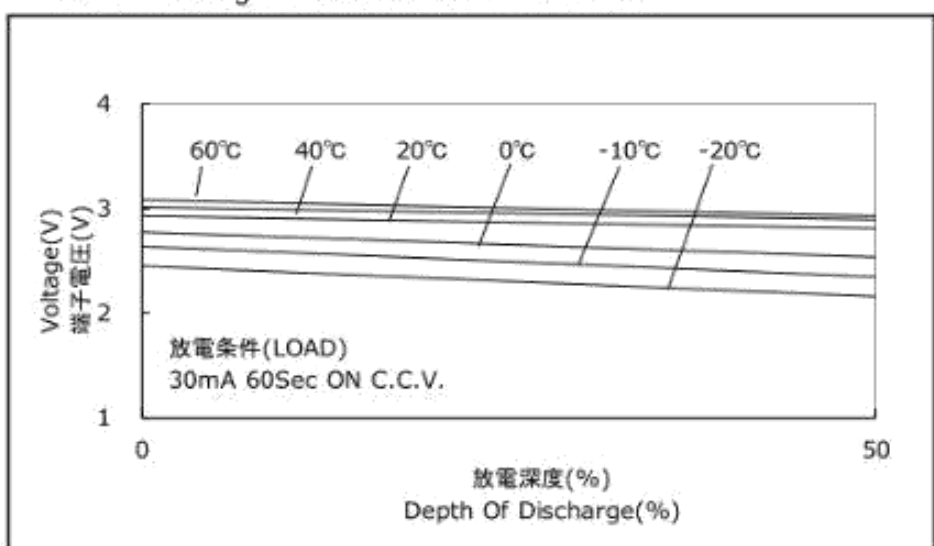

Discharge Load vs. Cell Capacity of CR8·LHC

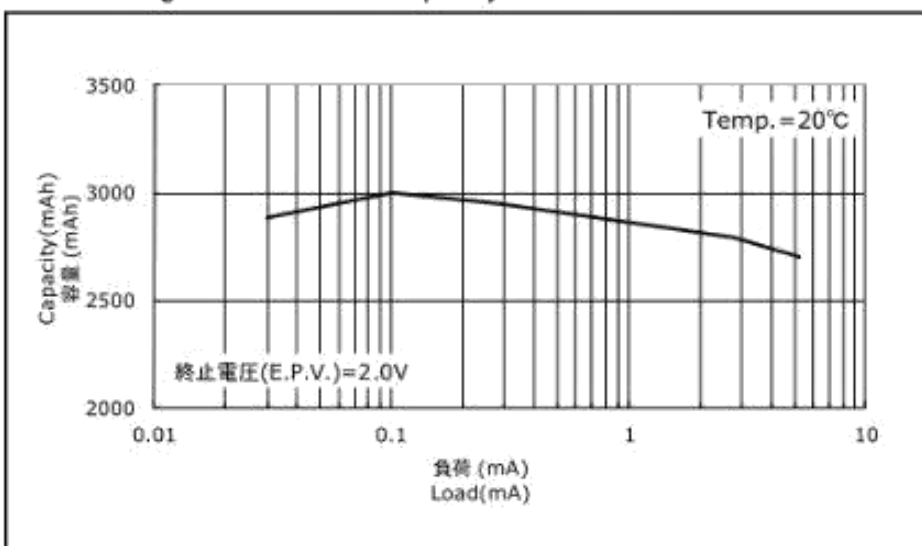

**The data in this document are for descriptive purposes only and are not intended to make or imply any guarantee or warranty.**