

Specifications:
 Current rating:3.0A AC/DC
 Voltage rating:60V AC/DC
 Contact resistance:4m ohm. max.
 Insulator resistance:1000M ohm. Min.
 Withstanding voltage:100V AC for one minute
 Operating temperature range:-40°C to +105°C

Material and Finish:
 Insulator:PBT (UL94V-0)
 Contact:Beryllium Copper(Becu) 10u" Gold Plated
 Sleeve Barrel:Brass Tin Plated

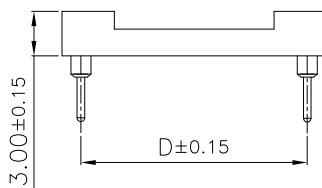
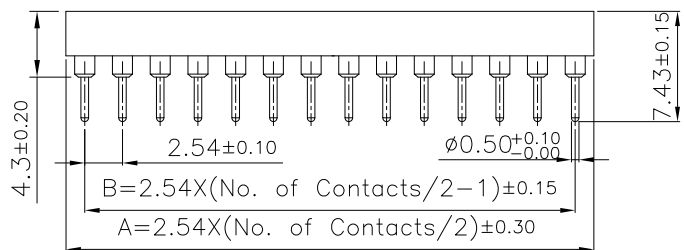

Note1: W/O middle bar(6~16P)
 With middle bar(18~48P)

PART NO.	Circuits	DIM.A	DIM.B	DIM.C	DIM.D	PART NO.	Circuits	DIM.A	DIM.B	DIM.C	DIM.D
211-1-XX-003	6	7.62	5.08	10.18	7.62	211-1-XX-006	24	30.48	27.94	17.80	15.24
	8	10.16	7.62	10.18	7.62		28	35.56	33.02	17.80	15.24
	14	17.78	15.24	10.18	7.62		32	40.64	38.10	17.80	15.24
	16	20.32	17.78	10.18	7.62		40	50.80	48.26	17.80	15.24
	18	22.86	20.32	10.18	7.62		42	53.34	50.80	17.80	15.24
	20	25.40	22.86	10.18	7.62		48	60.96	58.42	17.80	15.24

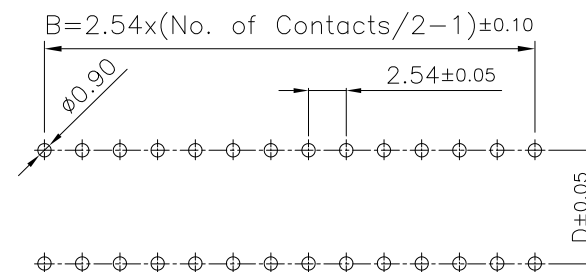

PCB Layout

RoHS Compliant

				DRAWN:	GENERAL TOLERANCE: .X=±0.38 .XX=±0.25	<h1 style="color: red; text-align: center;">CnC Tech</h1> <p style="text-align: center;">Industrial Cable and Connector Technology</p>		
				CHECKED:	UNIT: MM			DESCRIPTION: 2.54mm IC Socket Machine Pin 10u" Gold Plated
					SCALE:1:1	PART NO:	A4	
	05-FEB-2020			APPROVAL:	SHEET: 1 / 1	211-1-XX-00X		
REV	DATE	FILE	BY		PROJECTION:			

