

NOTES:

1. MATERIALS AND FINISHES(PLATING THICKNESS IN MICRO-INCHES):
 BODY - BERYLLIUM COPPER, WHITE BRONZE PLATING (COPPER-TIN-ZINC)
 CONTACT - BERYLLIUM COPPER, GOLD PLATING
 INSULATOR - PTFE
2. ELECTRICAL:
 A. IMPEDANCE: 50 OHM
 B. FREQUENCY RANGE: DC 0- 4 GHz
 C. VSWR(RETURN LOSS): 1.5 MAX.
 D. DIELECTRIC WITHSTANDING VOLTAGE: 1000 VRMS, MIN
3. MECHANICAL:
 A. DURABILITY: 500 CYCLES MIN.
 B. TEMPERATURE RANGE: -40°C TO +155°C
4. OTHER
 A. CRIMPED FERRULE: HEX CRIMP SIZE .128"
 B. SOLDER CONTACT CONDUCTOR

THIRD ANGLE PROJ.

REVISIONS

| REV | DESCRIPTION | DATE | ECO | APPR |
|-----|--|-----------|-------|-------|
| A | RELEASE TO MFG. | 8/8/06 | 46108 | CISSY |
| B | CHANGE NOTE 3 "0.005" TO "0.12"; 13.28 WAS 13.36; 9.03 WAS 10.11; ADD NOTE WITH ARROWS ITEM 2 & ITEM 1 MUST BOTT AGAINST ITEM 6 AS SHOWN, AND ITEM 6 WAS CHANGED | 9-16-06 | 46257 | JEKY |
| C | TRANSFER TO ARFA | 29-Mar-11 | 48515 | SH |
| D | FERRULE, BARREL WERE CHANGED/RD-DA11070801L2 | 06-Jul-11 | 48694 | SH |
| E | NO CHANGE TO COD | 14-Oct-17 | 05562 | MZ |

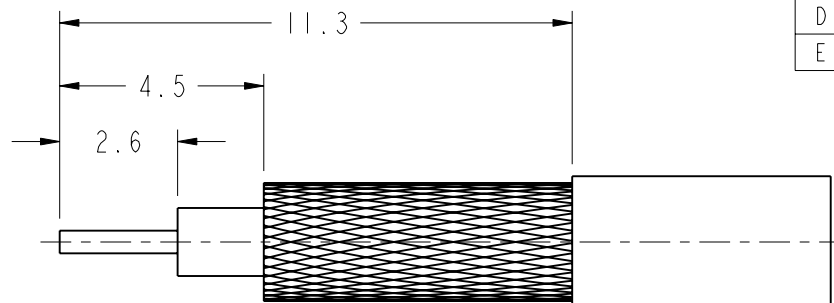

RECOMMENDED
CABLE STRIPPING DIM'S

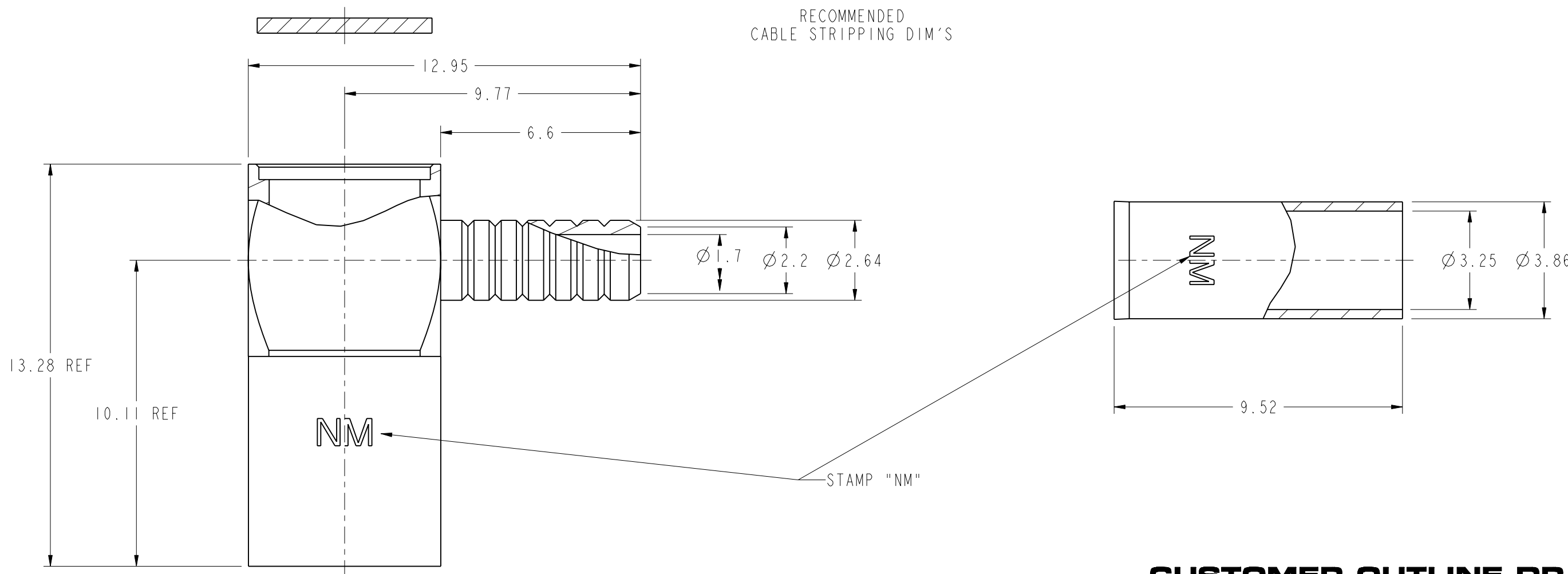

CUSTOMER OUTLINE DRAWING
ALL OTHER SHEETS ARE FOR INTERNAL USE ONLY

UNLESS OTHERWISE SPECIFIED, DIMENSIONS ARE IN METRIC AND TOLERANCES ARE:
 <math>< 0.5\text{mm}</math> $0.5 - 6\text{mm}$ $6 - 30\text{mm}$ $30 - 120\text{mm}$ ANGLES
 $\pm 0.05\text{mm}$ $\pm 0.1\text{mm}$ $\pm 0.2\text{mm}$ $\pm 0.3\text{mm}$ $\pm 1^\circ$

NOTICE - These drawings, specifications, or other data (1) are, and remain the property of Amphenol corp. (2) must be returned upon request; and (3) are confidential and not to be disclosed to any person other than those to whom they are given by Amphenol Corp. the finishing of these drawings, specifications, or other data by Amphenol Corp., or to any other person for any purpose is not to be regarded by implication or otherwise in any manner licensing, granting rights to permitting such holder or any other person to manufacture, use or sell any product, process or design, patented or otherwise, that may in any way be related to or disclosed by said drawings, specifications, or other data.

| | |
|-----------|-------------|
| MATERIAL | |
| REFERENCE | 903-289-51A |
| FINISH | |

| | | | |
|----------|----------|------|-----------|
| DRAWN | K. SONG | DATE | 23-Oct-17 |
| ENGINEER | GEFFERY | DATE | 16-Sep-06 |
| APPROVED | S. HSIEH | DATE | 24-Oct-17 |
| CAD FILE | | | |

| | |
|--|--------------|
| TITLE | |
| SMB RIGHT ANGLE PLUG FOR RG-316/U NON MAGNETIC | |
| SCALE: 7.0:1.0 | SHEET 2 OF 2 |
| DWG SIZE | REV |
| B | E |

| | |
|---|----------------|
| Amphenol RF | |
| Danbury CT USA, Tainan, Taiwan, Shenzhen, China www.amphenolrf.com | |
| DRAWING NO. 903-NM289P-51A | |
| ITEM NO. | 903-NM289P-51A |
| PART NO. | 903-NM289P-51A |