

Fuse link, SEV G2 500V (gG)



See below:

[Approvals and Compliances](#)

### Description

- According to IEC 269
- According to EN 60269
- Selectivity 1:1.6
- Removal tags energized
- Dimensions according to SNV 24482

### Unique Selling Proposition

- Characteristic gG
- Full-range fuse-links for general applications

### Weblinks

[pdf data sheet](#), [html datasheet](#), [Detailed request for product](#)

### Technical Data

Rated Current In	40- 250A
Rated Voltage	500VAC
Breaking Capacity	120 kA
Rated Power Operating Frequency	50Hz

### Basic Design

Insulator	Ceramics
Metal components	corrosion-resistant (rustproof)

### Power Dissipation (Watt) operating temperature max.

The power dissipation is the so called power loss at rated current load and operation temperature acc. VDE 0636 . It is to be measured in Watt at AC condition. The voltage tap is to be assured that the power dissipation of the blade contacts are included. This means the measure contact need to be applied at the ends of the blade contacts. The standard VDE 0636 part 1 and 2 requires that following maximal permissible power losses are not exceeded.

### Approvals and Compliances

Detailed information on product approvals, code requirements, usage instructions and detailed test conditions can be looked up in [Details about Approvals](#)

### Compliances

The product complies with following Guide Lines

Identification	Details	Initiator	Description
REACH	REACH	SCHURTER AG	On 1 June 2007, Regulation (EC) No 1907/2006 on the Registration, Evaluation, Authorization and Restriction of Chemicals 1 (abbreviated as "REACH") entered into force.

## Dimensions [mm]

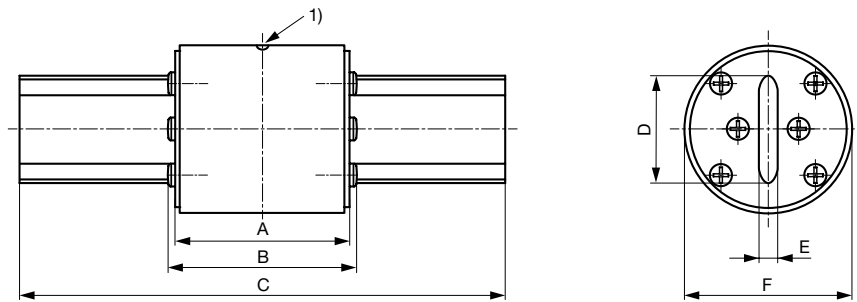

SEV	A	B	C	D	E	F
2	53	58	134	25	5	45
4	61	65	162	35	6	55
6	66	70	188	42	8	70

1) Indicator

## Time-Current-Curves

SEV G2 - G6

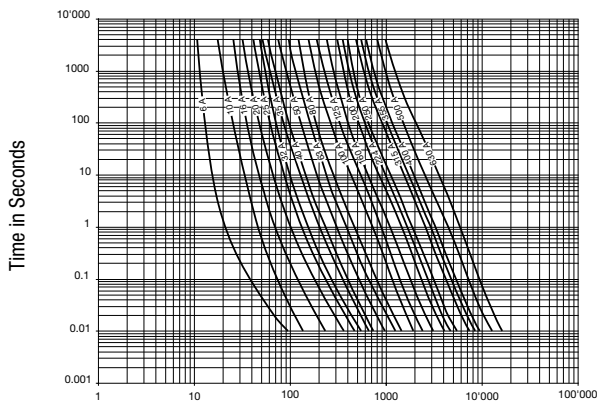

Current in Amperes

## All Variants

Rated current [A]	Style [Compact]	Power Loss [W]	Order Number	E-No.
40	-	-	1301.2201	840110149
50	-	-	1301.2202	840110159
63	-	-	1301.2203	840110179
80	-	-	1301.2204	840110199
100	-	-	1301.2205	840110209
125	-	-	1301.2206	840110219

Rated current [A]	Style [Compact]	Power Loss [W]	Order Number	E-No.
160	-	-	<a href="#">1301.2207</a>	840110239
200	-	-	<a href="#">1301.2208</a>	840110249
250	-	-	<a href="#">1301.2209</a>	840110269

Most Popular.

Availability for all products can be searched real-time:<https://www.schurter.com/en/Stock-Check/Stock-Check-SCHURTER>

**Packaging unit** 3 Pcs