

MPCG0730LR40

Aliases (UPIB0730LR4000)

Not for New Design

KEMET, MPCG, Power, 0.4 uH, 20%, 3026

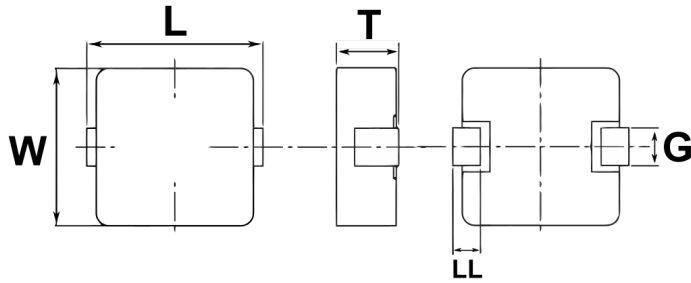

Click [here](#) for the 3D model.

Dimensions

L	7.5mm +/-0.5mm
W	6.7mm +/-0.3mm
T	3mm MAX
LL	1.5mm NOM
G	1.65mm +/-0.3mm

Packaging Specifications

Packaging	T&R, 330mm
Packaging Quantity	1000

General Information

Series	MPCG
Style	SMD
Chip Size	3026
Description	Shielded, Surface Mount Inductor
Features	High Speed, Large Current DC/DC Converter
RoHS	Yes
Core	Composite

Specifications

Inductance	0.4 uH
Inductance Tolerance	20%
Temperature Range	-40/+125°C
Rated Temperature	120°C
Shielded	Yes
Current	16 Amps (Isat, 20% Drop In Inductance), 16 Amps (Irms, 40C Rise By Self Heating)
DC Resistance	2.6 mOhms