

REVISION RECORD				
REV	ECO	DESCRIPTION	DRFT	CHKD
△		Add P/N	Sammy 08/01/04	
△		NOTES MODIFY	Among 10/22/04	

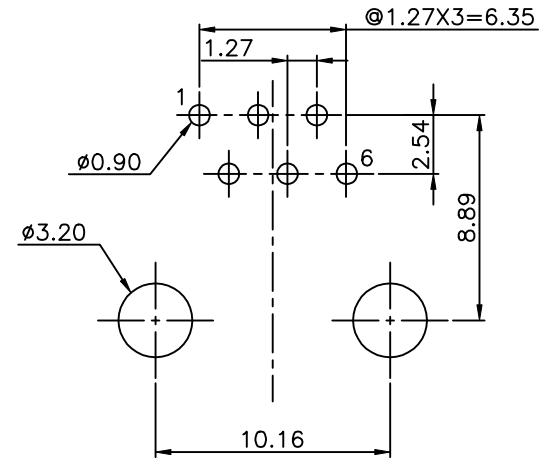
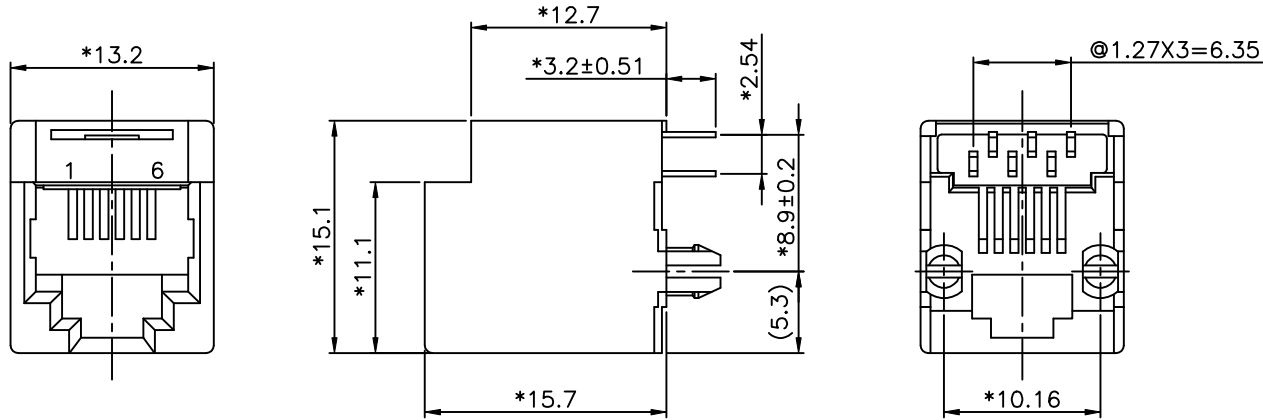

**NOTES:**

ELECTRICAL:

1. VOLTAGE RATING: 125 VAC RMS .
2. CURRENT RATING: 1.5 AMP .
3. CONTACT RESISTANCE: 30 MILLIOHMS MAX.
4. INSULATION RESISTANCE: 1000 MEGOHMS MIN @ 500 VDC.
5. DIELECTRIC STRENGTH: 1000 VAC RMS 60Hz, 1MIN.

MECHANICAL:

1. HOUSING MATERIAL: GLASS FILLED POLYESTER UL 94V-0
2. CONTACT MATERIAL: PHOSPHOR BRONZE. t=0.35mm
- △ 3. PLATING: GOLD PLATING OVER NICKEL.
4. OPERATING LIFE: 750 CYCLES MIN.
5. PCB RETENTION PRE-SOLDER: 1 LB MIN.
6. PCB RETENTION POST-SOLDER: 10 LBS MIN.

ENVIRONMENTAL:

1. STORAGE: -40°C TO +85°C.
- △ 2. OPERATION: -40°C TO +85°C.

PART NUMBER: E526X-70004X

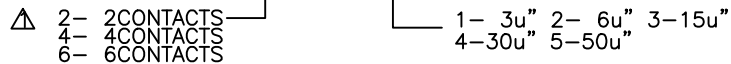

DETACHED LISTS	MM (INCH)	DFTD SANDY DATE 1/5/00	FULL RISE ELECTRONIC CO., LTD	
	TOLERANCES EXCEPT AS NOTED	CHKD SAMMY DATE 2004/11/17		
	MM	MFO DATE	TITLE	
	.0 ±0.20 ±	APPVL LUSHENG DATE 2004/11/17	TOP ENTRY PCB JACK (DIP TYPE)	
.00 ±0.15 ±	MATERIAL :	DRAWING NO. GE523030	SIZE A3	REV 2
.000 ±0.075 ±	ANGLES ±	/PART NO. SEE NOTE		
THIRD ANGLE PROJECTION	FINISH :	DO NOT SCALE DRAWING	SHEET X	OF Y
	SCALE :			