

10 ROW
10 POSITION
SHOWN
SEE SHEET 3 FOR
8 ROW GEOMETRY &
SEE SHEET 4 FOR
6 ROW GEOMETRY

NOTES:

1. MATERIAL: HOUSING: GLASS FILLED LCP (LIQUID CRYSTAL POLYMER), UL94V-0, BLACK
CONTACTS: COPPER ALLOY
SOLDER CHARGE: 95.5% TIN, 3.8% SILVER, 0.7% COPPER
2. FINISH: SELECT GOLD IN CONTACT AREA, 30 MICROINCH MINIMUM
SELECT TIN ON TAIL, 50 MICROINCH MINIMUM
OVERALL NICKEL UNDERPLATE
3. PRODUCT SPECIFICATION: PS-45970-001
4. PACKAGING SPECIFICATION: PK-45971-002 (TAPE AND REEL)
5. MATES WITH SEARAY PLUG ASSEMBLY SERIES 45970
6. APPLICATION SPECIFICATION: AS-45970-001
7. COSMETIC SPECIFICATION: PS-45499-002 CLASS B
8. PART STATUS: CONTACT MOLEX

| POSITIONS | TOTAL NUMBER OF EDGE NOTCHES | |
|-----------|------------------------------|-----------|
| 10 | 8 | 0.15/.006 |
| 15 | 14 | |
| 20 | 18 | |
| 25 | 24 | |
| 30 | 28 | |
| 35 | 34 | 0.23/.009 |
| 40 | 38 | |
| 45 | 44 | |
| 50 | 48 | |

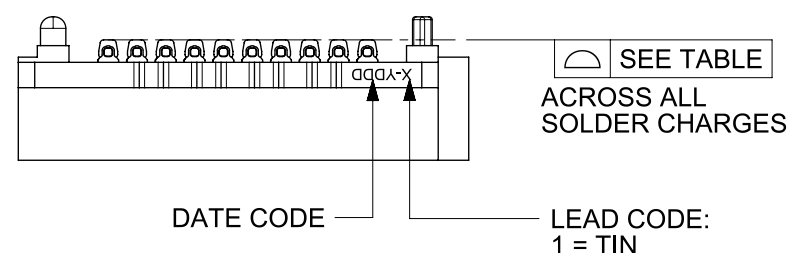

NOTE: THESE CODES MAY BE LOCATED ON EITHER SIDE OF THE HOUSING

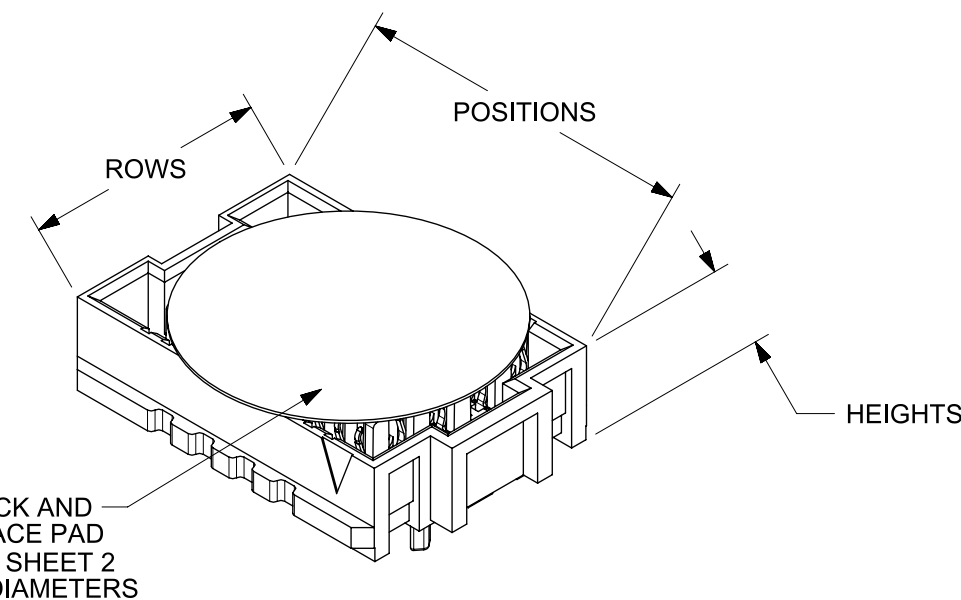
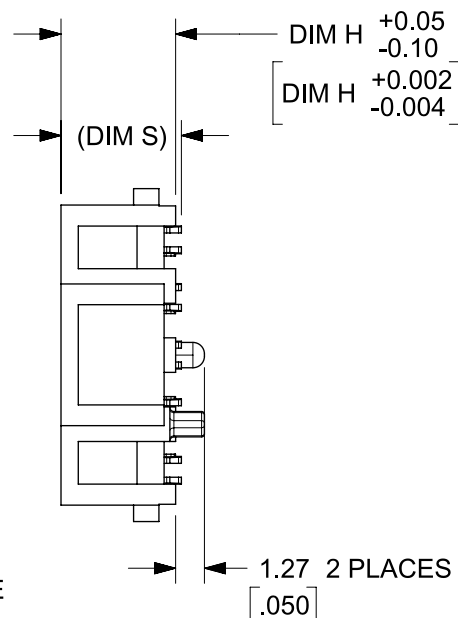
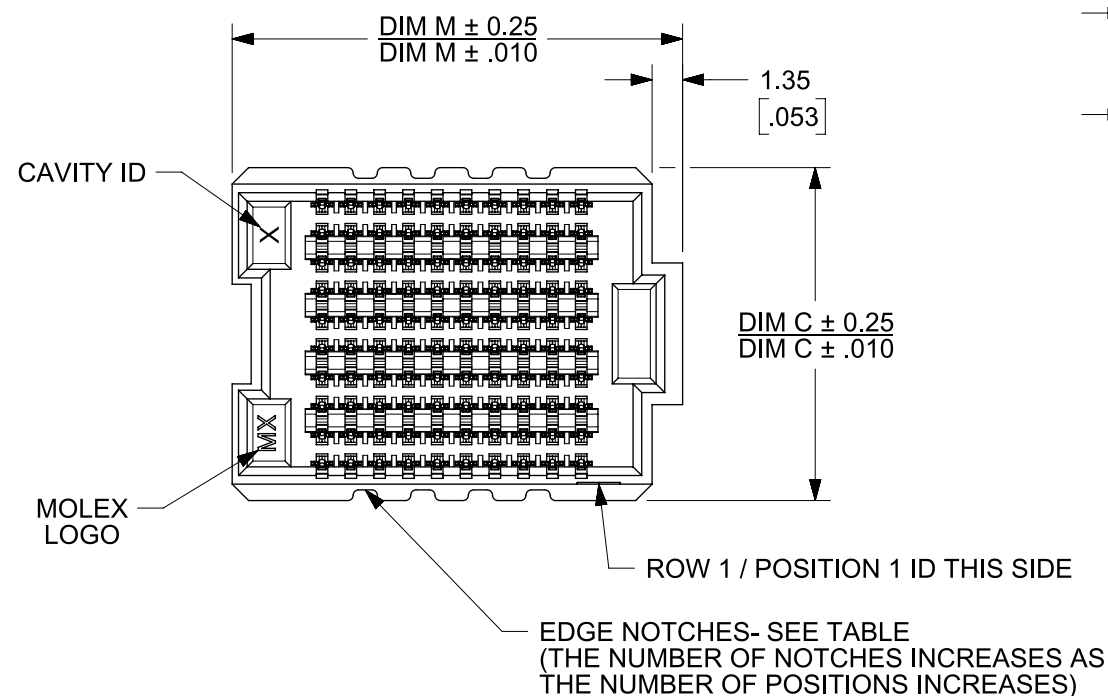

| | | | | | | | | | |
|---|--|-----------------------------------|--|---------------------------------------|--|--------------------------|--|---------------------------------------|--|
| THIS DRAWING CONTAINS INFORMATION THAT IS PROPRIETARY TO MOLEX ELECTRONIC TECHNOLOGIES, LLC AND SHOULD NOT BE USED WITHOUT WRITTEN PERMISSION | | | | | | | | | |
| DIMENSION UNITS: MM/IN | | SCALE: 3:1 | | CURRENT REV DESC: | | | | molex | |
| GENERAL TOLERANCES (UNLESS SPECIFIED) | | ANGULAR TOL ± ° | | EC NO: 712067 | | | | | |
| 4 PLACES ± | | 3 PLACES ± | | 2 PLACES ± 0.25 | | 1 PLACE ± 0.38 | | 0 PLACES ± | |
| DRAFT WHERE APPLICABLE MUST REMAIN WITHIN DIMENSIONS | | THIRD ANGLE PROJECTION | | DRAWING: B-SIZE | | SERIES: 45971 | | MATERIAL NUMBER: SEE TABLE SHEET NO 5 | |
| DOCUMENT STATUS: P1 | | RELEASE DATE: 2022/07/14 16:45:44 | | DRWN: CLHOE01 | | 2022/01/25 | | 2022/06/27 | |
| | | | | CHK'D: HCGOH | | 2022/07/14 | | 2005/05/17 | |
| | | | | APPR: SHONG | | 2010/03/05 | | 2010/03/05 | |
| | | | | INITIAL REVISION: | | | | SD-45971-001 | |
| | | | | DRWN: TREGORI | | | | PSD | |
| | | | | APPR: JCOMERCI | | | | 001 | |
| | | | | THIRD ANGLE PROJECTION | | | | AA | |
| | | | | DRAWING: B-SIZE | | SERIES: 45971 | | 1 OF 5 | |
| | | | | MATERIAL NUMBER: SEE TABLE SHEET NO 5 | | CUSTOMER: GENERAL MARKET | | | |

10 ROW
10 POSITION
SHOWN

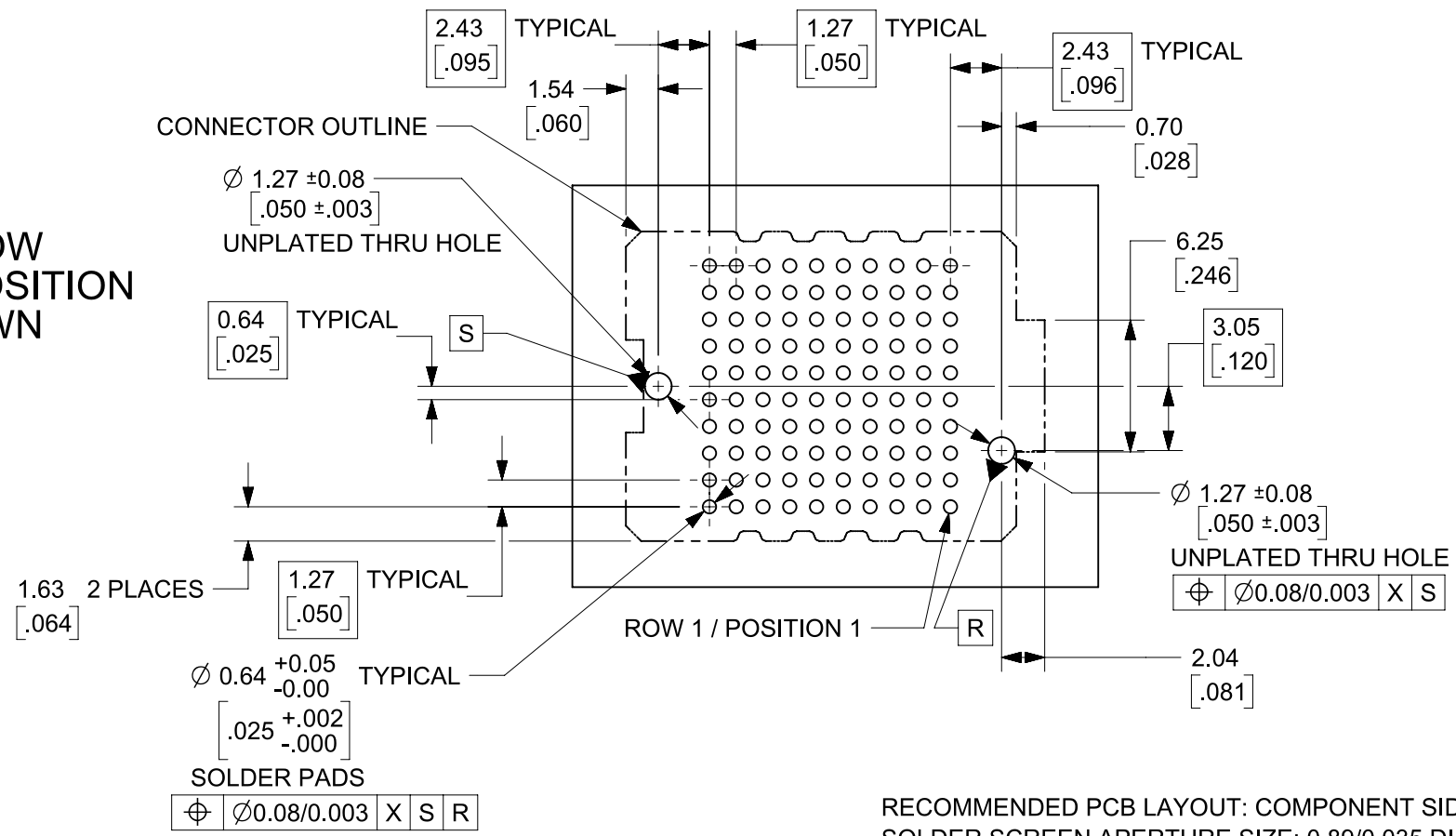

RECOMMENDED PCB LAYOUT: COMPONENT SIDE
SOLDER SCREEN APERTURE SIZE: 0.89/0.035 DIAMETER
PCB THICKNESS: NA

DIM M/2 ±1.52
DIM M/2 ±0.60
PAD
LOCATION

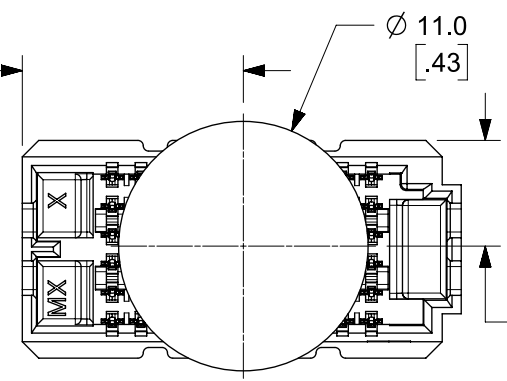

6 ROW OPTION

DIM M/2 ±1.52
DIM M/2 ±0.60
PAD
LOCATION

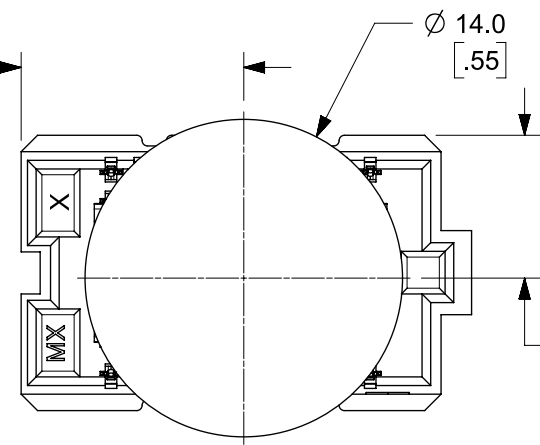

8 ROW OPTION

DIM M/2 ±1.52
DIM M/2 ±0.60
PAD
LOCATION

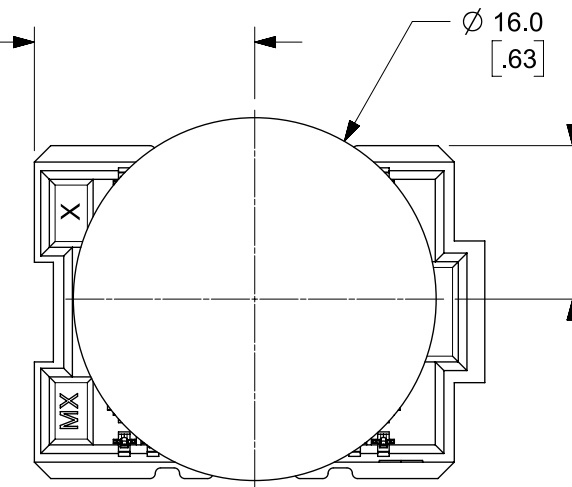

10 ROW OPTION

DIM C/2 ±1.52
DIM C/2 ±0.60
PAD
LOCATION

DIM C/2 ±1.52
DIM C/2 ±0.60
PAD
LOCATION

DIM C/2 ±1.52
DIM C/2 ±0.60
PAD
LOCATION

PICK AND PLACE PAD DIAMETERS 10 POSITION VERSIONS SHOWN

| | | | | | | | | | |
|---|--|---------------------|--|---|--|------------|--|----------|--|
| THIS DRAWING CONTAINS INFORMATION THAT IS PROPRIETARY TO MOLEX ELECTRONIC TECHNOLOGIES, LLC AND SHOULD NOT BE USED WITHOUT WRITTEN PERMISSION | | | | | | | | | |
| DIMENSION UNITS MM/IN | | SCALE 3:1 | | CURRENT REV DESC: | | | | | |
| GENERAL TOLERANCES (UNLESS SPECIFIED) | | | | molex SEARAY RECEPTACLE ASSEMBLY 1.27/.050 CENTERS PRODUCT CUSTOMER DRAWING | | | | | |
| ANGULAR TOL ± ° | | | | | | | | | |
| 4 PLACES ± | | | | | | | | | |
| 3 PLACES ± | | | | | | | | | |
| 2 PLACES ± 0.25 | | | | | | | | | |
| 1 PLACE ± 0.38 | | | | | | | | | |
| 0 PLACES ± | | | | EC NO: 712067 | | 2022/01/25 | | | |
| DRAFT WHERE APPLICABLE MUST REMAIN WITHIN DIMENSIONS | | | | THIRD ANGLE PROJECTION | | DRAWING | | SERIES | |
| DOCUMENT STATUS | | P1 | | RELEASE DATE | | 2022/07/14 | | 16:45:44 | |
| SD-45971-001 | | PSD | | 001 | | AA | | 2 OF 5 | |

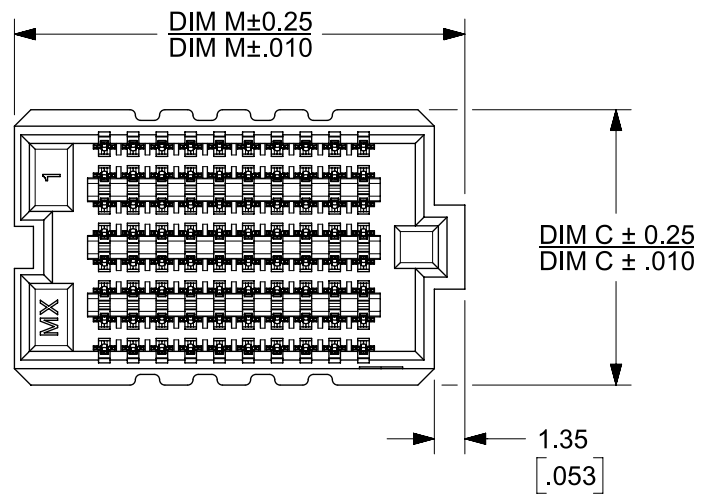

NOTE: THESE CODES MAY BE LOCATED ON EITHER SIDE OF THE HOUSING
 LEAD CODE: 1 = TIN
 DATE CODE

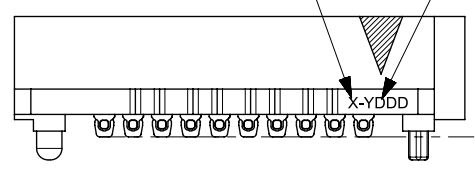

SEE TABLE
 ACROSS ALL SOLDER CHARGES

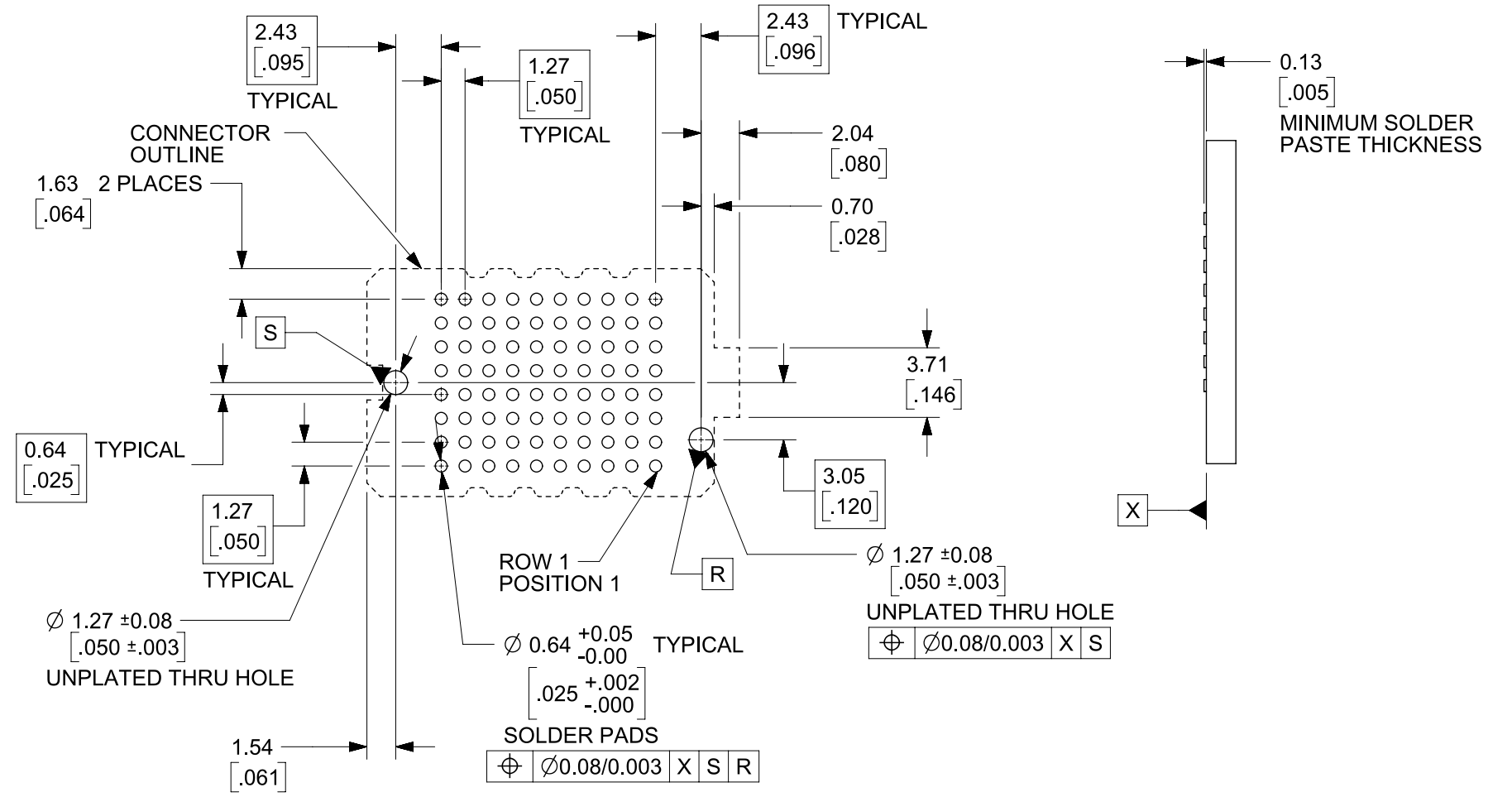
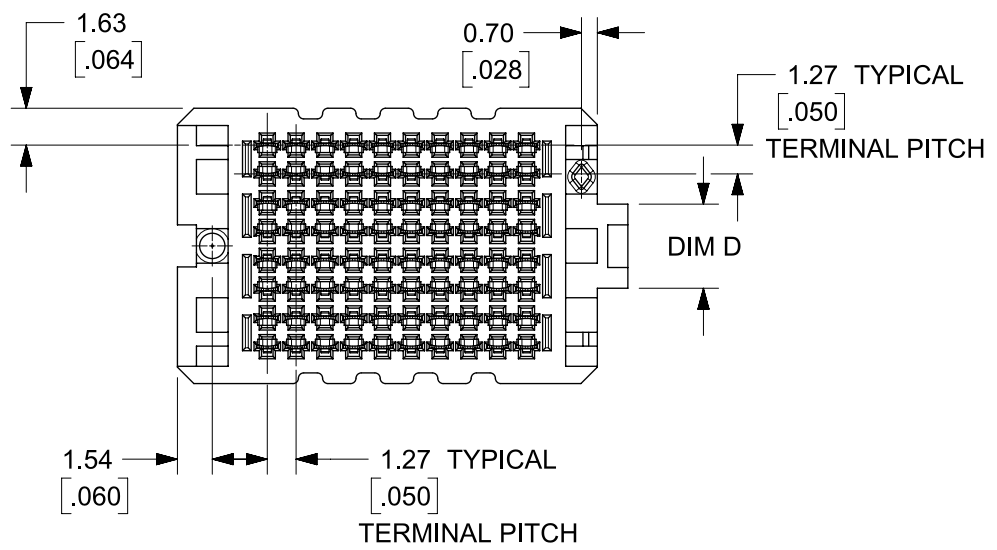

RECOMMENDED PCB LAYOUT: COMPONENT SIDE
 SOLDER SCREEN APERTURE SIZE: 0.89/0.035 DIAMETER
 PCB THICKNESS: NA
 8 ROW 10 POSITION SHOWN

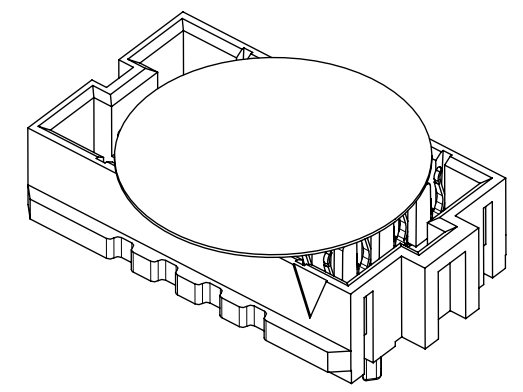

| | | | | | | | | | |
|---|--|------------------------|--|---|--|--------|--|---|--|
| THIS DRAWING CONTAINS INFORMATION THAT IS PROPRIETARY TO MOLEX ELECTRONIC TECHNOLOGIES, LLC AND SHOULD NOT BE USED WITHOUT WRITTEN PERMISSION | | | | | | | | | |
| DIMENSION UNITS: MM/IN | | SCALE: 3:1 | | CURRENT REV DESC: | | | | | |
| GENERAL TOLERANCES (UNLESS SPECIFIED) | | | | EC NO: 712067 DRWN: CLHOE01 CHK'D: HCGOH APPR: SHONG | | | | | |
| ANGULAR TOL ± ° | | | | 2022/01/25 2022/06/27 2022/07/14 | | | | SEARAY RECEPTACLE ASSEMBLY 1.27/.050 CENTERS | |
| 4 PLACES ± | | | | INITIAL REVISION: | | | | PRODUCT CUSTOMER DRAWING | |
| 3 PLACES ± | | | | DRWN: TGREGORI | | | | DOCUMENT NUMBER | |
| 2 PLACES ± 0.25 | | | | APPR: JCOMERCI | | | | SD-45971-001 | |
| 1 PLACE ± 0.38 | | | | 2005/05/17 | | | | DOC TYPE DOC PART REVISION | |
| 0 PLACES ± | | | | 2010/03/05 | | | | PSD 001 AA | |
| DRAFT WHERE APPLICABLE MUST REMAIN WITHIN DIMENSIONS | | THIRD ANGLE PROJECTION | | DRAWING | | SERIES | | MATERIAL NUMBER CUSTOMER | |
| | | | | B-SIZE | | 45971 | | SEE TABLE SHEET NO 5 GENERAL MARKET | |
| | | | | | | | | SHEET NUMBER | |
| | | | | | | | | 3 OF 5 | |

6 ROW
10 POSITION
SHOWN

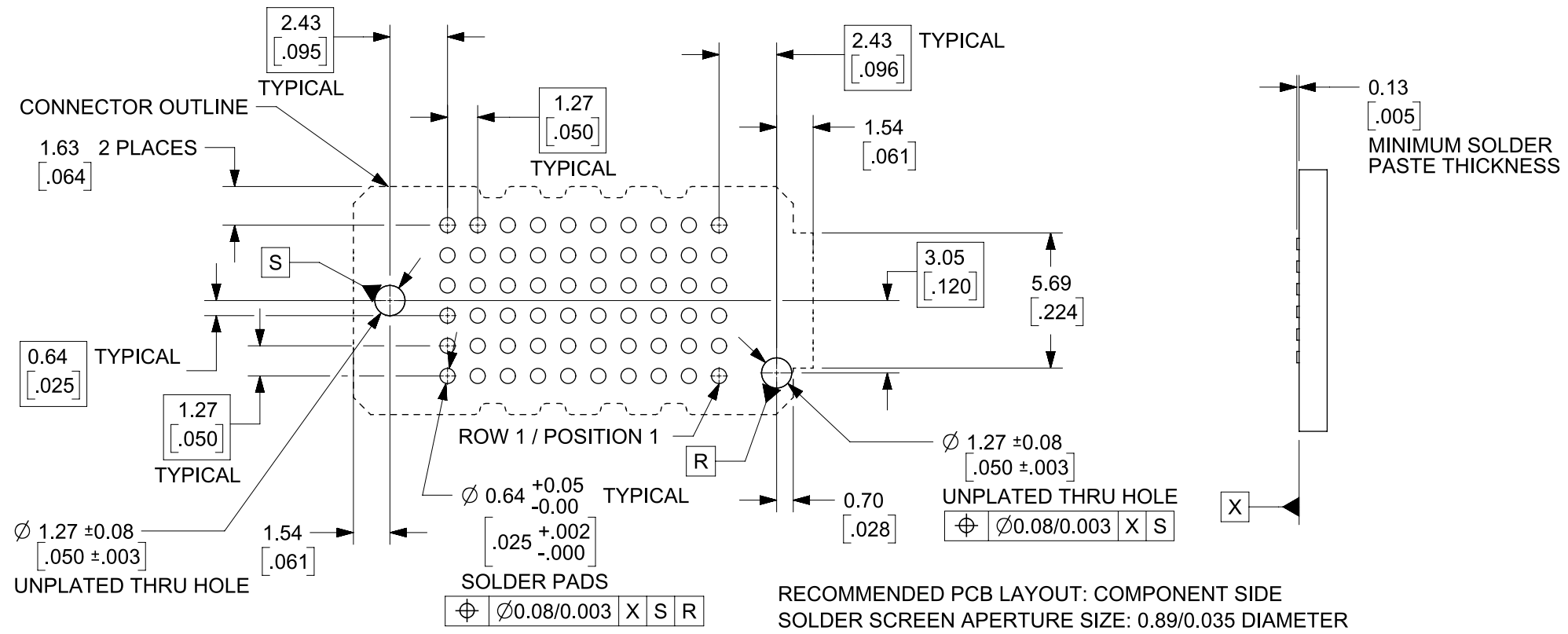

RECOMMENDED PCB LAYOUT: COMPONENT SIDE
SOLDER SCREEN APERTURE SIZE: 0.89/0.035 DIAMETER
PCB THICKNESS: NA

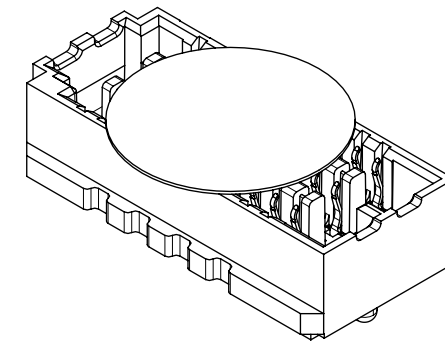
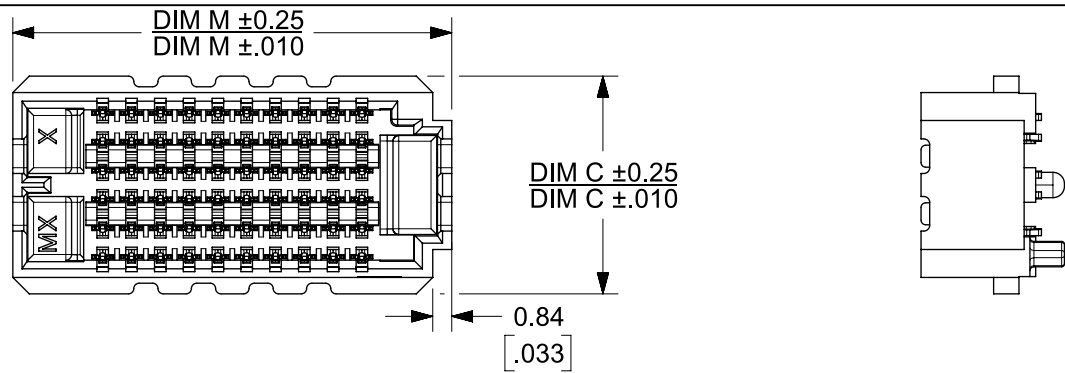

6 ROW
10 POSITION
SHOWN

NOTE: THESE CODES MAY BE LOCATED ON EITHER SIDE OF THE HOUSING
LEAD CODE
1 = TIN
DATE CODE

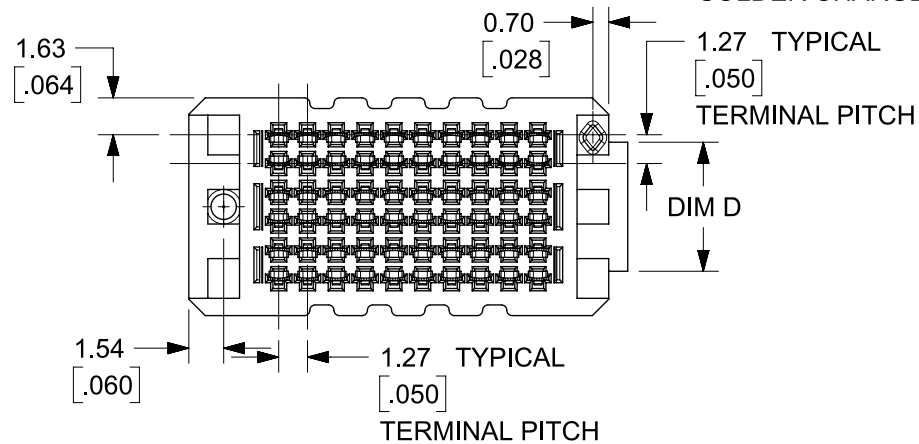
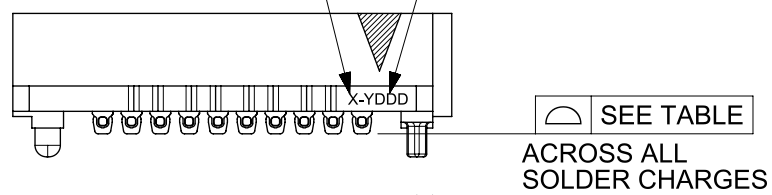

| | | | | | | | | | |
|---|--|------------------------|--|---|--|----------------------|--|-----------------|--|
| THIS DRAWING CONTAINS INFORMATION THAT IS PROPRIETARY TO MOLEX ELECTRONIC TECHNOLOGIES, LLC AND SHOULD NOT BE USED WITHOUT WRITTEN PERMISSION | | | | | | | | | |
| DIMENSION UNITS | | SCALE | | CURRENT REV DESC: | | | | | |
| MM/IN | | 3:1 | | molex SEARAY RECEPTACLE ASSEMBLY 1.27/.050 CENTERS PRODUCT CUSTOMER DRAWING DOCUMENT NUMBER: SD-45971-001 DOC TYPE: PSD DOC PART: 001 REVISION: AA MATERIAL NUMBER: SEE TABLE SHEET NO 5 CUSTOMER: GENERAL MARKET SHEET NUMBER: 4 OF 5 | | | | | |
| GENERAL TOLERANCES (UNLESS SPECIFIED) | | | | | | | | | |
| ANGULAR TOL ± ° | | | | | | | | | |
| 4 PLACES ± | | | | | | | | | |
| 3 PLACES ± | | | | | | | | | |
| 2 PLACES ± 0.25 | | | | | | | | | |
| 1 PLACE ± 0.38 | | | | | | | | | |
| 0 PLACES ± | | | | | | | | | |
| DRAFT WHERE APPLICABLE MUST REMAIN WITHIN DIMENSIONS | | THIRD ANGLE PROJECTION | | DRAWING | | SERIES | | MATERIAL NUMBER | |
| | | B-SIZE | | 45971 | | SEE TABLE SHEET NO 5 | | GENERAL MARKET | |

| ROWS: 6 DIMENSION C = 9.60/.378 DIMENSION D = 5.69/.224 | | | | | | |
|---|-------------|-------------|-------------|-------------|-------------|-------------|
| DIM R: (REF) | | 5.0 mm | 6.0 mm | 6.5 mm | 7.5 mm | 8.0 mm |
| DIM H: | | 5.05/.199 | 6.05/.238 | 6.55/.258 | 7.54/.297 | 8.05/.317 |
| DIM S: | | 5.31/.209 | 6.30/.248 | 6.81/.268 | 7.80/.307 | 8.31/.327 |
| POSITION | DIM M | MATERIAL NO | MATERIAL NO | MATERIAL NO | MATERIAL NO | MATERIAL NO |
| 10 | 19.35/0.762 | | | | | |
| 20 | 32.05/1.262 | | | | | |
| 30 | 44.75/1.762 | 45971-3165 | | | | |
| 40 | 57.45/2.262 | | | | | |
| 50 | 70.15/2.762 | 45971-5165 | | | | |
| 15 | 25.70/1.012 | | | | | |
| 25 | 38.40/1.512 | | | | | |
| 35 | 51.10/2.012 | | | | | |
| 45 | 63.80/2.512 | | | | | |

| ROWS: 8 DIMENSION C = 12.14/.478 DIMENSION D = 3.71/.146 | | | | | | |
|--|-------------|-------------|-------------|-------------|-------------|-------------|
| DIM R: (REF) | | 5.0 mm | 6.0 mm | 6.5 mm | 7.5 mm | 8.0 mm |
| DIM H: | | 5.05/.199 | 6.05/.238 | 6.55/.258 | 7.54/.297 | 8.05/.317 |
| DIM S: | | 5.31/.209 | 6.30/.248 | 6.81/.268 | 7.80/.307 | 8.31/.327 |
| POSITION | DIM M | MATERIAL NO | MATERIAL NO | MATERIAL NO | MATERIAL NO | MATERIAL NO |
| 10 | 19.88/0.784 | | | | | |
| 20 | 32.58/1.284 | 45971-2185 | | 45971-2385 | | |
| 30 | 45.28/1.784 | 45971-3185 | | 45971-3385 | | |
| 40 | 57.98/2.284 | 45971-4185 | | 45971-4385 | | |
| 50 | 70.68/2.784 | 45971-5185 | | | | |
| 15 | 26.23/1.034 | | | | | |
| 25 | 38.93/1.534 | | | | | |
| 35 | 51.63/2.034 | | | | | |
| 45 | 64.33/2.534 | | | | | |

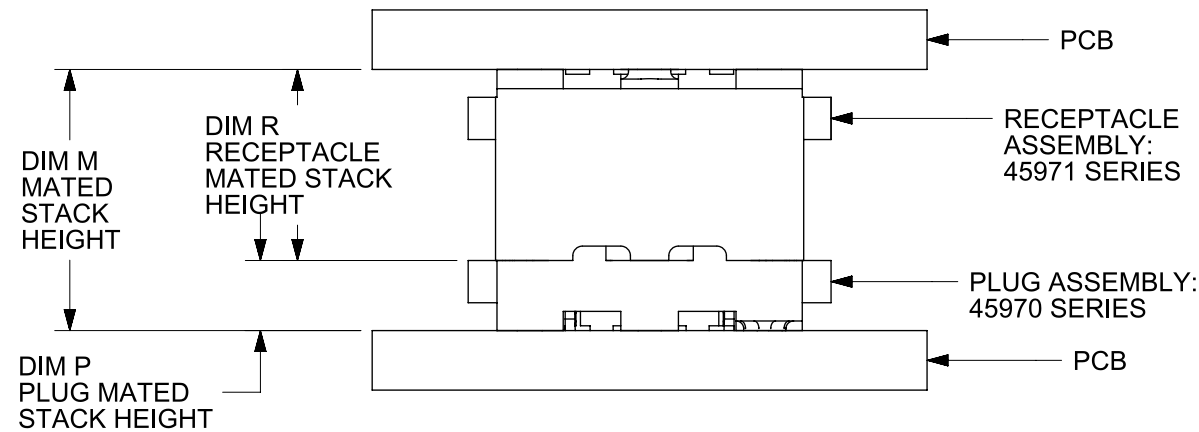

STACK HEIGHTS
GIVEN IN MILLIMETERS (MM) FOR REFERENCE ONLY

| ROWS: 10 DIMENSION C = 14.68/.578 DIMENSION D = 6.25/.246 | | | | | | |
|---|-------------|-------------|-------------|-------------|-------------|-------------|
| DIM R: (REF) | | 5.0 mm | 6.0 mm | 6.5 mm | 7.5 mm | 8.0 mm |
| DIM H: | | 5.05/.199 | 6.05/.238 | 6.55/.258 | 7.54/.297 | 8.05/.317 |
| DIM S: | | 5.31/.209 | 6.30/.248 | 6.81/.268 | 7.80/.307 | 8.31/.327 |
| POSITION | DIM M | MATERIAL NO | MATERIAL NO | MATERIAL NO | MATERIAL NO | MATERIAL NO |
| 10 | 19.88/0.784 | 45971-1115 | 45971-1215 | 45971-1315 | 45971-1415 | 45971-1515 |
| 20 | 32.58/1.284 | 45971-2115 | 45971-2215 | 45971-2315 | 45971-2415 | 45971-2515 |
| 30 | 45.28/1.784 | 45971-3115 | 45971-3215 | 45971-3315 | 45971-3415 | 45971-3515 |
| 40 | 57.98/2.284 | 45971-4115 | 45971-4215 | 45971-4315 | 45971-4415 | 45971-4515 |
| 50 | 70.68/2.784 | 45971-5115 | 45971-5215 | 45971-5315 | 45971-5415 | 45971-5515 |
| 15 | 26.23/1.034 | 45971-6115 | 45971-6215 | 45971-6315 | 45971-6415 | 45971-6515 |
| 25 | 38.93/1.534 | 45971-7115 | 45971-7215 | 45971-7315 | 45971-7415 | 45971-7515 |
| 35 | 51.63/2.034 | 45971-8115 | 45971-8215 | 45971-8315 | 45971-8415 | 45971-8515 |
| 45 | 64.33/2.534 | 45971-9115 | 45971-9215 | 45971-9315 | 45971-9415 | 45971-9515 |

MATING STACK HEIGHTS (DIMENSION R)
GIVEN IN MILLIMETERS (mm) FOR REFERENCE ONLY

| | | DIM R RECEPTACLE STACK HEIGHT | | | | | | | | | |
|-------------------------|-------|-------------------------------|-----------|-------------------|-----------|-------------------|-----------|-------------------|-----------|-------------------|-----------|
| | | 5.0 | | 6.0 | | 6.5 | | 7.5 | | 8.0 | |
| | | DIM M FULLY MATED | DIM M MAX | DIM M FULLY MATED | DIM M MAX | DIM M FULLY MATED | DIM M MAX | DIM M FULLY MATED | DIM M MAX | DIM M FULLY MATED | DIM M MAX |
| DIM P PLUG STACK HEIGHT | 2.0 | 7.00 | 7.74 | 8.00 | 8.74 | 8.50 | 9.24 | 9.50 | 10.24 | 10.00 | 10.74 |
| | 2.5 | 7.50 | 8.24 | 8.50 | 9.24 | 9.00 | 9.74 | 10.00 | 10.74 | 10.50 | 11.24 |
| | 3.0 | 8.00 | 8.74 | 9.00 | 9.74 | 9.50 | 10.24 | 10.50 | 11.24 | 11.00 | 11.74 |
| | 3.5 | 8.50 | 9.24 | 9.50 | 10.24 | 10.00 | 10.74 | 11.00 | 11.74 | 11.50 | 12.24 |
| | 4.5 | 9.50 | 10.24 | 10.50 | 11.24 | 11.00 | 11.74 | 12.00 | 12.74 | 12.50 | 13.24 |
| | 5.0 | 10.00 | 10.74 | 11.00 | 11.74 | 11.50 | 12.24 | 12.50 | 13.24 | 13.00 | 13.74 |
| | 7.0 | 12.00 | 12.74 | 13.00 | 13.74 | 13.50 | 14.24 | 14.50 | 15.24 | 15.00 | 15.74 |
| 9.0 | 14.00 | 14.74 | 15.00 | 15.74 | 15.50 | 16.24 | 16.50 | 17.24 | 17.00 | 17.74 | |

MATED STACK HEIGHTS
GIVEN IN MILLIMETERS (mm) FOR REFERENCE ONLY

| | | | | | | | | | | | |
|---|--|-----------------------------------|--|---|--|----------------|--|---------------------------------------|--|--|--|
| THIS DRAWING CONTAINS INFORMATION THAT IS PROPRIETARY TO MOLEX ELECTRONIC TECHNOLOGIES, LLC AND SHOULD NOT BE USED WITHOUT WRITTEN PERMISSION | | | | | | | | | | | |
| DIMENSION UNITS: MM/IN | | SCALE: 3:1 | | CURRENT REV DESC: | | | | | | molex | |
| GENERAL TOLERANCES (UNLESS SPECIFIED) | | ANGULAR TOL ± ° | | EC NO: 712067 DRWN: CLHOE01 CHK'D: HCGOH APPR: SHONG | | | | | | | |
| 4 PLACES ± | | 3 PLACES ± | | 2 PLACES ± 0.25 | | 1 PLACE ± 0.38 | | 0 PLACES ± | | INITIAL REVISION: DRWN: TGREGORI APPR: JCOMERCI | |
| DRAFT WHERE APPLICABLE MUST REMAIN WITHIN DIMENSIONS | | THIRD ANGLE PROJECTION | | DRAWING: B-SIZE | | SERIES: 45971 | | MATERIAL NUMBER: SEE TABLE SHEET NO 5 | | CUSTOMER: GENERAL MARKET | |
| DOCUMENT STATUS: P1 | | RELEASE DATE: 2022/07/14 16:45:44 | | 2022/01/25 | | 2022/06/27 | | 2022/07/14 | | PRODUCT CUSTOMER DRAWING | |
| | | | | | | | | DOCUMENT NUMBER: SD-45971-001 | | DOC TYPE: PSD | |
| | | | | | | | | REVISION: 001 | | AA | |
| | | | | | | | | SHEET NUMBER: 5 OF 5 | | | |